

1993

COMMISSION

Approved by Menominee County  
Land Survey Remonumentation  
Peer Group Under Act 345 Of  
P.A. Of 1990 On 11/12 199 23  
Mez Drenn  
Chairman

LAND CORNER RECORDATION CERTIFICATE  
Filing Requirement of Act 74, Mich. P.A. 1970

For corners in

<u>MENOMINEE</u> (County)	Located In:	Corner Code #
1. Public Land Survey	T <u>32N</u> R <u>27W</u>	<u>C-2</u>
	T _____ R _____	_____
	T _____ R _____	_____
	T _____ R _____	_____
2. Property Controlling in Section	S _____ T _____ R _____	_____
	S _____ T _____ R _____	_____
3. Miscellaneous Property in Sec.	S _____ T _____ R _____	_____
	S _____ T _____ R _____	_____

RECEIVED FOR RECORD  
93 DEC 29 PM 3:53  
PAGE # 15 124 #  
BARBARA MORRISON  
REGISTER OF DEEDS  
MENOMINEE, MI 49853

Register of Deeds Stamp & File Number

4. Lot No. \_\_\_\_\_, Recorded Plat \_\_\_\_\_  
5. Private Claims \_\_\_\_\_

	A	B	C	D	E	F	G	H	I	J	K	L	M
2	6	7	8	9	10	11	12	13	14	15	16	17	18
3													
4	7	8	9	10	11	12	13	14	15	16	17	18	19
5													
6	18	17	16	15	14	13	12	11	10	9	8	7	6
7													
8	19	20	21	22	23	24	25	26	27	28	29	30	31
9													
10	30	29	28	27	26	25	24	23	22	21	20	19	18
11													
12	31	32	33	34	35	36	37	38	39	40	41	42	43
13													

I, William Lenca, in a field survey on November, 19 93, do hereby certify that under requirements of P.A. 74, Michigan P.A. of 1970, the corner points mentioned in lines 1 and 2 above were in conformance with regulations and rules therefore as required in the current manual of survey instructions of the United States Department of the Interior, Bureau of Land Management or by a decree of a Court of Law and/or that the corner points mentioned in lines 3, 4 and 5 above were in conformance with the rules of the Michigan Board of Land Surveyors or by a Decree of a Court of Law; established, re-established, monumented, re-monumented, recovered, found as expressed below:

NOTE: Not more than 4 corners, all in the same town and range, may be recorded on this certificate.

A. Description of original monument and accessories and/or subsequent restoration:

ORIGINAL B.T.'s: Hemlock, 12", N77°E, 23 lks  
Sugar, 14", S09°E, 23 lks

Original Survey by James H. Mullett in 1848. All original evidence for this corner has been destroyed by county road improvements.

B. Description of corner evidence found and/or method applied in restoring or reestablishing corner:

Found a 5/8" x 24" Iron Rod/Ident. cap (RLS 26461-William Lenca) set in the centerline of a North - South county road (gravel) and in line with an old fence running East. This position fits within 6 feet of a proportionate position for this corner, and is set on a straight line between section corners. This location is accepted as the best available evidence of the position of the original corner.

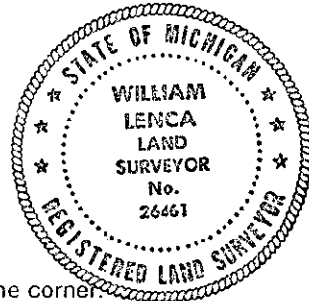

C. Description of monument for corner and accessories established to perpetuate locating the position of the corner:

Set Aluminum Berntsen "A1NBF30" Monument stamped for corner:

5/8" x 24" Iron Rod/Ident. cap (MI 26461/WI 1569)	S87°E	33.03 feet
5/8" x 24" Iron Rod/2" dia. Alum. cap (WITNESS MARKER)	S45°E	37.87 feet
" " " " " " " "	S56°W	46.02 feet
" " " " " " " "	N87°W	36.38 feet
Metal Survey Sign Post	N87°W	37.4 feet

NOTE: All bearings are magnetic bearings; distances are measured with steel tape.

Signed by William Lenca Date December 6, 1993  
Surveyor's Michigan License No. 26461