

SURVEY & REMONUMENTATION

LAND CORNER RECORDATION CERTIFICATE
Filing Requirement of Act 74, Mich. P.A. 1970

Approved by Menominee County
 Land Survey Remonumentation
 Fee Group Under Act 345 Of

P.A. of 1999 Ch. DEC 16 1994
William Lenca
 ACTING Chairman

For corners in MENOMINEE
 (County)

APR 11 1995

COMMISSION

Located in: _____ Corner Code # _____

- | | | | | |
|------------------------------------|---|-------------|------------|-------------|
| 1. Public Land Survey | T | <u>32NR</u> | <u>27W</u> | <u>C-09</u> |
| | T | _____ | _____ | _____ |
| | T | _____ | _____ | _____ |
| | T | _____ | _____ | _____ |
| 2. Property Controlling in Section | S | _____ | _____ | _____ |
| | S | _____ | _____ | _____ |
| 3. Miscellaneous Property in Sec. | S | _____ | _____ | _____ |
| | S | _____ | _____ | _____ |

RECEIVED FOR RECORD
 94 DEC 27 AM 10:49
 PAGE # 201 Bk. 4
 BARBARA MORRIS
 REGISTER OF DEEDS
 MENOMINEE, MI 49850

Register of Deeds Stamp & File Number

4. Lot No. _____, Recorded Plat _____
 5. Private Claims _____

	A	B	C	D	E	F	G	H	I	J	K	L	M
2	6	5	4	3	2	1							
3													
4	7	8	9	10	11	12							
5													
6	18	17	16	15	14	13							
7													
8	19	20	21	22	23	24							
9													
10	30	29	28	27	26	25							
11													
12	31	32	33	34	35	36							
13													

William Lenca May. 05 1994

I, _____, in a field survey on _____, 19 _____, do hereby certify that under requirements of P.A. 74, Michigan P.A. of 1970, the corner points mentioned in lines 1 and 2 above were in conformance with regulations and rules therefore as required in the current manual of survey instructions of the United States Department of the Interior, Bureau of Land Management or by a decree of a Court of Law and/or that the corner points mentioned in lines 3, 4 and 5 above were in conformance with the rules of the Michigan Board of Land Surveyors or by a Decree of a Court of Law; established, re-established, monumented, re-monumented, recovered, found as expressed below:

NOTE: Not more than 4 corners, all in the same town and range, may be recorded on this certificate.

A. Description of original monument and accessories and/or subsequent restoration:

- 1847 - Original Survey by James H. Mullett - B.T.'s - Black Ash, 14", N12°W, 14 lks; W. Birch, 10", N62°E, 26 lks. All original evidence for this corner has been destroyed by County Road improvements.
- 1884 - Survey by Orson Burlingame showing partial section subdivision - shows this corner in relation to Corners 1/2 mile North and 1/2 mile East. No description of the corner monument is given and no bearing trees are given.
- 1981 - Certified Survey No. 270 by George B. Wilson, RLS No. 17607, shows section subdivision of Section 29, T32N-R27W - Shows corner C-9 in relation to other corners in Section 29 - no description of corner monument is given.

B. Description of corner evidence found and/or method applied in restoring or reestablishing corner:

Found a railroad spike in the centerline of county roads running East-West and South, and in line with an old fence running North. We also found a concrete monument 33 feet North of this location. The measured distances 1/2 mile North (2682.76 feet) and 1/2 mile East (2802.99 feet) match closely with Orson Burlingame's record distances of 2691 feet and 2894.5 feet respectively. We accepted the position of the railroad spike as the best available evidence of the position of the original corner.

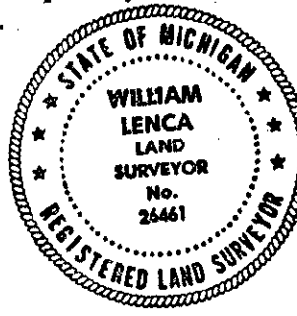

C. Description of monument for corner and accessories established to perpetuate locating the position of the corner:

Set 5/8" x 24" iron rod 3/16" dia. Alum. Cap stamped for corner in Monument Box.

5" dia. White Ash	N35°E	35.60 feet
5/8" x 24" Iron Rod/2" Alum. cap stamped "WITNESS MARKER"	S28°E	131.72 feet
5/8" x 24" Iron Rod/2" Alum. cap stamped "WITNESS MARKER"	S56°W	45.52 feet
5/8" x 24" Iron Rod/2" Alum. cap stamped "WITNESS MARKER"	N34°W	23.83 feet
Survey Sign Post	N56°W	45.7 feet

NOTE: All bearings are magnetic bearings. All distances are measured with steel tape. Distances to trees are to nail in side of tree.

Signed by William Lenca Date Nov. 18, 1994

Surveyor's Michigan License No. 26461