

**SURVEY & REMONUMENTATION**

JAN 09 2001

**SECTION**

**LAND CORNER RECORDATION CERTIFICATE**  
Filing Requirement of Act 74, Mich. P.A. 1970

Approved by Menominee County  
Land Survey Remonumentation  
Peer Group Under Act 345 of  
P.A. Of 1990, On 12/22, 2000  
MEL BAWLI RLS  
Chairman

Bk. 6 Pg. 213

RECEIVED FOR RECORD  
28 DEC 2000 2:31:31 PM  
BARBARA MORRISON  
REGISTER OF DEEDS  
MENOMINEE, MI 49858

Register of Deeds Stamp & File Number

For corners in

MENOMINEE

(County)

Located in:

Corner Code #

- |                                    |                             |       |
|------------------------------------|-----------------------------|-------|
| 1. Public Land Survey              | T <u>33</u> N R <u>26</u> W | D-9   |
|                                    | T ___ R ___                 | _____ |
|                                    | T ___ R ___                 | _____ |
|                                    | T ___ R ___                 | _____ |
| 2. Property Controlling in Section | S ___ T ___ R ___           | _____ |
|                                    | S ___ T ___ R ___           | _____ |
| 3. Miscellaneous Property in Sec.  | S ___ T ___ R ___           | _____ |
|                                    | S ___ T ___ R ___           | _____ |

4. Lot No. \_\_\_\_\_, Recorded Plat \_\_\_\_\_  
5. Private Claims \_\_\_\_\_

I, William Lenca, in a field survey on Nov., 1900 do hereby state that under requirements of P.A. 74, Michigan P.A. of 1970, the corner points mentioned in lines 1 and 2 above were in conformance with regulations and rules therefore as required in the current manual of survey instructions of the United States Department of the Interior, Bureau of Land Management or by a decree of a Court of Law and/or that the corner points mentioned in lines 3, 4 and 5 above were in conformance with the rules of the Michigan Board of Land Surveyors or by a Decree of a Court of Law; established, re-established, monumented, recovered, found as expressed below:

NOTE: Not more than 2 corners, all in the same town and range, may be recorded on this certificate.

A	B	C	D	E	F	G	H	I	J	K	L
1											
2	6		5		4		3		2		1
3											
4	7		8		9		10		11		12
5											
6	10		17		16		15		14		13
7											
8	19		20		21		22		23		24
9											
10	30		29		28		27		26		25
11											
12	31		32		33		34		35		36
13											

A. Description of original monument and accessories and/or subsequent restoration:

- 1848: Original Survey by James H. Mullett - B.T.'s - Tamarack, 12" - N48°E - 32 lks.; Tamarack, 12" - S30°E - 16 lks.; All original evidence for this corner has been destroyed by years of decay.  
1988: L.C.R.C. No. 803, Book 3, by William Lenca, RLS No. 26461 states "found old squared post in location indicated by retracement of the South line of Section 20". Set 3/4" x 60" Alum. Pipe/3" Alum. cap stamped for corner location. TIES: Nail in 12" Tamarack, Scr. B.T., N55°E, 25.76'; Nail in 12" White Pine, Scr. B.T., N32°W, 24.85'; Nail in 6" Blue Spruce, Scr. B.T., S18°E, 31.45'; Carsonite, SW, 2.17'.

B. Description of corner evidence found and/or method applied in restoring or reestablishing corner:

We found an HDR monument and three B.T.'s in place per L.C.R.C. No. 803 (see above). This corner fits well with measurements to corners 1/2 mile East and 1/2 mile West and has been accepted and used as survey control for several years, and is accepted as the best available evidence of the position of the original corner.

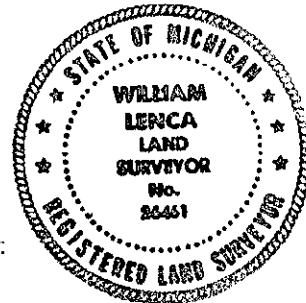

C. Description of monument for corner and accessories established to perpetuate locating the position of the corner:

Accepted existing 3/4" x 5' long aluminum rod/3" dia. Alum. cap stamped for corner:

- |                                     |       |            |             |
|-------------------------------------|-------|------------|-------------|
| 12" dia. Tamarack (Existing B.T.)   | N55°E | 25.76 feet | Scr. N.B.T. |
| 12" dia. White Pine (Existing B.T.) | N32°W | 24.85 feet | Scr. N.B.T. |
| 6" dia. Blue Spruce (Existing B.T.) | S18°E | 31.45 feet | Scr. N.B.T. |
| 7" dia. Maple                       | S58°W | 34.51 feet | Scr. N.B.T. |
| Metal Survey Sign Post              | West  | 1.0 feet   |             |

NOTE: All bearings are magnetic bearings. All distances are measured with steel tape. Distances to trees are to nail in side of tree.

Signed by William Lenca  
Surveyor's Michigan License No. 26461

Date Dec. 20, 2000