

FEB 18 1999

SECTION

LAND CORNER RECORDATION CERTIFICATE

Filing Requirement of Act 74, Mich. PA 1970

For Corners In:	Located In	Corner Code #
Osceola (County)		
1. Public Land Survey	T 18N R 9W	MC-1
Property Controlling in Section	S T R	
3. Miscellaneous Property in Section	S T R	

APPROVED LAND CORNER
P.A. 345 OF 1990
Osceola County

Matthew W. Cleary
6 Aug 1998

Register of Deeds Stamp & File Number

4. Lot No: _____ Recorded Plat: _____
5. Private Claims: _____

I, Craig W. McVean, in a field survey on Aug. 19 98 do hereby state that under requirements of PA 74, Michigan PA of 1970, the corner points mentioned in lines 1 and 2 above were in conformance with regulations and rules therefore as required in the current manual of survey instructions of the United States Department of the Interior, Bureau of Land Management or by a decree of a Court of Law and/or that the corner points mentioned in lines 3, 4 and 5 above were in conformance with the rules of the Michigan Board of Land Surveyors or by a Decree of a Court of Law; established, re-established, monumented, recovered, found as expressed below:

NOTE: Not more than 2 corners, all in the same town and range, may be recorded on this certificate.

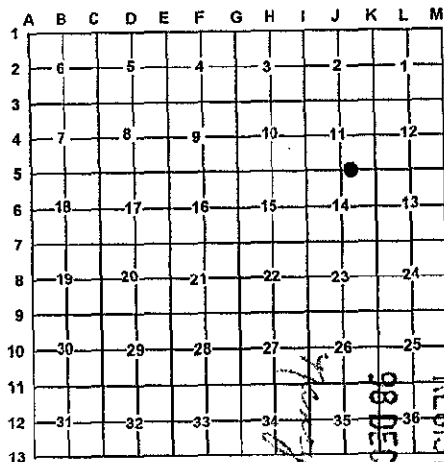

A. Description of original monument and accessories and/or subsequent restoration:

MC-1 [MC | S11 | S14] - GLO - J. Hodgson - 1838
Meander Corner East side of lake - Pine 18"
- Osceola Co. Cedar F.B., P. 30-31 - Survey Sec. 11
B. Oak S62°E 25L, Pine 10" N42°E 54L

B. Description of corner evidence found and/or method applies in restoring or re-establishing corner:

MC-1 [MC | S11 | S14] - Meander Corner on E. side Horsehead Lake between Sec. 11 & 14 T18N, R9W. Fnd. remains of 18" Pine stump on high water line of enclosed lake. Edge of water is 35' W. - 8/19/1998. Old E-W woven wire & barb wire fence remains are 8' S. Found Pine stump fits within 6' of GLO prorated position and 5' S. of straight line between I-5 & K-5. Could find no evidence of County survey BT's. Accept Pine stump remains as the best available evidence of The position of the original corner.

C. Description of monument for corner and accessories established to perpetuate locating the position of the corner.

MC-1 [MC | S11 | S14] - Drove 2" Alum. Cap on 5/8" x 34" Rebar in CL. Fnd. remains of 18" Pine stump. Built ring of cobble stones. Set orange Carsonite post 1' S.
N10°E 20.07' to N&T in W. Side 3" W. Pine
S33°E 48.51' to N&T in NE. Side 5" W. Pine
S17°W 48.54' to N&T in W. Side 5" W. Pine
N75°E 16.74' to N&T in S. Side 16" B. Oak

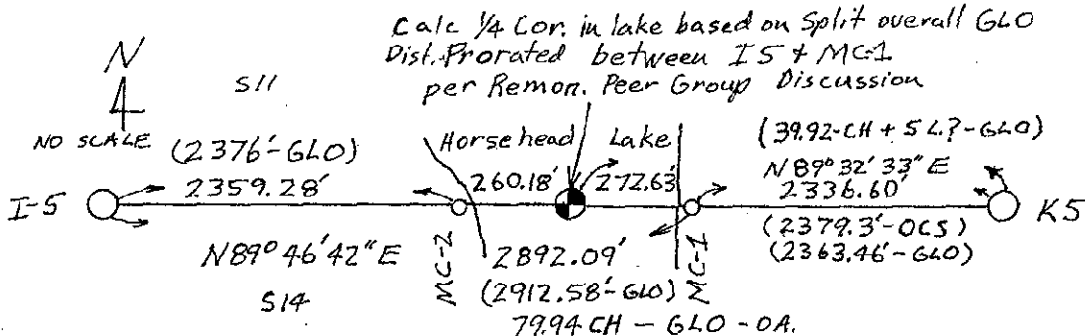

OCS - OSCEOLA Co.
Surv. Notes

Signed by: Craig W. McVean Date: 12/9/1998
Surveyor's Michigan License No.: 39088