

LAND CORNER RECORDATION CERTIFICATE
Filing Requirement of Act 74, Mich. P.A. 1970

RECORDED

For corners in

Remon 1 Page 11

Alcona
(County)

Located In:

Corner Code ##

DEC 20 1 17 PM '93

- | | | |
|------------------------------------|-------------------------|-------|
| 1. Public Land Survey | T 28 N R 7 E | M-5 |
| | T _____ R _____ | _____ |
| | T _____ R _____ | _____ |
| | T _____ R _____ | _____ |
| 2. Property Controlling in Section | S _____ T _____ R _____ | _____ |
| | S _____ T _____ R _____ | _____ |
| 3. Miscellaneous Property in Sec. | S _____ T _____ R _____ | _____ |
| | S _____ T _____ R _____ | _____ |

David A. Guthrie
 REGISTER OF DEEDS
 ALCONA COUNTY, MICHIGAN

Register of Deeds Stamp & File Number

4. Lot No. _____, Recorded Plat _____
 5. Private Claims _____

	A	B	C	D	E	F	G	H	I	J	K	L	M
2	6	5	4	3	2	1							
3													
4	7	8	9	10	11	12							
5													
6	18	17	16	15	14	13							
7													
8	19	20	21	22	23	24							
9													
10	30	29	28	27	26	25							
11													
12	31	32	33	34	35	36							
13													

I, David B. Guthrie a field survey on Sept. 21, 1993, do hereby certify that under requirements of P.A. 74, Michigan P.A. of 1970, the corner points mentioned in lines 1 and 2 above were in conformance with regulations and rules therefore as required in the current manual of survey instructions of the United States Department of the Interior, Bureau of Land Management or by a decree of a Court of Law and/or that the corner points mentioned in lines 3, 4 and 5 above were in conformance with the rules of the Michigan Board of Land Surveyors or by a Decree of a Court of Law; established, re-established, monumented, re-monumented, recovered, found as expressed below:

NOTE: Not more than 4 corners, all in the same town and range, may be recorded on this certificate.

A. Description of original monument and accessories and/or subsequent restoration:

1839: G.L.O. Survey by Lewis Clason - Set post and referenced
 Elm 10 - S59°W - 26 / Cedar 8 - N37°W - 20

1973: Survey by Donald Marlatt for the Plat of Korol Park - Found square wooden stake.

1988: Survey by David B. Guthrie - Found square wooden stake - Set 1/2" Iron Rod adjacent and referenced.

B. Description of corner evidence found and/or method applied in restoring or reestablishing corner:

1993: Found 1/2" Iron Rod and remnants of square wooden stake.
 Verified 1988 references.

**SURVEY &
 REMONUMENTATION**

1993

COMMISSION

C. Description of monument for corner and accessories established to perpetuate locating the position of the corner:

1993: Set 1/2" X 24" Iron rod with a 3" aluminum cap stamped to identify the corner. Referenced -
 S56°W - 18" Willow - 16.00 Feet
 N73°W - 6" Ash - 15.72 Feet
 N19°E - 6" Ash - 4.98 Feet
 N77°E - 6" Ash - 17.58 Feet

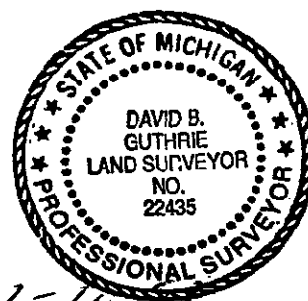

Signed by

Date

Surveyor's Michigan License No. 22435