

LAND CORNER RECORDATION CERTIFICATE
Filing Requirement of Act 74, Mich. P.A. 1970 as Amended

For corners in

Baraga (County)	Located In:	Corner Code #
1. Public Land Survey	T 50N R 33W T 50N R 33W T R	E10 D9
2. Property Controlling in Section	S T R S T R S T R	
3. Miscellaneous Property in Sec.	S T R S T R	
4. Lot No. , Recorded Plat		
5. Private Claims		

Register of Deeds Stamp & File Number

	A	B	C	D	E	F	G	H	I	J	K	L	M
1													
2		6		5		4		3		2		1	
3													
4		7		8		9		10		11		12	
5													
6		18		17		16		15		14		13	
7													
8		19		20		21		22		23		24	
9													
10		30		29		28		27		26		25	
11													
12		31		32		33		34		35		36	
13													

I, Stephan J. Szyszkoski, in a field survey on D9 05/19/2011 do hereby state
that under requirements of P.A. 74, Michigan P.A. of 1970, the corner points mentioned in lines 1 and 2
above were in conformance with regulations and rules therefore as required in the current manual of survey
instructions of the United States Department of the Interior, Bureau of Land Management or by a decree of
a Court of Law and /or that the corner points mentioned in lines 3, 4 and 5 above were in conformance with
the rules of the Michigan Board of Land Surveyors or by a Decree of a Court of Law; established,
re-established, monumented, recovered, found as expressed below:

NOTE: Not more than 2 corners, all in the same town and range, may be recorded
on this certificate.

A. Description of original monument and accessories and/or subsequent restoration:

(E10) Quarter corner common to Sections 28 and 29. 1849 - Established by Wm.Burt Deputy Surveyor
midway and on the Section line between Section corners 40.00 ch. North and South. Set Cedar post.
Sugar 6" S16W 13 links, Hemlock 6" N61E 15 links. Found no subsequent record. Norman T. Thompson
RLS did survey work in this area in the 1940's for Ford Motor Company.

(D9) Quarter corner common to Sections 20-29. 1849 - Established by Wm.Burt Deputy Surveyor midway
and on the Section line between Section corners 39.905 chains east and west. Set Cedar post. Cedar
8" N53E 48 links, Cedar 7" S38W 9 links. Found no subsequent record.

B. Description of corner evidence found and/or method applied in restoring or reestablishing corner:

(E10) Found an old 1"ID I.pipe, not of record, substantially at the 1849 position of record and at
record bearing and distance from the rotting remains of a Hemlock stump, likely the remains of the
1849 BT, N61E 15 links. Any markings which may have been present on the Hemlock have long since
rotted away. Found old blazes on nearby trees facing the pipe, as well as a Ford Motor Co. location
poster dated to 1955 or 1956 on a fallen Cedar, also with old blazes. Accepted the pipe as the best
available evidence of the position of the original corner and drove a new monument at its position.

(D9) The original post and accessories were not recovered. Found no evidence of the position of the
original corner on the ground. Reestablished the position for the corner midway and on the Section
line between Section corners 2613.34' east and west, proportionate to the original record. From the
corner position, found an old Ford Motor Co. location poster on a down Cedar 15 ft. southeast, marked
"approximate" corner.

C. Description of monument for corner and accessories established to perpetuate locating the position of the corner:

(E10) Set 1"IDx32" I.pipe with 4" alum. MDNR cap.
Set measuring nail with MDNR tag in the side of:
12" Y.Birch S70E 30.0' mrkd "1/4S NBT"
15" Hemlock S09E 20.45' do
13" Cedar S38W 28.3' do
16" Hemlock S87W 21.2' do
Set sq'd cedar post adjacent.
Bearings are magnetic.

(D9) Set 1"IDx32" I.pipe with 4" alum. MDNR cap.
Set measuring nail with MDNR tag in the side of:
10" Cedar N06E 43.3' mrkd "1/4S NBT"
6" Balsam N68E 0.85' do
14" Cedar N88E 6.8' do
12" Cedar S21W 19.0' do
Set sq'd Cedar post adjacent.
Bearings are magnetic.

Signed by Stephan J. Szyszkoski
Surveyor's Michigan License No. 33986

Date 10/24/2011

For the Michigan Department of Natural Resources, Forest Management Division

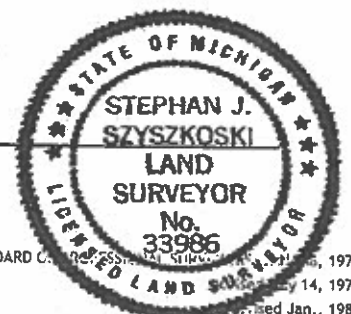

16738

16739