

LAND CORNER RECORDATION CERTIFICATE
Filing Requirement of Act 74, Mich. P.A. 1970

For corners in

Baraga

(County)

Located in:

Corner Code #

1. Public Land Survey

T50N R 34W

E4

T R

T R

T R

T R

2. Property Controlling
in Section

S T

T R

3. Miscellaneous
Property in Sec.

S T

T R

S T

T R

Register of Deeds Stamp & File Number

4. Lot No. _____, Recorded Plat _____

5. Private Claims _____

10/14/98

I, Stephan J. Szyszkoski, in a field survey on _____, 19____ do hereby state that under requirements of P.A. 74, Michigan P.A. of 1970, the corner points mentioned in lines 1 and 2 above were in conformance with regulations and rules therefore as required in the current manual of survey instructions of the United States Department of the Interior, Bureau of Land Management or by a decree of a Court of Law and for that the corner points mentioned in lines 3, 4 and 5 above were in conformance with the rules of the Michigan Board of Land Surveyors or by a Decree of a Court of Law, established, re-established, monumented, recovered, found as expressed below:

NOTE: Not more than 2 corners, all in the same town and range, may be recorded on this certificate.

A	B	C	D	E	F	G	H	I	J	K	L	M
1												
2	6		5		4		3		2		1	
3												
4	7		8		9		10		11		12	
5												
6	18		17		16		15		14		13	
7												
8	19		20		21		22		23		24	
9												
10	30		29		28		27		26		25	
11												
12	31		32		33		34		35		36	
13												

A. Description of original monument and accessories and/or subsequent restoration:

Quarter corner common to Sections 8 & 9. Established in 1949 by Mm. A. Burt: "North between Sections 8 & 9...40.00 Set tamarack qr. section post. Tamarack 12 N66W 30, do 4 S34E 10...80.00 Set post corner of Sections 4, 5, 8, 9". B. Description of corner evidence found... The original post and accessories were not recovered. At the location for the corner, I found a very old barbed wire fence running westerly from an abandoned and overgrown N-S roadbed. The roadbed is defined from approximately the south 1/16 corner between 8&9 north to the Section corner 4-5-8-9. (continued below)

B. Description of corner evidence found and/or method applied in restoring or reestablishing corner:

Continued from above - I traced the fence line to about 300' west of the old road and it runs quite straight at a magnetic bearing of N87W. The fence continues west but I did not follow it any farther. At the intersection of the E'ly extension of the fence with the roadbed, I find a 3/8" dia. by 8' long copper grounding rod sunk 4' into the ground. There is no fence to the east. A local land owner, Mr. Philip M. Keyes says that it is his understanding that the fence is the original homestead fence constructed 80-90 years ago and that it is regarded as the E-W 1/4 line of Sec. 8. I recover, in the roadbed, an ancient 12" iron culvert, 10.5' long, about 4' south of the corner and use it's center to define the center of the roadbed. I measure south to a recorded section corner 2597.8' over very rough terrain, and north approximately 2630' to the NW corner of section 9. The bed is about 18' W. of a line between these corners at the fence. I accept the intersection of the fence with the center of the old bed (as defined by the culvert) to be the best available evidence of the position of the original corner and place a 1"10x32" iron pipe capped with a plastic cap stamped "MICH DNR PS 33986" at that location.

C. Description of monument for corner and accessories established to perpetuate locating the position of the corner:

Set 1" pipe with plastic cap "MICH DNR PS 33986" projecting 10". Blazed, scribed and set measuring nails in:
 7" Blk Spruce N76E 26.15 "1/4S NBT"
 5" Blk Spruce N22E 51.05' do
 7" Blk Spruce N51W 32.8' do
 5" Blk Spruce S15E 43.75' do
 Distances are to 16d galvanized sinkers with brass tags. Bearings are magnetic.

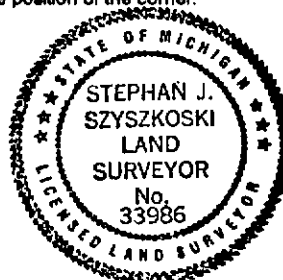

Signed by

Stephan J. Szyszkoski

Date

3/30/99

Surveyor's Michigan License No.

33986

For the Michigan Department of Natural Resources - Forest Management Division