

LAND CORNER RECORDATION CERTIFICATE
 Filing Requirement of Act 74, Mich. P.A. 1970 as Amended

For corners in

<u>Baraga</u> (County)	Located In:	Corner Code #
1. Public Land Survey	T 51N R 32W	H11
	T _____ R _____	_____
	T _____ R _____	_____
2. Property Controlling in Section	S _____ T _____ R _____	_____
	S 23 T 51N R 32W	11
	S _____ T _____ R _____	_____
3. Miscellaneous Property in Sec.	S _____ T _____ R _____	_____
	S _____ T _____ R _____	_____
4. Lot No. _____, Recorded Plat _____		
5. Private Claims _____		

Register of Deeds Stamp & File Number

	A	B	C	D	E	F	G	H	I	J	K	L	M
1													
2	6			5				4				3	
3													
4	7												
5													
6	10												
7													
8	13												
9													
10	16												
11													
12	19												
13													

I, Stephan J. Szyszkoski, in a field survey on 11 08/18/2011 do hereby state that under requirements of P.A. 74, Michigan P.A. of 1970, the corner points mentioned in lines 1 and 2 above were in conformance with regulations and rules therefore as required in the current manual of survey instructions of the United States Department of the Interior, Bureau of Land Management or by a decree of a Court of Law and /or that the corner points mentioned in lines 3, 4 and 5 above were in conformance with the rules of the Michigan Board of Land Surveyors or by a Decree of a Court of Law; established, re-established, monumented, recovered, found as expressed below:

NOTE: Not more than 2 corners, all in the same town and range, may be recorded on this certificate.

A. Description of original monument and accessories and/or subsequent restoration:

(H11) Quarter corner common to Sections 27 and 34. 1986 - The original corner position was recovered by Stephen D. Douglas, Cadastral Surveyor, for the U.S. D.O.I., Bureau of Land Management, during a dependent resurvey of this township. Mr. Douglas recovered the remains of the original bearing trees and determined that the position of the corner is N89 deg. 02.6'E 39.940 chains from Section corner G11 and N89 deg. 45.0'W 40.024 chains from Section corner I11 (mean true bearings). Mr. Douglas did not monument the corner position, nor take witnesses. The remains of the original BTs are described in the 1986 field notes as: A charred Y.Pine stump, size indeterminate, N34E 12 links, faint axe marks; A charred Y.Pine stump, 26" dia., S46W 36 links, chaining notch visible.

(11-Sec. 23) Southwest 1/16 corner, Section 23. Not established in the original survey.

B. Description of corner evidence found and/or method applied in restoring or reestablishing corner:

(H11) Reestablished the 1986 position for the corner by adjusting the record 1986 measurements between corners G10, G11, H11, I9, I11, I12, and J11 to fit BLM monuments recovered at G9, G10, I9, I12 and J11. I observed the mean true bearings and distances from the positions for Section corners G11 and I11 (which were left unmonumented) to the reestablished position for H11 to be N89 deg 3.2'E 39.939 chains and N 89 deg. 45.8'W 40.020 chains, respectively. The position for the corner falls at record bearing and distance from the B.T. Y.Pine SW, now a stump hole. The B.T. Y.Pine NE is sliding downhill and is not reliable for accurate measurement, but falls at the approximate record bearing and distance.

(11-Sec. 23) Established the corner at the intersection of straight lines connecting opposite 1/16 corners.

C. Description of monument for corner and accessories established to perpetuate locating the position of the corner:

(H11) Set 1"IDx32" I.pipe with 4" alum. MDNR cap. Set measuring nail with MDNR tag in the side of:
 4" R.Pine N13E 11.5' mrkd "1/4S NBT"
 8" R.Pine S04E 4.05' do
 4" R.Pine S74W 8.9' do
 7" R.Pine N54W 19.4' do
 Set sq'd Cedar post adjacent.
 Bearings are magnetic.

(11) Set 1"IDx32" I.pipe with 4" alum. MDNR cap. Set measuring nail with MDNR tag in the side of:
 4" Balsam N41E 5.3' mrkd "1/16S BT"
 7" twin Hemlock S72E 16.7' do
 6" Balsam S08W 18.4' do
 7" Hemlock N85W 11.95' do
 Set sq'd Cedar post adjacent.
 Bearings are magnetic.

Signed by Stephan J. Szyszkoski
 Surveyor's Michigan License No. 33986

Date 08/30/2011

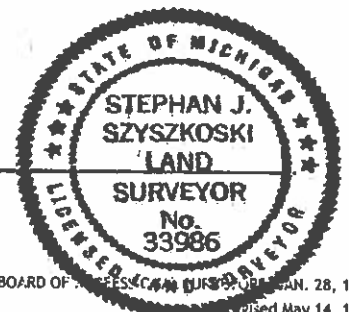

For the Michigan Department of Natural Resources, Forest Management Division