

SURVEY & REMONUMENTATION

APR 08 1996

COMMISSION

BARRY COUNTY REMONUMENTATION LAND CORNER RECORDATION CERTIFICATE Filing Requirement of Act 74, Mich. P.A. 1970

STATE OF MICHIGAN
COUNTY OF BARRY
RECEIVED FOR RECORD

DEC 15 2 08 PM '95

Sandy Schondelmaier
REGISTER OF DEEDS

For corners in

BARRY

(County)

Located In:

Corner Code ~~##~~

- Public Land Survey
PRAIRIEVILLE TOWNSHIP
REFERENCE MONUMENT TO
MEANDER POST ON BASE LINE AT
EAST SHORE OF LITTLE LONG LAKE
T R
- Property Controlling
in Section
S T 1 N R 10W
- Miscellaneous
Property in Sec.
S T R

002358

Register of Deeds Stamp & File Number

- Lot No. , Recorded Plat
- Private Claims

I, **BRIAN REYNOLDS**, in a field survey on **OCTOBER 24**, 19 **95**, do hereby certify that under requirements of P.A. 74, Michigan P.A. of 1970, the corner points mentioned in lines 1 and 2 above were in conformance with regulations and rules therefore as required in the current manual of survey instructions of the United States Department of the Interior, Bureau of Land Management or by a decree of a Court of Law and/or that the corner points mentioned in lines 3, 4 and 5 above were in conformance with the rules of the Michigan Board of Land Surveyors or by a Decree of a Court of Law; established, re-established, monumented, re-monumented, recovered, found as expressed below:

NOTE: Not more than 4 corners, all in the same town and range, may be recorded on this certificate.

A. Description of original monument and accessories and/or subsequent restoration:

- MEANDER CORNER ON EAST SIDE OF LITTLE LONG LAKE WAS ESTABLISHED BY GENERAL LAND OFFICE DEPUTY SURVEYOR JOHN MULLETT IN DECEMBER, 1825. THE NOTES INDICATE THAT THE CORNER WAS 54.25 CHAINS EAST OF J-13, THE NEAREST STANDARD CORNER NOT IN A LAKE. MEANDER POST NOTED AS "ASPIN 6."
- RESURVEY OF PRAIRIEVILLE TOWNSHIP BY BARRY COUNTY DEPUTY SURVEYOR JOHN Q. CRESSY IN OCTOBER, 1884, NOTES INDICATE THAT FROM J-13 TO THE EAST BANK OF LITTLE LONG LAKE IS 54.19 CHAINS. CRESSY'S NOTES INDICATE THAT THE SOUTHWEST CORNER OF SECTION 36 IS "IN LAKE." CRESSY DID NOT SET A POST ON THE SHORE, AND NO WITNESS WERE NOTED.
SEE REVERSE OF THIS FORM FOR ADDITIONAL HISTORICAL DATA

B. Description of corner evidence found and/or method applied in restoring or reestablishing corner:

NO DIRECT EVIDENCE REMAINS OF THE GENERAL LAND OFFICE SURVEY OR THE CRESSY RESURVEY BETWEEN GULL LAKE AND LITTLE LONG LAKE. FOUND CONCRETE MONUMENTS AT THE NORTHWEST CORNER OF TANGLEWOOD, THE NORTHEAST CORNER OF TANGLEWOOD, AND 3 POINTS BETWEEN THEM. ALSO FOUND A 1/2" IRON AT THE SOUTHWEST CORNER OF RIDGEWOOD, AND AT SEVERAL POINTS ALONG THE SOUTH LINE OF RIDGEWOOD. A LINEAR REGRESSION OF THE 8 POINTS FOUND ALONG THE BASE LINE BETWEEN THE LAKES INDICATES THAT THE FURTHEST POINT IS 0.23 FEET FROM LINE. ACCEPTED THE LINE THUS DETERMINED AS THE BEST EVIDENCE OF THE BASE LINE BETWEEN THE LAKES. SET STANDARD KALAMAZOO COUNTY HARRISON MONUMENT 7.45' WEST OF CONCRETE MONUMENT AT NORTHWEST CORNER OF LOT 1 OF TANGLEWOOD AS REFERENCE MONUMENT TO MEANDER POST.

SEE REVERSE OF THIS FORM FOR GRAPHICAL REPRESENTATION

ACT 345 BARRY COUNTY REMONUMENTATION
APPROVED BY PEER REVIEW AT A MEETING HELD ON

12/11/95 **BR**
BRIAN REYNOLDS COUNTY SURVEYOR

C. Description of monument for corner and accessories established to perpetuate locating the position of the corner:

SET STANDARD KALAMAZOO COUNTY REMONUMENTATION MONUMENT (HARRISON)

WITNESSES:

NAIL AND TAG IN N SIDE OF 20" MAPLE	S77°E	25.05'
NAIL AND TAG IN NE ROOT OF 10" ASH	N40°E	10.07'
NAIL AND TAG IN SW ROOT OF 14" ASH	N43°E	25.67'
NAIL AND TAG IN S SIDE OF 18" OAK	N71°E	41.30'
WEST SHORE OF LITTLE LONG LAKE	WEST	12'+/-
CONCRETE PLAT MONUMENT	EAST	7.45'

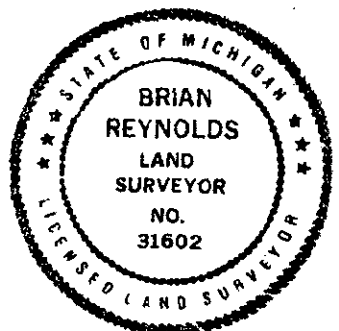

Signed by

Date

Surveyor's Michigan License No.

31602

PART "A" (CONTINUED)

3. THE RECORDED PLAT OF "TANGLEWOOD HILLS" IN SECTION 2, T1S R10W, SURVEYED BY WILLIAM H. WILKINS, RECORDED 9-10-1954, LIBER 20 OF PLATS, PAGE 29. THE NORTH LINE OF THE PLAT IS THE MICHIGAN BASE LINE; THE NORTHWEST CORNER OF LOT 1 IS THE INTERSECTION OF THE BASE LINE AND AN INTERMEDIATE TRAVERSE LINE OF THE EAST SHORE OF LITTLE LONG LAKE.
4. RECORDED PLAT OF "RIDGEWOOD" IN SECTION 36, T1N R10W, SURVEYED BY ANDREW LENDERINK, RECORDED 5-11-1922. THE SOUTH LINE OF THE PLAT IS THE MICHIGAN BASE LINE. THE DESCRIPTION OF THE PLAT BOUNDARY DOES NOT REFERENCE ANY GRID CORNER; THE POINT OF BEGINNING IS THE INTERSECTION OF THE BASE LINE AND THE EASTERLY RIGHT OF WAY LINE OF "THE PUBLIC HIGHWAY." THE SOUTHEAST CORNER OF LOT 1 IS THE INTERSECTION OF THE BASE LINE AND AN INTERMEDIATE TRAVERSE LINE OF THE WEST SHORE OF GULL LAKE.

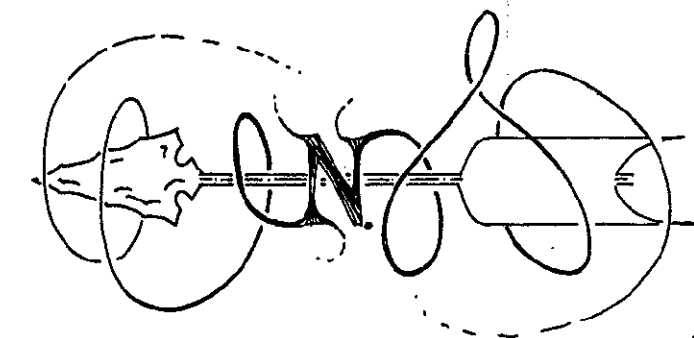

RELATIVE
POSITION
OF CORNERS
NO SCALE

