

SURVEY &  
REMONUMENTATION

BARRY COUNTY REMONUMENTATION

AUG 13 1998

LAND CORNER RECORDATION CERTIFICATE  
Filing Requirement of Act 74, Mich. P.A. 1970

SECTION  
For Corners in  
**BARRY**  
(county)

Located In:

Corner Code #

1. Public Land Survey  
CORNER COMMON TO  
SECTIONS 4, 5, 8 &  
BALTIMORE TOWNSHIP

T 2N R 8W  
T \_\_\_\_\_ R \_\_\_\_\_  
T \_\_\_\_\_ R \_\_\_\_\_  
T \_\_\_\_\_ R \_\_\_\_\_

E-3



2678

Page: 1 of 1  
04/23/1998 08:10A

Sandy Schondelmayer - Barry Co. LCROR

2. Property Controlling S \_\_\_\_\_ T \_\_\_\_\_ R \_\_\_\_\_  
in Section S \_\_\_\_\_ T \_\_\_\_\_ R \_\_\_\_\_

3. Miscellaneous S \_\_\_\_\_ T \_\_\_\_\_ R \_\_\_\_\_  
Property in Sec. S \_\_\_\_\_ T \_\_\_\_\_ R \_\_\_\_\_

4. Lot No \_\_\_\_\_, Recorded Plat \_\_\_\_\_

5. Private Claims \_\_\_\_\_

Register of Deeds Stamp & File Number

I, **Brian Reynolds**, in a field survey on **10 AUGUST, 1997** do hereby certify that under requirements of P.A. 74, Michigan P.A. of 1970, the corner points mentioned in lines 1 and 2 above were in conformance with regulations and rules therefore as required in the current manual of survey instructions of the United States Department of the Interior, Bureau of Land Management or by a decree of a Court of Law and/or that the corner points mentioned in lines 3, 4, and 5 above were in conformance with the rules of the Michigan Board of Land Surveyors or by a Decree of a Court of Law; established, re-established, monumented, re-monumented, recovered, found as expressed below.

NOTE: Not more than 2 corners, all in the same town and range, may be recorded on this certificate.

	A	B	C	D	E	F	G	H	I	J	K	L	M
1													
2		6		5		4		3		2		1	
3													
4		7		8		9		10		11		12	
5													
6		18		17		16		15		14		13	
7													
8		19		20		21		22		23		24	
9													
10		30		29		28		27		26		25	
11													
12		31		32		33		34		35		36	
13													

A. Description of original monument and accessories and/or subsequent restoration:

1. GENERAL LAND OFFICE: MUSGROVE EVANS, D.S., 1826 (R8W, P.78) A BE. 9 S79E 17 & A W. O. 18 S61W 22 LKS
2. COUNTY SURVEYOR RECORDS: FRANK BOWEN (COPYIST), MARCH 3, 1866 (L.2, P.80) "BEARINGS FOUND"
3. ALSO: LEE COBB, 1887 (L.2, P.61) "FOUND OLD W. O. STUMP GOV'T & REMAINS OF BEECH" W. O. 18 N47½ E 72½
4. COUNTY ROAD COMMISSION: 1926 HIGHWAY PLANS(PAGE 22) "FOUND 943.5' W. OF STA. 906.60" NO WITNESSES
5. UNRECORDED SURVEY OF PARCEL IN SW ¼ OF SECTION 4 BY Wm. HUME ROGERS, P.S. #6197, DATED SEPT. 28, 1971, SECTION CORNER IS SW CORNER OF "PARCEL A" DRAWING INDICATES "1" IRON, NO WITNESSES RECITED.
6. UNRECORDED SURVEY: BY BRIAN REYNOLDS, P.S. #31602, 30 NOV., 1988 (JOB #88438) & 11 APRIL, 1994 (JOB #94212) WITNESSES TO ¾" IRON 12" BEECH N50°E 39.06' 10" HICKORY S65°W 29.60' 30" BEECH S80°E 22.30' 85' +/- WEST OF POND 7' +/- NORTH OF E-W FENCE

B. Description of corner evidence found and/or method applied in restoring or reestablishing corner:

FOUND ¾" IRON CONFORMING WITH OFFSET DIMENSION IN ITEM #4 ABOVE, CONFORMING WITH DISTANCES TO PROPERTY CORNERS IN ITEM #5 ABOVE, AND CONFORMING WITH WITNESSES IN ITEM #6 ABOVE. ACCEPTED AS PERPETUATION OF CORNER POSITION. REPLACED ¾" IRON WITH STANDARD BARRY COUNTY REMONUMENTATION MONUMENT.

C. Description of monument for corner and accessories established to perpetuate locating the position of the corner:

SET STANDARD BARRY COUNTY REMONUMENTATION MONUMENT (3/4" X 36" IRON) WITH ALUMINUM CAP.  
SET 20d NAIL IN THE SOUTH SIDE OF A 12" BEECH N50°E 39.06'  
SET 20d NAIL IN THE NORTH SIDE OF A 10" HICKORY S65°W 29.60'  
SET 20d NAIL IN THE NORTH SIDE OF A 30" BEECH S80°E 22.30'  
SET 20d NAIL IN THE EAST SIDE OF A 10" ELM N12°W 22.31'  
7' +/- NORTH OF DECAYING EAST-WEST FENCE  
85' +/- WEST OF WEST SHORE OF LARGE POND

ACT 345 BARRY COUNTY REMONUMENTATION  
APPROVED BY PEER REVIEW AT A MEETING HELD ON

13 May, '96

BRIAN REYNOLDS

COUNTY SURVEYOR

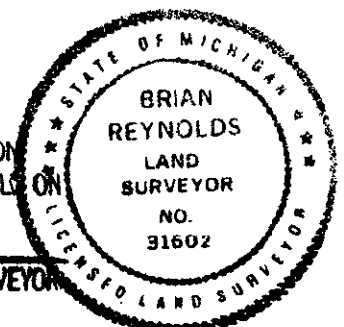

Signed by Brian Reynolds  
Surveyor's Michigan License No 31602

Date APRIL 20, 1998

FORM APPROVED BY MICHIGAN STATE BOARD OF LAND SURVEYORS. JAN. 28, 1971

REVISED MAY 14, 1975 REVISED JANUARY, 1983 REVISED OCTOBER 1995