

RAITIFIED BY THE BERRIEN COUNTY  
SURVEY PEER GROUP AS THE  
OFFICIAL CORNER UNDER MICHIGAN  
PUBLIC ACT 345 OF 1990

03/08/96

111#0545 A33  
CORNER \$9.00  
111#0545 A33  
STATE REMON FEE \$2.00

BERRIEN COUNTY REMONUMENTATION  
LAND CORNER RECORDATION CERTIFICATE  
Filing Requirement of Act 74, Mich. P.A. 1970

For corners in BERRIEN (County)  
Located In: \_\_\_\_\_ Corner Code ##  
ON STATE LINE  
1. Public Land Survey T 8S. R 21W. G-9  
T \_\_\_\_\_ R \_\_\_\_\_  
T \_\_\_\_\_ R \_\_\_\_\_  
T \_\_\_\_\_ R \_\_\_\_\_  
2. Property Controlling S \_\_\_\_\_ T \_\_\_\_\_ R \_\_\_\_\_  
in Section S \_\_\_\_\_ T \_\_\_\_\_ R \_\_\_\_\_  
3. Miscellaneous S \_\_\_\_\_ T \_\_\_\_\_ R \_\_\_\_\_  
Property in Sec. S \_\_\_\_\_ T \_\_\_\_\_ R \_\_\_\_\_

4. Lot No. \_\_\_\_\_, Recorded Plat \_\_\_\_\_  
5. Private Claims \_\_\_\_\_

Register of Deeds Stamp & File Number

I, DANIEL B. ZWAR, in a field survey on MARCH 5, 19 96,  
do hereby certify that under requirements of P.A. 74, Michigan P.A. of 1970, the corner points mentioned  
in lines 1 and 2 above were in conformance with regulations and rules therefore as required in the  
current manual of survey instructions of the United States Department of the Interior, Bureau of Land  
Management or by a decree of a Court of Law and/or that the corner points mentioned in lines 3, 4 and 5  
above were in conformance with the rules of the Michigan Board of Land Surveyors or by a Decree of a  
Court of Law; established, re-established, monumented, re-monumented, recovered, found as  
expressed below:

NOTE: Not more than 4 corners, all in the same town and range, may be recorded  
on this certificate.

A. Description of original monument and accessories and/or subsequent restoration:

1827- E.P.KENDRICKS RAN NORTH LINE OF INDIANA. FROM 3 MILE POST RAN EAST 80.00 CHAINS-  
SET 4 MILE POST. W. OAK 24" S54°W 14 LINKS, W. OAK 14" N62°E 83 LINKS.

1830- L. LYON RAN SOUTH BETWEEN SECTIONS 21 & 22 - 55.19 CHAINS TO NORTH BOUNDARY OF  
INDIANA, 0.63 LINKS EAST OF 4 MILE POST.  
BEECH 16" N85°W 16 LINKS, WHITEWOOD 18" N69°E 17 LINKS.

(CONTINUED ON BACK)

B. Description of corner evidence found and/or method applied in restoring or reestablishing corner:

NO ORIGINAL WITNESSES EXIST TODAY. COULD NOT FIND 4 MILE POST. ACCORDING TO RECENT WITNESSES  
INCLUDING THOSE ON L.C.R.C. IN LIBER 1, PAGE 396 I DID FIND A 1" X 16" IRON PIPE IN GRAVEL  
ROAD. REMOVED PIPE AND DUG SUFFICIENT HOLE TO EXPOSE A POINTED STONE IN A RING OF RED BRICKS  
AT ABOUT 18"- 20"! POINT OF STONE WAS 0.20' SOUTH AND 0.16' EAST OF PIPE LOCATION.

SURVEY &  
REMONUMENTATION

DEC 16 1996

COMMISSION

C. Description of monument for corner and accessories established to perpetuate locating the position of the corner:

REMOVED STONE (NO OTHER EVIDENCE BELOW) AND LEFT RING OF BRICKS INTACT. SET STANDARD 1"X 36"  
IRON PIPE W/ B.C.R.P. BRASS CAP TO EXACT LOCATION OF POINT ON STONE. SET IN MON. BOX- TOP  
6" BELOW ROAD SURFACE. CORNER IS ACCEPTED AS A CAREFUL AND FAITHFUL PERPETUATION OF THE POSI-  
TION OF THE ORIGINAL CORNER. CAP IS MARKED "+" FOR EXACT CORNER LOCATION AND WITH "28435"  
N 1/4 POST, INDIANA CORNER SECTION 10- T38N, R3W WEST 474.97' AND WITH "1996".  
SET NAIL W/ TAG IN POWER POLE(B692-62) N22°W 72.84'  
SET NAIL W/ TAG IN POWER POLE(L106-40) S53°W 34.68'  
SET NAIL W/ TAG IN 18" OAK N77°E 49.28'  
SET NAIL W/ TAG IN 24" OAK S75°E 15.96'

Signed by Daniel B Zwar  
Surveyor's Michigan License No. 28435

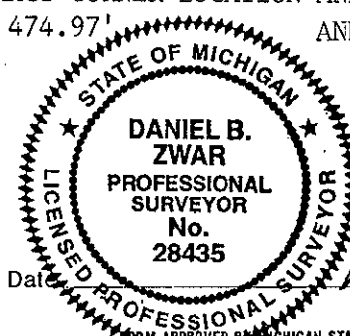

Date

March 7, 1996

Continued From A:

1960 - Michigan State Highway Dept.  
Dimensions 474.88' West from G-9 to N¼ Post Section 10, T.38N., R.3W.,  
Springfield Twp. LaPorte County, Ind.

1972 - BCRC Notes "MSHD - Boat Spike"

Guy Pole N37°E 26.62'

6" Oak S72°E 17.02' ✓

T.P. N68°W 47.10'

6" Basswood N60°W 52.0'

F.Post S80° W 45.70'

F.Post S60° W 22.8'

F.Post S10° E 7.9'

Demensions 474.73' From G-9 to N¼ Post Section 10, T38N., R3W.

1973 - R. Garrett - "1" Iron Pipe" ✓

12" Oak S75°E 16.75' ✓

P.Pole N35°W 73.09'

4" Sassafras N75°E 63.34' ✓

W/LCRC L1/pg. 396

Did two surveys here in Aug'73 - Same wit.

1989 - D.Pitts - "Iron Pipe" ✓

No witnesses

Feb 28, 1996 D. Zwar inspection site and found a 1" Iron Pipe w/Oak (SE) and Sassafras (NE)  
still existant. Also fd Harrison Mon at N¼ Post, sd Sec 10, Indiana about 474± West.  
(✓=Fd)

Daniel B. Zwar  
L.P.S. No. 28435