

LAND CORNER RECORDATION CERTIFICATE
Filing Requirement of Act 74, Mich. P.A. 1970

For corners in
Chippewa

(County)

Located In:

Corner Code #

1. Public Land Survey

T___ R___
T___ R___
T___ R___
T___ R___

2. Property Controlling
in Section

S___ 6 T___ 45N R___ 1W 10

3. Miscellaneous
Property in Sec.

S___ T___ R___
S___ T___ R___

Register of Deeds Stamp & File Number

4. Lot No. _____, Recorded Plat _____
5. Private Claims _____

Sep 23 2002

I, Stephan J. Szyszkoski, in a field survey on _____, 19____ do hereby state that under requirements of P.A. 74, Michigan P.A. of 1970, the corner points mentioned in lines 1 and 2 above were in conformance with regulations and rules therefore as required in the current manual of survey instructions of the United States Department of the Interior, Bureau of Land Management or by a decree of a Court of Law and /or that the corner points mentioned in lines 3, 4 and 5 above were in conformance with the rules of the Michigan Board of Land Surveyors or by a Decree of a Court of Law, established, re-established, monumented, recovered, found as expressed below:

NOTE: Not more than 2 corners, all in the same town and range, may be recorded on this certificate.

	A	B	C	D	E	F	G	H	I	J	K	L	M
1													
2		6		5		4		3		2		1	
3													
4		7		8		9		10		11		12	
5													
6		18		17		16		15		14		13	
7													
8		19		20		21		22		23		24	
9													
10		30		29		28		27		26		25	
11													
12		31		32		33		34		35		36	
13													

A. Description of original monument and accessories and/or subsequent restoration:
The South 1/16 corner between Section 6 T45N-R01W and Section 1 T45N-R02W. Not established in the original survey. Found no subsequent record.

B. Description of corner evidence found and/or method applied in restoring or reestablishing corner:

Established the corner midway and on a straight line between Quarter corner 1317.45' North and Section corner 1317.45' South, both being Chippewa County monuments of record, established in 1994.

C. Description of monument for corner and accessories established to perpetuate locating the position of the corner:

Set 1"IDx36" I.pipe with 4" alum. MDNR
cap. Blazed, scribed, and set measuring
nails in:
6" Balsam N39E 33.2' "S1/16 NBT"
12" Maple N64E 8.85' do
10" triple Maple S68E 94.0' do
12" twin Maple S20E 31.95' do
Bearings are magnetic. Distances are to
nail with tag.

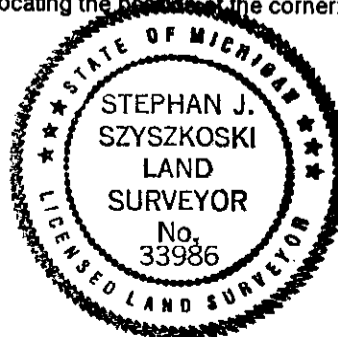

Signed by Stephan J. Szyszkoski
Surveyor's Michigan License No. 33986

Date 12/5/02