

LAND CORNER RECORDATION CERTIFICATE  
Filing Requirement of Act 74, Mich. P.A. 1970

For corners in  
Chippewa

(County)

Located In:

Corner Code #

1. Public Land Survey

T 45N R 1W B3  
T R  
T R  
T R  
S T R  
S T R  
S T R  
S T R

2. Property Controlling  
in Section

3. Miscellaneous  
Property in Sec.

4. Lot No. , Recorded Plat  
5. Private Claims

May 16 2002

I, Stephan J. Szyszkoski, in a field survey on \_\_\_\_\_, 19\_\_\_\_ do hereby state that under requirements of P.A. 74, Michigan P.A. of 1970, the corner points mentioned in lines 1 and 2 above were in conformance with regulations and rules therefore as required in the current manual of survey instructions of the United States Department of the Interior, Bureau of Land Management or by a decree of a Court of Law and /or that the corner points mentioned in lines 3, 4 and 5 above were in conformance with the rules of the Michigan Board of Land Surveyors or by a Decree of a Court of Law, established, re-established, monumented, recovered, found as expressed below:

NOTE: Not more than 2 corners, all in the same town and range, may be recorded on this certificate.

Register of Deeds Stamp & File Number

	A	B	C	D	E	F	G	H	I	J	K	L	M
1													
2		6		5		4		3		2		1	
3													
4		7		8		9		10		11		12	
5													
6		18		17		16		15		14		13	
7													
8		19		20		21		22		23		24	
9													
10		30		29		28		27		26		25	
11													
12		31		32		33		34		35		36	
13													

A. Description of original monument and accessories and/or subsequent restoration:

(B3) Quarter corner common to Sections 6-7. 1845: Established by James Mullett D.S.: "East corrected between sections 6 & 7...39.85 Set quarter section post. Hemlock 18 S69E 22, Cedar 10 N30E 20...79.85 Sect. cor." Found no subsequent record.

B. Description of corner evidence found and/or method applied in restoring or reestablishing corner:

(B3) The original post and accessories were not recovered. Found no evidence of the position of the original corner on the ground. Reestablished the corner on a line of mean true bearing between Section Corners 2662.99' east and 2653.00' west, being 40 chains, proportionate to the original record, west of C3. I found the true bearing of the Section line to be S89 deg. 54' 25" W.

C. Description of monument for corner and accessories established to perpetuate locating the position of the corner:

(B3) Set 1"IDx36" Iron pipe with 4" alum. MDNR cap. Blazed, scribed, and set measuring nails in:  
5" B.Spruce N06E 4.1' "1/4S NBT"  
6" J.Pine S75E 7.0' do  
4" B.Spruce S19W 4.1' do  
7" Tamarack S31E 14.1' do  
Set cedar post adjacent. Bearings are magnetic. Distances are to nail with tag.

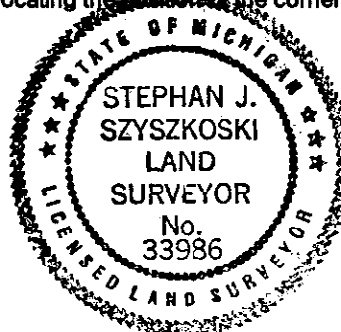

Signed by Stephan J. Szyszkoski  
Surveyor's Michigan License No. 33986

Date 9/18/02

For the Michigan Department of Natural Resources - Office of Property Management

FORM APPROVED BY MICHIGAN STATE BOARD OF PROFESSIONAL SURVEYORS, JAN. 28, 1971  
REVISED MAY 14, 1975  
REVISED JAN., 1983  
REVISED OCT., 1995