

APR 27 1995

COMMISSION

CRAWFORD COUNTY
PEER GROUP APPROVAL
DATE DEC 29, 1994
MEM

LIBER 8 PAGE 176

LAND CORNER RECORDATION CERTIFICATE
Filing Requirement of Act 74, Mich. P.A. 1970

For corners in

Crawford
(County)

Located In:

Corner Code ##

- | | | |
|------------------------------------|---|-------------|
| 1. Public Land Survey | T <u>25N</u> R <u>2W</u> | <u>E-9</u> |
| | T <u> </u> R <u> </u> | <u> </u> |
| | T <u> </u> R <u> </u> | <u> </u> |
| | T <u> </u> R <u> </u> | <u> </u> |
| 2. Property Controlling in Section | S <u> </u> T <u> </u> R <u> </u> | <u> </u> |
| | S <u> </u> T <u> </u> R <u> </u> | <u> </u> |
| 3. Miscellaneous Property in Sec. | S <u> </u> T <u> </u> R <u> </u> | <u> </u> |
| | S <u> </u> T <u> </u> R <u> </u> | <u> </u> |

STATE OF MICHIGAN

COUNTY OF CRAWFORD

FILED FOR RECORD THIS
30th DAY OF Dec, 1994 AT
4:20 am/pm IN LIBER 3
PAGE 176

Register of Deeds Stamp & File Number

4. Lot No. , Recorded Plat
5. Private Claims

I, Marvin E. Myers in a field survey on Dec 27, 19 94, do hereby certify that under requirements of P.A. 74, Michigan P.A. of 1970, the corner points mentioned in lines 1 and 2 above were in conformance with regulations and rules therefore as required in the current manual of survey instructions of the United States Department of the Interior, Bureau of Land Management or by a decree of a Court of Law and/or that the corner points mentioned in lines 3, 4 and 5 above were in conformance with the rules of the Michigan Board of Land Surveyors or by a Decree of a Court of Law; established, re-established, monumented, re-monumented, recovered, found as expressed below:

NOTE: Not more than 4 corners, all in the same town and range, may be recorded on this certificate.

	A	B	C	D	E	F	G	H	I	J	K	L	M
2	6	5	4	3	2	1							
3													
4	7	8	9	10	11	12							
5													
6	18	17	16	15	14	13							
7													
8	19	20	21	22	23	24							
9													
10	30	29	28	27	26	25							
11													
12	31	32	33	34	35	36							
13													

A. Description of original monument and accessories and/or subsequent restoration:

GLO-D. Pettibone 1852

Mon-Set Post

Wit-12" Spr. Pine N39°E .03 chs.

20" Y. Pine S87°E 2.20 chs.

R. Ostling Sept 1956

Mon- Well Point

Wit- 6" B. Oak S11°30'W 21.8

4" B. Oak S59°30'E 26.7

10" J. Pine N12°E 35.6

4" B. Oak N47°W 6.6

PLAT OF RIVER FOREST

Mon-4"x36" concrete mon.

Wit- NBT 6" B. Oak N47°W 6.8

NBT 10" J. Pine N12°E 35.8

NBT 5" B. Oak S11°30'W 21.8

NBT 5" B. Oak S59°E 27.6

B. Description of corner evidence found and/or method applied in restoring or reestablishing corner:

Found 4" x 36" Concrete Monument laying on side near 1/2"x18" iron bar & cap #21266 on North Right of Way of road. Found Blaze in 12" J. Pine (cut) NE'ly 35'±. Found Brass tag & nail W. side 8" J. Pine N29°E 8.82. Found Brass tag & nail W. side 13" W. Pine S10°E 51.33

Accepted as the best available evidence of the position of the Original Corner.

C. Description of monument for corner and accessories established to perpetuate locating the position of the corner:

Mon-Set standard Crawford County Monument marked cap "31600 MEM E-9" in exact location of 1/2"x18" bar and cap.

Wit-Set nail & tag North side 4" Cedar post N75°W 9.75

Set nail & tag NW side 7" J. Pine N63°E 28.38

Set carsonite post N7°E 3.42

Old survey line N07°E

Center of road Southerly 18'±

Found Brass tag & nail W. side 13" W. Pine S10°E 51.33

Found Brass tag & nail W. side 8" J. Pine N29°E 8.82

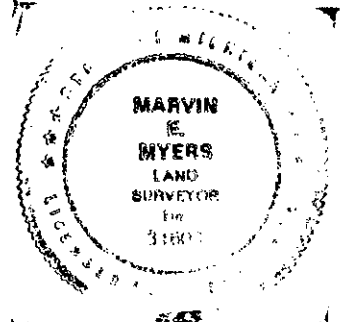

Signed by Marvin E. Myers

Date December 29, 1994

Surveyor's Michigan License No. 31600