

SEP 17 1999

LAND CORNER RECORDATION CERTIFICATE
 Filing Requirement of Act 74, Mich. P.A. 1970

SECTION

For corners in

Houghton
 (County)

Located In: 26

Corner Code #

1. Public Land Survey

T 54N R 33W J-11

T R

T R *Seg. #2*

T R

2. Property Controlling
 in Section

S T R

S T R

3. Miscellaneous
 Property in Sec.

S T R

S T R

MARY SCHOOS 05/19/99 2
 HOUGHTON COUNTY, REGISTER 13:55
 LC 3/ 606 PAJ Fee: 9.00
 Page 1 of 1

Register of Deeds Stamp & File Number

4. Lot No. _____, Recorded Plat _____

5. Private Claims _____

I, Robert A Goodreau in a field survey on September 1998 do hereby state that under requirements of P.A. 74, Michigan P.A. of 1970, the corner points mentioned in lines 1 and 2 above were in conformance with regulations and rules therefore as required in the current manual of survey instructions of the United States Department of the Interior, Bureau of Land Management or by a decree of a Court of Law and/or that the corner points mentioned in lines 3, 4 and 5 above were in conformance with the rules of the Michigan Board of Land Surveyors or by a Decree of a Court of Law, established, re-established, monumented, recovered, found as expressed below:

	A	B	C	D	E	F	G	H	I	J	K	L	M
1													
2		6		5		4		3		2		1	
3													
4		7		8		9		10		11		12	
5													
6		18		17		16		15		14		13	
7													
8		19		20		21		22		23		24	
9													
10		30		29		28		27		26		25	
11													
12		31		32		33		34		35		36	
13													

NOTE: Not more than 2 corners, all in the same town and range, may be recorded on this certificate.

A. Description of original monument and accessories and/or subsequent restoration:
 J-11 Post Set - 1845 by D. Houghton.
 Yellow Birch, 10" N17°E, 9 LKS
 Maple, 14", S62°W, 12 LKS

B. Description of corner evidence found and/or method applied in restoring or reestablishing corner:
 J-11 Found 1" Pipe, along evident fence line and field. Blue paint marking lines in all directions.
 Accepted corner as found.

C. Description of monument for corner and accessories established to perpetuate locating the position of the corner:
 J-11 Set 2" Brass remon cap on top of found pipe. Witness set with 60d nail, brass "UPEA" tags, chest blaze.
 Hemlock, 7", SCR. NBT S68°E, 5.85'
 Yellow Birch, 15", SCR. NBT, S30°E, 12.65'
 Hemlock, 8", SCR. NBT, S44°W, 11.85'
 Balsam Fir, 9", SCR. NBT, S80°W, 13.24'

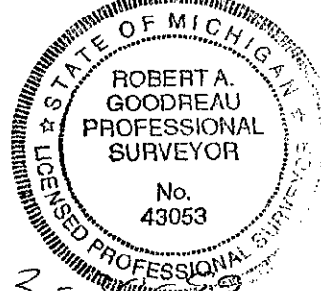

Signed by Robert A. Goodreau
 Surveyor's Michigan License No. 43053

Date 3-30-99