

JAN 19 2001

SECTION

Re-Monumented 2, Page 1/1

2000 REMONUMENTATION
LAND CORNER RECORDATION CERTIFICATE
Filing Requirement of Act 74, Mich. P.A. 1970

For Corners in BINGHAM Township

STATE OF MICHIGAN
HURON COUNTY
RECORDED

8 DEC 2000 9:58 AM

FRANCES L. HOLDWICK
REGISTER OF DEEDS

Huron
(County)

Located in: Corner Code #

- 1. Public Land Survey T 15N R 13E A-3
T _____ R _____
T _____ R _____
T _____ R _____
- 2. Property Controlling S
in Section S T _____ R _____
T _____ R _____
- 3. Miscellaneous S
Property in Sec. S T _____ R _____
T _____ R _____

Register of Deeds Stamp & File Numl

- 4. Lot No. _____, Recorded Plat _____
- 5. Private Claims _____

1	A	B	C	D	E	F	G	H	I	J	K	L
2	8	5	4	3	2	1						
3												
4	7	6	9	10	11	12						
5												
6	18	17	16	15	14	13						
7												
8	19	20	21	22	23	24						
9												
10	30	29	28	27	26	25						
11												
12	31	32	33	34	35	36						
13												

I, Russell L. Brown, in a field survey on June 23, 2000 do hereby state that under requirements of P.A. 74, Michigan P.A. of 1970, the corner points mentioned in lines 1 and 2 above were in conformance with regulations and rules therefore as required in the current manual of survey instructions of the United States Department of the Interior, Bureau of Land Management or by a decree of a Court of Law and/or that the corner points mentioned in lines 3, 4, and 5 above were in conformance with the rules of the Michigan Board of Land Surveyors or by a Decree of a Court of Law; established, re-established, monumented, recovered, found as expressed below:

NOTE: Not more than 2 corners, all in the same town and range, may be recorded on this certificate.

A. Description of original monument and accessories and/or subsequent restoration:

1834 G.L.O. H. Parke D.S. Set Post Corner Sections 1 and 12, East side T15N-R12E B. Ash 16 N46W 17, DO 7 S7W 9

COUNTY SURVEYOR RECORD - None

COUNTY ROAD COMMISSION RECORD - Iron Pin, WITNESSES: Spike P.P. S45W 48.3', Spike P.P. N20W 88.3'

MONUMENT: no witnesses given, 5-11-00 FOUND 3/4" Iron In Monument Box WITNESSES: N45°E 68.54' Spike in P.P., East 40.66' P.K. Nail Centerline Wadsworth Road, S60°W 96.06' Spike in P.P.

L.C.R.C. - None

RECORDED SURVEY - Continued next page

UNRECORDED SURVEY - None

B. Description of corner evidence found and/or method applied in restoring or reestablishing corner:

No evidence of original corner or accessories found.

Found 3/4" Dia. Re-Rod in Monument Box.

Accepted found 3/4" Re-Rod as best evidence of original corner position.

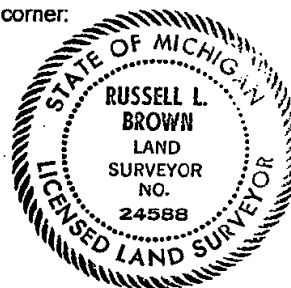

C. Description of monument for corner and accessories established to perpetuate locating the position of the corner:

A - 3, S. W. Cor. Sec. 6, and N. W. Cor. Sec. 7, T15N-R13E

Found 3/4" Dia. Re-Rod in Monument Box

WITNESSES:

N30°W 91.22' Southwesterly quad S. lift loop on Phone Ped

N45°E 68.48' Spike in S.E. face Power Pole

S60°W 96.05' Roofing Nail in N.W. face of Power Pole

S65°E 140.50' Spike in N. face Power Pole

South 2643.09' to A-4, W. 1/4 Cor. Sec. 7, T15N-R13E

North 2628.0' to A-2, W. 1/4 Cor. Sec. 6, T15N-R13E

NOTE:

This corner is common with M - 3, T15N-R12E

Signed by Russell L. Brown
Surveyor's Michigan License No. 24588

Date Nov. 2, 2000

Peer group approved at meeting held November 2, 2000. *RLB*

JAN 19 2001

SECTION

Re-Monumentation, Page 111 A

2000 REMONUMENTATION
LAND CORNER RECORDATION CERTIFICATE
Filing Requirement of Act 74, Mich. P.A. 1970

For Corners in BINGHAM Township

Huron County, T15N-R13E
A - 3 Continued

RECORDED SURVEYS:

9-29-76, Case Surveying, Stewart G. Case P.S. 15399, Liber 3 Survey, Page 78 of Huron County Recors.
S. W. Cor. Frac. Sec. 6, T15N-R13E
Found Monument Box in place in center intersection

WITNESSES:

Center of Telephone Pole, N20°W 88.5'
Center of Power Pole, N50°E 68.9'
Center of Guard Rail, S20°W 66.35'

