

JAN 19 2001

SECTION

2000 REMONUMENTATION
LAND CORNER RECORDATION CERTIFICATE
Filing Requirement of Act 74, Mich. P.A. 1970

For Corners in VERONA Township

Huron
(County)

Located in:

Corner Code #

1. Public Land Survey

T 16N R 13E A - 12

T R

T R

T R

T R

T R

T R

T R

2. Property Controlling S
in Section S

3. Miscellaneous S
Property in Sec. S

4. Lot No. , Recorded Plat

5. Private Claims

I, Russell L. Brown, in a field survey on June 23, 2000 do hereby state that under requirements of P.A. 74, Michigan P.A. of 1970, the corner points mentioned in lines 1 and 2 above were in conformance with regulations and rules therefore as required in the current manual of survey instructions of the United States Department of the Interior, Bureau of Land Management or by a decree of a Court of Law and/or that the corner points mentioned in lines 3, 4, and 5 above were in conformance with the rules of the Michigan Board of Land Surveyors or by a Decree of a Court of Law; established, re-established, monumented, recovered, found as expressed below:

NOTE: Not more than 2 corners, all in the same town and range, may be recorded on this certificate.

A. Description of original monument and accessories and/or subsequent restoration:

1834 GLO H. Parke D.S. Set quarter Section Post, E. side Section 36, T16N-R12E

Cedar 12 N10 1/2W 8 1/2, Hemlock 12 S33W 12

COUNTY SURVEYOR RECORDS: None

COUNTY ROAD COMMISSION RECORD: Iron Pin, WITNESSES: Spike in P.P. S45°E 77.35', Spike in 30" Maple N45°E 90.30', Iron Pin in fence, West 55.90'; 5-11-00, Found P.K. Nail over 1 1/2" Pipe, WITNESSES: West 42.0' to W. edge of grader blade; S35°E 73.35' to Spike in P.P.

L.C.R.C. - None

RECORDED SURVEYS: continued next page

UNRECORDED SURVEYS: None

B. Description of corner evidence found and/or method applied in restoring or reestablishing corner:

No evidence of original corner or accessories found.

Found 1 1/4" Pipe in Monument Box.

Accepted found 1 1/4 Pipe as best evidence of original corner position.

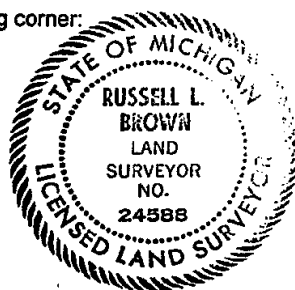

C. Description of monument for corner and accessories established to perpetuate locating the position of the corner:

A - 12, West 1/4 Corner Section 31, T16N-R13E

Found 1 1/4" Pipe in Monument Box

WITNESSES:

West 40.08' to 1/2" Re-Rod Set

S35°E 73.40' to Spike in S.W. Face of Power Pole

N45°E 38.0' to 1/2" Re-Rod Set

S45°W 38.0' to 1/2" Re-Rod Set

South 2620.05'; A-13 S.W. Corner Section 31, T16N-R13E

North 2617.34'; A- 11 N.W. Corner Section 31, T16N-R13E

NOTE:

This corner is common with
M - 12, T16N-R12E

Signed by Russell L. Brown
Surveyor's Michigan License No. 24588

Date Nov. 2, 2000

Peer group approved at meeting held November 2, 2000. RLB

SHEET 1 of 2 SHEETS

JAN 19 2001

SECTION

Re-Monumented 2, Page 123 A
2000 REMONUMENTATION
LAND CORNER RECORDATION CERTIFICATE
Filing Requirement of Act 74, Mich. P.A. 1970

For corners in VERONA Township

Huron County, T16N-R13E
A - 12 Continued

RECORDED SURVEYS:

5-27-77, Case Surveying, Stewart G. Case P.S. 15399, Liber 3 Survey, Page 241 of Huron County Records.
East ¼ Cor. Sec. 36, T16N-R12E Colfax Township
Found 1" Pipe over top of 1" Steel Axle Shaft in place

WITNESSES:

¾" Iron Pin, West 57.0'
Spike in S.W. Side of P.P. S30°E 73.45'
Spike in N. W. Side of 36" Box Elder Tree, N55°E 91.8'

