

JAN 19 2001

SECTION

2000 REMONUMENTATION  
LAND CORNER RECORDATION CERTIFICATE  
Filing Requirement of Act 74, Mich. P.A. 1970

For Corners in CASEVILLE Township

Huron  
(County)

Located in:

Corner Code #

1. Public Land Survey

T 18N R 10E  
T \_\_\_\_\_ R \_\_\_\_\_  
T \_\_\_\_\_ R \_\_\_\_\_  
T \_\_\_\_\_ R \_\_\_\_\_  
T \_\_\_\_\_ R \_\_\_\_\_  
T \_\_\_\_\_ R \_\_\_\_\_  
T \_\_\_\_\_ R \_\_\_\_\_  
T \_\_\_\_\_ R \_\_\_\_\_

J - 13

2. Property Controlling S  
in Section S

3. Miscellaneous S  
Property in Sec. S

4. Lot No. \_\_\_\_\_, Recorded Plat \_\_\_\_\_

5. Private Claims \_\_\_\_\_

STATE OF MICHIGAN  
HURON COUNTY  
RECORDED

8 DEC 2000 9:56 AM

FRANCES L. HOLDWICK  
REGISTER OF DEEDS

Register of Deeds Stamp & File Number

I, Russell L. Brown, in a field survey on October 12, 2000 do hereby state that under requirements of P.A. 74, Michigan P.A. of 1970, the corner points mentioned in lines 1 and 2 above were in conformance with regulations and rules therefore as required in the current manual of survey instructions of the United States Department of the Interior, Bureau of Land Management or by a decree of a Court of Law and/or that the corner points mentioned in lines 3, 4, and 5 above were in conformance with the rules of the Michigan Board of Land Surveyors or by a Decree of a Court of Law; established, re-established, monumented, recovered, found as expressed below:

NOTE: Not more than 2 corners, all in the same town and range, may be recorded on this certificate.

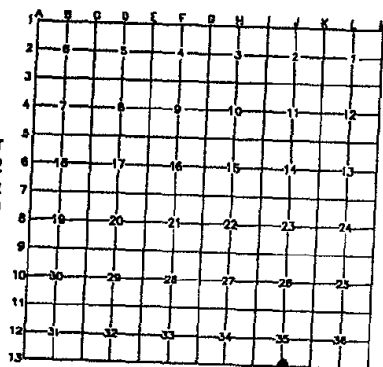

A. Description of original monument and accessories and/or subsequent restoration:

1834 GLO H. Parke D.S. Set quarter Section Post

Tamarec 9 N32E 7; DO 5 N42W 18

COUNTY SURVEYOR RECORD: None

COUNTY ROAD COMMISSION RECORD: None

L.C.R.C.: None

RECORDED SURVEYS: 10-15-76, Case Surveying, Stewart G. Case P.S. 15399, Liber 3 survey, page 127 of Huron County Records.; S. 1/4 Cor. Sec. 35, T18N-R10E: Corner comes in center of Compeau County Drain. Corner is 32.3' West of centerline of Railroad track. No Witnesses given

UNRECORDED SURVEYS: None

B. Description of corner evidence found and/or method applied in restoring or reestablishing corner:

No evidence of original corner or accessories found.

Set 1/2" x 18" Steel Stake (Re-Rod) by single proportionate measurement between K-13 and I-13, T18N-R10E as best evidence of original corner position. Capped P.S. 24588

C. Description of monument for corner and accessories established to perpetuate locating the position of the corner:

J - 13, S. 1/4 Corner Section 35, T18N-R10E

Set 1/2" x 18" Steel Stake (Re-Rod) capped 24588

WITNESSES:

N50°E 30.10' to Spike in S.E. Side Tressle Wing Wall Support Post

N10°W 45.72' to Top Center Hydrant

S15°E 21.64' to Spike & Washer East Side Power Pole

S65°W 10.78' to 1/2" x 18" Steel Stake Set

South 8.0' to 1/2" Steel Stake Found

East 2639.36' to K-13, S.E. Corner Section 35, T18N-R10E

West 2639.36' to I-13, S.W. Corner Section 35, T18N-R10E

Signed by Russell L. Brown  
Surveyor's Michigan License No. 24588

Date Nov 2, 2000

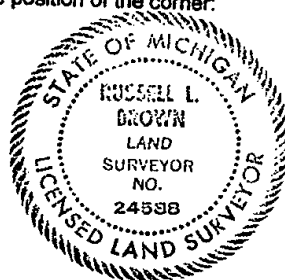

Peer group approved at meeting held November 2, 2000. REB