

1999 REMONUMENTATION
LAND CORNER RECORDATION CERTIFICATE
Filing Requirement of Act 74, Mich. P.A. 1970

For Corners in PORT AUSTIN Township

<u>Huron</u> (County)	Located in:	Corner Code #
1. Public Land Survey	T 19N R 12E	K - 13
	T ----- R -----	
	T ----- R -----	
	T ----- R -----	
2. Property Controlling S in Section S	T ----- R -----	
	T ----- R -----	
3. Miscellaneous S Property in Sec. S	T ----- R -----	
	T ----- R -----	

STATE OF MICHIGAN
HURON COUNTY
RECORDED

30 DEC 99 2:16 P.M.

FRANCES L. HOLDWICK
REGISTER OF DEEDS

Register of Deeds Stamp & File Number

4. Lot No. _____, Recorded Plat _____
5. Private Claims _____

SECTION

I, Russell L. Brown, in a field survey on Dec. 14, 1999 do hereby state that under requirements of P.A. 74, Michigan P.A. of 1970, the corner points mentioned in lines 1 and 2 above were in conformance with regulations and rules therefore as required in the current manual of survey instructions of the United States Department of the Interior, Bureau of Land Management or by a decree of a Court of Law and/or that the corner points mentioned in lines 3, 4, and 5 above were in conformance with the rules of the Michigan Board of Land Surveyors or by a Decree of a Court of Law; established, re-established, monumented, recovered, found as expressed below:

A	B	C	D	E	F	G	H	I	J	K	L	M
2	6	5	4	3	2							
3												
4	7	8	9	10	11	12						
5												
6	18	17	16	15	14	13						
7												
8	19	20	21	22	23	24						
9												
10	30	29	28	27	26	25						
11												
12	31	32	33	34	35	36						
13												

NOTE: Not more than 2 corners, all in the same town and range, may be recorded on this certificate.

A. Description of original monument and accessories and/or subsequent restoration:
1834 G.L.O. H. Parke D.S. Set Post Corner Sections 35 and 36, Cedar 8 N83 1/2E 25, Elm 9 N75W 32
County Surveyors Records - None
County Road Commission Records - None
L.C.R.C. - None
Recorded Surveys - None
Unrecorded Surveys - None

B. Description of corner evidence found and/or method applied in restoring or reestablishing corner:
No evidence of original corner or accessories found.

Found 1/2" Steel Stake.

Accepted found 1/2" Steel Stake as best evidence of original corner position.

Capped found 1/2" Steel Stake P.S. 24588

C. Description of monument for corner and accessories established to perpetuate locating the position of the corner:

K-13, South Corner Sections 35 and 36, T19N-R12E
Found 1/2" Steel Stake capped P.S. 24588
WITNESSES:
North 30.95' to R.R.S. in East Side of 42" Maple Tree
N40°W 52.92' to Spike in Northeast Side of 15" Maple
N40°E 46.90' to Spike in Northwest Side of 13" Maple
S65°E 42.51' to "+" in top of 24" C.M.P. 4.5' North of South end.
West 23.60' to 1 1/2" Pipe, apparent North Corner Sections 1 and 2, T18N-R12E
East 2624.98' to L-13, South 1/4 Corner Section 36, T19N-R12E
West 2640.00' to J-13, South 1/4 Corner Section 35, T19N-R12E

Signed by Russell L. Brown
Surveyor's Michigan License No. 24588

Date Dec. 27, 1999

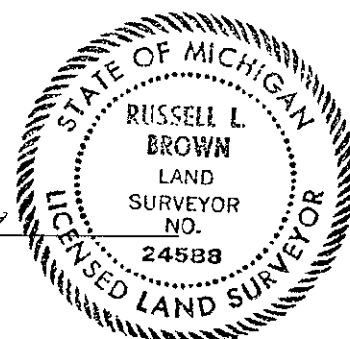

Peer group approved at meeting held 12-27-99, RLB