

FILED

RECORDATION

NOV 15 1994

LAND CORNER RECORDATION CERTIFICATE  
Filing Requirement of Act 74, Mich. P.A. 1970

JUL 6 8 17 AM '94

For corners in  
INGHAM

(County)

Located In:

Corner Code #1

ALALEDON TOWNSHIP

1. Public Land Survey

T 3N R 1W

K-10

2. Property Controlling  
In Section

S T R

3. Miscellaneous

S T R

Property in Sec.

S T R

REGISTER OF DEEDS  
INGHAM COUNTY, MICH.

Register of Deeds Stamp &amp; File Number

4. Lot No. , Recorded Plat

5. Private Claims

I, DAVID R. LOHR, in a field survey on APRIL 29, 1994, do hereby certify that under requirements of P.A. 74, Michigan P.A. of 1970, the corner points mentioned in lines 1 and 2 above were in conformance with regulations and rules therefore as required in the current manual of survey instructions of the United States Department of the Interior, Bureau of Land Management or by a decree of a Court of Law and/or that the corner points mentioned in lines 3, 4 and 5 above were in conformance with the rules of the Michigan Board of Land Surveyors or by a Decree of a Court of Law; established, re-established, monumented, re-monumented, recovered, found as expressed below:

NOTE: Not more than 4 corners, all in the same town and range, may be recorded on this certificate.

A. Description of original monument and accessories and/or subsequent restoration:

K-10

1. POST SET BY MUSGROVE EVANS IN DECEMBER 1826, WITNESSED BY:  
IRONWOOD 4" SOUTH 8 DEGREES EAST 7 LINKS (4.62')  
BEECH 16" SOUTH 61 DEGREES WEST 36 LINKS (23.76')

2. A. JACKSON, COUNTY SURVEYOR 1842 SURVEY RECORDED IN VOL. 4, PG. 62, USES SAME GLO WITNESSES

CONTINUED ON BACK

B. Description of corner evidence found and/or method applied in restoring or reestablishing corner:

K-10: VISITED CORNER LOCATION AND FOUND 1/2" IRON IN MON BOX 2.5' NORTH OF FENCE LINE WEST AS PER L4. PG. 74. TRAVERSED SECTION AND FOUND IRON TO BE NEARLY ON LINE AND MIDWAY BETWEEN K-9 AND K-11. ACCEPTED LOCATION OF 1/2" IRON AS CORNER AND SET STANDARD 3/4" x 24" RENON. BAR / PA 345 CAP #30090 IN MON BOX.

C. Description of monument for corner and accessories established to perpetuate locating the position of the corner:

K-10: STANDARD 3/4" x 24" RENON. BAR/PA 345 CAP #30090 IN MON BOX.  
WITNESSED BY:

SET N&amp;T #30090 S/S OF POLE STUMP

AZ. 97 DEG. 37.00'

SET N&amp;T #30090 SE/S OF TW. 12" BL. WALNUT

AZ. 223 DEG. 31.55'

SET N&amp;T #30090 N/S ANCHOR POST

AZ. 266 DEG. 27.98'

SET N&amp;T #30090 NE/S POST

AZ. 304 DEG. 33.03'

BEARING AND DISTANCE TO K-9

AZ. 00-04-33 DEG. 2662.87'

BEARING AND DISTANCE TO K-11

AZ. 180-04-37 DEG. 2663.04'

BEARING AND DISTANCE TO J-10

AZ. 269-52-21 DEG. 2629.06'

Signed by

David R. Lohr

Date JUNE 28, 1994

Surveyor's Michigan License No. 30090

FORM APPROVED BY MICHIGAN STATE

P.A. 345 INGHAM COUNTY

PEER APPROVED 6/8/94 PL

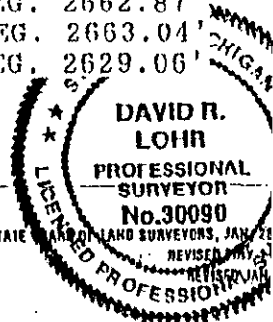

2630

Page 2

K-10 CONTINUED

3. NO OTHER REFERENCES FOUND IN COUNTY SURVEYORS RECORDS
4. L.C.R.C. DONE BY RONNIE LESTER DATED 6/20/77, LIBER 4, PAGE 74,  
"SET WEST 1/4 CORNER MIDWAY AND ON LINE BETWEEN NW CORNER AND SW  
CORNER OF SECTION. CORNER FALLS ON OCCUPATION LINE WEST AND IN  
CENTERLINE OF ROADWAY." WITNESSED BY:  

NAIL AND TAG IN NE	SIDE OF FENCE POST,	NW	33.03'
NAIL AND TAG IN N	SIDE POWER POLE,	WEST	20.82'
NAIL AND TAG IN N	SIDE POWER POLE,	EAST	37.00'
5. RECORDED SURVEY BY A. WILLIAMS, PS #21275, DATED 5/13/78  
LIBER 3 PAGE 404, NO MENTION OF MONUMENT, WITNESSED BY:  

NAIL AND TAG IN NE/S	FENCE POST	NW	33.03'
NAIL AND TAG IN N/S	POWER POLE	WEST	20.82'
NAIL AND TAG IN N/S	POWER POLE	EAST	37.00'
6. RECORDED SURVEY BY JOHN SELLEK, PS #2585, DATED 4/18/80,  
LIBER 4 PAGE 243, STATES, "FD. 1/2" IRON AND CAP"  
WITNESSED SAME AS ABOVE #5
7. RECORDED SURVEY BY GEORGE YOUNG, PS #17640, DATED 4/26/85  
LIBER 4 PAGE 1045, STATES "FD. 1/2" IRON AND CAP"  
WITNESSED AS ABOVE #5
8. RECORDED SURVEY BY RONNIE LESTER, PS #18998, DATED 7/85,  
LIBER 4 PAGE 1048, STATES "FD 1/2" BAR BUT NO WITNESSES LISTED."
9. RECORDED SURVEY BY RONNIE LESTER, DATED 6/22/90,  
LIBER 6 PAGE 238. WITNESSED BY:  

FD N&T IN NE	SIDE FENCE POST	310	DEGREES	Az.	33.1'
FD N&T IN N	SIDE UTILITY POLE	360	DEGREES	Az.	20.8'
SET N&T IN NE	SIDE TWIN 10" WALNUT	228	DEGREES	Az.	31.1'
FD N&T IN N	SIDE UTILITY POLE	19	DEGREES	Az.	36.5'
10. RECORDED SURVEY BY MAURICE MAHIEU, PS #28414, DATED 10/5/91,  
LIBER 6, PAGE 804, STATES "FD. 1" BAR." WITNESSED SAME AS  
ABOVE #9