

DEC 16 1996

COMMISSION

LAND CORNER RECORDATION CERTIFICATE

Liber

9 Page

12

For corners in

Ingham
(County)
Alaiedon Township

Located In:

Corner Code #

FILED

960038957
10/09/1996 15:09:57
REGISTER OF DEEDS
Paula Johnson
INGHAM COUNTY, MI

- | | | | | | |
|------------------------------------|---|-----------|---|-----------|------------|
| 1. Public Land Survey | T | <u>3N</u> | R | <u>1W</u> | <u>L-2</u> |
| | T | | R | | |
| | T | | R | | |
| | T | | R | | |
| 2. Property Controlling in Section | S | | T | | |
| | S | | T | | |
| 3. Miscellaneous | S | | T | | |
| Property in Section | S | | T | | |

Register of Deeds Stamp & File Number

4. Lot No. _____, Recorded Plat _____
5. Private Claims _____

A	B	C	D	E	F	G	H	I	J	K	L
2	5	5	4	3	2						
3											
4	7	8	9	10	11	12					
5											
6	18	17	16	15	14	13					
7											
8	19	20	21	22	23	24					
9											
10	30	29	28	27	26	25					
11											
12	31	32	33	34	35	36					
13											

I, David R. Lohr, in a field survey on Aug. 8, 1996, do hereby certify that under requirements of P.A. 74, Michigan P.A. of 1970, the corner points mentioned in lines 1 and 2 above were in conformance with regulations and rules therefore as required in the current manual of survey instructions of the United States Department of the Interior, Bureau of Land Management or by a decree of a Court of Law and/or that the corner points mentioned in lines 3, 4 and 5 above were in conformance with the rules of the Michigan Board of Professional Surveyors or by a Decree of a Court of Law; established, re-established, monumented, re-monumented, recovered, found as expressed below:

NOTE: Not more than 4 corners, all in the same town and range, may be recorded on this certificate.

A. Description of original monument and accessories and/or subsequent restoration:

- L-2 1. POST NOT SET IN ORIGINAL GOVERNMENT SURVEY.
2. T.J. BROWN, COUNTY SURVEYOR IN AN 1848 SURVEY RECORDED IN VOLUM C, PAGE 17. NO REFERENCE TO MONUMENT, WITNESSED BY:
BEECH, 10", S 1 W 36LKS (23.76')
BEECH, 14", N 52 E, 48LKS (31.68')
SURVEY SHOWS DISTANCE WEST TO K-2 OF 40.13 CH. (2648.58'), AND EAST TO M-2 OF 40.73 CH. (2688.18')
3. A. JACKSON, COUNTY SURVEYOR IN AN 1848 SURVEY RECORDED IN VOL. 2, PAGE 63. MAKES NO REFERENCE TO MONUMENT, SAME WITNESSES AS ABOVE.

CONTINUED ON BACK

B. Description of corner evidence found and/or method applied in restoring or reestablishing corner:

- L-2: EXCAVATED AT APPARENT LOCATION OF CORNER. FOUND CONCRETE MONUMENT/CAP 10" DEEP UNDER 4" OF BIT. PAVING. SET NEW MON BOX OVER CONCRETE COLLAR. ANCHOR POST TO SOUTH WAS RECENTLY REMOVED, FRESH HOLE STILL VISIBLE. ACCEPTED MONUMENT AS THAT DESCRIBED IN ITEM #7 ABOVE

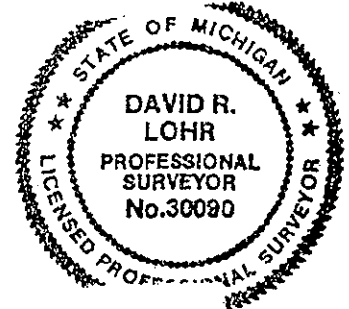

C. Description of monument for corner and accessories established to perpetuate locating the position of the corner:

- L-2: FOUND 4" MONUMENT/CAP, SET NEW MON BOX. 1.5' SOUTH C/L OF BUTTON ROAD. WITNESSED BY:
SET N&T #30090, SE/S 16" CHERRY, AZ., 56 DEG., 38.88'
SET N&T #30090, E/S P. POLE, AZ., 178 DEG., 73.75'
SET N&T #30090, SE/S 24" SHAG HICK., AZ., 245 DEG., 56.75'
SET N&T #30090, SW/S TW. 12" HICK., AZ., 289 DEG., 70.00'
SET N&T #30090, SW/S 18" ELM, AZ., 298 DEG., 57.17'
SET N&T #30090, SW/S 15" ELM, AZ., 321 DEG., 38.80'

Signed by

David R. Lohr

Date

8-22-96

Surveyor's Michigan License No.

30090

FORM APPROVED BY MICHIGAN STATE BOARD OF PROFESSIONAL SURVEYORS, JAN. 28, 1971
REVISED MAY 14, 1975
REVISED JAN., 1983

P.A. 345 INGHAM COUNTY
PEER APPROVED: 8/22/96 M

L-2: ALAIEDON TOWNSHIP, PART A - CONTINUED

4. T.J. BROWN, COUNTY SURVEYOR IN AN 1875 SURVEY RECORDED IN VOLUME 3, PAGE 111. NO REFERENCE TO MONUMENT OR WITNESSES: "STONES APPROPRIATELY MARKED ARE SET FOR THE CORNER OF EACH". SHOWS DISTANCE WEST OF 40.16CH. (2650.56').
5. MDOT FORM 280 CORNER WITNESS CARD DATED MARCH 1967, BY C.E. SMITH, STATES: "FOUND STONE; RAISED WITH 3/4" PIPE. CENTER SEC.1, T3N, R1W, ALAIEDON TWP. INGHAM CO. WITNESSED BY:
- | | | |
|---------|---------|------------------|
| N 70 W, | 69.31', | 13" DBL. HICKORY |
| N 55 E, | 38.96', | 10" CHOKE CHERRY |
| S 05 W | 20.08', | T. POLE |
| S 75 W, | 57.08', | 19" HICKORY |
- SHOWS DISTANCE WEST TO K-2 OF 2658.23'
6. INGHAM COUNTY GRID MAP, NOT DATED SHOWS; 3/4" PIPE (MDOT 1967), SAME WITNESSES AS ABOVE.
7. LCRC BY RONNIE LESTER, PS #18998, DATED 11/02/78, RECORDED IN LIBER 5 PAGE 120, STATES THAT AN EXCAVATION 5' X 5' X 2.5' WAS PERFORMED ON THE CENTERLINE OF BUTTON ROAD ON A FENCE LINE TO THE SOUTH. FOUND A 3/4" X 14" PIPE SURROUNDED BY ORANGE BRICK, +/- 2.0' SOUTH OF THE CENTERLINE OF BUTTON ROAD, ON A FENCE LINE TO THE SOUTH. ACCEPTED PIPE AS CORNER DESCRIBED BY MDOT FORM 280 AND INGHAM COUNTY ROAD COMMISSION RECORDS NOTED ABOVE. MEASURED +/- 2655 WEST TO K-2, IN CLOSE ACCORD TO MDOT FORM 280 DISTANCE. SET 4" X 36" CONCRETE MONUMENT WITH 1/2" X 38" REROD AND CAP #18998, AT LOCATION OF PIPE DESCRIBED ABOVE. WITNESSED BY:
- | | | | |
|---|-----|------------------|------------|
| NW EDGE OF ANGLE IRON ANCHOR POST AT GR. LEVEL, SOUTH, 18.53' | | | |
| N&T #18998 | N/S | 24" HICKORY | WSW 56.66' |
| N&T #18998 | S/S | TWIN 16" HICKORY | WSW 70.00' |
| N&T #18998 | S/S | 16" WILD CHERRY | NE 70.00' |
8. SURVEY #820481, BY FRED N. WHITE, PS #12034, DATED 9/09/82, RECORDED IN LIBER 4, PG. 689, STATES: "CENTER OF SECTION 1, T3N, R1W, LIBER 5, PG. 120", NO MENTION OF MONUMENT OR WITNESSES. SHOWS DISTANCE EAST TO M-2 OF 2661.64'
9. SURVEY #5237, BY DAVID R. LOHR, PS #30090, DATED 7/27/90, RECORDED IN LIBER 6, PAGE 645-653, STATES: "CENTER OF SECTION, LIBER 5, PG. 120" "FD. 1/2" IRON 2 FT. SOUTH C/L BUTTON". WITNESSED BY:
- | | | |
|------------------------|---------|--------|
| FD. N&T 24" HICKORY | S 75 E, | 56.60' |
| FD. N&T 16" CHERRY, | N 50 E, | 38.88' |
| FD. N&T 12" TW. HICK., | N 75 W, | 70.00' |
- SURVEY SHOWS A DISTANCE OF 2658.77 TO K-2, A DISTANCE OF 2525.97 TO L-1, AND A DISTANCE OF 2662.37' TO M-2.
10. UNRECORDED SURVEY #7488, BY DAVID R. LOHR, PS #30090, DATED 11/05/92, SAME DATA AS IN ITEM #9 ABOVE.

