

# LAND CORNER RECORDATION CERTIFICATE

## Filing Requirement of Act 74, Mich. P.A. 1970

1999 IOSCO COUNTY REMONUMENTATION CORNER

For corners IOSCO Located In: \_\_\_\_\_ Corner Code # \_\_\_\_\_

1. Public Land Survey	T <u>24N</u>	R <u>9E</u>	H-3		
	T _____	R _____	_____	_____	_____
	T _____	R _____	_____	_____	_____
	T _____	R _____	_____	_____	_____
2. Property Controlling in Section	S _____	T _____	R _____	_____	_____
	S _____	T _____	R _____	_____	_____
3. Miscellaneous Property in Sec.	S _____	T _____	R _____	_____	_____
	S _____	T _____	R _____	_____	_____
4. Lot No. _____, Recorded Plat _____					
5. Private Claims _____					

99 - 71

STATE OF MICHIGAN  
IOSCO COUNTY  
FILED

22 DEC 99 2:42 P.M.

NINETEEN NINE NINE

Register of Deeds Stamp & File Number

I, WILLIAM E. WOODS P.S., in a field survey on DEC. 10, 1999 do hereby state that under requirements of P.A. 74, Michigan P.A. of 1970, the corner points mentioned in lines 1 and 2 above were in conformance with regulations and rules therefore as required in the current manual of survey instructions of the United States Department of the Interior, Bureau of Land Management or by a decree of a Court of Law and /or that the corner points mentioned in lines 3, 4 and 5 above were in conformance with the rules of the Michigan Board of Land Surveyors or by a Decree of a Court of Law; established, re-established, monumented, recovered, found as expressed below:

	A	B	C	D	E	F	G	H	I	J	K	L	M
1													
2	6	5	4	3	2	1							
3													
4	7	8	9	10	11	12							
5													
6	18	17	16	15	14	13							
7													
8	19	20	21	22	23	24							
9													
10	30	29	28	27	26	25							
11													
12	31	32	33	34	35	36							
13													

**NOTE:** Not more than 2 corners, all in the same town and range, may be recorded on this certificate.

A. Description of original monument and accessories and/or subsequent restoration:

1843: ORIGINAL GOVERNMENT NOTES

SET POST  
WHITE PINE 12° N31°E 28 LKS  
YELLOW PINE 10° S73°W 15 LKS

B. Description of corner evidence found and/or method applied in restoring or reestablishing corner:

SET CORNER BY SINLGE PROPORTIONATE BETWEEN G-3 & I-7

ACCEPTED BY THE IOSCO COUNTY SURVEY BOARD AS THE ORIGINAL CORNER POINT P.A. 345 OF 1932 AT A MEETING HELD ON 10-13-99

*James H. Krueger*

C. Description of monument for corner and accessories established to perpetuate locating the position of the corner:

SET 5/8 REBAR & REMON CAP

- SET NAIL & TAG S30°E 7.84' 10" W. PINE
- SET NAIL & TAG N86°E 26.42' 16" TRIPLE MAPLE
- SET NAIL & TAG N62°E 24.15' 8" OAK
- SET NAIL & TAG N74°W 47.42' P. POLE
- SET NAIL & TAG WEST 23' RD. CENTERLINE

Signed by *William E. Woods* Date 12-15-99  
WILLIAM E. WOODS P.S.

Surveyor's Michigan License No. 25882

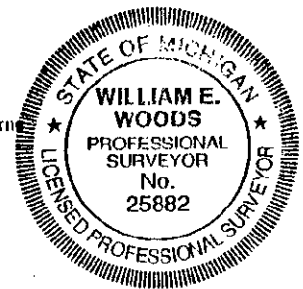

FORM APPROVED BY MICHIGAN STATE BOARD OF PROFESSIONAL SURVEYORS, JAN. 28, 1971  
REVISED MAY 14, 1975  
REVISED JAN., 1983

APR 27 2000

SECTION