

# SURVEY & REMONUMENTATION

JAN 13 1998

SECTION

## LAND CORNER RECORDATION CERTIFICATE Filing Requirement of Act 74, Mich. P.A. 1970

For corners in

Iron	Located In:	Corner Code #
(County)		
1. Public Land Survey	T 44N R 32W	E-6.7a
	T R	#001
	T R	
	T R	
2. Property Controlling in Section	S T R	
	S T R	
3. Miscellaneous Property in Sec.	S T R	
	S T R	

IRON COUNTY  
MICHIGAN  
RECEIVED FOR RECORD

97 DEC 23 PM 1:28

L.C. Records L.7 P. 144

*Gary L. Pisoni*  
REGISTERED DEEDS

Register of Deeds Stamp & File Number

4. Lot No. \_\_\_\_\_, Recorded Plat \_\_\_\_\_  
5. Private Claims \_\_\_\_\_

North Meander Corner Sections 16 and 17, T44N, R32W

I, Gary L. Pisoni, in a field survey on November 13, 1997, do hereby state that under requirements of P.A. 74, Michigan P.A. of 1970, the corner points mentioned in lines 1 and 2 above were in conformance with regulations and rules therefore as required in the current manual of survey instructions of the United States Department of the Interior, Bureau of Land Management or by a decree of a Court of Law and /or that the corner points mentioned in lines 3, 4 and 5 above were in conformance with the rules of the Michigan Board of Land Surveyors or by a Decree of a Court of Law; established, re-established, monumented, recovered, found as expressed below:

NOTE: Not more than 2 corners, all in the same town and range, may be recorded on this certificate.

	A	B	C	D	E	F	G	H	I	J	K	L	M
1													
2	6		5		4		3		2		1		
3													
4	7		8		9		10		11		12		
5													
6	18		17		16		15		14		13		
7													
8	19		20		21		22		23		24		
9													
10	30		29		28		27		26		25		
11													
12	31		32		33		34		35		36		
13													

PEER GROUP APPROVED

*Gary L. Pisoni 12-1-97*  
IRON COUNTY REPRESENTATIVE

A. Description of original monument and accessories and/or subsequent restoration:

Original corner established in 1849 by Zelotes B. Searls, U.S. Deputy Surveyor.

Original Corner; Wood Post

Original Bearing Trees:	Tamarack	12"	N50° E	27 lks. (17.82 feet)
	Cedar	4"	N36° W	30 lks. (19.80 feet)

B. Description of corner evidence found and/or method applied in restoring or reestablishing corner:

No original corner evidence was recovered.

I restored the corner position by single proportionate measurement on the North shore of Light Lake and set a W.C. M.C. on line between the East Quarter Corner of Section 17 and the South Meander Corner between Sections 16 and 17. The monument is located 20 feet from the edge of shore.

Corner record research on file with County Representative.

C. Description of monument for corner and accessories established to perpetuate locating the position of the corner:

At the W.C. M.C. corner position, set a 3/4 inch outside diameter aluminum rod monument, 9 feet long, 6 inches above the ground surface, with a 3 inch diameter aluminum cap stamped as follows; Iron County Remonumentation, T44N, R32W, S17, S16, W.C. M.C., S 00° 12'25"W, 56.74', 1997, RLS 27457. Blazed and scribed the following new bearing trees; (Measurements are taken to a nail in side of tree)

Cedar	6"	N66° E	35.41 feet
Cedar	6"	N42° E	6.56 feet
Cedar	5"	N54° W	36.11 feet
Steel Sign Post		South	0.72 feet
Steel Sign Post		West	0.85 feet

97-39  
Signed by Gary L. Pisoni Date November 29, 1997

Surveyor's Michigan License No. 27457

FORM APPROVED BY MICHIGAN STATE BOARD OF PROFESSIONAL SURVEYORS, JAN. 28, 1971

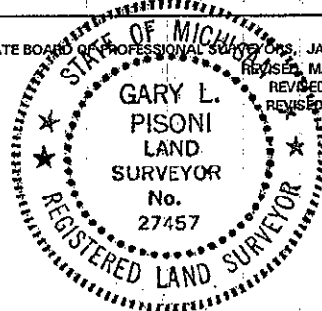

REVISED MAY 14, 1975  
REVISED JAN., 1983  
REVISED OCT., 1995