

SURVEY & REMONUMENTATION

FEB 14 1997

COMMISSION

KENT COUNTY REMONUMENTATION

LAND CORNER RECORDATION CERTIFICATE Filing Requirement of Act 74, Mich. P.A. 1970

other # 6

For corners in
KENT COUNTY

(County)

Located In:

Corner Code #

1. Public Land Survey

T R
T R
T R
T R

#6

2. Property Controlling
in Section

S25 T7N R12W

Wit. Cor. on
E-W 1/4 line

3. Miscellaneous
Property in Sec.

S T R
S T R
S T R

Sec. 25

4. Lot No. , Recorded Plat

5. Private Claims

REG. OF DEEDS

96 AUG -2 AM 8:31

STATE OF MICHIGAN
COUNTY OF KENT
RECEIVED FOR RECORD

9200 A

Register of Deeds Stamp & File Number

	A	B	C	D	E	F	G	H	I	J	K	L	M
1													
2	6		5		4		3		2		1		
3													
4	7		8		9		10		11		12		
5													
6	18		17		16		15		14		13		
7													
8	19		20		21		22		23		24		
9													
10	30		29		28		27		26		25		
11													
12	31		32		33		34		35		36		
13													

Kirk Breitels

in a field survey on July 17, 1996 do hereby state that under requirements of P.A. 74, Michigan P.A. of 1970, the corner points mentioned in lines 1 and 2 above were in conformance with regulations and rules therefore as required in the current manual of survey instructions of the United States Department of the Interior, Bureau of Land Management or by a decree of a Court of Law and/or that the corner points mentioned in lines 3, 4 and 5 above were in conformance with the rules of the Michigan Board of Land Surveyors or by a Decree of a Court of Law; established, re-established, monumented, recovered, found as expressed below:

NOTE: Not more than 2 corners, all in the same town and range, may be recorded on this certificate.

A. Description of original monument and accessories and/or subsequent restoration:

1830 - Nothing set by GLO

1873 - "Converse and Tolford's Addition" in S 1/2 of Sec. 25
Extends C/L Fulton St. and E-W 1/4 line East to Grand River

1883 - "J. W. Converse Replatted Addition" in Gov't. Lots 1 & 2
Extends C/L Fulton St. East to Grand River.

- City of Grand Rapids witness card for C 1/4 corner and various street plans
C 1/4 corner on C/L Fulton St. and it East to Grand River.

B. Description of corner evidence found and/or method applied in restoring or reestablishing corner:

Produced E-W 1/4 line per W 1/4 corner and C 1/4 corner. Said 1/4 line fits C/L Fulton St. (West of the Grand River) per lot corners and occupation in various plats in the NW 1/4 and SW 1/4 of Sec. 25. Extended said E-W 1/4 line East from the C 1/4 corner to the Grand River.

The location is accepted by me and is generally accepted by professional surveyors as the best evidence of the position of the corner (1/4 line).

C. Description of monument for corner and accessories established to perpetuate locating the position of the corner:

Set Standard Kent Co. Witness Mon. on East & West 1/4 line (West of the Grand River) of Sec. 25, being the Easterly extension of the E-W 1/4 line and the C/L Fulton St. (West 1/4 corner through Central 1/4 corner).

NW corner casting 2' x 2' handhole
NE face of light pole (2' above grnd.)

S05°E 44.12'
S60°W 108.06'
N70°W 132.22'
N55°W 92.44'
N45°E 47.78'
S75°E 27.7'

See sketch reverse

Top SE corner brick wall

SE corner GVSU sign base (brick)

SW corner conc. wall (face of bevel)

C/L bridge at W. end of bridge

Signed by Kirk Breitels
Surveyor's Michigan License No. 30077

Date 7/25/96

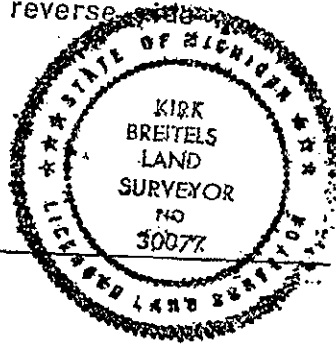

P.A. 345 1990 KENT COUNTY

PEER APPROVED 6/27/96

CHAIRMAN Harry Fisher

9200 B

SURVEY &
REMONUMENTATION
FEB 14 1997
COMMISSION

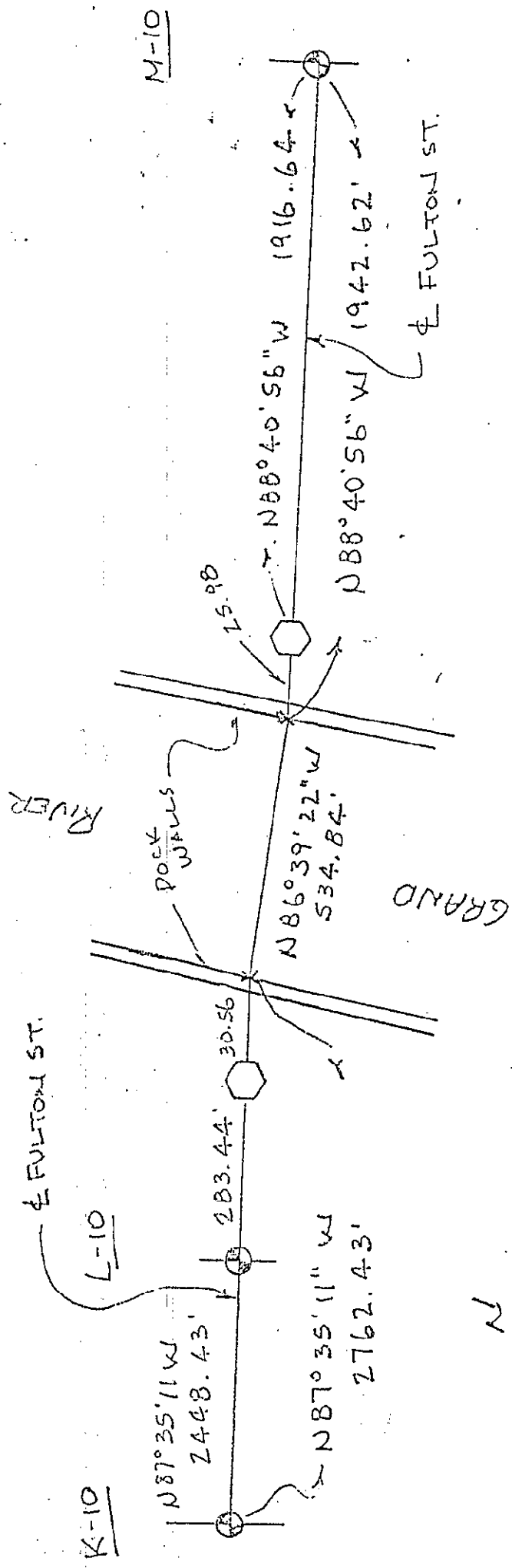

⊗ = KENT CO. MON.
⬡ = KENT. CO. WIT. MON.

EAST-WEST 1/4 LINE
SEC. 25, T7N, R12W

N
No SCALE