

SURVEY & REMONUMENTATION

AUG 31 1999 LAND CORNER RECORDATION CERTIFICATE

FILING REQUIREMENT OF ACT 74, Mich. P.A. 1970

SECTION

For corners in LAKE Located in: Corner Code#

1. Public Land Survey T 19N R 11W G-8

2. Property Controlling in Section S T R

3. Miscellaneous Property in Sec. S T R

4. Lot No. Recorded Plat

5. Private Claims

I, Robert L. Wetherell, in a field survey on June 2 1999, do hereby certify that under requirements of P.A. 74, Michigan P.A. of 1970, the corner points mentioned in lines 1 and 2 above were in conformance with regulations and rules therefore as required in the current manual of survey instructions of the United States Department of the Interior, Bureau of Land Management or by decree of a Court of Law and/or that the corner points mentioned in lines 3, 4, and 5 above were in conformance with the rules of the Michigan Board of Land Surveyors or by a Decree Of a Court of Law; established, re-established, monumented, re-monumented, recovered, found as expressed below:

G-8 - 1/4 CORNER COMMON TO SECTIONS 21 & 22, T19N, R11W

A. Description of original monument and accessories and/or subsequent restoration:

1838- S. SIBLEY, G.L.O.  
#1 - 14" Sugar S36°W 29 Links  
#2 - 10" Hemlock N23°E 19 Links  
Stream running E. & W. is 462' South  
1899 - J.W. Nichoson  
Measured 2593.14' North to  
Section corner

1906 - J.W. Nichoson  
"Old Corner Identified"  
Set Railroad Iron.  
#3 - 14" Hemlock S5-1/2°W 73 Links  
1918- G.H. Johnson, Co. Sur.  
"T" Rail for Monument  
#4 - 4" Maple N56°E 160 Links

1986 - C. Cole, LS 17615  
Found Railroad Iron - 4 feet below road surface. Raised with 1/2" re-rod.  
#5 - 8" W. Pine N78°E 68.50'  
#6 - 7" Hemlock N68°W 74.02'  
#7 - 5" Maple S60°W 83.95'

B. Description of corner evidence found and/or method applied in restoring of reestablishing corner:

I found Cole's 1/2" re-bar over old railroad rail at the intersection of roads West and South. I measured 422 feet South to a Creek running through a culvert approximately 15 feet below road surface. The drainage basin for creek is fairly wide at this location.

Condition of the accessories are as follows: #1 gone, #2 Gone, #3 Gone, #4 Gone, #5 Found in good condition, #6 Found in good condition, #7 Found in good condition.

C. Description of monument for corner and accessories established to perpetuate locating the position of the corner:

I replaced the 1/2" re-bar with a 3/4" x 24" re-bar with Lake County Brass Cap, and is accepted as a careful and faithful re-establishment of the position of the original corner.

16" W. Pine N77°E 68.47' (60d spike in N. side) #5  
9" Hemlock N65°W 73.96' (60d spike in S. side) #6  
6" Maple S62°W 83.85' (60d spike in S. side) #7  
10" W. Pine S48°E 47.59' (60d spike in S.W. side)

RATIFIED BY THE LAKE CO. PEER REVIEW GROUP  
IN ACCORDANCE WITH P.A. 345  
CHAIRMAN Rlw  
DATE 7-20-99

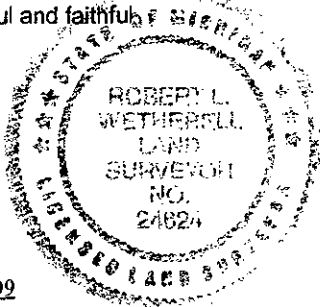

Signed by Robert L. Wetherell

Date July 21, 1999

Surveyor's Michigan License No.