

MICHIGAN
DEPARTMENT OF CONSERVATION
FORESTRY DIVISION

LAND CORNER RECORD

T. 42-43 N.R. 12 W

Mackinac COUNTY

DESCRIPTION OF CORNER Sec. Cor. common to Secs. 2-3-35-34.

CORNER MONUMENT 1" Pipe with 4" Aluminum Cap. 4" Concrete Monument.

DATE MONUMENT PLACED AND WITNESSED 11-10-69

WITNESSES TO CORNER..... 15" Soft Maple (S 3/4 NBT) West 74.5'

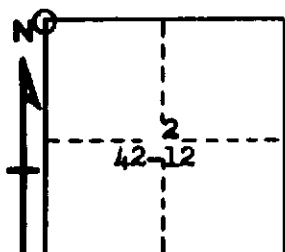

6" Hard Maple (S 3/4 NBT) N53°W 76.3'

AND

CIRCLE CORNER REGISTERED

DESCRIPTION IN DETAIL AS TO HOW CORNER WAS LOCATED AND IDENTIFIED OR RESTORED.

This corner replaced and witnessed as placed by E. A. Sainio,
R.L.S. about 1959.

Distance West to Lake fits well and distance East, one mile
to Sec. Corner fits.
Found no evidence of original corner.

Corner lies 70' West of road.

SURVEYOR'S SEAL

SIGNED Billy D. Buckler DATE 1-12-70
REGISTERED LAND SURVEYOR