

MAR 14 2000

SECTION

LAND CORNER RECORDATION CERTIFICATE  
Filing Requirement of Act 74, Mich. P.A. 1970

STATE OF MICHIGAN  
COUNTY OF MECOSTA  
RECEIVED FOR RECORD

For corners in

Mecosta Located In: Corner Code #  
(County)

1. Public Land Survey T 15 N R 09 W H-7  
T R  
T R  
T R  
T R

2. Property Controlling S T R  
in Section S  
T R

3. Miscellaneous S  
T R  
Property in Sec. S  
T R

'99 DEC 14 P2:23

James Brown  
REGISTER OF DEEDS

Register of Deeds Stamp & File Number

4. Lot No. , Recorded Plat

5. Private Claims

I, James H. Carter, in a field survey in November, 1999 do hereby state that under requirements of P.A. 74, Michigan P.A. of 1970, the corner points mentioned in lines 1 and 2 above were in conformance with regulations and rules therefore as required in the current manual of survey instructions of the United States Department of the Interior, Bureau of Land Management or by a decree of a Court of Law and /or that the corner points mentioned in lines 3, 4 and 5 above were in conformance with the rules of the Michigan Board of Land Surveyors or by a Decree of a Court of Law; established, re-established, monumented, recovered, found as expressed below:

NOTE: Not more than 1 corner, all in the same town and range, may be recorded on this certificate.

A. Description of original monument and accessories and/or subsequent restoration:

Deputy surveyor set 1/4 sec post - Sugar 8 N 07 W 13 and Beech 6 S 80 E 05

1895 - L. W. June - Orgnl cor. Iron for stake

1896 - L. W. June - Old field book, page 88 shows N-S distance from center of section to be 19.73 & 19.73 chains.

1905 - L. W. June - tile corner, and shows distance from center to to be 20.03 & 20.03 chains.

1930 - Old county field book indicates a 2 deg 30 min Rt deflection at 2300' East of the SW cor of sec 15 and calls sight on Sec cor.

1988 - Gerald Gray - LCRC L 2, P 229, Set 1 1/2" iron rod in Centerline of gravel & N-S 1 1/4 line fence extended.  
8" Dogwood - 49.95' - S 60 W, 8" Dogwood - 21.04' - S 10 E, 10" Pine 90.45' - S 75 E.

B. Description of corner evidence found and/or method applied in restoring or reestablishing corner:

Fd 1 1/2" iron in centerline of gravel road.

Fd nail in 16" pine - S 75 E - 90.56', Fd 20" twin maple - S 08 E - 21.31', Fd 16" twin maple - S 80 W - 50.23'

C. Description of monument for corner and accessories established to perpetuate locating the position of the corner:

H-7 - CORNER COMMON TO SECTIONS 15 AND 22, T 15 N, R09W.

SET A STANDARD MECOSTA COUNTY REMONUMENTATION MONUMENT AND IS ACCEPTED AS A CAREFUL AND FAITHFUL RE-ESTABLISHMENT OF THE POSITION OF THE ORIGINAL CORNER.

S 75 E - 90.56' - NAIL & TAG IN 16" PINE OBT

S 08 E - 21.31' - NAIL & TAG IN 20" MAPLE OBT

S 80 W - 50.23' - NAIL & TAG IN 16" TWIN MAPLE OBT

S 81 W - 59.23' - NAIL & TAG IN 17" ELM

Signed by James H. Carter

Date DEC 13, 1999

Surveyor's Michigan License No. 33973

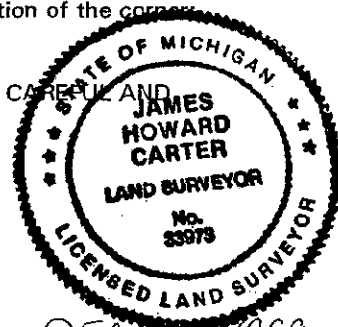

APPROVED BY MECOSTA CO. PEER GROUP  
IN ACCORDANCE WITH P.A. 345 of 1990

REVISED MAY 1975

CHAIRMAN  
DATE

James H. Knapp  
DEC. 3, 1999

FORM APPROVED BY MICHIGAN STATE BOARD OF PROFESSIONAL SURVEYORS

REVISED JAN., 198  
REVISED OCT., 199

LIBER 101 PAGE 271