

LAND CORNER RECORDATION CERTIFICATE
Filing Requirement of Act 74, Mich. P.A. 1970

For corners in
Montcalm County
(County)

Located In:

Corner Code: //

1. Public Land Survey

T 12N R 5W

C-10

T 12N R 5W

C-11

T R

T R

2. Property Controlling
in Section

S T R

S T R

3. Miscellaneous
Property in Sec.

S T R

S T R

Register of Deeds Stamp & File Number

4. Lot No. , Recorded Plat

5. Private Claims

I, Gary C. Bilow, in a field survey on February, 1991, do hereby certify that under requirements of P.A. 74, Michigan P.A. of 1970, the corner points mentioned in lines 1 and 2 above were in conformance with regulations and rules therefore as required in the current manual of survey instructions of the United States Department of the Interior, Bureau of Land Management or by a decree of a Court of Law and/or that the corner points mentioned in lines 3, 4 and 5 above were in conformance with the rules of the Michigan Board of Land Surveyors or by a Decree of a Court of Law; established, re-established, monumented, re-monumented, recovered, found as expressed below:

NOTE: Not more than 4 corners, all in the same town and range, may be recorded on this certificate.

A. Description of original monument and accessories and/or subsequent restoration:

C-10: Corner established by U.S. Gov't Deputy Surveyor J. Hodgson in 1837 - accessories: Beech 10 N78E 32 and Beech 12 N15W 15. County Surveyor F.A. Palmer records in 1884 "found E-W 1/4 line" but no reference to corner. County Surveyor J.F. Daoust records in 1906 "Found stake agreeing with NBT pine stump 36 N2-1/2 W 23." Corner recorded under Act 74, P.A. 1970 in 1975 in Liber 1 Page 217 by H. Fluharty (RLS 18223) as "found 1-1/2" pipe - reset concrete monument - accessories: 26" Oak S45W 4.00', 14" Oak S50W 24.06', 10" Poplar N30W 31.85'."

C-11: Corner established by U.S. Gov't Deputy Surveyor J. Hodgson in 1837 - accessories: Pine 10 S14W 9 and Birch 12 N38E 36. County Surveyor F.A. Palmer recorded in 1882 for NE Corner Section 31 "BT's correct at NE corner." County Surveyor H. M. Calkins recorded in 1904 "found Pine and remarked corner." County Surveyor J.F. Daoust recorded in 1905 "Found stake and both BT's agreeing - drove large cedar stake and took NBT pine 20 N-E 24-1/2 and recovered/recorded same in 1906."

B. Description of corner evidence found and/or method applied in restoring or reestablishing corner:

C-10: Found concrete monument and 2 witnesses - accepted this corner as the best evidence of the original GLO corner.

C-11: Found 1-1/2" iron pipe. Measurements to C-10, D-11, and B-11 consistent and reasonable with County Surveyor Records. Accepted this iron pipe as the best evidence of the original GLO corner.

C. Description of monument for corner and accessories established to perpetuate locating the position of the corner:

C-10: Found Concrete Monument
S69W 4.1', Nail & Michigan Department of
Natural Resources tag in N face 26" Oak
S14E 34.61', N&T in W face 10" Oak
N7W 23.27', N&T in W face 10" Oak
S16W 39.18', N&T in W face twin 16" Oak

C-11: Found 1-1/2" Iron Pipe
N82E 12.08', N&T in 3" Maple
N23E 15.69', N&T in 6" Elm
N42W 27.10', N&T in 6" Elm
S5E 14.44', N&T in 4" Elm

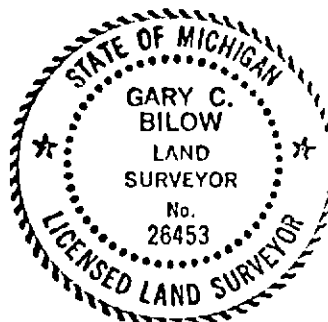

Signed by Gary C. Bilow Date 5/22/91
Surveyor's Michigan License No. 26453