

LAND CORNER RECORDATION CERTIFICATE
Filing Requirement of Act 74, Mich. P.A. 1970 as Amended

For corners in

Menominee (County)	Located In:	Corner Code #
1. Public Land Survey	T _____ R _____ T _____ R _____ T _____ R _____	_____
2. Property Controlling in Section	S 11 T 34N R 29W S 11 T 34N R 29W S _____ T _____ R _____	S in N20aGL S in N20aGL _____
3. Miscellaneous Property in Sec.	S _____ T _____ R _____ S _____ T _____ R _____	_____
4. Lot No. _____, Recorded Plat _____		
5. Private Claims _____		

Register of Deeds Stamp & File Number

A	B	C	D	E	F	G	H	I	J	K	L	M
1												
2	6		5		4		3		2		1	
3												
4	7		8		9		10		11		12	
5												
6	18		17		16		15		14		13	
7												
8	19		20		21		22		23		24	
9												
10	30		29		28		27		26		25	
11												
12	31		32		33		34		35		36	
13												

I, Jeremy J. Pipp, in a field survey on 4/05/2012AD do hereby state that under requirements of P.A. 74, Michigan P.A. of 1970, the corner points mentioned in lines 1 and 2 above were in conformance with regulations and rules therefore as required in the current manual of survey instructions of the United States Department of the Interior, Bureau of Land Management or by a decree of a Court of Law and /or that the corner points mentioned in lines 3, 4 and 5 above were in conformance with the rules of the Michigan Board of Land Surveyors or by a Decree of a Court of Law; established, re-established, monumented, recovered, found as expressed below:

NOTE: Not more than 2 corners, all in the same town and range, may be recorded on this certificate.

A. Description of original monument and accessories and/or subsequent restoration:

(S line N 20ac Gov't Lot [SW]) Point on North-South One-Quarter Line of Section 11 being on the South line of the North 20 Acres of Government Lot 1. Not set in original survey, no evidence of subsequent establishment.

(S line N 20ac Gov't Lot [SE]) Point on East One-Sixteenth Line of Section 11 being on the South line of the North 20 Acres of Government Lot 1. Not set in original survey, no evidence of subsequent establishment.

B. Description of corner evidence found and/or method applied in restoring or reestablishing corner:

(S line N 20ac Gov't Lot [SW]) Established point on North-South One-Quarter Line of Section 11 being on the South line of the North 20 Acres of Government Lot 1.

(S line N 20ac Gov't Lot [SE]) Established point on East One-Sixteenth Line of Section 11 being on the South line of the North 20 Acres of Government Lot 1.

C. Description of monument for corner and accessories established to perpetuate locating the position of the corner:

(S line N 20ac Gov't Lot [SW]) DNR mon
6" Red Maple S57W 31.82' (X,BT)
10" Ash N03W 48.15' (X,BT)
All trees are blazed, scribed, and painted. Measurements are to nail in side of tree, bearings are magnetic.

(S line N 20ac Gov't Lot [SE]) DNR mon
13" Maple N38E 5.55' (X,BT)
9" Maple S82W 18.35' (X,BT)
All trees are blazed, scribed, and painted. Measurements are to nail in side of tree, bearings are magnetic.

Signed by Jeremy J. Pipp
Surveyor's Michigan License No. 50447

For the Michigan Department of Natural Resources

20059

20061

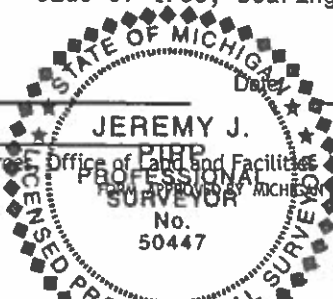

Date July 17, 2012

Office of Land and Facilities
APPROVED BY MICHIGAN STATE BOARD OF PROFESSIONAL SURVEYORS, JAN. 28, 1971

Revised May 14, 1975
Revised Jan., 1983
Revised Oct., 1995