

P.A. of 1990 On 9/25 1996  
Mr. David RLS  
Chairman

LAND CORNER RECORDATION CERTIFICATE  
Filing Requirement of Act 74, Mich. P.A. 1970

For corners in

MENOMINEE

(County)

Located In:

Corner Code #

1. Public Land Survey

T34N R 27W H05  
T R  
T R  
T R  
T R  
S T R  
S T R  
S T R  
S T R

2. Property Controlling  
in Section

3. Miscellaneous  
Property in Sec.

4. Lot No. \_\_\_\_\_, Recorded Plat \_\_\_\_\_  
5. Private Claims \_\_\_\_\_

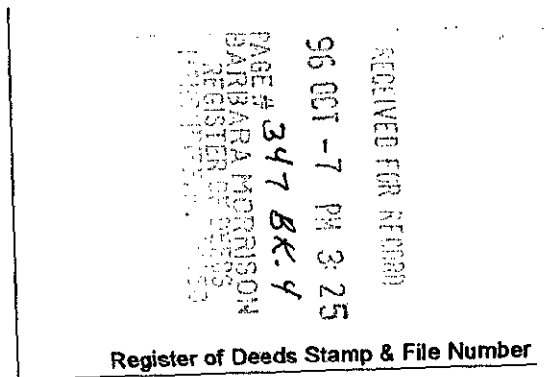

I, William Lenca, in a field survey on Mar. 11, 1996 do hereby state that under requirements of P.A. 74, Michigan P.A. of 1970, the corner points mentioned in lines 1 and 2 above were in conformance with regulations and rules therefore as required in the current manual of survey instructions of the United States Department of the Interior, Bureau of Land Management or by a decree of a Court of Law and/or that the corner points mentioned in lines 3, 4 and 5 above were in conformance with the rules of the Michigan Board of Land Surveyors or by a Decree of a Court of Law; established, re-established, monumented, recovered, found as expressed below:

NOTE: Not more than 2 corners, all in the same town and range, may be recorded on this certificate.

	A	B	C	D	E	F	G	H	I	J	K	L	M
1													
2	6		5		4		3		2		1		
3													
4	7		8		9		10		11		12		
5													
6	18		17		16		15		14		13		
7													
8	19		20		21		22		23		24		
9													
10	30		29		28		27		26		25		
11													
12	31		32		33		34		35		36		
13													

- A. Description of original monument and accessories and/or subsequent restoration:
- 1848: Original Survey by James H. Mullett - B.T.'s - Tamarack, 10" - S70°W - 07 lks.; Tamarack, 10" - S83°E - 08 lks. No original evidence was found for this corner position.
- 1978: CERTIFIED SURVEY NO.s 56 & 57 by George B. Wilson, RLS No. 17607, shows this corner as it relates to other corners in Section 15, T34N-R27W. The corner monument is described as "found axel 30' N. of centerline".

B. Description of corner evidence found and/or method applied in restoring or reestablishing corner:

We found a 1 inch diameter axle shaft 5 feet long in a location matching ties to the Northwest Corner and the Northeast Corner of Section 15, as shown in Certified Surveys 56 and 57. The corner was found approximately 30 feet North of the centerline of an East - West County Road. This corner has been used by local surveyors for 18 years, and is accepted as the best available evidence of the position of the original corner.

- C. Description of monument for corner and accessories established to perpetuate locating the position of the corner:
- Set 2" dia. Aluminum Pipe/3-1/4" dia. Alum. cap stamped for corner location in place of existing axle shaft

5" dia. Cedar	S54°E	14.18 feet	Scr. NBT
10" dia. Cedar	S08°W	104.52 feet	Scr. NBT
5" dia. Cedar	N26°W	17.06 feet	Scr. NBT
Metal Survey Sign Post	North	0.5 feet	

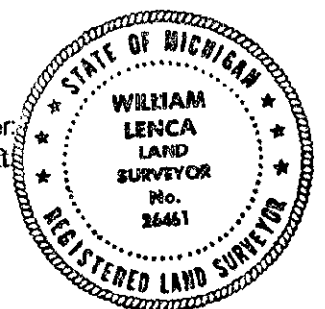

NOTE: All bearings are magnetic bearings. All distances are measured with EDM. Distances to trees are to nail in side of tree.

Signed by William Lenca  
Surveyor's Michigan License No. 26461

Date Mar. 26, 1996