

SURVEY & REMONUMENTATION

FEB 11 1998

Approved by Menominee County
Land Survey Reestablishment
Peer Group Under Act 345 Of
P.A. Of 1930 On 10/31, 1997
Mike Davis RLS
Chairman

LAND CORNER RECORDATION CERTIFICATE Filing Requirement of Act 74, Mich. P.A. 1970

SECTION

For corners in

<u>MENOMINEE</u> (County)	Located In:	Corner Code #
1. Public Land Survey	T <u>34</u> N R <u>27</u> W	E/F-05 (004)
	T ___ R ___	___
	T ___ R ___	___
	T ___ R ___	___
2. Property Controlling in Section	S ___ T ___ R ___	___
	S ___ T ___ R ___	___
3. Miscellaneous Property in Sec.	S ___ T ___ R ___	___
	S ___ T ___ R ___	___
4. Lot No. _____, Recorded Plat _____		
5. Private Claims _____		

97 NOV 21 PM 3:20
STATE OF MICHIGAN
REGISTERED LAND SURVEYOR
No. 26461

Register of Deeds Stamp & File Number

A	B	C	D	E	F	G	H	I	J	K	L	M
1												
2	6	5	4	3	2	1						
3												
4	7	8	9	10	11	12						
5												
6	18	17	16	15	14	13						
7												
8	19	20	21	22	23	24						
9												
10	30	29	28	27	26	25						
11												
12	31	32	33	34	35	36						
13												

I, William Lenca, in a field survey on June 09, 1997 do hereby state that under requirements of P.A. 74, Michigan P.A. of 1970, the corner points mentioned in lines 1 and 2 above were in conformance with regulations and rules therefore as required in the current manual of survey instructions of the United States Department of the Interior, Bureau of Land Management or by a decree of a Court of Law and/or that the corner points mentioned in lines 3, 4 and 5 above were in conformance with the rules of the Michigan Board of Land Surveyors or by a Decree of a Court of Law; established, re-established, monumented, recovered, found as expressed below:

NOTE: Not more than 2 corners, all in the same town and range, may be recorded on this certificate.

A. Description of original monument and accessories and/or subsequent restoration:

1848: Original Survey by James H. Mullett - B.T.'s - Aspen, 6" - N41°E - 62 lks.; Aspen, 12" - S84°E - 85 lks. All original evidence for this corner has been destroyed by ice shoves and shore line erosion.

B. Description of corner evidence found and/or method applied in restoring or reestablishing corner:

We re-established this corner by projecting a line between corners G-5 and F-5 West to the river. The distance from Corner F-5 (S1/4 Corner of Section 9) to the Meander Corner is 232.2 feet compared to 2.0 Chains (132 feet) GLO record. The terrain drops sharply to a low swampy area which may have been flooded at the time of the original survey. We accepted the straight line position on the present bank of the Menominee River as the best available evidence of the position of the original corner.

C. Description of monument for corner and accessories established to perpetuate locating the position of the corner:
Set 2" dia. Aluminum Pipe/3-1/4" dia. Alum. cap stamped for corner location:

18" dia. Maple	N22°E	10.97 feet	Scr. NBT
9" dia. Maple	N87°E	8.53 feet	Scr. NBT
14" dia. Maple	S47°W	7.92 feet	Scr. NBT
7" dia. Maple	N50°W	7.88 feet	Scr. NBT
Survey Sign Post	North	0.9 feet	
Menominee River Bank	West	15.0 feet	

NOTE: All bearings are magnetic bearings. All distances are measured with steel tape. Distances to trees are to nail in side of tree.

Signed by William Lenca
Surveyor's Michigan License No. 26461

Date Oct. 07, 1997

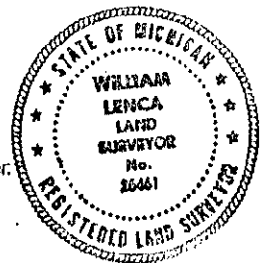

552