

MAR 29 2000

SECTION

LAND CORNER RECORDATION CERTIFICATE
Filing Requirement of Act 74, Mich. P.A. 1970

Approved by Menominee County
Land Survey Remonumentation
Plan Group Under Act 245 of
P.A. of 1990 On 12/28 1999
McDani RLS
Chairman

For corners in

MENOMINEE

(County)

Located In:

Corner Code #

1. Public Land Survey

T 35NR 28W J/K - 13 (001)

T R
T R
T R
T R
S T R
S T R
S T R
S T R

2. Property Controlling
in Section

3. Miscellaneous
Property in Sec.

BK. 6 Pg. 74

RECEIVED FOR RECORD
28 DEC 1999 3:56:09 PM
BARBARA MORRISON
REGISTER OF DEEDS
MENOMINEE, MI 49858

Register of Deeds Stamp & File Number

4. Lot No. _____, Recorded Plat _____

5. Private Claims _____

SAME AS CORNER J/K - 1 T34N - R28W (001)

I, William Lenca, in a field survey on Dec., 19 99 do hereby state that under requirements of P.A. 74, Michigan P.A. of 1970, the corner points mentioned in lines 1 and 2 above were in conformance with regulations and rules therefore as required in the current manual of survey instructions of the United States Department of the Interior, Bureau of Land Management or by a decree of a Court of Law and/or that the corner points mentioned in lines 3, 4 and 5 above were in conformance with the rules of the Michigan Board of Land Surveyors or by a Decree of a Court of Law; established, re-established, monumented, recovered, found as expressed below:

NOTE: Not more than 2 corners, all in the same town and range, may be recorded on this certificate.

	A	B	C	D	E	F	G	H	I	J	K	L	M
1													
2	6		5		4		3		2		1		
3													
4	7		8		9		10		11		12		
5													
6	18		17		16		15		14		13		
7													
8	19		20		21		22		23		24		
9													
10	30		29		28		27		26		25		
11													
12	31		32		33		34		35		36		
13													

A. Description of original monument and accessories and/or subsequent restoration:

1848: Original Survey by H. Brevoort - B.T.'s - Lynn, 12" - S70°W - 18 lks.; Ironwood, 8" - N51°W - 25 lks. All original evidence for this corner has been destroyed by river erosion and ice jams.

B. Description of corner evidence found and/or method applied in restoring or reestablishing corner:

We recovered a 5/8 inch diameter iron rod on the high bank of the Menominee River in line with an ancient fence running West. The line running West has been monumented with 5/8 inch diameter iron rods at steel fence posts on a straight line between the iron at the Menominee River and the SW Corner of Section 35. This corner has been accepted by land owners and used by local surveyors for several years, and is accepted as the best available evidence of the position of the original corner.

C. Description of monument for corner and accessories established to perpetuate locating the position of the corner:

Set 2" dia. Aluminum Pipe 30" long/3-1/4" dia. Alum.cap stamped for corner location:

12" dia. White Ash	N37°E	55.60 feet	Scr. NBT
14" dia. Oak	S55°W	45.26 feet	Scr. NBT
15 dia. White Ash	N45°W	53.08 feet	Scr. NBT
12" dia. White Ash	N05°W	25.32 feet	Scr. NBT
Metal Survey Sign Post	S40°E	0.8 feet	
Menominee River	East	15' +/-	

NOTE: All bearings are magnetic bearings. All distances are measured with steel tape. Distances to trees are to nail in side of tree.

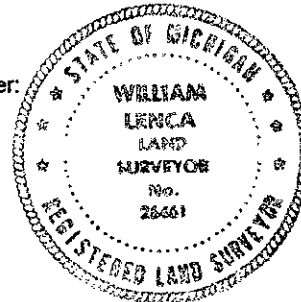

Signed by William Lenca 26461

Date Dec. 17, 1998

Surveyor's Michigan License No. _____