

FEB 11 1998

Approved by Menominee County
Land Survey Remonumentation
Peer Group Under Act 345 Of
P.A. Of 1990 On 10/31 199 7
Mike Davis RLS
Chairman

LAND CORNER RECORDATION CERTIFICATE
Filing Requirement of Act 74, Mich. P.A. 1970

SECTION For corner in

MENOMINEE

Located In:

Corner Code #

- ## 1. Public Land Survey

T36N R. 27W

B-11

- ## 2. Property Controlling in Section

S _____ T _____ R _____

3. Miscellaneous
Property in Sec.

S T R

4. Lot No. _____, Recorded Plat _____
5. Private Claims _____

I, William Lenca, in a field survey on Sept 24, 1997 do hereby state that under requirements of P.A. 74, Michigan P.A. of 1970, the corner points mentioned in lines 1 and 2 above were in conformance with regulations and rules therefore as required in the current manual of survey instructions of the United States Department of the Interior, Bureau of Land Management or by a decree of a Court of Law and/or that the corner points mentioned in lines 3, 4 and 5 above were in conformance with the rules of the Michigan Board of Land Surveyors or by a Decree of a Court of Law; established, re-established, monumented, recovered, found as expressed below:

NOTE: Not more than 2 corners, all in the same town and range, may be recorded on this certificate.

[illegible]

- A. Description of original monument and accessories and/or subsequent restoration:

1852: Original Survey by Francis Coleman - B.T.'s - Aspen, 8" - N70°E - 110 lks.; W. Birch, 12" - S83°E - 94 lks. All original evidence for this corner has been destroyed by farming & clearing activities.

- B. Description of corner evidence found and/or method applied in restoring or reestablishing corner:

After a careful search of the corner area, we found no evidence of the original corner accessories, or evidence of subsequent restoration. We set the corner at the intersection of ancient fences running north and east. This position matches well with the East 1/16 fence and fits very well with ancient fences within Section 31. We accepted this location as the best available evidence of the position of the original corner.

- C. Description of monument for corner and accessories established to perpetuate locating the position of the corner:
Sct 5/8" x 36" Iron Rod/3-1/4" dia. Alum. cap stamped for corner location;

18" dia. Maple	N86°E	4.78 feet	Scr. NBT
18" dia. Maple	S11°W	30.32 feet	Scr. NBT
16" dia. White Pine	S68°W	33.07 feet	Scr. NBT
5" dia. Maple	N18°W	29.44 feet	Scr. NBT
Metal Survey Sign Post	South	2.0 feet	

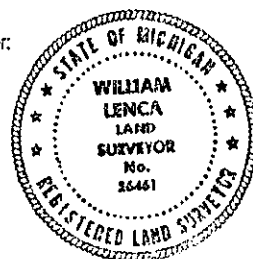

NOTE: All bearings are magnetic bearings. All distances are measured with steel tape. Distances to trees are to nail in side of tree.

Signed by William J. Jura
Surveyor's Michigan License No. 26461

Date Oct. 13, 1997