

APR 06 1999

Approved by Menominee County  
Land Survey Remonumentation  
Peer Group Under Act 345 Of

P.A. Of 1990 On 6/26/98  
Mr. David RLS  
Chairman

SECTION

LAND CORNER RECORDATION CERTIFICATE  
Filing Requirement of Act 74, Mich. P.A. 1970

For corners in

MENOMINEE  
(County)

Located In:

Corner Code #

1. Public Land Survey

T 36NR 27W A-04

T   R   

T   R   

T   R   

2. Property Controlling  
in Section

S   T   R   

S   T   R   

3. Miscellaneous  
Property in Sec.

S   T   R   

S   T   R   

RECEIVED FOR RECORD  
98 DEC -4 PM 3:48  
PAGE # 648  
BARBARA MORRISON  
REGISTER OF DEEDS  
MENOMINEE, MI 49858

Register of Deeds Stamp & File Number

4. Lot No.   , Recorded Plat   

5. Private Claims   

(SAME AS CORNER M-04 T36N - R28W)

I, William Lenca, in a field survey on June 01, 19 98 do hereby state that under requirements of P.A. 74, Michigan P.A. of 1970, the corner points mentioned in lines 1 and 2 above were in conformance with regulations and rules therefore as required in the current manual of survey instructions of the United States Department of the Interior, Bureau of Land Management or by a decree of a Court of Law and /or that the corner points mentioned in lines 3, 4 and 5 above were in conformance with the rules of the Michigan Board of Land Surveyors or by a Decree of a Court of Law; established, re-established, monumented, recovered, found as expressed below:

NOTE: Not more than 2 corners, all in the same town and range, may be recorded on this certificate.

A. Description of original monument and accessories and/or subsequent restoration:

1848: Original Survey by H. Brevoort, Jr. - B.T.'s - Beech, 6" - N08°W - 34 lks.; Beech, 4" - S51°W - 41 lks. All original evidence for this corner has been destroyed by road construction and farming activities.

B. Description of corner evidence found and/or method applied in restoring or reestablishing corner:

We set this corner on a straight line between the Northwest and Southwest Corners of Section 7, T36N - R27W and in line with ancient fences to the East and West. The corner was placed 6" below the West wheel track of a dirt road. This position fits existing lines of occupation and is accepted as the best available evidence of the position of the original corner.

C. Description of monument for corner and accessories established to perpetuate locating the position of the corner:

Set 2" dia. Aluminum Pipe/3-1/4" dia. Alum cap stamped for corner location:

5/8" x 24" Iron Rod/2" dia. Alum. cap marked "WITNESS MARKER"	N72°E	10.21 feet	0.5' N. of Gate Post
12" dia. Twin Maples (West Tree)	S40°E	82.60 feet	Scr. NBT
5/8" x 24" Iron Rod/2" dia. Alum. cap marked "WITNESS MARKER"	S88°W	6.68 feet	@ Sign Post
Metal Survey Sign Post	S88°W	7.03 feet	

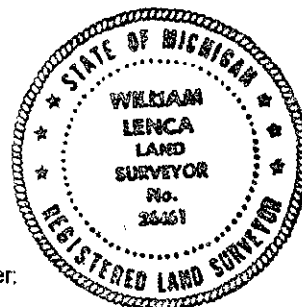

NOTE: All bearings are magnetic bearings. All distances are measured with steel tape. Distances to trees are to nail in side of tree.

Signed by William Lenca  
Surveyor's Michigan License No. 26461

Date June 22, 1998