

P.A. Of 1990 On 12/22, 19995

LAND CORNER RECORDATION CERTIFICATE
Filing Requirement of Act 74, Mich. P.A. 1970

Mike Sawki RLS
Chairman

For corners in

MENOMINEE

(County)

Located In:

Corner Code #

1. Public Land Survey

T37N R 25W

F-9

T R

T R

T R

2. Property Controlling
In Section

S T R

S T R

3. Miscellaneous
Property in Sec.

S T R

S T R

4. Lot No. _____, Recorded Plat _____

5. Private Claims _____

I, William Lenca, in a field survey on Nov. 10, 1995 do hereby state that under requirements of P.A. 74, Michigan P.A. of 1970, the corner points mentioned in lines 1 and 2 above were in conformance with regulations and rules therefore as required in the current manual of survey instructions of the United States Department of the Interior, Bureau of Land Management or by a decree of a Court of Law and/or that the corner points mentioned in lines 3, 4 and 5 above were in conformance with the rules of the Michigan Board of Land Surveyors or by a Decree of a Court of Law; established, re-established, monumented, recovered, found as expressed below:

NOTE: Not more than 2 corners, all in the same town and range, may be recorded on this certificate.

RECEIVED FOR RECORD
95 DEC 27 PM 3:31
PAGE # 301 BR4
BUREAU OF LAND MANAGEMENT
REGISTERED DEEDS
SECTION 17, T37N
R25W

Register of Deeds Stamp & File Number

	A	B	C	D	E	F	G	H	I	J	K	L
1												
2	6		5		4		3		2		1	
3												
4	7		8		9		10		11		12	
5												
6	18		17		16		15		14		13	
7												
8	19		20		21		22		23		24	
9												
10	30		29		28		27		26		25	
11												
12	31		32		33		34		35		36	
13												

A. Description of original monument and accessories and/or subsequent restoration:

- 1852: Original Survey by George Adair - B.T.'s - Beech, 7" - N40°W - 55 lks; Beech, 8" - S48°E - 59 lks . All original evidence for this corner has been destroyed by county road improvements.
- 1985: L.C.R.C. No. 693 by George B. Wilson, RLS No. 17607, has a diagram on the back side of the sheet showing a subdivision of Section 21, T37N-R25W. This particular corner monument is not described, and no ties are given.
- 1988: L.C.R.C. No. 807, recorded by Edward Kazianka, RLS No. 14765. He finds a 1/2" re-rod and states that "This corner is shown on sketch of survey by George B. Wilson on the Corner Report recorded on Sept. 12, 1985." TIES: Power Pole - S27E - 31.04'; Maple, 20" - S69W - 48.36'; Maple, 9" - N10E - 62.72'.

B. Description of corner evidence found and/or method applied in restoring or reestablishing corner:

In our 1995 Remonumentation Survey in T37N-R25W, we recovered a 1/2 inch diameter re-rod and ties as described in L.C.R.C. No. 807 (see part "A"). Although Wilson never describes this corner monument, it is typical of the type of iron monument he used, and it agrees with his recorded distances to corners North and East of this location as shown in the diagram on L.C.R.C. No. 693. The corner falls in the centerline of an East - West County Road, and in line with ancient fences running North and South from this location, and is accepted as the best available evidence of the position of the original corner.

C. Description of monument for corner and accessories established to perpetuate locating the position of the corner:

Accepted 1/2" dia. Re-rod - set 3-1/4" dia. Alum cap stamped for corner location:

12" dia. Maple	N52°E	85.60 feet	Scr. NBT
9" dia. Maple	S51°E	42.23 feet	Scr. NBT
24" dia. Maple - Existing NBT	S69°W	47.83 feet	Scr. NBT
5/8" x 24" Iron Rod/2" dia. Alum. cap marked "WITNESS MARKER"	North	38.52 feet	
Metal Survey Sign Post	North	38.9 feet	

NOTE: All bearings are magnetic bearings. All distances are measured with EDM. Distances to trees are to nail in side of tree.

Signed by William Lenca
Surveyor's Michigan License No. 26461

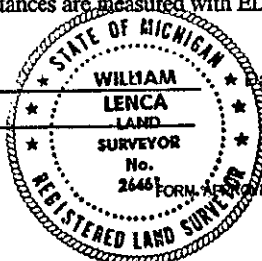

Date Dec. 13, 1995