

LAND CORNER RECORDATION CERTIFICATE  
Filing Requirement of Act 74, Mich. P.A. 1970

For corners in

MENOMINEE  
(County)

Located In:

Corner Code #

1. Public Land Survey

T38N R 25W

E-11

2. Property Controlling  
in Section

S

T

R

3. Miscellaneous  
Property in Sec.

S

T

R

4. Lot No. \_\_\_\_\_, Recorded Plat \_\_\_\_\_

5. Private Claims \_\_\_\_\_

I, William Lenca, in a field survey on May 19, 19 97 do hereby state that under requirements of P.A. 74, Michigan P.A. of 1970, the corner points mentioned in lines 1 and 2 above were in conformance with regulations and rules therefore as required in the current manual of survey instructions of the United States Department of the Interior, Bureau of Land Management or by a decree of a Court of Law and/or that the corner points mentioned in lines 3, 4 and 5 above were in conformance with the rules of the Michigan Board of Land Surveyors or by a Decree of a Court of Law; established, re-established, monumented, recovered, found as expressed below:

NOTE: Not more than 2 corners, all in the same town and range, may be recorded on this certificate.

A. Description of original monument and accessories and/or subsequent restoration:

1852: Original Survey by George Adair - B.T.'s - Sugar, 12" - N53°E - 46 lks.; Cedar, 12" - S39°W - 27 lks. All original evidence for this corner has been destroyed by flooding and ice jams on the Big Cedar River.

B. Description of corner evidence found and/or method applied in restoring or reestablishing corner:

We re-established this corner on an ancient fence line running East - West, and at a single proportional location between the N1/4 Corner (D-11) of Section 32 and the Northeast Corner (G-11) of Section 33, T38N-R25W. (Note - no corner evidence was found at the N1/4 Corner (F-11) of Section 33). This position fits well with GLO calls to the top of a 40' ridge 5.58 chains East and the Big Cedar River, 1.63 chains West, and is accepted as the best available evidence of the position of the original corner.

C. Description of monument for corner and accessories established to perpetuate locating the position of the corner:  
Set 2" dia. Aluminum Pipe 30" long/3-1/4" dia. Alum cap stamped for corner location:

9" dia. Cedar	N48°E	21.17 feet	Scr. NBT
8" dia. Maple	S46°E	34.64 feet	Scr. NBT
20" dia. Cedar	S62°W	35.46 feet	Scr. NBT
6" dia. White Ash	N50°W	18.15 feet	Scr. NBT
Metal Survey Sign Post	North	1.0 feet	

NOTE: All bearings are magnetic bearings. All distances are measured with steel tape. Distances to trees are to nail in side of tree.

Signed by William Lenca  
Surveyor's Michigan License No. 26461

June 06, 1997

Date \_\_\_\_\_

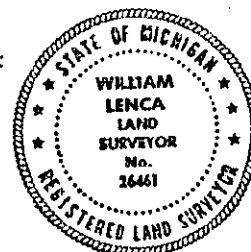

REMONUMENTATION

509

DEC 2 1997

COMMISSION