

SURVEY & REMONUMENTATION

Montmorency County Remonumentation

FEB 06 1998

LAND CORNER RECORDATION CERTIFICATE

Filing Requirement of Act 74, Mich. P.A. 1970

For corners in **SECTION**

Liber **00012** Page **0270**

MONTMORENCY (County) Located In: **ALBERT TWP.** Corner Code **#**
 1. Public Land Survey T 29N R 1E **K-11 as Related to Ref. Mon. 4 East 4 3 South**
 2. Property Controlling in Section S _____ T _____ R _____
 3. Miscellaneous Property in Sec. S _____ T _____ R _____

STATE OF MICHIGAN
MONTMORENCY COUNTY
Recorded & Filed

11-12-1997 09:41:05

A. PANGAN-MCELROY
REGISTER OF DEEDS
Register of Deeds Stamp & File Number

4. Lot No. _____, Recorded Plat _____
 5. Private Claims _____

I, **FREDERICK J. KING**, in a field survey on June 9, 1997, do hereby certify that under requirements of P.A. 74, Michigan P.A. of 1970, the corner points mentioned in lines 1 and 2 above were in conformance with regulations and rules therefore as required in the current manual of survey instructions of the United States Department of the Interior, Bureau of Land Management or by a decree of a Court of Law and/or that the corner points mentioned in lines 3, 4 and 5 above were in conformance with the rules of the Michigan Board of Land Surveyors or by a Decree of a Court of Law; established, re-established, monumented, re-monumented, recovered, found as expressed below:

NOTE: Not more than 4 corners, all in the same town and range, may be recorded on this certificate.

A. Description of original monument and accessories and/or subsequent restoration:

- K-11 - CORNER COMMON TO SECTIONS 25, 26, 35 & 36**
 June 1840 - ORIGINAL CORNER IN LAKE - Ref Post to South of Cor, Set by L. Clason, D.S. - Set 9.44 Ch S of Corner (623.04') S85E-26 1k(17.16') 8" Aspen * N69E-45 1k(29.70') 8" Aspen
 Ref Post to East of Cor, Set by L. Clason, D.S. (Pg 355) - Set 2.30 Ch East of Corner (151.8') S45E-43 1k(28.38) Spr Pine.
 Feb 1936 - "SUPERVISOR'S PLAT OF A SUB. OF GOV. LOT 1 OF SEC. 35, T29N-R1E" by F.N. Smith, PS #754
 Rec. L. 1, Pg. 33 Shows Mon as Ref. Post between Sec 35 & 36 to be NE Cor of Plat - No Wit.
 Aug 1949 - Field Notes by F.N. Smith, PS #754 - Ref. Post for Wolf Lake Established Equistant from N & S Sec. Corners
 S51E-38.9'-7" Aspen * S13E-19.2'- W Pine Stmp * N73E-38.9'-Y Pine Stmp.
 Apr 1968 - Sec Division by N.C. Caldwell, PS #12018 - Reference Corner Sec 25 & 26 - Fnd Rec 1/2" Bar & 1" Pipe 173.4' East
 Not Recorded of Cor Common to Sec. 25, 26, 35 & 36 * S15W-38.75'-7" N. Pine *
 N73E-52.2'-N.P. Stmp * S13E-19.2'-W.P. Stmp * S45E-82.75'-15" N. Pine
 Apr. 1968 - Act 132 by N.C. Caldwell, PS #12018 - No Cor Desc - No Wit - Not Recorded
 June 1972 - Act 132 by G.D. Henning, PS #2040(R-L.2,P.315) Shows Ref. Post - Sec 25 & 36, to be 2487.4' W of Corner L-11 - No Wit
 Oct 1994 - Act 132 by F.J. King, PS #25852 - Shows Ref. Cor, Sec 25 & 36 as Fnd Pipe (C-173.46' E of K-11)(R-173.4')
 Rec. L. 4, Pg. 219 (Meas 2486.24' W of L-11 (R-2487.4'))
 Shows Conc Mon Fnd @ NE Cor of "SUPERVISORS PLAT GVMT LOT 1" - Sec 35 to be Calc as being 324.11' South of K-11
 Oct 1994 - Act 132 by F.J. King, PS #25852 - Fnd Rec Pipe @ Ref. Post Sec 25 & 36, 173.46' E of K-11 IN WATER - Set
 1/2" Iron & Cap #25852 - 40.20' East of Pipe on Dry Land - ALSO Mon to S on Sec Line 35 & 36 at 324.11' S of K-11
 Rec. L. 4, Pgs. 217-218
 Apr. 1996 - Act 132 by F.J. King, PS #25852 - Fnd Rec Pipe on Sec Line Sec 25 & 36 - 173.46' E of Cor K-11 - No Wit
 Rec. L. 4, Pg. 348

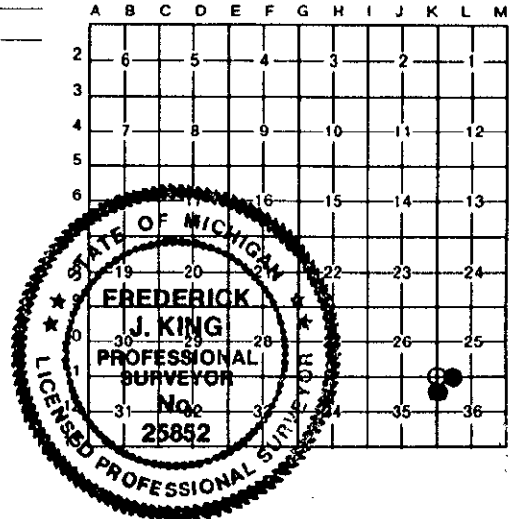

B. Description of corner evidence found and/or method applied in restoring or reestablishing corner:

- K-11 - CORNER COMMON TO SECTIONS 25, 26, 35 & 36 - CORNER IN BIG WOLF LAKE**
 FOUND REF. CORNER OF RECORD ON SEC. LINE 25 & 36 - FOUND PIPE - 173.46'(R-173.4') E of K-11 AND 1/2" Iron & Cap
 #25852 40.20' East of Fnd Pipe - Record Witnesses Found - NONE - Meas. 2486.24' from Fnd Pipe to L-11 (R-2487.4')
 Found REF. Cor of Record on Sec Line 35 & 36 - Found Conc Mon - Calc 324.11' S of K-11 - Rec 324.1' by N.C.
 Caldwell on 1968 Sec. Div. - RECORD WITNESSES FOUND - NONE

This Corner Approved by County Peer Review on June 20, 1997, as a careful and faithful establishment of the position of the corner, as Related to the Reference Monuments.

C. Description of monument for corner and accessories established to perpetuate locating the position of the corner:

- K-11 - CORNER COMMON TO SECTIONS 25, 26, 35 & 36 - CORNER IS NOW UNDER WATERS OF "BIG WOLF LAKE" -3S. Ref. Placed County Re-Mon Cap on Found Conc Mon on S shore of Lake at the NE Cor of "SUPERVISOR'S PLAT OF A SUB OF GOVT LOT 1, Sec. 35 (Liber 1 of Plats, Page 33) * N55E - 55.14' - Set S&T on NW side of 18" W. Pine * S80E - 20.56' - Set S&T on N side of 24" W. Pine * S25E - 17.49' - Set S&T on W side of 12" W. Pine * S50W - 7.50' - Set S&T on NW side of 6" W. Pine N20°22'E - 324.11'(R-324.1') - CORNER K-11, Set by N.C. Caldwell, in 1968.**
3E. Ref. - SET CONC MON & COUNTY RE-MON CAP @ FND F.J. KING I&C - 1.5' S of Chain Fence * N55E - 15.27' - Set S&T on SE side of 10" W. Pine * S55E - 39.90' - Set S&T on NE side of 10" W. Pine * S05W - 9.46' - Set S&T on W side of 10" W. Pine * S55W - 36.45' - Set S&T on NW side of 8" Maple * WEST - 40.20' - Fnd Rec 1/2" Iron & 1/2" Pipe in Water (N.C. Caldwell Ref. Pt.) * N88°24'25"W - 213.66' - CORNER K-11, Set by N.C. Caldwell in 1968

APPROVED BY PEER GROUP

Signed by *Frederick J. King*

Date *Nov. 6, 1997*

Surveyor's Michigan License No. **25852**

JUN 20 97

J.H.B.