

Montmorency County Remonumentation

Liber 00012 Page 0182

LAND CORNER RECORDATION CERTIFICATE

Filing Requirement of Act 74, Mich. P.A. 1970

For corners in

MONTMORENCY
(County)

Located In:
AVERY TWP.

Corner Code -#

STATE OF MICHIGAN
MONTMORENCY COUNTY
Recorded & Filed

11-21-1995 13:22:50

A. PANGAN-MCELROY
REGISTER OF DEEDS

Register of Deeds Stamp & File Number

1. Public Land Survey T 30N R 3E G-13
T R
T R
T R
2. Property Controlling S T R
in Section S T R
3. Miscellaneous S T R
Property in Sec. S T R
4. Lot No. , Recorded Plat
5. Private Claims

I, DONALD E MARLATT, in a field survey on 4-2, 19 95, do hereby certify that under requirements of P.A. 74, Michigan P.A. of 1970, the corner points mentioned in lines 1 and 2 above were in conformance with regulations and rules therefore as required in the current manual of survey instructions of the United States Department of the Interior, Bureau of Land Management or by a decree of a Court of Law and/or that the corner points mentioned in lines 3, 4 and 5 above were in conformance with the rules of the Michigan Board of Land Surveyors or by a Decree of a Court of Law; established, re-established, monumented, re-monumented, recovered, found as expressed below:

NOTE: Not more than 4 corners, all in the same town and range, may be recorded on this certificate.

A. Description of original monument and accessories and/or subsequent restoration:

G-13 SOUTH CORNER COMMON TO SEC'S 33 & 34, T30N, R3E.
POST SET BY LEWIS CLASON 1840. ASPEN 16"-N51°W- 12 L., ASPEN 12"-N45°E-18 L.
FRANK SMITH NOTES 1940, NO CORNER DESCRIPTION-10"CEDAR S64°30'E 12.54'-14"BAL.S26°30'E 32.15'-14"CEDAR S16°W 39.25'- 5"W. PINE N26°W 35.20'.
SURVEY BY N.C. CALDWELL, 1-5-68, FOUND PIPE, PLACE 1/2"ROD & CAP, S16°W 39.25' 16"CEDAR N26°W 35.2' 8"W.PINE.
ACT 74 BY T. MILLER L. 1, P. 2.
SURVEY BY T. MILLER L. 2, P. 108, NO WIT. OR CORNER DESCRIPTION.

B. Description of corner evidence found and/or method applied in restoring or reestablishing corner:

G-13 SOUTH COR. COMMON TO SEC'S 33 & 34, T30N, R3E.
FOUND 1/2"ROD IN 1 1/4" PIPE WITH GRADER BLADE.
N43 1/2°E 10"CEDAR 28.1'
N45 1/2°W 18"W.PINE 31.9'

SURVEY &
REMONUMENTATION

DEC 18 1995

COMMISSION

NO EVIDENCE OF ORIGINAL CORNER

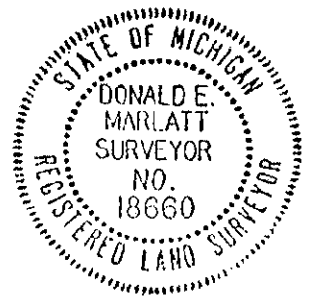

C. Description of monument for corner and accessories established to perpetuate locating the position of the corner:

G-13 SOUTH CORNER COMMON TO SEC'S 33 & 34, T30N, R3E.
SET CONC. MONUMENT & REMON. CAP# 18660.
S48°E 15"CFDAR 26.8'
S 2°E 12"CFDAR 16.45'
N23°W 15"CFDAR 20.57'
N20°E 10"CFDAR 28.58'
WITNESSES MARKED WITH 30 PENNY SPIKES & TAG #18660
APPROVED BY PEER GROUP ON JUNE 2, 1995 AS A PERPETUATION OF THE ORIGINAL GOV'T CORNER.

APPROVED BY
PEER GROUP

JUN 02 95

LYB

Signed by Donald E Marlatt

Date 11-17-1995

Surveyor's Michigan License No. 18660