

LAND CORNER RECORDATION CERTIFICATE
Filing Requirement of Act 74, Mich. P.A. 1970 as Amended

For corners in

Ontonagon (County)	Located In:	Corner Code #
1. Public Land Survey	T 51N R 37W	MC N. of M13 (GCDB 700109)
	T R	
	T R	
2. Property Controlling in Section	S T R	
	S T R	
	S T R	
3. Miscellaneous Property in Sec.	S T R	
	S T R	
4. Lot No. , Recorded Plat		
5. Private Claims		

Register of Deeds Stamp & File Number

	A	B	C	D	E	F	G	H	I	J	K	L	M
1													
2	6		5		4		3		2		1		
3													
4	7		8		9		10		11		12		
5													
6	18		17		16		15		14		13		
7													
8	19		20		21		22		23		24		
9													
10	30		29		28		27		26		25		
11													
12	31		32		33		34		35		36		
13													

I, Stephan J. Szyszkoski, in a field survey on 06/11/14 do hereby state that under requirements of P.A. 74, Michigan P.A. of 1970, the corner points mentioned in lines 1 and 2 above were in conformance with regulations and rules therefore as required in the current manual of survey instructions of the United States Department of the Interior, Bureau of Land Management or by a decree of a Court of Law and /or that the corner points mentioned in lines 3, 4 and 5 above were in conformance with the rules of the Michigan Board of Land Surveyors or by a Decree of a Court of Law; established, re-established, monumented, recovered, found as expressed below:

NOTE: Not more than 2 corners, all in the same town and range, may be recorded on this certificate.

A. Description of original monument and accessories and/or subsequent restoration:

Meander Corner on the north shore of Six Mile Lake between Section 36 T51N-R37W and Section 31 T51N-R36W. 1854 - Established by Wm.A.Burt Deputy Surveyor 6.82 ch. North of the position for M13 and 33.18 ch. South of M12. Set post. Tamarack 6" N75°E 79 links, Tamarack 6" N14°W 136 links. Witnesses following are numbered to correspond to those in Part B. 1957 - MSHD highway plans show 3/4" iron pipe at the corner with witnesses: 1) 12" Birch N25°W 25.42'; 2) 12" Pine stp. N15°E 23.55'; 3) 10" Oak S65°E 44.50'. 1979 - K.L.Sackett RLS records that he restored the corner position from the MSHD witnesses and set a 1"ID I.pipe with 4" alum. cap witnessed by: 4) 18" W.Pine N38°W 33.4'; 5) 23" W.Pine N89°E 70.4'; 6) Concrete ROW marker N07°E 12.2'. 1990 - R.Crampton RLS records that he found a 1" iron pin from MSHD notes, witnessed by nail and tag in: 7) 23" W.Pine N34°W 33.67'; 8) 9" W.Birch N50°E 33.62'; 9) 18" Oak S64°E 43.73'; 10) center of conc. ROW marker N07°E 12.45'.

B. Description of corner evidence found and/or method applied in restoring or reestablishing corner:

Found a 1" dia. iron pin set flush, in good condition, in accord with the witnesses of record referenced above: 1) a stump; 2) not found 3) in good condition. Set new witness nail in this tree (see below); 4) now standing dead with scribing "MC NBT" visible; 5) a stump; 6) measured 12.2' to south face and 12.35' to center; 7) same as 4); 8) now standing dead, about 25' tall with overgrowth covering tag; 9) same as 3)-overgrowth covers the 1990 witness tag; 10) same as 6). I note that the position of this monument is 30.923 chains (2040.91') south of corner M12 and it is likely not the original Meander Corner position but, rather, a witness corner to the MC. Based on record GLO distance to M12, the MC is 148.97' south of this position.

C. Description of monument for corner and accessories established to perpetuate locating the position of the corner:

Found 1"ID iron pin.
Set measuring nail with MDNR tag in the side of:
18" Oak S65°E 44.3' with old overgrown blazes
6" Oak N46°E 13.4' mrkd "MC NBT"
6" Oak S45°E 4.05' do
C/L of Conc R/W post N08°E 12.35'
Set sq'd cedar post adjacent.
E= 7852404.656 N= 222224.863

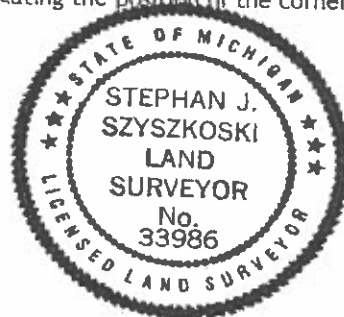

Bearings are magnetic. Coordinates are MCS83 in meters (NAD83(2011) Datum).
Coord. Ref.=NGS PID RL0607: N= 222113.185 m. E= 7850163.394 m.

Signed by Stephan J. Szyszkoski Date 06/30/2014
Surveyor's Michigan License No. 33986

For the Michigan Department of Natural Resources, Forest Resources Division