

**SAGINAW COUNTY RE-MON 1997  
LAND CORNER RECORDATION CERTIFICATE  
Filing Requirement of Act 74, Mich. P.A. 1970**

RECORDED & FILED

For corners in Taymouth Township

#	<u>Saginaw</u>	Located In:	Corner Code
	(County)		
1. Public Land Survey	T <u>10N</u>	R <u>5E</u>	<u>G-13</u>
	T _____	R _____	_____
	T _____	R _____	_____
	T _____	R _____	_____
2. Property Controlling in Section	S _____	T _____	R _____
	S _____	T _____	R _____
3. Miscellaneous Property in Sec.	S _____	T _____	R _____
	S _____	T _____	R _____

Sep 25 9 23 PM '97

MILDRED M. DODAK  
REGISTER OF DEEDS  
SAGINAW COUNTY MICH.

LIBER 2027 PAGE 89

*Liber 7 Page 129*  
Register of Deeds Stamp & File Number

4. Lot No. \_\_\_\_\_, Recorded Plat \_\_\_\_\_  
5. Private Claims \_\_\_\_\_

1	A	B	C	D	E	F	G	H	I	J	K	L	M
2		6		5		4		3		2		1	
3													
4		7		8		9		10		11		12	
5													
6		18		17		16		15		14		13	
7													
8		19		20		21		22		23		24	
9													
10		30		29		28		27		26		25	
11													
12		31		32		33		34		35		36	
13													

I, Ronald C. Prevost in a field survey on 5-1, 1997 do hereby state that under requirements of P.A. 74, Michigan P.A. of 1970, the corner points mentioned in lines 1 and 2 above were in conformance with regulations and rules therefore as required in the current manual of survey instructions of the United States Department of the Interior, Bureau of Land Management or by a decree of a Court of Law and /or that the corner points mentioned in lines 3, 4 and 5 above were in conformance with the rules of the Michigan Board of Land Surveyors or by a Decree of a Court of Law; established, re-established, monumented, recovered, found as expressed below:

**NOTE: Not more than 2 corners, all in the same town and range, may be recorded on this certificate.**

**A. Description of original monument and accessories and/or subsequent restoration:**

G-13 Post set by J. Wampler about 1822.  
Lynn 8° N.52E. 17 L  
Elm 20° S.81W. 11 L  
L.C.R.C. L1-P68, McKelver, 1971, set 1" iron pipe.  
Act 132 L1336 P1137, McKelver, L1336 P1138, wit's same as L.C.R.C.  
Act 132 L1423 P378, Floyd no witnesses.

APPROVED BY PEER GROUP  
P.A. 345 OF 1990  
SAGINAW COUNTY  
*B-28-97*

**B. Description of corner evidence found and/or method applied in restoring or reestablishing corner:**

G-13 Found 3/4" pipe, 5-1-97.  
L1-P68 E.66.00' NE corner Sec 4, Montrose Twp. Genesee Co. (M 66.00)  
to 5/8" bar in mon box. G.L.O. closing corner distance 1.00 Ch.  
Approved by Peer Group 8-28-97.

SURVEY &  
REMONUMENTATION

MAR 18 1998

SECTION

**C. Description of monument for corner and accessories established to perpetuate locating the position of the corner:**

G-13 Replaced 3/4" pipe with 5/8" re-rod, Sag. Co. cap set mon box 9-9-97.  
East 66.00 5/8" bar in mon box.  
N.70°E. 63.54 nail & cap S side p. pole.  
N.75°W. 33.06 nail & cap N side p. pole.  
N.20°W. 62.49 nail & cap E side 20" Elm.

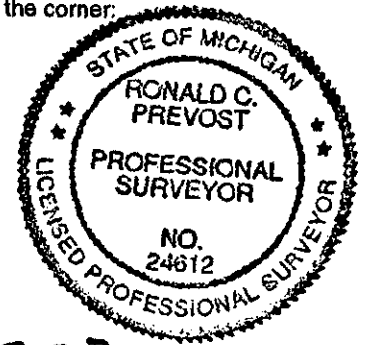

Signed by Ronald C. Prevost  
Ronald C. Prevost

Date 9-25-97

Surveyor's Michigan License No. 24612

MAR 12 1998