

SCHOOLCRAFT COUNTY
PEER GROUP APPROVED

DATE 10/10/00

SURVEY &
REMONUMENTATION

FEB 08 2001

LAND CORNER RECORDATION CERTIFICATE
Filing Requirement of Act 74, Mich. P.A. 1970

For corners in

Schoolcraft
(County)

Located In:

Corner Code #

SECTION

1. Public Land Survey

T 42N R 14W

M11

T R

T R

T R

T R

2. Property Controlling
in Section

S T

T R

S T

T R

3. Miscellaneous
Property in Sec.

S T

T R

S T

T R

SIGRID HEDBERG

1P

SCHOOLCRAFT CO. REGISTER

Page 1 of 1

LC 4/422

JLV Date 12/28/2000

Time 11:28:15

Register of Deeds Stamp & File Number

4. Lot No. _____, Recorded Plat _____
5. Private Claims _____

I, Thomas P. O'Brien, in a field survey on 11/27/00, do hereby state that under requirements of P.A. 74, Michigan P.A. of 1970, the corner points mentioned in lines 1 and 2 above were in conformance with regulations and rules therefore as required in the current manual of survey instructions of the United States Department of the Interior, Bureau of Land Management or by a decree of a Court of Law and/or that the corner points mentioned in lines 3, 4 and 5 above were in conformance with the rules of the Michigan Board of Land Surveyors or by a Decree of a Court of Law; established, re-established, monumented, recovered, found as expressed below:

NOTE: Not more than 2 corners, all in the same town and range, may be recorded on this certificate.

	A	B	C	D	E	F	G	H	I	J	K	L	M
1													
2	6		5		4		3		2		1		
3													
4	7		8		9		10		11		12		
5													
6	18		17		16		15		14		13		
7													
8	19		20		21		22		23		24		
9													
10	30		29		28		27		26		25		
11													
12	31		32		33		34		35		36		
13													

A. Description of original monument and accessories and/or subsequent restoration:

March 31, 1851 Algernon Merryweather, DS set section corner 25 and 36 Cedar 5 in S40W 7 links Cedar 6 in N70W 7 "

July 17, 1902 Eugene Ford, County Surveyor "set post at corner new witness steel rail due north 70 l. Telegraph pole N17E 32 l..

Aug. 4, 1975 Thomas P. O'Brien RLS found 1" pipe.
1979 rest with county monument by County Surveyor.

B. Description of corner evidence found and/or method applied in restoring or reestablishing corner:

Nov. 27, 2000 Thomas P. O'Brien PS found Schoolcraft County monument incorrectly stamped and replaced with properly stamped Schoolcraft County monument.

C. Description of monument for corner and accessories established to perpetuate locating the position of the corner:

Schoolcraft County monument stamped to identify.

Witnesses:

10" Cedar N54°E 7.0'

4" Cedar S46°E 6.32'

10" Cedar S62°W 22.70'

Centerline rail N0°41'02"E 49.65' (46.20' Ford survey)

Carsonite post North 1.0'

Signed by Thomas P. O'Brien

Surveyor's Michigan License No. 21274

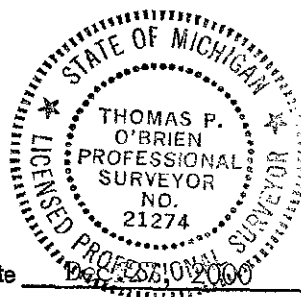

Date

LIBER

4

PAGE:

422