

STATE

RC 1274

RC 1274

LAND CORNER RECORDATION CERTIFICATE

LI 27018PA 420

Filing Requirement of Act 74, Mich. P.A. 1970

For corners in

Wayne

(County)

Located In:

OTHER...
Corner Code #21

1. Public Land Survey T 25 R 12E # 021
T _____ R _____
T _____ R _____
T _____ R _____
2. Property Controlling S _____ T _____ R _____
in Section S _____ T _____ R _____
3. Miscellaneous S _____ T _____ R _____
Property in Sec. S _____ T _____ R _____

Compliance with
ACT 345, P.A. 1990

APPROVED ON: 12-8-93
WAYNE COUNTY REMONUMENTATION
PEER GROUP COMMITTEE

Register of Deeds Stamp & File Number

4. Lot No. _____, Recorded Plat _____
5. Private Claims Line Common to P.C. 228 and P.C. 227

I, George M. Platz, in a field survey on November 15, 19 93,
do hereby certify that under requirements of P.A. 74, Michigan P.A. of 1970, the corner points mentioned
in lines 1 and 2 above were in conformance with regulations and rules therefore as required in the
current manual of survey instructions of the United States Department of the Interior, Bureau of Land
Management or by a decree of a Court of Law and/or that the corner points mentioned in lines 3, 4 and 5
above were in conformance with the rules of the Michigan Board of Land Surveyors or by a Decree of a
Court of Law; established, re-established, monumented, re-monumented, recovered, found as
expressed below:

NOTE: Not more than 4 corners, all in the same town and range, may be recorded
on this certificate.

A. Description of original monument and accessories and/or subsequent restoration:

LINE COMMON TO P.C. 228 AND P.C. 227

THE LINE COMMON TO P.C. 228 AND 227 WAS ORIGINALLY SURVEYED IN 1810 BY AARON GREELEY (SEE RESEARCH DOSSIER FOR
SKETCH AND NOTES). POSTS WERE ORIGINALLY SET AT THE CORNERS ONLY AND NO LINE STAKES ARE CALLED OUT. MANY
SUBDIVISIONS HAVE BEEN PLATTED ADJACENT TO THIS LINE, SOME DELINEATING IT WITH DIMENSION, OTHERS NOT. THE CITY OF
DETROIT SURVEY BUREAU HAS ASSEMBLED AND MAINTAINED THEIR "CARTOGRAPHICAL MAPS" FROM RECORD PLAT DATA AND
FIELD WORK. THESE MAPS HAVE BEEN RELIED UPON FOR A GREAT NUMBER OF YEARS AND ARE CONSIDERED THE BEST
ASSEMBLED COLLECTION OF WRITTEN EVIDENCE AVAILABLE. TO THE BEST OF MY KNOWLEDGE, THERE HAS NEVER BEEN ANY
SUBSEQUENT RESTORATION OF THIS LINE, EXCEPTING THE PLATS WHICH WERE DONE LONG AGO.

B. Description of corner evidence found and/or method applied in restoring or reestablishing corner:

LINE COMMON TO P.C. 228 AND P.C. 227

A COMPLETE ANALYSIS OF THIS LINE FROM ITS SOUTHERN BEGINNINGS AT THE DETROIT RIVER TO ITS NORTHERN TERMINUS JUST
NORTH OF MCGRAW AVENUE HAS BEEN FIELD MEASURED BY SPALDING, DEDECKER AND ASSOCIATES, LOCATING BUILDING LINES,
STREET LINES AND ALLEY LINES AT VARIOUS POSITIONS (SEE RESEARCH DOSSIER). IT IS MY CONCLUSION THAT "TWO SEPARATE
LINES" OF DIFFERENT BEARING OCCUR ALONG THIS P.C. LINE WITH THE CHANGE OCCURRING AT OR NEAR GRAND RIVER AVENUE.
QUITE POSSIBLY, THIS MAY HAVE OCCURRED AS THE STAGES OF EARLY CITY DEVELOPMENT EXPANDED OUTWARD. THE SPECIFIC
POINTS HELD AS GOOD AND THE RELATIONSHIP OF THE OTHER VARIOUS POINTS FIELD MEASURED ARE LABELED IN THE RESEARCH
DOSSIER.

C. Description of monument for corner and accessories established to perpetuate locating the position of the corner:

- (B) SET MONUMENT WITH WAYNE COUNTY REMONUMENTATION TAG AND LICENSE CAP NO. 38121 IN GRASS AREA APPROXIMATELY
52' SOUTHERLY OF THE CENTERLINE OF MARTIN LUTHER KING BLVD. BETWEEN CURB AND SIDEWALK. THE LOCATION OF THIS
PROPERTY CONTROLLING MONUMENT IS ACCEPTED AS A CAREFUL AND FAITHFUL DETERMINATION OF THE POSITION OF THE
PRIVATE CLAIM LINE BASED UPON ALL KNOWN EVIDENCE.

AZ. 77°: 8.62'; SET PK NAIL WITH WCR TAG IN SOUTH FACE OF 4" ASH
AZ. 156°: 29.35'; SET PK NAIL WITH WCR TAG IN WEST FACE OF 8" MULTI-STEM CHERRY
AZ. 225°: 136.98'; SET PK NAIL WITH WCR TAG IN NORTH FACE OF 14" LOCUST
AZ. 254°: 36.51'; SET PK NAIL WITH WCR TAG IN SOUTH FACE OF 4" ASH

Signed by George M. Platz

Date 12-3-93

Surveyor's Michigan License No. 38121

	A	B	C	D	E	F	G	H	I	J	K	L	M
2	6	5	4	3	2	1							
3													
4	7	8	9	10	11	12							
5													
6	18	17	16	15	14	13							
7													
8	19	20	21	22	23	24							
9													
10	30	29	28	27	26	25							
11													
12	31	32	33	34	35	36							
13													

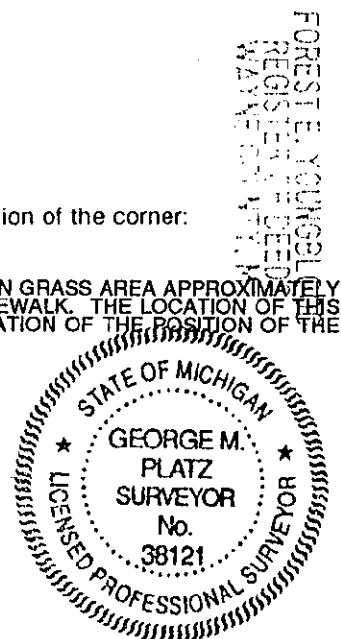

VERMONT

FORD FREEWAY (I-94)

12TH STREET
(ROSA PARKS BLVD.)

© TO BE MONUMENTED
AT A LATER DATE

GRAND RIVER AVE.

FILED DO NOT MAIL

ⓑ MARTIN LUTHER KING BLVD.
(MYRTLE)

P.C. 228
P.C. 227

Ⓐ LAFAYETTE

DETROIT RIVER

NO SCALE

12/08/93 35181 REMO FEE 2.00
12/08/93 35181 DEED 14.00