



**DEPARTMENT OF NATURAL RESOURCES
STATE OF MICHIGAN**

TIMBER SALE PROSPECTUS #5820

SCHEDULED SALE DATE AND TIME: 10:00 a.m. (local time) on July 11, 2017.

LOCATION: ATLANTA MGMT UNIT, 13501 M-33, ATLANTA, MI 49709.

CONTACT NAME: Cody Stevens

PHONE NUMBER: (989) 785-4251

PROSPECTUS NOTE: The bidder is advised to inspect the sale area and review the location, estimated volumes, operating costs and contract terms of proposed sales. Please be aware that some landowners may request 60 days or more notice for access across their land.

Notice is hereby given that bids will be received by the Unit Manager, ATLANTA MANAGEMENT UNIT, for certain timber on the following described lands:

Mapleclation (54-042-16)

Montmorency County, Advertised Price \$231,903.50, 210.0 Acres, Aspen, Red Oak.

TIMBER SALE INFORMATION

Maplecatation (54-042-16)

Montmorency County (Advertised Price \$231,903.50)

A timber sale contract for this lump sum, sealed bid timber sale will be awarded to the responsible bidder offering the highest sealed bid price. Bids must be at or above the following advertised price for each species:

<u>PRODUCTS & SPECIES</u>	<u>ESTIMATED UNITS*</u>	<u>ADVERTISED PRICE</u>
Sawtimber		
Mixed Aspen	171.50 MBF	\$ 78.00 / MBF
Red Maple	60.40 MBF	\$ 123.00 / MBF
Red Oak	921.20 MBF	\$ 145.00 / MBF
Red Pine	28.80 MBF	\$ 128.00 / MBF
White Oak	45.80 MBF	\$ 72.00 / MBF
Pulpwood		
Balsam Fir	38.00 Cords	\$ 28.25 / Cord
Mixed Aspen	855.00 Cords	\$ 20.95 / Cord
Mixed Hardwood	627.00 Cords	\$ 18.90 / Cord
Red Oak	1,891.00 Cords	\$ 18.45 / Cord
Red Pine	38.00 Cords	\$ 50.25 / Cord
White Oak	113.00 Cords	\$ 18.45 / Cord
White Pine	23.00 Cords	\$ 35.65 / Cord

BOND AND PAYMENT SCHEDULE:

1. A bond in the amount of \$11,595.18 to insure faithful performance of the conditions of the contract will be deposited by the successful bidder within 21 days of the sale award.
2. Cutting in any sale or unit without the required advance payment would be considered a trespass.
3. Total payment must be paid in advance or according to the following schedule:
 - (a) Ten percent (10%) of the sale value must be paid within 21 days of the sale award.
 - (b) The 10% down payment will be credited towards the first unit cut.
4. If no cutting takes place, the 10% down payment will not be refunded.
5. Operations on the contract issued will terminate on 12/31/2019.

Description of Timber by Payment Unit (PU)

PU	MARKET GROUP	PRODUCT	QUANTITY	UNIT	ACRES	ADVERTISE PRICE
1	Mixed Aspen	Sawtimber	13.9	MBF	29.0	\$31,041.00
	<i>B. T. Aspen</i>		9.9	<i>MBF</i>		
	<i>Quaking Aspen</i>		4.0	<i>MBF</i>		
	Red Maple		11.5	MBF		
	Red Oak		101.9	MBF		
	Red Pine	Pulpwood	21.0	MBF		
	White Oak		7.4	MBF		
	Mixed Aspen		115.0	Cords		
	<i>B. T. Aspen</i>		103.0	<i>Cords</i>		
	<i>Quaking Aspen</i>		12.0	<i>Cords</i>		
	Mixed Hardwood		97.0	Cords		
	<i>Paper Birch</i>		3.0	<i>Cords</i>		
	<i>Red Maple</i>		94.0	<i>Cords</i>		
	Red Oak		225.0	Cords		
	Red Pine		28.0	Cords		
	White Oak		23.0	Cords		
	White Pine		9.0	Cords		
	<i>White Pine</i>	<i>Sawtimber</i>	1.1	<i>MBF</i>		
	<i>White Pine</i>	<i>Pulpwood</i>	7.0	<i>Cords</i>		
2	Mixed Aspen	Sawtimber	67.0	MBF	25.5	\$24,908.00
	<i>B. T. Aspen</i>		60.4	<i>MBF</i>		
	<i>Quaking Aspen</i>		6.6	<i>MBF</i>		
	Red Maple		8.8	MBF		
	Red Oak		45.3	MBF		
	Red Pine	Pulpwood	4.3	MBF		
	White Oak		1.5	MBF		
	Mixed Aspen		305.0	Cords		
	<i>B. T. Aspen</i>		250.0	<i>Cords</i>		
	<i>Quaking Aspen</i>		55.0	<i>Cords</i>		
	Mixed Hardwood		115.0	Cords		
	<i>Paper Birch</i>		1.0	<i>Cords</i>		
	<i>Red Maple</i>		114.0	<i>Cords</i>		
	Red Oak		128.0	Cords		
	Red Pine		6.0	Cords		
	White Oak		6.0	Cords		
	White Pine		1.0	Cords		
	<i>White Pine</i>	<i>Sawtimber</i>	0.2	<i>MBF</i>		
	<i>White Pine</i>	<i>Pulpwood</i>	1.0	<i>Cords</i>		
3	Mixed Aspen	Sawtimber	44.5	MBF	37.2	\$38,937.25
	<i>B. T. Aspen</i>		41.9	<i>MBF</i>		
	<i>Quaking Aspen</i>		2.6	<i>MBF</i>		
	Red Maple		9.0	MBF		
	Red Oak		126.3	MBF		
	Red Pine	Pulpwood	1.0	MBF		
	White Oak		0.4	MBF		
	Mixed Aspen		220.0	Cords		
	<i>B. T. Aspen</i>		198.0	<i>Cords</i>		
	<i>Quaking Aspen</i>		22.0	<i>Cords</i>		
	Mixed Hardwood		202.0	Cords		
	<i>Red Maple</i>		202.0	<i>Cords</i>		
	Red Oak		389.0	Cords		
	Red Pine		1.0	Cords		
	White Oak		5.0	Cords		
	White Pine		4.0	Cords		
	<i>White Pine</i>		4.0	<i>Cords</i>		

Description of Timber by Payment Unit (PU), con't

PU	MARKET GROUP	PRODUCT	QUANTITY	UNIT	ACRES	ADVERTISE PRICE
4	Mixed Aspen	Sawtimber	11.5	MBF	9.5	\$8,307.30
	B. T. Aspen		11.5	MBF		
	Red Maple		1.1	MBF		
	Red Oak		24.8	MBF		
	Mixed Aspen		127.0	Cords		
	B. T. Aspen		127.0	Cords		
	Mixed Hardwood		8.0	Cords		
	Red Maple		8.0	Cords		
Red Oak	47.0	Cords				
5	Mixed Aspen	Sawtimber	2.6	MBF	12.6	\$9,252.25
	B. T. Aspen		1.2	MBF		
	Quaking Aspen		1.4	MBF		
	Red Maple		4.7	MBF		
	Red Oak		24.0	MBF		
	Red Pine		2.5	MBF		
	White Oak		19.7	MBF		
	Balsam Fir		8.0	Cords		
	Balsam Fir		1.0	MBF		
	Balsam Fir		6.0	Cords		
	Mixed Aspen		24.0	Cords		
	B. T. Aspen		12.0	Cords		
	Quaking Aspen		12.0	Cords		
	Mixed Hardwood		29.0	Cords		
	Paper Birch		3.0	Cords		
	Red Maple		26.0	Cords		
	Red Oak		62.0	Cords		
	Red Pine		3.0	Cords		
	White Oak		35.0	Cords		
	White Pine		1.0	Cords		
	White Pine		0.1	MBF		
	White Pine		1.0	Cords		
6	Mixed Aspen	Sawtimber	21.4	MBF	64.1	\$79,579.15
	B. T. Aspen		16.7	MBF		
	Quaking Aspen		4.7	MBF		
	Red Maple		16.9	MBF		
	Red Oak		399.1	MBF		
	White Oak		11.2	MBF		
	Balsam Fir		20.0	Cords		
	Balsam Fir		20.0	Cords		
	Mixed Aspen		42.0	Cords		
	B. T. Aspen		15.0	Cords		
	Quaking Aspen		27.0	Cords		
	Mixed Hardwood		117.0	Cords		
	Beech		3.0	Cords		
	Red Maple		114.0	Cords		
	Red Oak		693.0	Cords		
	White Oak		29.0	Cords		
	White Pine		5.0	Cords		
	White Pine		5.0	Cords		
7	Mixed Aspen	Sawtimber	10.6	MBF	32.1	\$39,842.90
	B. T. Aspen		8.3	MBF		
	Quaking Aspen		2.3	MBF		
	Red Maple		8.4	MBF		
	Red Oak		199.8	MBF		
	White Oak		5.6	MBF		

Description of Timber by Payment Unit (PU), con't

PU	MARKET GROUP	PRODUCT	QUANTITY	UNIT	ACRES	ADVERTISE PRICE
7 con't	Balsam Fir	Pulpwood	10.0	Cords		
	Balsam Fir		10.0	Cords		
	Mixed Aspen		22.0	Cords		
	B. T. Aspen		8.0	Cords		
	Quaking Aspen		14.0	Cords		
	Mixed Hardwood		59.0	Cords		
	Beech		2.0	Cords		
	Red Maple		57.0	Cords		
	Red Oak		347.0	Cords		
	White Oak		15.0	Cords		
	White Pine		2.0	Cords		
	White Pine		2.0	Cords		
TOTAL:			1,227.7	MBF		
TOTAL:			3,584.0	Cords		

Sale Specific Conditions & Requirements

Sale Name: Maplecation

Sale Number: 54-042-16 Seq#: 1

1 - Sale Area

1.2 - Boundaries

1.2.1 - Painted boundaries (1/14)

The sale boundary and Payment Unit boundaries are marked and identified red and yellow paint. Exterior sale boundary lines against state are marked with red paint. Interior Payment Unit boundaries are marked with yellow paint. Yellow painted trees designating an interior Payment Unit boundary are only to be cut when all surrounding Payment Units have been paid.

2 - Timber Specifications

2.1 - Included Timber

2.1.1 - Clearcut unit(s) with unmerchantable trees (6/14)

Within Payment Unit(s) 1-7, cut all trees that are two (2) inches or more at DBH except do not cut any red or white pine in Payment Units 6 & 7.

2.1.15 - Hazard trees near roads (7/13)

Cut and remove all standing dead trees within 100 feet of the cleared portion of designated county roads. These trees may be utilized or must be scattered back into the sale area.

2.2 - Utilization

2.2.6 - Roundwood operation required (5/07)

The skidding of whole trees or tree segments with limbs attached is prohibited within Payment Unit(s) 2-4. All products must be produced as roundwood and forwarded to existing roads or landing areas in final product length.

2.2.10 - No chipping tops and limbs (8/16)

Within Payment Unit(s) 2-5, chipping of limbs or tops is not permitted. Limbs and the remaining top must be left on site and scattered.

3 - Payments

3.3 - Pre-measured Sales

3.3.4 - Dividing payment units (7/14)

Payment Unit(s) 1-3, 6, and 7 may be divided at the request of the Purchaser and upon approval of the Unit Manager.

Dividing Payment Units is a contract modification which requires a Timber Sale Contract Supplement. There maybe more then one division per Payment Unit in order to get units to \$20,000 or less.

3.4 - Damaged Timber

3.4.1 - Damaged timber (6/14)

General Condition and Requirement 3.4 Damaged Timber, defines liquidated damages for undesignated live merchantable trees which are cut or injured.

Within the sale area, if more than 25% of the white pine seedlings or saplings (1/4" to 4.5" DBH) within Payment Unit 5 are damaged, liquidated damages will be assessed at \$150 per acre for all acreage within that specified portion of the sale area that was damaged.

4 - Transportation

4.1 - Construction

4.1.6 - Road construction (1/09)

Improvements of existing roads shall be done in such a way as to minimize the environmental and visual impacts.

Merchantable trees shall be cut and utilized unless otherwise directed. Non-merchantable trees shall be severed and laid flat on the ground. Slash shall be scattered, and not left in windrows and kept a minimum of 10 feet back from the road edge. Stumps shall be set upright, not left on edge, and be moved at least 10 feet away from the road edge. Disturbed soil shall be feathered into the woods and not left in berms or windrows.

4.1.12 - No new roads (1/12)

No new roads will be permitted in any Payment Unit. All operations are limited to existing roads. Skid trails only will be allowed.

4.2 - Maintenance

4.2.5 - Two wheel drive condition (2/04)

All existing trail roads on and adjacent to the sale area must be passable by two-wheel drive traffic for the duration of the sale.

5 - Operations

5.1 - Notification

5.1.1 - Pre-sale conference (10/11)

A pre-sale conference on site between the Purchaser and sale administrator is required prior to beginning any operations to determine landing and road locations. The Unit Manager or his/her representative must be contacted at least 10 days in advance to schedule the conference.

5.1.3 - Well heads and natural gas pipelines (11/15)

The Purchaser is responsible for contacting the gas or pipeline company 30 days prior to operating equipment in the vicinity of well heads or natural gas pipelines.

5.1.4 - Post-sale conference (6/11)

A post-sale conference on site between the Purchaser and sale administrator is required 5 days prior to the completion of active logging operations to determine clean-up and repair of landings, road edges, and the fulfillment of other contract specifications.

5.2 - Conduct of Operations

5.2.2 - Hazard Trees/Snags

5.2.2.1 - Den trees (2/04)

Obvious hollow and/or den trees shall be protected and left standing unless they are a safety hazard.

5.2.3 - Operating Restrictions

5.2.3.1 - Operating restrictions (9/11)

Within Payment Unit(s) 5, unless changed by written agreement, cutting, skidding, and hauling are limited to the period of October 1 through April 30. This restriction is because of a state forest campground nearby.

5.2.3.11 - Coppice regeneration protection (4/10)

Timber harvesting in any Payment Unit must be completed before significant deciduous sprouting occurs in that Payment Unit so as to minimize damage to the new regeneration. Any post harvest operations, such as chipping, must be completed before sprouting of regeneration occurs. If it is anticipated that chipping will be delayed, then tops shall be carried to one central location or left unchipped. The Unit Manager or his/her representative may cease such operations if sprouting occurs before the operation is complete.

5.2.4 - Dead and Down Creation

5.2.4.2 - Dead and down creation, hare and grouse (1/14)

To improve habitat for snowshoe hare, grouse, and other species, the Purchaser is to leave 1 tree, nine (9) inches or larger in diameter on the ground for every 1 acre. They should be scattered throughout the sale or positioned per the sale administrators instructions. If possible, the logs or trees should be felled so they overlap. Note these pieces should have a minimum length of twenty feet. They can be of any tree species and can be an un-merchantable piece of wood or a full tree.

5.2.32 - Decking/landing restoration (9/13)

All decking and landing areas must have the surface area restored to a condition equal to or better than before. This is to ensure the proper regeneration of the stand. Wood debris, chips and "cookies" from trimmings must be removed or scattered away from landing and loading areas and may not be windrowed on the edge.

5.2.38 - No decking against live trees (2/04)

Cut products may not be decked against unmarked or designated leave trees.

5.2.40 - Pathway protection (10/10)

The horse trail is shown on the Timber Sale Map. Do not cut trees or damage posts with blue pathway markers. Maintain a 20-foot wide slash, debris, and rut free zone daily, using the pathway as the centerline. Skidding across the trail may only occur in locations approved by the sale administrator. In addition, if a permitted event is scheduled, operations are to halt or be restricted to 330 feet or more from trails while event takes place.

5.2.41 - Snowmobile trail protection (9/11)

The snowmobile trail is shown on the Timber Sale Map. Do not cut or damage posts with orange trail markers or traffic control signs. If the trail is used, it must be maintained and restored to a condition equal to or better than before the sale. The road maintenance/restoration must be done prior to December 1. If the trail is used for hauling, it must be graded to the satisfaction of the Unit Manager or his/her representative prior to December 1st. If the trail road is to be used for hauling during the snowmobile season, then a snow covered base must be left on the trail. The snowmobile trail may only be crossed at right angles. Maintain a 20 foot wide slash, debris, and rut free zone daily using the snowmobile trail as the centerline. All stumps within 20 feet of the snowmobile trail must be cut at ground level.

5.4 - Soil Protection

5.4.1 - Rutting restriction, general (7/16)

Operations are to cease immediately if equipment and weather conditions result in rutting of roads and/or skid trails which is 12 inches or greater in depth and 50 feet in length. The Unit Manager or his/her representative may restrict hauling and/or skidding if ruts exceed the specified depth. With the Unit Manager or his/her representative's approval, the Purchaser may return to the area when the risk of rutting has decreased.

5.4.2 - Skid trails (2/04)

Skid trails up and down slopes should be avoided. If however this is unavoidable, these trails will be left in a non-erodible condition using water bars, logs, and slash. Placing of slash on these skid trails while logging is ongoing may alleviate need for any further action. At the direction of the sale administrator, seed, fertilizer, and mulch may also be required.

5.4.4 - Slope protection (5/15)

Skid trails and roads on slopes shall be water barred with slash, stumps, and/or clean straw bales native to the area as soon as use is complete to prevent erosion.

5.8 - Protection of Endangered Species

5.8.5 - Protection of raptor nests (3/13)

All trees with raptor nests will be protected if found during harvesting operations. Notification will be made to the Unit Manager or his/her representative who will notify the Wildlife Biologist so an on-site evaluation and recommendation can be made, if necessary.

6 - Safety and Fire Prevention

6.2 - Signing

6.2.1 - Road posting (9/09)

The Purchaser is responsible for posting and maintaining caution signs on Avery Lake road prior to beginning operations. The road must be posted at appropriate distances from the sale area to warn of logging activity and truck traffic. Signs must be removed when harvest operations are suspended or completed. The Purchaser will provide these signs.

6.2.2 - Snowmobile trail posting (8/09)

The Purchaser is responsible for posting and maintaining caution signs on snowmobile trail prior to beginning operations during the snowmobile season (approximately December 1 to March 31). The trail must be posted at appropriate distances from the sale area to warn of logging activity and truck traffic. Signs must be removed when harvest operations are suspended or

completed. The Purchaser will provide these signs.

6.2.3 - Recreational trail posting (2/10)

The Purchaser is responsible for posting and maintaining caution signs on the horse trail prior to beginning operations. The trail must be posted at appropriate distances from the sale area to warn of logging activity and truck traffic at both ends of the trail. Signs must be removed when harvest operations are suspended or completed. The Purchaser will provide these signs.

**TIMBER SALE MAP**

This information provided by authority of Part 525, 1994 PA 451, as amended.

Sale Number	Year
54 - 042	16

Forest Management Unit Atlanta		County Montmorency	Mapped By Krugh	Date 09/19/2016	Page 1	of 2
Township 29N	Range 02E	Section(s) and Subdivision(s) 10 N2NE N2NW SENW SW W2SE, 15 NW, 3 N2SE E2SW SENE, 9 NENE NESE		Scale 1:15,840		

Cover Type				Density	
A = Aspen	H = Hemlock	N = Marsh	U = Upland Brush	0 = Non Stocked	5 = Pole Timber Medium
B = Paper Birch	J = Jack Pine	O = Oak	UM = Upland Mixed	1 = Seedling Sapling Poor	6 = Pole Timber Well
C = Cedar	L = Lowland Brush	P = Lowland Poplar	V = Bog or Marsh	2 = Seedling Sapling Medium	7 = Saw Timber Poor
D = Treed Bog	LM = Lowland Mixed	Q = Mixed Swamp Conifer	W = White Pine	3 = Seedling Sapling Well	8 = Saw Timber Medium
E = Swamp Hdwoods	M = Mpl, Bch, Brch	R = Red Pine	X = Non Stocked	4 = Pole Timber Poor	9 = Saw Timber Well
F = Spruce Fir	MC = Mixed Conifer	S = Black Spruce	Z = Water		
G = Grass	MD = Mixed Deciduous	T = Tamarack			

PU	Acres	PU	Acres
1	29	4	9.5
2	25.5	5	12.6
3	37.2	6	64.1

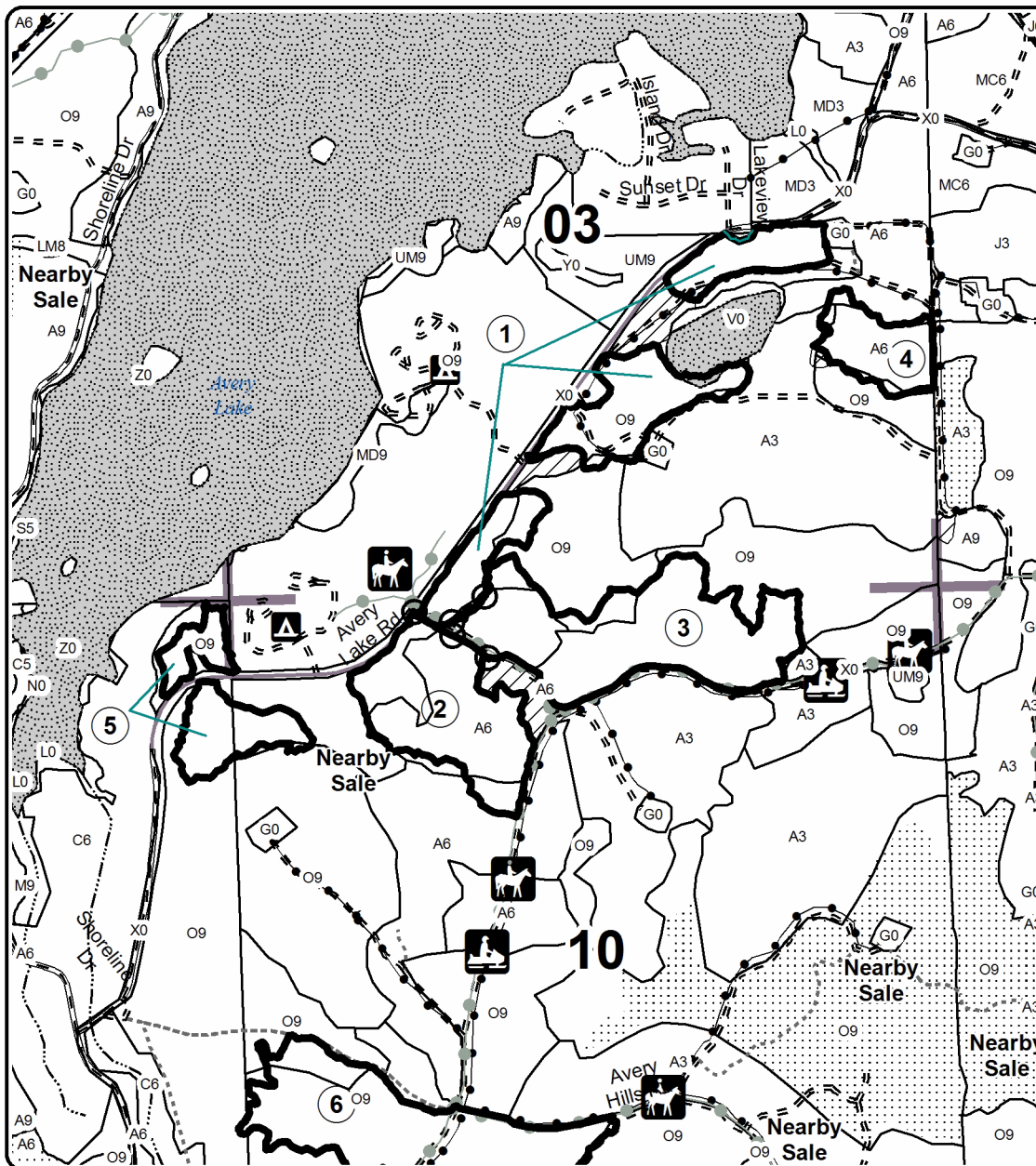
Maplecatation
Compartment 006
210 Acres**Legend**

- Against State (Red)
- Payment Unit (Yellow)
- ▨ Retention Area
- Payment Units
- Recreational Trail
- Pipeline; Powerline
- ▨ Adjacent Timber Sale
- Paved Roads
- Gravel Roads
- Poor Dirt Roads
- Closed Roads
- ▨ Lakes and Rivers
- All
- Recreational Trail

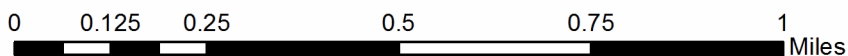
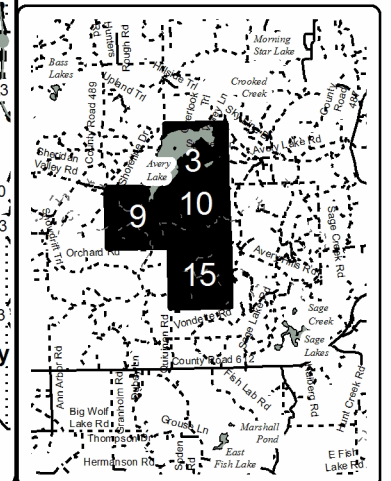
Locator Map
1:200,000

**TIMBER SALE MAP***This information provided by authority of Part 525, 1994 PA 451, as amended.*

Forest Management Unit		County	Mapped By	Date	Page	of
Altanta		Montmorency	Krugh	09/19/2016	2	2
Township	Range	Section(s) and Subdivision(s)		Scale		
29N	02E	10 N2NE N2NW SENW SW W2SE, 15 NW, 3 N2SE E2SW SENE, 9 NENE NESE		1:15,840		

Cover Type

A = Aspen	H = Hemlock	N = Marsh	U = Upland Brush
B = Paper Birch	J = Jack Pine	O = Oak	UM = Upland Mixed
C = Cedar	L = Lowland Brush	P = Lowland Poplar	V = Bog or Marsh
D = Treed Bog	LM = Lowland Mixed	Q = Mixed Swamp Conifer	W = White Pine
E = Swamp Hdwoods	M = Mpl, Bch, Brch	R = Red Pine	X = Non Stocked
F = Spruce Fir	MC = Mixed Conifer	S = Black Spruce	Z = Water
G = Grass	MD = Mixed Deciduous	T = Tamarack	

Density

0 = Non Stocked	5 = Pole Timber Medium
1 = Seedling Sapling Poor	6 = Pole Timber Well
2 = Seedling Sapling Medium	7 = Saw Timber Poor
3 = Seedling Sapling Well	8 = Saw Timber Medium
4 = Pole Timber Poor	9 = Saw Timber Well

PU Acres

6	64.1
7	32.1

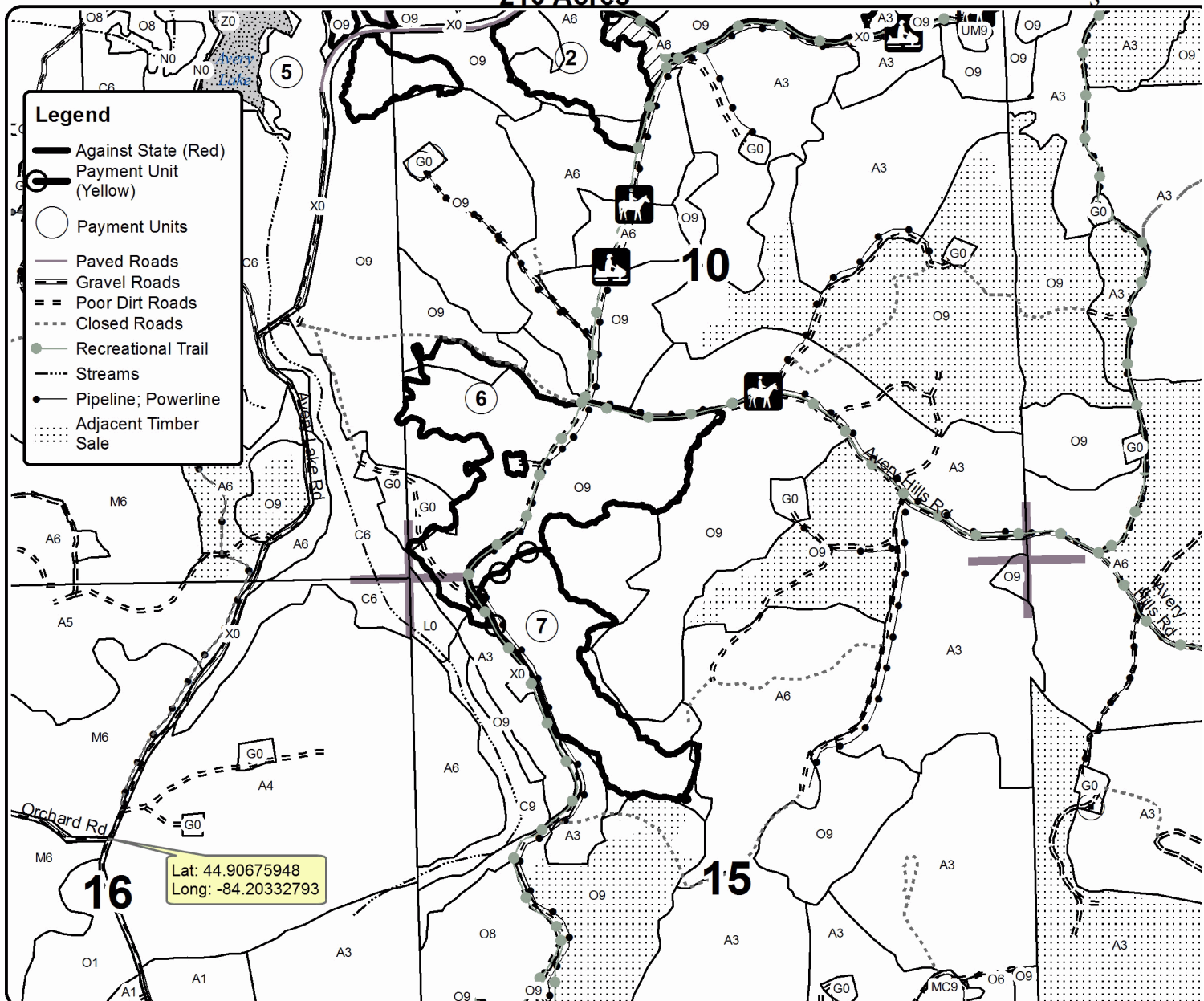
**Maplecion
Compartment 006
210 Acres**

0 0.125 0.25 0.5 0.75 1 Miles