



**DEPARTMENT OF NATURAL RESOURCES
STATE OF MICHIGAN**

TIMBER SALE PROSPECTUS #6547

SCHEDULED SALE DATE AND TIME: 3:00 p.m. (local time) on September 30, 2019.

LOCATION: BALDWIN FIELD OFFICE, 2468 W 24TH STREET, BALDWIN, MI 49304.

CONTACT NAME: Joe Ventimiglia

PHONE NUMBER: (231) 824-3591

PROSPECTUS NOTE: The bidder is advised to inspect the sale area and review the location, estimated volumes, operating costs and contract terms of proposed sales. Please be aware that some landowners may request 60 days or more notice for access across their land.

Notice is hereby given that bids will be received by the Unit Manager, CADILLAC MANAGEMENT UNIT, for certain timber on the following described lands:

GNA Dean Marten Pine 1 (63-816-19) / T22N, R11W, SEC. 20, E1/2SW,NESE,SWSE.

T22N, R11W, SEC. 28, SENW,SWNE,SW,NWSE.

T22N, R11W, SEC. 29, SENW,SWNE,N1/2SE,SESE.

T22N, R11W, SEC. 32, E1/2NE.

T22N, R11W, SEC. 33, NW,W1/2NE,N1/2SW.

Wexford County, Advertised Price \$234,149.25, 255.6 Acres, Hardwood, Red Pine.

SALE NOTE: This is a Good Neighbor Authority (GNA) timber sale on national forest land. This timber sale was set up and is being advertised by the Michigan DNR for the US Forest Service. The contract will be awarded and administered by the Michigan DNR. Note the additional Sale Specific Conditions & Requirements containing the acronym 'GNA.' Also, please note that red pine stands within this sale must be cut from January 1 to March 1 to prevent the spread of HRD.

A recreation site such as a trail, pathway, or campground is within the sale area or the vicinity. Certain restrictions/specifications may be applicable including time restrictions. Access may be through other public land.

TIMBER SALE INFORMATION

GNA Dean Marten Pine 1 (63-816-19)

T22N, R11W, SEC. 20; T22N, R11W, SEC. 28; T22N, R11W, SEC. 29; T22N, R11W, SEC. 32; T22N, R11W, SEC. 33.
Wexford County (Advertised Price \$234,149.25)

SALE NOTE: This is a Good Neighbor Authority (GNA) timber sale on national forest land. This timber sale was set up and is being advertised by the Michigan DNR for the US Forest Service. The contract will be awarded and administered by the Michigan DNR. Note the additional Sale Specific Conditions & Requirements containing the acronym 'GNA.' Also, please note that red pine stands within this sale must be cut from January 1 to March 1 to prevent the spread of HRD.

A recreation site such as a trail, pathway, or campground is within the sale area or the vicinity. Certain restrictions/specifications may be applicable including time restrictions. Access may be through other public land.

A timber sale contract for this lump sum, sealed bid timber sale will be awarded to the responsible bidder offering the highest sealed bid price. Bids must be at or above the following advertised price for each species:

<u>PRODUCTS & SPECIES</u>	<u>ESTIMATED UNITS*</u>	<u>ADVERTISED PRICE</u>
Sawtimber		
B. T. Aspen	4.60 MBF	\$ 93.00 / MBF
Beech	4.90 MBF	\$ 74.00 / MBF
Red Maple	55.60 MBF	\$ 97.00 / MBF
Red Pine	783.70 MBF	\$ 121.00 / MBF
Sugar Maple	6.50 MBF	\$ 361.00 / MBF
Pulpwood		
Mixed Aspen	198.00 Cords	\$ 17.20 / Cord
Mixed Hardwood	451.00 Cords	\$ 16.05 / Cord
Red Pine	3,423.00 Cords	\$ 35.10 / Cord

BOND AND PAYMENT SCHEDULE:

1. A bond in the amount of \$11,707.46 to insure faithful performance of the conditions of the contract will be deposited by the successful bidder within 21 days of the sale award.
2. Cutting in any sale or unit without the required advance payment would be considered a trespass.
3. Total payment must be paid in advance or according to the following schedule:
 - (a) Ten percent (10%) of the sale value must be paid within 21 days of the sale award.
 - (b) The 10% down payment will be credited towards the first unit cut.
4. If no cutting takes place, the 10% down payment will not be refunded.
5. Operations on the contract issued will terminate on 03/31/2022.

Description of Timber by Payment Unit (PU)

PU	MARKET GROUP	PRODUCT	QUANTITY	UNIT	ACRES	ADVERTISE PRICE
1	Red Pine	Sawtimber	87.2	MBF	8.6	\$12,200.90
	Red Pine	Pulpwood	47.0	Cords		
2	Red Pine	Sawtimber	30.1	MBF	6.1	\$5,024.05
	Mixed Hardwood	Pulpwood	3.0	Cords		
	Red Pine		38.0	Cords		
3	B. T. Aspen	Sawtimber	4.6	MBF	18.1	\$19,057.30
	Beech		4.9	MBF		
	Red Maple		55.6	MBF		
	Sugar Maple		6.5	MBF		
	Mixed Aspen	Pulpwood	194.0	Cords		
	Mixed Hardwood		448.0	Cords		
4	Red Pine	Sawtimber	73.2	MBF	30.0	\$28,723.80
	Red Pine	Pulpwood	566.0	Cords		
5	Red Pine	Sawtimber	44.2	MBF	22.3	\$19,282.90
	Red Pine	Pulpwood	397.0	Cords		
6	Red Pine	Sawtimber	78.9	MBF	26.0	\$20,884.20
	Red Pine	Pulpwood	323.0	Cords		
7	Red Pine	Sawtimber	9.1	MBF	5.6	\$2,926.30
	Red Pine	Pulpwood	52.0	Cords		
8	Red Pine	Sawtimber	105.3	MBF	39.3	\$37,696.00
	Mixed Aspen	Pulpwood	4.0	Cords		
	Red Pine		709.0	Cords		
9	Red Pine	Sawtimber	107.7	MBF	24.4	\$23,456.40
	Red Pine	Pulpwood	297.0	Cords		
10	Red Pine	Sawtimber	104.4	MBF	30.2	\$25,022.70
	Red Pine	Pulpwood	353.0	Cords		
11	Red Pine	Sawtimber	99.9	MBF	29.1	\$24,864.30
	Red Pine	Pulpwood	364.0	Cords		
12	Red Pine	Sawtimber	43.7	MBF	15.9	\$15,010.40
	Red Pine	Pulpwood	277.0	Cords		
TOTAL:			855.3	MBF		
TOTAL:			4,072.0	Cords		

Sale Specific Conditions & Requirements

Sale Name: GNA Dean Marten Pine 1

Sale Number: 63-816-19 Seq#: 1

1 - Sale Area

1.2 - Boundaries

1.2.1 - Painted boundaries (1/14)

The sale boundary and Payment Unit boundaries are marked and identified by orange and yellow paint. Exterior sale boundary lines against private property are marked with orange paint and red paint on property line trees. Exterior sale boundary lines against federal property are marked with orange paint. Interior Payment Unit boundaries and interior decline pockets are marked with yellow paint. The painted boundary line and Payment Unit line trees are not Included Timber and are to be protected unless marked with blue paint.

2 - Timber Specifications

2.1 - Included Timber

2.1.1 - Clearcut unit(s) with unmerchantable trees (6/14)

Within Payment Unit(s) 3, cut all trees that are two (2) inches or more at DBH, except do not cut oak.

2.1.3 - Cut tree marked unit(s) (12/08)

Within Payment Unit(s) 2, 4, 5, 7, 8, 9, 10, and 11, all trees are designated for cutting when marked with blue paint above and below stump height, regardless of merchantability. In addition, within Payment Units 4, 7, and 8 (two areas), there are small areas of pine decline and mortality which have been lined with yellow paint. Within these areas, cut all merchantable red pine trees. Also, within Payment Units 5, 8, 9, 10, and 11, cut all beech and ironwood trees that are greater than 2 inches at DBH.

2.1.4 - Designated timber unit(s) (6/17)

Within Payment Unit(s) 1, all red pine trees that are two (2) inches or more at DBH are designated for cutting.

2.1.8 - Designated plantation row unit(s) (12/08)

Within Payment Unit(s) 6, all red pine trees which meet minimum piece specifications in 2.2 Utilization, within designated plantation rows are designated for cutting. Designated plantation rows begin with the third row in from the outside of the plantation, then continue every third row. Because of the variability of row direction, it shall be the responsibility of the producer to maintain the third row sequence.

Within Payment Unit(s) 12, all red pine trees which meet minimum piece specifications in 2.2 Utilization, within designated plantation rows are designated for cutting. Designated plantation rows generally follow a cut two, leave three pattern. Because of the variability of row direction, enough trees have been marked with blue paint to help the producer follow the rows to be cut.

2.2 - Utilization

2.2.4 - Skidding length (2/14)

Skidding of unlimbed tops or lengths over 17 feet is not permissible, except in Payment Unit 3.

2.2.6 - Roundwood operation required (5/07)

The skidding of whole trees or tree segments with limbs attached is prohibited within Payment Units 2, 4, 5, 6, 7, 8, 9, 10, 11, and 12. All products must be produced as roundwood and forwarded to existing roads or landing areas in final product length. Utility pole production will be allowed, but all other products must be produced as short wood.

2.2.9 - No chipping permitted (12/08)

Within Payment Unit(s) 2, 4, 5, 6, 7, 8, 9, 10, 11, and 12, all wood must be removed by roundwood. No chipping is permitted. Tops may be piled in brush piles or distributed throughout the sale area. Dead standing trees should not be harvested unless necessary for safety concerns. If dead standing trees are cut, they should be left for coarse woody debris.

2.2.12 - GNA, cut and remove Included Timber (3/18)

Unless provided otherwise herein, the DNR agrees to sell and permit Purchaser to cut and remove Included Timber and

Purchaser agrees to purchase, cut, and remove Included Timber.

3 - Payments

3.3 - Pre-measured Sales

3.3.4 - Dividing payment units (7/14)

Payment Unit(s) greater than \$20,000 may be divided at the request of the Purchaser and upon approval of the Unit Manager. Dividing Payment Units is a contract modification which requires a Timber Sale Contract Supplement. There will be only one division per Payment Unit.

3.4 - Damaged Timber

3.4.1 - Damaged timber (6/14)

General Condition and Requirement 3.4 Damaged Timber, defines liquidated damages for undesignated live merchantable trees which are cut or injured. In addition, extreme care should be taken to avoid damage to tree seedlings and saplings within Payment Unit 1.

Within Payment Unit 1, if more than 25% of the tree seedlings or saplings (1/4" to 4.5" DBH) within a specified portion of the sale area are damaged, liquidated damages will be assessed at \$300 per acre for all acreage within that specified portion of the sale area that was damaged.

No damage is acceptable to merchantable trees. Within the sale area, if more than 5% of trees (> 4.5" DBH) within a specified area of the sale are damaged, liquidated damages will be assessed for all trees damaged. Rates will be in accordance with General Condition and Requirement 3.4 Damaged Timber.

4 - Transportation

4.1 - Construction

4.1.3 - Slash and earthen piles (8/04)

Piles or windrows of earth along roads and landings that have been widened or constructed shall be leveled. Slash from road maintenance or construction, including stumps, shall be dispersed throughout the sale.

4.1.6 - Road construction (1/09)

Construction of new roads or improvements of existing roads shall be done in such a way as to minimize the environmental and visual impacts. Merchantable trees shall be cut and utilized unless otherwise directed. Non-merchantable trees shall be severed and laid flat on the ground. Slash shall be scattered, and not left in windrows and kept a minimum of 10 feet back from the road edge. Stumps shall be set upright, not left on edge, and be moved at least 10 feet away from the road edge. Disturbed soil shall be feathered into the woods and not left in berms or windrows.

4.1.7 - Road closure (10/11)

All new roads built into the sale must be blocked to vehicle traffic within 30 days of completion of hauling. Overgrown roads that are reopened shall be considered new roads. In general, this will require constructing a four (4') foot high berm of stumps and logs covered with earth. These roads must be rendered impassable to cars, trucks and ORVs. Temporary berms may be required if no sale activity occurs for 30 or more consecutive days. Contact the sale administrator for specific details of design and placement.

5 - Operations

5.1 - Notification

5.1.1 - Pre-sale conference (10/16)

A pre-sale conference on site between the Purchaser and sale administrator is required prior to beginning any operations to determine landing and road locations and review sale specific conditions. The Unit Manager or his representative must be contacted at least 5 days in advance to schedule the conference.

5.2 - Conduct of Operations

5.2.1 - Slash

5.2.1.8 - Slash height (12/08)

No slash or tree tops may exceed 36 inches in height.

5.2.2 - Hazard Trees/Snags

5.2.2.1 - Den trees (10/16)

Obvious hollow and/or den trees shall be protected and left standing unless they are a safety hazard.

5.2.3 - Operating Restrictions

5.2.3.4 - Oak wilt restriction, no exceptions (1/18)

Within Payment Unit(s) 3, cutting, skidding, hauling within the sale and brushing of access roads to the sale are not permitted during the period of April 15 to July 15. No exceptions will be granted. This is necessary to reduce the spread of oak wilt.

5.2.3.11 - Coppice regeneration protection (4/10)

Within Payment Unit(s) 3, harvesting is not permitted during the period of April 1 through September 30. Timber harvesting in any Payment Unit must be completed before significant aspen sprouting occurs in that Payment Unit so as to minimize damage to the new regeneration. Any post harvest operations, such as chipping, must be completed before sprouting of regeneration occurs. If it is anticipated that chipping will be delayed, then tops shall be carried to one central location or left unchipped. The Unit Manager or his/her representative may cease such operations if sprouting occurs before the operation is complete.

5.2.3.14 - GNA, heterobasidion root disease (HRD) (9/19)

This plantation is at risk of infection by the root rot fungus, *Heterobasidion irregulare*. To prevent the spread of this disease, cutting operations within Payment Unit(s) 1, 2, 4, 5, 6, 7, 8, 9, 10, 11, and 12 are restricted to the period of January 1st through February 28th. Cutting may only occur outside this period with written permission of the Unit Manager or with the application of a preventative pesticide. Consultation with a forest health specialist will determine if cutting can occur prior to January 1 without pesticide application, dependent upon current and forecasted snow cover. Cellu-Treat and RotStop C are currently the only EPA registered products available in the United States for the control of *Heterobasidion*. Both products are a water-soluble powder that must be applied to the stump, in accordance with the product label. Dye must be added to these products to provide visible evidence of adequate coverage. Application of these pesticides requires licensing by the Michigan Department of Agriculture and Rural Development. All applicators are required to: provide to the Sale Administrator notification of application per requirements in 40 CFR 170.120; and document and provide to the Sale Administrator annually, by December 31 and prior to closure of sale, the volume of product used and acres treated.

5.2.4 - Dead and Down Creation

5.2.4.6 - Dead and down creation, other (9/09)

To improve wildlife habitat, within Payment Unit 3, the Purchaser shall ensure that there are at least 3 large (>10" diameter) pieces of wood left per acre. If they are not already on the ground, the Producer shall leave cull pieces.

5.2.20 - Equipment width (2/04)

Equipment used to remove designated rows must be capable of moving through cut rows without damaging residual trees.

5.2.32 - Decking/landing restoration (9/13)

All decking and landing areas must have the surface area restored to a condition equal to or better than before. This is to ensure the proper regeneration of the stand. Wood debris, chips and "cookies" from trimmings must be removed or scattered away from landing and loading areas and may not be windrowed on the edge.

5.2.38 - No decking against live trees (2/04)

Cut products may not be decked against unmarked or designated leave trees.

5.2.41 - Snowmobile trail protection (9/11)

USFS Road #5030 is a snowmobile trail and is shown on the Timber Sale Map. Do not cut or damage posts with orange trail markers or traffic control signs. From November 30 to April 1, hauling on the designated snowmobile trail will only be allowed on Tuesday, Wednesday and Thursday. Someone must stand at each end of the trail to wave safety flags when trucks are on the snowmobile trail. If the road is used during the off-season, it must be maintained and restored to a condition equal to or better than before the sale, prior to November 30. No decking of forest products will be permitted along the snowmobile trail.

All stumps within 20 feet of the snowmobile trail must be cut at ground level.

5.4 - Soil Protection

5.4.1 - Rutting restriction, general (7/16)

Operations are to cease immediately if equipment and weather conditions result in rutting of roads and/or skid trails which is 12 inches or greater in depth and 50 feet in length. The Unit Manager or his/her representative may restrict hauling and/or skidding if ruts exceed the specified depth. With the Unit Manager or his/her representative's approval, the Purchaser may return to the area when the risk of rutting has decreased.

5.6 - Debris and Waste Material

5.6.2 - GNA, equipment cleaning (1/16)

(a) Areas, known by the DNR prior to timber sale advertisement, that are infested with invasive species of concern are shown on the Timber Sale Map. A current list of invasive species of concern and a map showing the extent of known infestations is available from the DNR. For purposes of this provision, "Off-Road Equipment" includes all logging and construction machinery, except for log trucks, chip vans, service vehicles, water trucks, pickup trucks, cars, and similar vehicles.

(b) Purchaser shall adhere to the following requirements with regard to cleaning "Off-Road Equipment":

(i) Prior to moving Off-Road Equipment onto the Sale Area, Purchaser shall identify the location of the equipment's most recent operation. Purchaser shall not move any Off-Road Equipment that last operated in an area infested with one or more invasive species of concern onto Sale Area without having cleaned such equipment of seeds, soil, vegetative matter, and other debris that could contain or hold seeds, and having notified the DNR, as provided in (iii). If the location of prior operation cannot be identified, then Purchaser shall assume that the location is infested with invasive species of concern.

(ii) Prior to moving Off-Road Equipment from a cutting unit that is shown on the Timber Sale Map to be infested with invasive species of concern to, or through any other area that is shown as being free of invasive species of concern, or infested with a different invasive species, Purchaser shall clean such equipment of seeds, soil, vegetative matter, and other debris that could contain or hold seeds, and shall notify the DNR, as provided in (iii).

(iii) Prior to moving any Off-Road Equipment subject to the cleaning requirements set forth above, Purchaser shall advise DNR of its cleaning measures and make the equipment available for inspection. DNR shall have 2 days, excluding weekends and State holidays, to inspect equipment after it has been made available. After satisfactory inspection or after such 2 day period, Purchaser may move the equipment as planned. Equipment shall be considered clean when a visual inspection does not disclose seeds, soil, vegetative matter, and other debris that could contain or hold seeds. Purchaser shall not be required to disassemble equipment unless so directed by the DNR after inspection.

(iv) If Purchaser desires to clean Off-Road Equipment on National Forest land, such as at the end of a project or prior to moving to, or through an area that is free of invasive species of concern, Purchaser shall obtain prior approval from the Unit Manager or his/her representative as to the location for such cleaning and measures, if any, for controlling impacts.

(v) Unit Manager or his/her representative may order delay, interruption, or modification of this Contract pursuant to Condition & Requirement 7.3 or 7.3.4.

(c) Nothing contained in this Condition & Requirement shall be interpreted as creating any warranty on the part of the DNR that all locations of invasive species of concern have been described herein, elsewhere in this Contract, or designated on the ground. Following sale advertisement, additional locations may be described or designated, and other species may be added to the list of invasive species of concern. In such event, the Unit Manager or his/her representative may order delay, interruption, or modification of this Contract pursuant to Condition & Requirement 7.3 or 7.3.4.

(d) The parties shall promptly communicate with one another with respect to description or designation of additional locations; discovery of locations of new species or new infestation; and, addition of species to the list of invasive species of concern.

5.8 - Protection of Endangered Species

5.8.8 - Protected species, other (2/12)

Within Payment Units 5, 6, 7, 8, 9, 10, 11, and 12, hauling may be restricted from March 1 through July 31. This restriction is to protect goshawk nesting habitat.

6 - Safety and Fire Prevention

6.2 - Signing

6.2.1 - Road posting (9/09)

The Purchaser is responsible for posting and maintaining caution signs on 15 1/2 Road prior to beginning operations. The road must be posted at appropriate distances from the sale area to warn of logging activity and truck traffic. Signs must be removed when harvest operations are suspended or completed. The Purchaser will provide these signs.

6.2.2 - Snowmobile trail posting (8/09)

The Purchaser is responsible for posting and maintaining caution signs on the snowmobile trail (USFS Road # 5030) prior to beginning operations during the snowmobile season (approximately December 1 to March 31). The trail must be posted at appropriate distances from the sale area to warn of logging activity and truck traffic. Signs must be removed when harvest operations are suspended or completed. The Purchaser will provide these signs.

7 - Other Conditions

SKIP

7.1.1 - GNA, title (7/16)

General Condition & Requirement 7.1 is inapplicable. The following applies to this contract.

All right, title, and interest in and to any Included Timber shall remain in USDA Forest Service with the State of Michigan acting on behalf of the USDA Forest Service under this GNA contract, until it has been Measured, removed from Sale Area or other authorized cutting area, and paid for, at which time title shall vest in Purchaser. Title to any Included Timber that has been Measured and paid for, but not removed from Sale Area or other authorized cutting area by Purchaser on or prior to Termination Date, shall remain in USDA Forest Service.

7.3 - Contract Modifications

7.3.3 - Modification for reforestation (8/05)

When contractual work of Purchaser has been accepted for any Payment Unit identified on Sale Area Map, Payment Unit will be eliminated from the Sale Area on written notice so that reforestation operations can begin.

7.3.4 - GNA, contract suspension and modification (5/16)

(a) The Unit Manager may, by written order, delay or interrupt authorized operations under this contract or, notwithstanding Condition & Requirement 7.3, modify this contract, in whole or in part:

(i) To prevent environmental degradation or resource damage, including, but not limited to, harm to habitat, plants, animals, cultural resources, or cave resources;

(ii) To ensure consistency with land and resource management plans or other documents prepared pursuant to the National Environmental Policy Act of 1969, 42 USC 4321-4347;

(iii) To conduct environmental analysis, including, but not limited to, engaging in consultation pursuant to the Endangered Species Act of 1973, 16 USC 1531, et seq.; or

(iv) Upon agreement of the Forest Service, due to administrative appeal or litigation, regardless of whether the Unit Manager's order is required by a court order or this contract is named in such a proceeding.

(b) In the event of an order delaying or interrupting Purchaser's Operations under this Condition & Requirement, Purchaser's remedy shall be:

(i) a no cost contract extension,

(ii) reimbursement for Out-of-Pocket Expenses,

however, the foregoing remedies shall be available only to the extent that the Unit Manager's order was the sole and exclusive cause of the delay or interruption of Purchaser's operations.

(c) Remedies awarded to the Purchaser shall not be duplicative, and the Unit Manager shall have the right to structure remedies provided herein to avoid duplicative compensation.

(d) Purchaser agrees that this Condition & Requirement, and the remedies provided herein shall apply regardless of any finding by any court that the DNR failed to comply with any statute, regulation and/or policy in connection with awarding, advertising, or authorizing this sale, or a similar sale.

7.5 - Loss

7.5.1 - Deteriorating timber (7/09)

The sale area has received damage from various forest health issues. The Purchaser should harvest the wood as soon as possible. The Department of Natural Resources is held free of responsibility of any further damage or deterioration due to delay in harvesting.

7.5.2 - GNA, liability for loss (7/16)

If Included Timber is destroyed or damaged by an unexpected event that changes the nature of Included Timber, such as wind, flood, insects, disease, or similar cause, the Purchaser shall bear the timber value loss resulting from such destruction or damage.

Deterioration or loss of timber value due to delay or interruption under 7.3.4 - GNA, contract suspension and modification, shall be borne by the party holding title. In this event, Included Timber to which USDA Forest Service holds title, Purchaser of the State GNA contract will not be obligated to remove and pay for such timber. This Subsection shall not be construed to relieve either party of liability for negligence.

7.10 - Certified Timber

7.10.1 - Non-certified timber (2/16)

The area encompassed by this timber sale is not certified to the standards of the Forest Stewardship Council (FSC) or the Sustainable Forestry Initiative (SFI). Forest products from this sale may not be delivered to the mill as "FSC and / or SFI certified". The lands within this sale belong to the National Forest system and are being managed by the State as part of a Good Neighbor Authority (GNA) agreement.



TIMBER SALE MAP

This information provided by authority of Part 525, 1994 PA 451, as amended.

Forest Management Unit Huron-Manistee National Forest		County Wexford	Mapped By Armstrong	Date 6/13/2019	Page 1	of 2
Township 22N	Range 11W	Section(s) and Subdivision(s) Sec. 20, 28, 29, 32, 33 (see proposal)		Scale 1:15,840		

Cover Type				Density	
A = Aspen	H = Hemlock	N = Marsh	U = Upland Brush	0 = Non Stocked	5 = Pole Timber Medium
B = Paper Birch	J = Jack Pine	O = Oak	UM = Upland Mixed	1 = Seedling Sapling Poor	6 = Pole Timber Well
C = Cedar	L = Lowland Brush	P = Lowland Poplar	V = Bog or Marsh	2 = Seedling Sapling Medium	7 = Saw Timber Poor
D = Treed Bog	LM = Lowland Mixed	Q = Mixed Swamp Conifer	W = White Pine	3 = Seedling Sapling Well	8 = Saw Timber Medium
E = Swamp Hdwoods	M = Mpl, Bch, Brch	R = Red Pine	X = Non Stocked	4 = Pole Timber Poor	9 = Saw Timber Well
F = Spruce Fir	MC = Mixed Conifer	S = Black Spruce	Z = Water		
G = Grass	MD = Mixed Deciduous	T = Tamarack			

PU	Acres	PU	Acres
1	8.6	7	5.6
2	6.1	8	39.2
3	18.1	9	24.4
4	30.0	10	30.2
5	22.3	11	29.1
6	26.0	12	15.9

GNA Dean Marten Pine 1

Compartments USFS 72 & 79

255.6 acres



Legend

Sale Boundary

- Against Federal (Orange)
- Payment Unit (Yellow)
- Private Line (Orange)
- ▭ Pine Mortality (Yellow)
- - - Roads
- Section Corners
- 🚙 Snowmobile Trails
- Recreational Trail

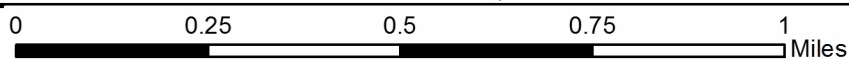
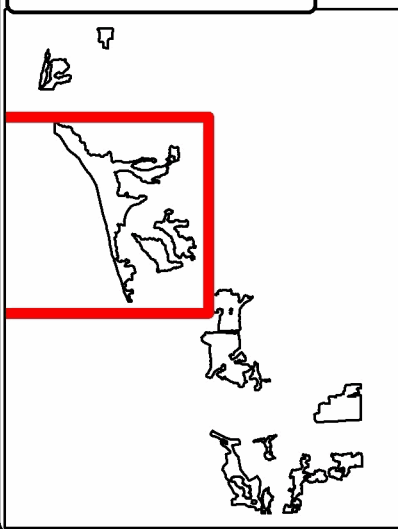
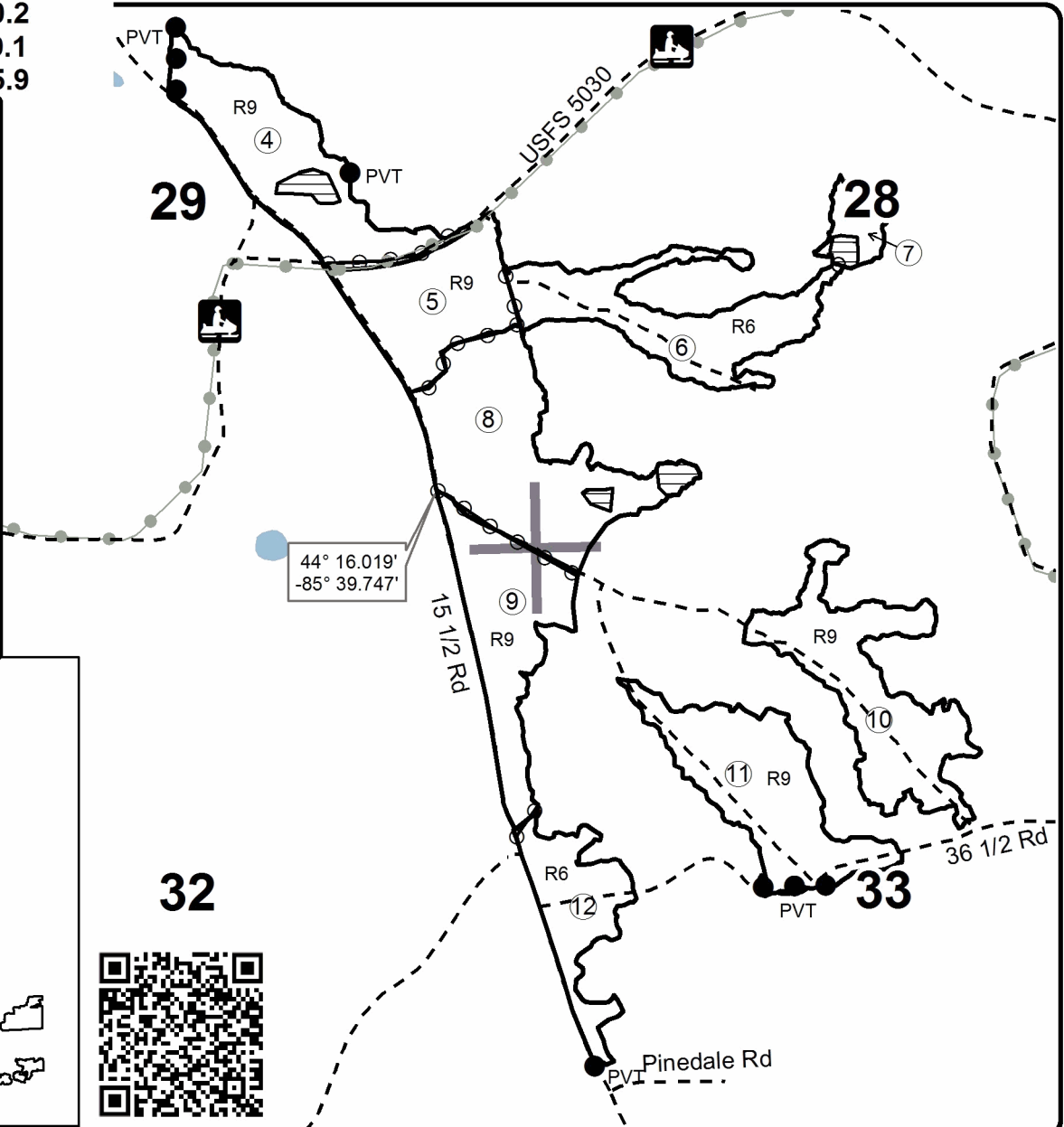



TIMBER SALE MAP

This information provided by authority of Part 525, 1994 PA 451, as amended.

Forest Management Unit Huron-Manistee National Forest		County Wexford	Mapped By Armstrong	Date 6/13/2019	Page 2	of 2
Township 22N	Range 11W	Section(s) and Subdivision(s) Sec. 20, 28, 29, 32, 33 (see proposal)		Scale 1:15,840		

Cover Type				Density	
A = Aspen	H = Hemlock	N = Marsh	U = Upland Brush	0 = Non Stocked	5 = Pole Timber Medium
B = Paper Birch	J = Jack Pine	O = Oak	UM = Upland Mixed	1 = Seedling Sapling Poor	6 = Pole Timber Well
C = Cedar	L = Lowland Brush	P = Lowland Poplar	V = Bog or Marsh	2 = Seedling Sapling Medium	7 = Saw Timber Poor
D = Tread Bog	LM = Lowland Mixed	Q = Mixed Swamp Conifer	W = White Pine	3 = Seedling Sapling Well	8 = Saw Timber Medium
E = Swamp Hdwoods	M = Mpl, Bch, Brch	R = Red Pine	X = Non Stocked	4 = Pole Timber Poor	9 = Saw Timber Well
F = Spruce Fir	MC = Mixed Conifer	S = Black Spruce	Z = Water		
G = Grass	MD = Mixed Deciduous	T = Tamarack			

PU	Acres	PU	Acres
1	8.6	7	5.6
2	6.1	8	39.2
3	18.1	9	24.4
4	30.0	10	30.2
5	22.3	11	29.1
6	26.0	12	15.9

GNA Dean Marten Pine 1

Compartments USFS 72 & 79

255.6 acres



Legend

Sale Boundary

- Against Federal (Orange)
- Payment Unit (Yellow)
- Private Line (Orange)
- ▨ Pine Mortality (Yellow)
- - - Roads
- Section Corners
- 🚙 Snowmobile Trails
- Recreational Trail

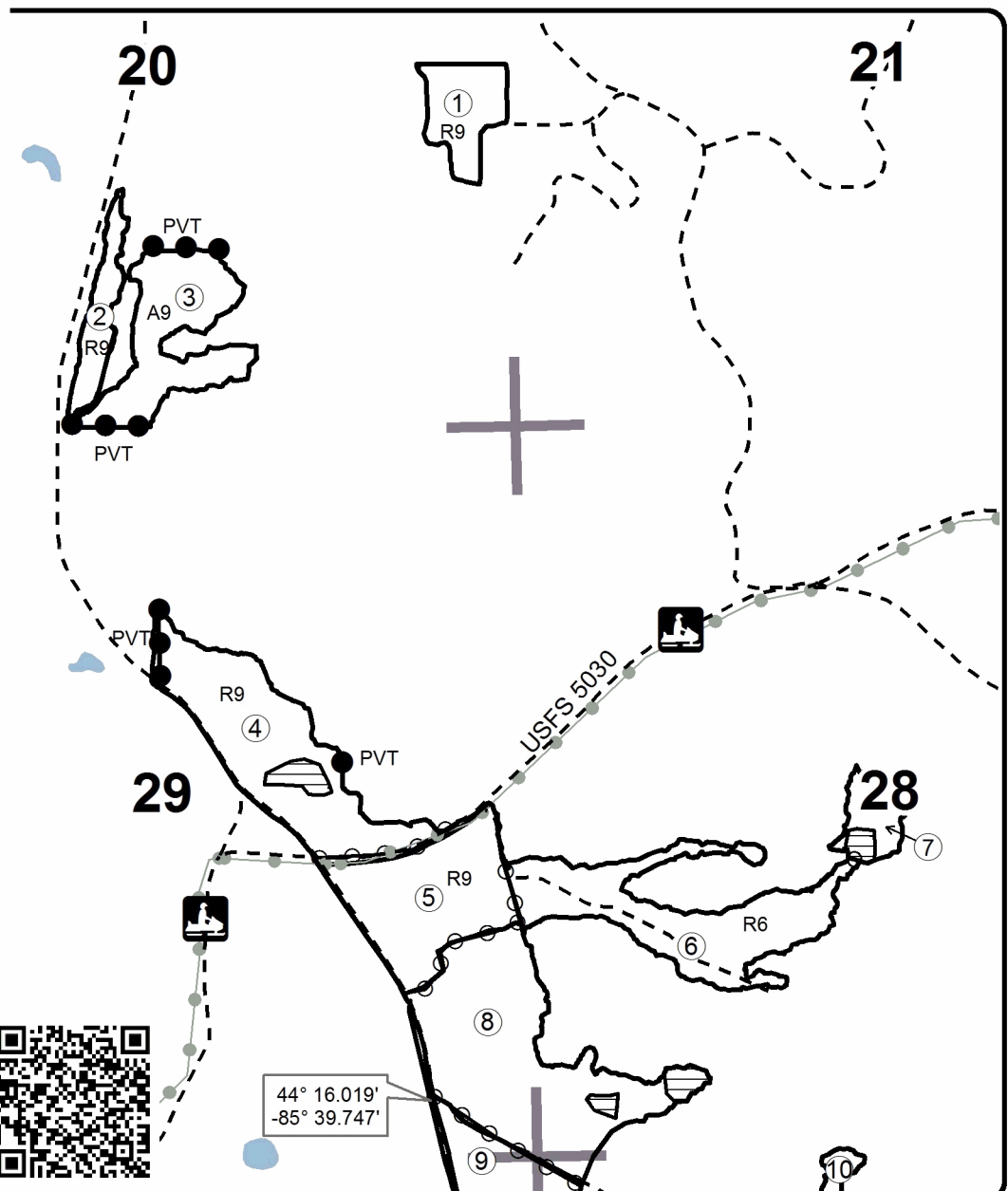
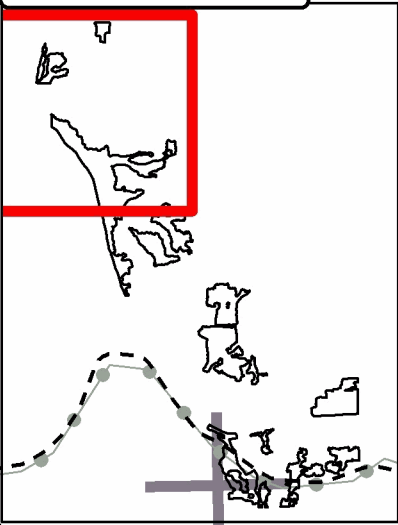

44° 16.019'
-85° 39.747'

