



**DEPARTMENT OF NATURAL RESOURCES
STATE OF MICHIGAN**

TIMBER SALE PROSPECTUS #6541

SCHEDULED SALE DATE AND TIME: 3:00 p.m. (local time) on October 29, 2019.

LOCATION: INDIAN RIVER FIELD OFFICE, 6984 WILSON, INDIAN RIVER, MI 49749.

CONTACT NAME: Lucas Merrick

PHONE NUMBER: (989) 732-3541

PROSPECTUS NOTE: The bidder is advised to inspect the sale area and review the location, estimated volumes, operating costs and contract terms of proposed sales. Please be aware that some landowners may request 60 days or more notice for access across their land.

Notice is hereby given that bids will be received by the Unit Manager, GAYLORD MANAGEMENT UNIT, for certain timber on the following described lands:

Hunny Bunny Mix (52-115-18) / T34N, R02W, SEC. 25, SW,SE.

Cheboygan County, Advertised Price \$35,370.25, 62.7 Acres, Hardwood, Spruce/Fir/Tamarack.

SALE NOTE: Gated access to Payment Units 2-5 may eventually be removed. Disconnected utility lines existed in Payment Unit 2 in summer of 2018.

TIMBER SALE INFORMATION

Hunny Bunny Mix (52-115-18)

T34N, R02W, SEC. 25.

Cheboygan County (Advertised Price \$35,370.25)

SALE NOTE: Gated access to Payment Units 2-5 may eventually be removed. Disconnected utility lines existed in Payment Unit 2 in summer of 2018.

A timber sale contract for this lump sum, sealed bid timber sale will be awarded to the responsible bidder offering the highest sealed bid price. Bids must be at or above the following advertised price for each species:

<u>PRODUCTS & SPECIES</u>	<u>ESTIMATED UNITS*</u>		<u>ADVERTISED PRICE</u>
Sawtimber			
Mixed Aspen	61.50	MBF	\$ 40.00 / MBF
Red Maple	23.60	MBF	\$ 68.00 / MBF
Red Pine	3.40	MBF	\$ 91.00 / MBF
Sugar Maple	47.20	MBF	\$ 204.00 / MBF
Pulpwood			
Balsam Fir	311.00	Cords	\$ 20.20 / Cord
Basswood	37.00	Cords	\$ 6.10 / Cord
Misc. Species 1	2.00	Cords	\$ 2.75 / Cord
Mixed Aspen	166.00	Cords	\$ 15.55 / Cord
Mixed Hardwood	510.00	Cords	\$ 20.80 / Cord
Paper Birch	64.00	Cords	\$ 12.10 / Cord
Red Pine	9.00	Cords	\$ 37.10 / Cord
Scotch Pine	25.00	Cords	\$ 22.25 / Cord

BOND AND PAYMENT SCHEDULE:

1. A bond in the amount of \$1,768.51 to insure faithful performance of the conditions of the contract will be deposited by the successful bidder within 21 days of the sale award.
2. Cutting in any sale or unit without the required advance payment would be considered a trespass.
3. Total payment must be paid in advance or according to the following schedule:
 - (a) Ten percent (10%) of the sale value must be paid within 21 days of the sale award.
 - (b) The 10% down payment will be credited towards the first unit cut.
4. If no cutting takes place, the 10% down payment will not be refunded.
5. Operations on the contract issued will terminate on 12/31/2022.

Description of Timber by Payment Unit (PU)

PU	MARKET GROUP	PRODUCT	QUANTITY	UNIT	ACRES	ADVERTISE PRICE
1	Mixed Aspen	Sawtimber	6.0	MBF	18.0	\$15,252.85
	Quaking Aspen		6.0	MBF		
	Red Maple		21.3	MBF		
	Sugar Maple		15.5	MBF		
	Balsam Fir		192.0	Cords		
	Mixed Aspen		53.0	Cords		
	Mixed Hardwood		256.0	Cords		
	Paper Birch		31.0	Cords		
	2		Mixed Aspen	Sawtimber		
B. T. Aspen		47.3	MBF			
Quaking Aspen		5.9	MBF			
Red Maple		2.3	MBF			
Balsam Fir		119.0	Cords			
Mixed Aspen		108.0	Cords			
Mixed Hardwood		58.0	Cords			
Paper Birch		33.0	Cords			
3		Mixed Hardwood	Pulpwood		3.0	Cords
	Sugar Maple	3.0		Cords		
	Scotch Pine	25.0		Cords		
4	Red Pine	Sawtimber	3.4	MBF	0.7	\$664.10
	Mixed Hardwood	Pulpwood	1.0	Cords		
	Red Pine		9.0	Cords		
5	Mixed Aspen	Sawtimber	2.3	MBF	27.2	\$10,861.35
	B. T. Aspen		2.3	MBF		
	Sugar Maple		31.7	MBF		
	Basswood		37.0	Cords		
	Misc. Species 1		2.0	Cords		
	Mixed Aspen		5.0	Cords		
	Mixed Hardwood		192.0	Cords		
TOTAL:			135.7	MBF		
TOTAL:			1,124.0	Cords		

Sale Specific Conditions & Requirements

Sale Name: Hunny Bunny Mix

Sale Number: 52-115-18 Seq#: 3

1 - Sale Area

1.2 - Boundaries

1.2.1 - Painted boundaries (1/14)

The sale boundary and Payment Unit boundaries are marked and identified by blue, red and yellow paint. Exterior sale boundary lines against private property are marked with blue paint. Exterior sale boundary lines against state are marked with red paint. Interior Payment Unit boundaries are marked with yellow paint. The painted boundary line trees are not Included Timber and are to be protected.

2 - Timber Specifications

2.1 - Included Timber

2.1.1 - Clearcut unit(s) with unmerchantable trees (6/14)

Within Payment Unit(s) 1 and 2, cut all trees that are two (2) inches or more at DBH, except do not cut oak and pine. In addition, within Payment Unit 2, do not cut spruce and hemlock. Special protection trees identified in accordance with condition 3.4.2, within clearcutting unit boundaries, are not Included Timber and are to be protected.

2.1.3 - Cut tree marked unit(s) (12/08)

Within Payment Unit(s) 5, all trees are designated for cutting when marked with orange paint above and below stump height, regardless of merchantability.

2.1.4 - Designated timber unit(s) (6/17)

Within Payment Unit(s) 3, all scotch pine are designated for cutting, regardless of merchantability.

2.1.8 - Designated plantation row unit(s) (12/08)

Within Payment Unit(s) 4, all red pine trees which meet minimum piece specifications in 2.2 Utilization, within designated plantation rows are designated for cutting. Designated plantation rows are every third row.

3 - Payments

3.4 - Damaged Timber

3.4.1 - Damaged timber (7/16)

General Condition and Requirement 3.4 Damaged Timber, defines liquidated damages for undesignated live merchantable trees which are cut or injured. No damage is acceptable to merchantable trees within Payment Units 4 and 5. Within the Payment Units 4 and 5, if more than 5% of trees (> 4.5" DBH) within a specified area of the sale are damaged, liquidated damages will be assessed for all trees damaged. Rates will be in accordance with General Condition and Requirement 3.4 Damaged Timber.

3.6 - Payment Unit Cutting Schedule

3.6.1 - Order of cutting (1/09)

Payment Units shall be cut in numerical order unless the sale is paid in full.

4 - Transportation

4.1 - Construction

4.1.3 - Slash and earthen piles (8/04)

Piles or windrows of earth along roads and landings that have been widened or constructed shall be leveled. Slash from road maintenance or construction, including stumps, shall be dispersed or utilized, not left in piles.

4.1.4 - Timber removed for construction (12/09)

Trees cut or damaged in the process of pre-approved road, landing or skid trail construction will be decked in an area separate

from other Designated Timber and not removed until measured by the sale administrator. Payment will be made at the specified Purchase Unit Price.

4.1.12 - No new roads (1/12)

No new roads will be permitted. All operations are limited to existing roads. Skid trails only will be allowed.

4.2 - Maintenance

4.2.5 - Two wheel drive condition (2/04)

All existing trail roads on and adjacent to the sale area must be passable by two-wheel drive traffic for the duration of the sale.

5 - Operations

5.1 - Notification

5.1.1 - Pre-sale conference (10/16)

A pre-sale conference on site between the Purchaser and sale administrator is required prior to beginning a Payment Unit to determine access and landing locations. The Unit Manager or his/her representative must be contacted at least 10 days in advance to schedule the conference.

5.2 - Conduct of Operations

5.2.1 - Slash

5.2.1.13 - Dispose of slash as directed (12/05)

Slash is to be disposed of as directed by the DNR sale administrator.

5.2.2 - Hazard Trees/Snags

5.2.2.1 - Den trees (10/16)

Obvious hollow and/or den trees shall be protected and left standing unless they are a safety hazard.

5.2.3 - Operating Restrictions

5.2.3.3 - Bark slippage restriction (3/09)

Within Payment Unit(s) 4 and 5, unless changed by written agreement, cutting and skidding are not permitted during the period of April 15 to July 15. This restriction is because of bark slippage.

5.2.29 - Shrub protection (9/07)

Do not cut or damage hawthorn, witch-hazel, dogwood or junberry. These woody-shrub plants are highly beneficial to various wildlife species.

5.2.32 - Decking/landing restoration (9/13)

All decking and landing areas must have the surface area restored to a condition equal to or better than before. This is to ensure the proper regeneration of the stand. Wood debris, chips and "cookies" from trimmings must be removed or scattered away from landing and loading areas and may not be windrowed on the edge.

5.2.38 - No decking against live trees (2/04)

Cut products may not be decked against unmarked or designated leave trees.

5.4 - Soil Protection

5.4.1 - Rutting restriction, general (7/16)

Operations are to cease immediately if equipment and weather conditions result in rutting of roads and/or skid trails which is 12 inches or greater in depth and 50 feet in length. The Unit Manager or his/her representative may restrict hauling and/or skidding if ruts exceed the specified depth. With the Unit Manager or his/her representative's approval, the Purchaser may return to the area when the risk of rutting has decreased.

5.8 - Protection of Endangered Species

5.8.5 - Protection of raptor nests (3/13)

All trees with raptor nests will be protected if found during harvesting operations. Notification will be made to the Unit

Manager or his/her representative who will notify the Wildlife Biologist so an on-site evaluation and recommendation can be made, if necessary.

6 - Safety and Fire Prevention

6.2 - Signing

6.2.1 - Road posting (9/09)

The Purchaser is responsible for posting and maintaining caution signs on Munger Road prior to beginning operations. The road must be posted at appropriate distances from the access road and/or sale area to warn of logging activity and truck traffic. Signs must be removed when harvest operations are suspended or completed. The Purchaser will provide these signs.

**TIMBER SALE MAP**

This information provided by authority of Part 525, 1994 PA 451, as amended.

Sale Number	Year
52 - 115	18

Forest Management Unit Gaylord Management Unit	County Cheboygan	Mapped By TSP	Date 08/15/2018	Page 1	of 2
Township 34N	Range 02W	Section(s) and Subdivision(s) Section 25: S1/2	Scale 1:15,840		

Cover Type				Density	
A = Aspen	H = Hemlock	N = Marsh	U = Upland Brush	0 = Non Stocked	5 = Pole Timber Medium
D = Paper Birch	J = Jack Pine	O = Oak	UM = Upland Mixed	1 = Seedling Sapling Poor	6 = Pole Timber Well
C = Cedar	L = Lowland Brush	P = Lowland Poplar	V = Bog or Marsh	2 = Seedling Sapling Medium	7 = Saw Timber Poor
D = Treed Bog	LM = Lowland Mixed	Q = Mixed Swamp Conifer	W = White Pine	3 = Seedling Sapling Well	8 = Saw Timber Medium
E = Swamp Hardwoods	M = Mpl. Dec. Dec.	R = Red Pine	X = Non Stocked	4 = Pole Timber Poor	9 = Saw Timber Well
F = Spruce Fir	MC = Mixed Conifer	S = Black Spruce	Z = Water		
G = Grass	MD = Mixed Deciduous	T = Tamarack			

PU	Acres	PU	Acres
1	18	4	0.7
2	14.9	5	27.2
3	1.9		

Hunny Bunny Mix

Compartment 173
62.7 Acres

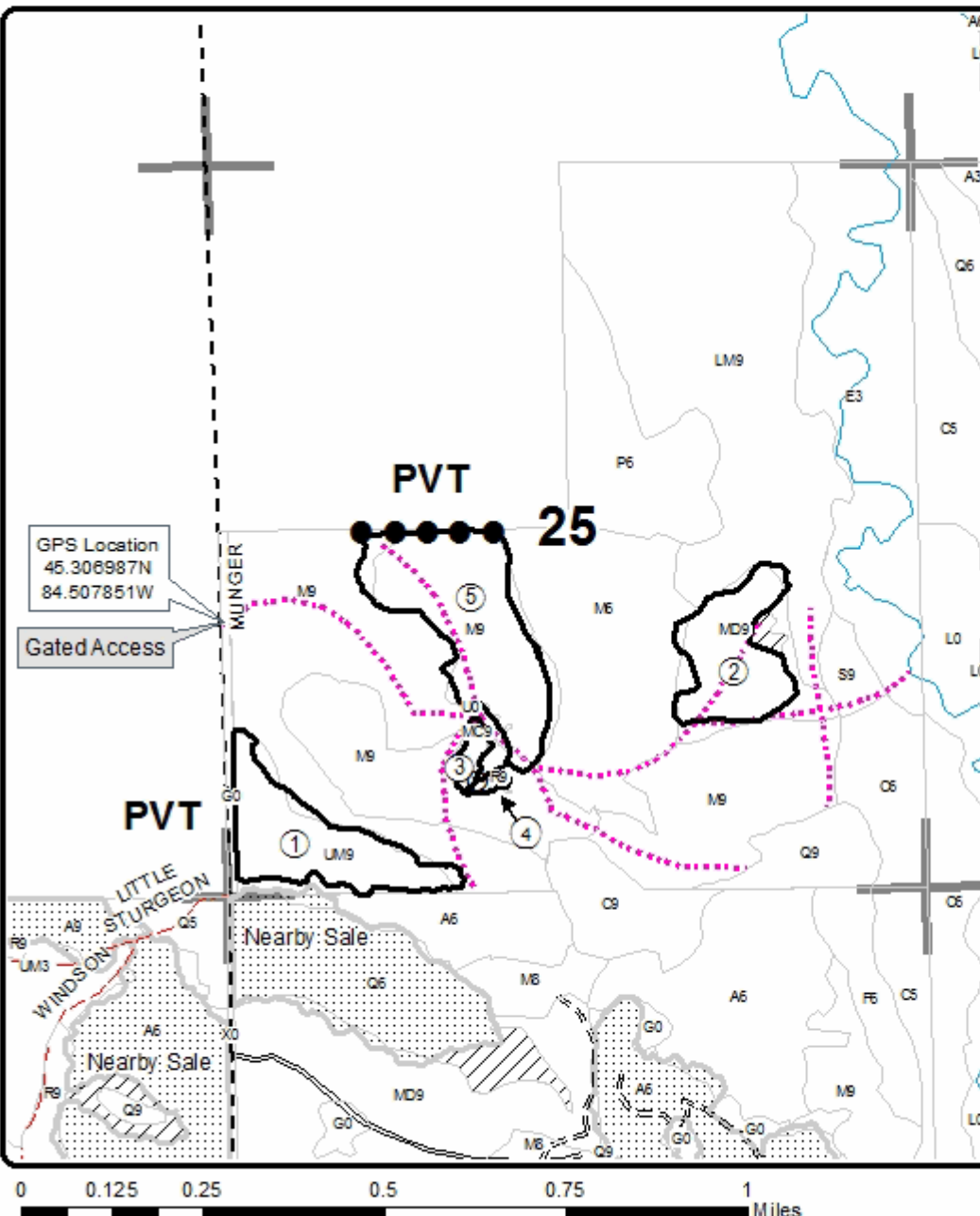
**Legend**

- Against State (Red)
- ○ Payment Unit (Yellow)
- ● Private Line (Blue)
- Stand Boundaries
- ▨ Retention Area
- ⋯ Nearby Timber Sales
- Secondary Forest Road
- == Forest Access Route
- - Gravel Road
- - County Road - Seasonal
- ⋯ Temporary Management Access
- Perennial River
- Section Corners

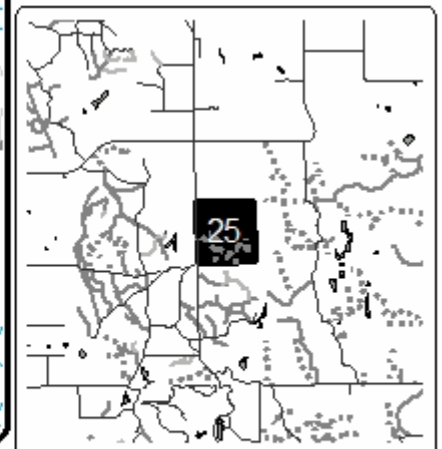
Locator Map
1:200,000

**TIMBER SALE MAP**

This information provided by authority of Part 525, 1994 PA 451, as amended.

Sale Number	Year
52 - 115	18

Forest Management Unit Gaylord Management Unit	County Cheboygan	Mapped By TSP	Date 08/14/2018	Page 2	of 2
Township 34N	Range 02W	Section(s) and Subdivision(s) Section 25: S1/2	Scale 1:1,980		

Cover Type				Density	
A = Aspen	H = Hemlock	N = Marsh	U = Upland Brush	0 = Non Stocked	5 = Pole Timber Medium
D = Paper Birch	J = Jack Pine	O = Oak	UM = Upland Mixed	1 = Seedling Sapling Poor	6 = Pole Timber Well
C = Cedar	L = Lowland Brush	P = Lowland Poplar	V = Bog or Marsh	2 = Seedling Sapling Medium	7 = Saw Timber Poor
D = Treed Bog	LM = Lowland Mixed	Q = Mixed Swamp Conifer	W = White Pine	3 = Seedling Sapling Well	8 = Saw Timber Medium
E = Swamp Hardwoods	M = Mpl, Doh, Birch	R = Red Pine	X = Non Stocked	4 = Pole Timber Poor	9 = Saw Timber Well
F = Spruce Fir	MC = Mixed Conifer	S = Black Spruce	Z = Water		
G = Grass	MD = Mixed Deciduous	T = Tamarack			

PU	Acres	PU	Acres	Payment Units 3 & 4 - Detail Map	
1	18	4	0.7	Compartment 173 62.7 Acres	
2	14.9	5	27.2		
3	1.9				

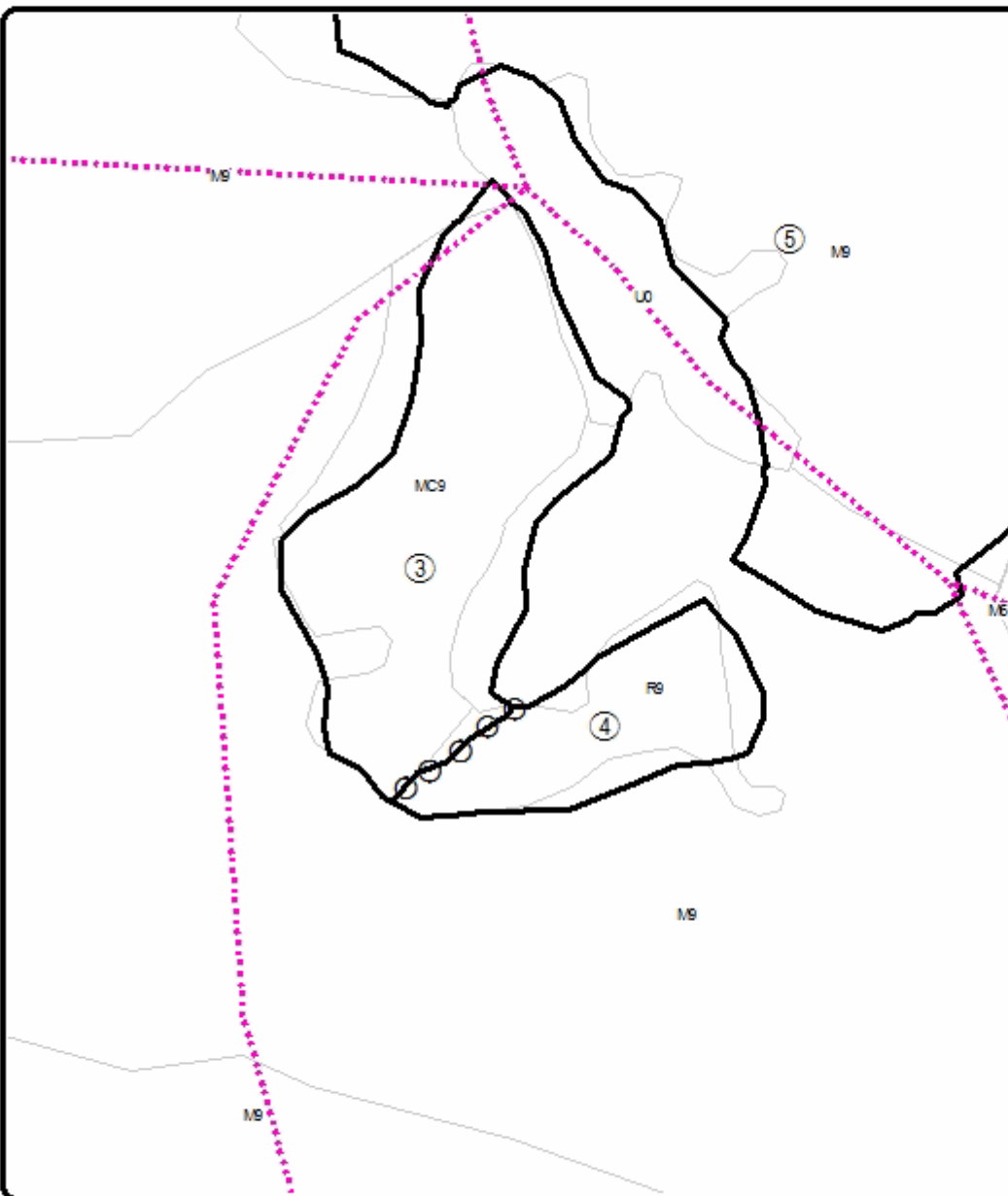
**Legend**

- Temporary Management Access
- Against State (Red)
- Payment Unit (Yellow)
- Stand Boundaries

Locator Map
1:200,000