



**DEPARTMENT OF NATURAL RESOURCES  
STATE OF MICHIGAN  
TIMBER SALE PROSPECTUS #7224**

**SCHEDULED SALE DATE AND TIME: 3:00 p.m. (local time) on August 10, 2023.**

**LOCATION: NEWBERRY MGMT UNIT, PO BOX 428, 5666 S STATE HWY M 123, NEWBERRY, MI 49868.**

**CONTACT NAME: Keith Magnusson**

**PHONE NUMBER: (906) 291-0120**

**PROSPECTUS NOTE:** The bidder is advised to inspect the sale area and review the location, estimated volumes, operating costs and contract terms of proposed sales. Please be aware that some landowners may request 60 days or more notice for access across their land.

Notice is hereby given that bids will be received by the Unit Manager, NEWBERRY MANAGEMENT UNIT, for certain timber on the following described lands:

Kilted Snowmobile (42-009-22) / T49N, R10W, SEC. 16, S1/2NW,SW.  
T49N, R10W, SEC. 17, E1/2SE.

Luce County, Advertised Price \$92,461.00, 121.5 Acres, Red Pine, White Pine.

SALE NOTE: No new roads will be permitted on this sale. See Sale Spec 4.1.12 for details.

Road work is required on this sale. See Sale Spec. 4.2.3 for specifics.

Within Payment Unit(s) 5 and 6, all red pine trees must be felled on-site during August 24th - August 30th, 2025. See Sale Spec 5.2.3.1 for additional information.

The ORV trail is shown on the Timber Sale Map. See Sale Spec. 5.2.39 for restrictions.

The snowmobile trail is shown on the Timber Sale Map. See Sale Spec 5.2.41 for additional information.

A recreation site such as a trail, pathway, or campground is within the sale area or the vicinity. Certain restrictions/specifications may be applicable including time restrictions.

## TIMBER SALE INFORMATION

Kilted Snowmobile (42-009-22)

T49N, R10W, SEC. 16; T49N, R10W, SEC. 17.

Luce County (Advertised Price \$92,461.00)

SALE NOTE: No new roads will be permitted on this sale. See Sale Spec 4.1.12 for details.

Road work is required on this sale. See Sale Spec. 4.2.3 for specifics.

Within Payment Unit(s) 5 and 6, all red pine trees must be felled on-site during August 24th - August 30th, 2025. See Sale Spec 5.2.3.1 for additional information.

The ORV trail is shown on the Timber Sale Map. See Sale Spec. 5.2.39 for restrictions.

The snowmobile trail is shown on the Timber Sale Map. See Sale Spec 5.2.41 for additional information.

A recreation site such as a trail, pathway, or campground is within the sale area or the vicinity. Certain restrictions/specifications may be applicable including time restrictions.

A timber sale contract for this lump sum, sealed bid timber sale will be awarded to the responsible bidder offering the highest sealed bid price. All units of volume listed below were estimated using the Inventory Manager computer program and the new Michigan taper model. Bids must be at or above the following advertised price for each product and species:

<u>PRODUCTS &amp; SPECIES</u>	<u>ESTIMATED UNITS*</u>	<u>ADVERTISED PRICE</u>
Pulpwood		
Jack Pine	5 Cords	\$ 39.30 / Cord
Red Pine	1,119 Cords	\$ 80.40 / Cord
White Pine	103 Cords	\$ 22.30 / Cord

\* The total volume is statistically estimated within plus (+) or minus (-) 10.95 percent. There are an estimated 1,295 cords on this timber sale, plus or minus 142 cords at the 95% confidence level. The estimated units are final and not subject to adjustment. Prospective bidders are urged to examine this timber and to make their own estimates of quantity and quality.

### **BOND AND PAYMENT SCHEDULE:**

1. A bond in the amount of \$4,623.05 to insure faithful performance of the conditions of the contract will be deposited by the successful bidder within 21 days of the sale award.
2. Cutting in any sale or unit without the required advance payment would be considered a trespass.
3. Total payment must be paid in advance or according to the following schedule:
  - (a) Ten percent (10%) of the sale value must be paid within 21 days of the sale award.
  - (b) The 10% down payment will be credited towards the first unit cut.
  - (c) Payment for each of the following units must be made before cutting begins in that unit:

<u>PAYMENT UNIT NUMBER</u>	<u>PERCENT OF TOTAL SALE VALUE</u>
01	21.5%
02	11.8%
03	28.2%
04	15.3%
05	12.6%
06	10.6%

4. If no cutting takes place, the 10% down payment will not be refunded.
5. Operations on the contract issued will terminate on 12/31/2026.

### **SALE STATISTICS**

Volumes were calculated in cubic feet using the Michigan taper model. Cubic foot volume includes all wood inside bark for the product indicated. For display purposes, cubic feet were converted to cords and MBF using a simple conversion factor, e.g. 79 cubic feet per cord and 185 cubic feet per MBF. The cubic foot volumes are precise; the cords and MBF volumes are not. Cubic foot volume cannot be directly converted to cords or boards with precision.

SALE VOLUMES

The total estimated sale volume may not equal the sum of the species/products due to the nature of statistical calculations associated with double sampling methodology.

VOLUME			STATISTICAL RANGE IN CORDS	
TOTAL CUBIC FEET	TOTAL CORDS	PERCENT ERROR	MINIMUM	MAXIMUM
102,324	1,295	10.95%	1,153	1,437

VDU VOLUMES

A VDU is a Volume Determination Unit. Volumes and their associated statistics are calculated at the VDU level and summarized to the sale level. There is often a one to one relationship between a VDU and a Payment Unit, but not always, depending on the cruise design. Refer to the VDU TO PAYMENT UNIT table.

	VOLUME			RANGE IN CORDS	
VDU	TOTAL CUBIC FEET	TOTAL CORDS	PERCENT ERROR	MINIMUM	MAXIMUM
15	22,318	283	18.47%	230	335
31	50,881	644	12.90%	561	727
212	29,124	369	19.09%	298	439
TOTAL:	102,324	1,295		1,090	1,501

VDU TO PAYMENT UNIT

When a VDU is associated with more than one Payment Unit (PU), the VDU volumes are assigned to the PU based on acres of the VDU within the PU.

VDU	VDU ACRES	PU	PU ACRES
15	41.1	5	22.3
		6	18.8
31	41.1	1	17.8
		3	23.3
212	39.3	2	17.1
		4	22.2
TOTAL:	121.5		121.5

**DESCRIPTION OF TIMBER BY PU (PU)**

PU	MARKET GROUP	PRODUCT	QUANTITY	UNIT	ACRES	ADVERTISE PRICE
1	Red Pine	Pulpwood	242	Cords	17.8	\$19,858.20
	Red Pine	Sawtimber	76.5	MBF		
	Red Pine	Pulpwood	89	Cords		
	White Pine		18	Cords		
	White Pine	Sawtimber	4.9	MBF		
	White Pine	Pulpwood	8	Cords		
2	Jack Pine	Pulpwood	2	Cords	17.1	\$10,954.30
	Red Pine		130	Cords		
	Red Pine	Sawtimber	51.3	MBF		
	Red Pine	Pulpwood	27	Cords		
	White Pine		19	Cords		
	White Pine	Sawtimber	5.9	MBF		
White Pine	Pulpwood	7	Cords			
3	Red Pine	Pulpwood	317	Cords	23.3	\$26,022.00
	Red Pine	Sawtimber	100.1	MBF		
	Red Pine	Pulpwood	117	Cords		
	White Pine		24	Cords		
	White Pine	Sawtimber	6.5	MBF		
	White Pine	Pulpwood	11	Cords		
4	Jack Pine	Pulpwood	3	Cords	22.2	\$14,182.60
	Red Pine		168	Cords		
	Red Pine	Sawtimber	66.7	MBF		
	Red Pine	Pulpwood	35	Cords		
	White Pine		25	Cords		
	White Pine	Sawtimber	7.7	MBF		
White Pine	Pulpwood	10	Cords			
5	Red Pine	Pulpwood	142	Cords	22.3	\$11,617.50
	Red Pine		142	Cords		
	White Pine		9	Cords		
	White Pine		9	Cords		
6	Red Pine	Pulpwood	120	Cords	18.8	\$9,826.40
	Red Pine		120	Cords		
	White Pine		8	Cords		
	White Pine		8	Cords		
TOTAL:			1,227	Cords		

## **Sale Specific Conditions & Requirements**

**Sale Name: Kilted Snowmobile**

**Sale Number: 42-009-22 Seq#: 1**

### **1 - Sale Area**

#### **1.2 - Boundaries**

##### **1.2.1 - Painted boundaries (9/19)**

The sale boundary and Payment Unit boundaries are marked and identified by red and yellow paint. Exterior sale boundary lines against state are marked with red paint. Interior Payment Unit boundaries are marked with yellow paint. The painted boundary line trees are not Included Timber and are to be protected. Yellow painted trees designating an interior Payment Unit boundary are only to be cut when all surrounding Payment Units have been paid.

### **2 - Timber Specifications**

#### **2.1 - Included Timber**

##### **2.1.1 - Clearcut unit(s) with unmerchantable trees (6/14)**

Within Payment Unit(s) 5 & 6, cut all trees that are two (2) inches or more at DBH.

##### **2.1.7 - Leave tree marked unit(s) (6/14)**

Within Payment Unit(s) 1-4, all trees, which meet minimum piece specifications in 2.2 Utilization, are designated for cutting except trees marked with green paint above and below stump height.

#### **2.2 - Utilization**

##### **2.2.3 - Stump heights (4/07)**

Stump heights within the Sale Area shall not exceed 6 inches for all trees. This is in order to facilitate planting operations.

### **4 - Transportation**

#### **4.1 - Construction**

##### **4.1.12 - No new roads (1/12)**

No new roads will be permitted in any Payment Unit. All operations are limited to existing roads. Skid trails only will be allowed.

#### **4.2 - Maintenance**

##### **4.2.1 - Hauling restriction (12/08)**

Hauling may be restricted on forest roads by the Unit Manager or his/her representative. The restriction may occur during spring breakup or during wet weather conditions.

##### **4.2.3 - Road maintenance (8/13)**

The following road maintenance may be needed: cleaning of drainage areas, grading, crowning and filling with gravel, if necessary. Damages will be assessed if grading/repair does not occur.

##### **4.2.4 - Grading (10/16)**

For completion of the sale, state forest roads must be graded. In general, this will require a road grader or bull dozer to shape up the roads after forest products have been hauled off site. This includes cleaning of drainage areas, grading, crowning and filling with gravel, if necessary. The grading equipment to be used must be approved by the Unit Manager or his/her representative.

##### **4.2.5 - Two wheel drive condition (2/04)**

All existing trail roads on and adjacent to the sale area must be passable by two-wheel drive traffic for the duration of the sale.

### **5 - Operations**

#### **5.2 - Conduct of Operations**

## 5.2.1 - Slash

### 5.2.1.8 - Slash height (12/08)

No slash or tree tops may exceed 24 inches in height.

## 5.2.2 - Hazard Trees/Snags

### 5.2.2.1 - Den trees (10/16)

Obvious hollow and/or den trees shall be protected and left standing unless they are a safety hazard.

## 5.2.3 - Operating Restrictions

### 5.2.3.1 - Operating restrictions (9/11)

Within Payment Unit(s) 5 & 6 all red pine trees must be felled on-site during August 24th - August 30th, 2025. Trees are to be left whole and must be felled separately and may not be bunched together in piles on the ground. In addition, no harvesting equipment will be permitted to operate in these units from September 1st to September 14th, 2025.

Processing and skidding will be allowed to resume on September 15th. This restriction is because DNR crews will be collecting available red pine cones from all felled trees. Note that if cone collection is finished early, the sale administrator will contact the Purchaser and allow harvesting equipment to return to these units earlier than September 15th.

### 5.2.32 - Decking/landing restoration (9/13)

All decking and landing areas must have the surface area restored to a condition equal to or better than before. This is to ensure the proper regeneration of the stand. Wood debris, chips and "cookies" from trimmings must be removed or scattered away from landing and loading areas and may not be windrowed on the edge.

### 5.2.38 - No decking against live trees (2/04)

Cut products may not be decked against unmarked or designated leave trees.

### 5.2.39 - ORV trail/route protection (4/18)

The ORV trail is shown on the Timber Sale Map. Do not cut trees or damage posts with yellow ORV markers. Trees with yellow ORV markers shall be cut off above the markers and at least 5 feet above ground. All stumps within 5 feet of the trail must be cut flush with the ground. Maintain a 20-foot wide slash, debris, and rut free zone daily using the ORV trail or route as the centerline. Do not run equipment down the ORV trail or route.

### 5.2.41 - Snowmobile trail protection (9/11)

The snowmobile trail is shown on the Timber Sale Map. Do not cut or damage posts with orange trail markers or traffic control signs. If the trail is used, it must be maintained and restored to a condition equal to or better than before the sale. The road maintenance/restoration must be done prior to December 1. If the trail is used for hauling, it must be graded to the satisfaction of the Unit Manager or his/her representative prior to December 1. If the trail road is to be used for hauling during the snowmobile season, then a snow-covered base must be left on the trail. Maintain a 20-foot wide slash, debris and rut-free zone daily, using the snowmobile trail as the centerline. All stumps within 20 feet of the snowmobile trail must be cut at ground level. In addition, any trees cut within 5 feet of the trail must have the stumps removed and be disposed of according to the direction of the Unit Manager or his/her representative.

## 5.4 - Soil Protection

### 5.4.1 - Rutting restriction, general (7/16)

Operations are to cease immediately if equipment and weather conditions result in rutting of roads and/or skid trails which is 12 inches or greater in depth and 50 feet in length. The Unit Manager or his/her representative may restrict hauling and/or skidding if ruts exceed the specified depth. With the Unit Manager or his/her representative's approval, the Purchaser may return to the area when the risk of rutting has decreased.

## 5.8 - Protection of Endangered Species

### 5.8.5 - Protection of raptor nests (3/13)

All trees with raptor nests will be protected if found during harvesting operations. Notification will be made to the Unit Manager or his/her representative who will notify the Wildlife Biologist so an on-site evaluation and recommendation can be made, if necessary.

## **6 - Safety and Fire Prevention**

### **6.2 - Signing**

#### **6.2.1 - Road posting (10/20)**

The Purchaser is responsible for posting and maintaining caution signs on County Road 410 prior to beginning operations. The road must be posted approximately 350 feet from the sale area to warn of logging activity and truck traffic. Signs must be removed when harvest operations are suspended or completed. The Purchaser will provide these signs.

#### **6.2.2 - Snowmobile trail posting (10/20)**

The Purchaser is responsible for posting and maintaining caution signs on the snowmobile trail prior to beginning operations during the snowmobile season (approximately December 1 to March 31). The trail must be posted at appropriate distances from the sale area to warn of logging activity and truck traffic. Signs must be removed when harvest operations are suspended or completed. The Purchaser will provide these signs.

#### **6.2.3 - Recreational trail posting (10/20)**

The Purchaser is responsible for posting and maintaining caution signs on the ORV trail prior to beginning operations. The trail must be posted approximately 350 feet from the sale area to warn of logging activity and truck traffic at both ends of the trail. Signs must be removed when harvest operations are suspended or completed. The Purchaser will provide these signs.

## **7 - Other Conditions**

### **7.3 - Contract Modifications**

#### **7.3.3 - Modification for reforestation (8/05)**

When contractual work of Purchaser has been accepted for any Payment Unit identified on Sale Area Map, Payment Unit will be eliminated from the Sale Area on written notice so that reforestation operations can begin.

**TIMBER SALE MAP***This information provided by authority of Part 525, 1994 PA 451, as amended.*

Sale Number

42-009

Year

22

Forest Management Unit

Newberry

County

Luce

Mapped By L. Livermore

Date

7/22/2022

Page

1

of

1

Township

49N

Range

10W

Section(s) and Subdivision(s)

Section 16: S½NW, SW Section 17: E½SE

Scale

1:15,840

**Cover Type**

A = Aspen	H = Hemlock	N = Marsh	U = Upland Brush
B = Paper Birch	J = Jack Pine	O = Oak	UM = Upland Mixed
C = Cedar	L = Lowland Brush	P = Lowland Poplar	V = Bog or Marsh
D = Treed Bog	LM = Lowland Mixed	Q = Mixed Swamp Conifer	W = White Pine
E = Swamp Hdwoods	M = Mpl, Bch, Brch	R = Red Pine	X = Non Stocked
F = Spruce Fir	MC = Mixed Conifer	S = Black Spruce	Z = Water
G = Grass	MD = Mixed Deciduous	T = Tamarack	

**Density**

0 = Non Stocked	5 = Pole Timber Medium
1 = Seedling Sapling Poor	6 = Pole Timber Well
2 = Seedling Sapling Medium	7 = Saw Timber Poor
3 = Seedling Sapling Well	8 = Saw Timber Medium
4 = Pole Timber Poor	9 = Saw Timber Well



- Against State (Red)
- Payment Unit (Yellow)
- Payment Unit Label
- ORV Trails
- Recreational Trail
- 01 Section Numbers
- Section Corners
- Field Grade Corners
- Lakes and Rivers
- Retention Area
- Highway
- Primary Forest Road
- Secondary Forest Road
- Forest Access Route
- Paved Road
- Gravel Road
- County Road - Seasonal
- Private
- Temporary Management Access

Locator Map: 1:200,000

- Main Map Extent

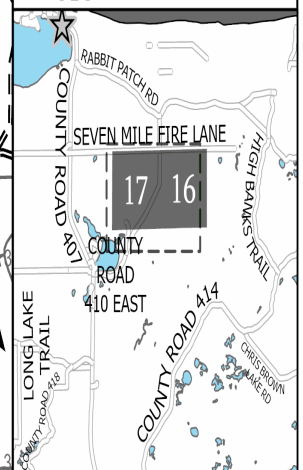

**Kilted Snowmobile**  
**Compartment 025**  
**121.5 Acres**

1	17.8
2	17.1
3	23.3
4	22.2
5	22.3
6	18.8

Approximately 1.6 Miles to  
CR 407 from PU 5