



**DEPARTMENT OF NATURAL RESOURCES  
STATE OF MICHIGAN  
TIMBER SALE PROSPECTUS #7183**

**SCHEDULED SALE DATE AND TIME:** 2:00 p.m. (local time) on August 7, 2023.

**LOCATION:** GWINN MGMT UNIT, 410 WEST M 35, GWINN, MI 49841.

**CONTACT NAME:** Kristen Matson

**PHONE NUMBER:** (906) 346-9201

**PROSPECTUS NOTE:** The bidder is advised to inspect the sale area and review the location, estimated volumes, operating costs and contract terms of proposed sales. Please be aware that some landowners may request 60 days or more notice for access across their land.

Notice is hereby given that bids will be received by the Unit Manager, GWINN MANAGEMENT UNIT, for certain timber on the following described lands:

Duke's Doodles GEMS (32-025-22) / T44N, R26W, SEC. 10, SESE.

T44N, R26W, SEC. 11, SWSW.

T44N, R26W, SEC. 13, SWSW.

T44N, R26W, SEC. 14, NWNW, S1/2NW, SWNE, W1/2SW, SE.

T44N, R26W, SEC. 15, NE, N1/2SE.

T44N, R26W, SEC. 22, SENE.

T44N, R26W, SEC. 23, NW, N1/2NE, SWNE, N1/2SW, SESW.

T44N, R26W, SEC. 24, E1/2SW, W1/2SE.

Marquette County, Advertised Price \$168,174.85, 217.8 Acres, Aspen, Spruce/Fir/Tamarack.

SALE NOTE: A recreation site such as a trail, pathway, or campground is within the sale area or the vicinity. Certain restrictions/specifications may be applicable including time restrictions.

## TIMBER SALE INFORMATION

### Duke's Doodles GEMS (32-025-22)

T44N, R26W, SEC. 10; T44N, R26W, SEC. 11; T44N, R26W, SEC. 13; T44N, R26W, SEC. 14; T44N, R26W, SEC. 15; T44N, R26W, SEC. 22; T44N, R26W, SEC. 23; T44N, R26W, SEC. 24.

SALE NOTE: A recreation site such as a trail, pathway, or campground is within the sale area or the vicinity. Certain restrictions/specifications may be applicable including time restrictions.

A timber sale contract for this lump sum, sealed bid timber sale will be awarded to the responsible bidder offering the highest sealed bid price. All units of volume listed below were estimated using the Inventory Manager computer program and the new Michigan taper model. Bids must be at or above the following advertised price for each product and species:

<u>PRODUCTS &amp; SPECIES</u>	<u>ESTIMATED UNITS*</u>	<u>ADVERTISED PRICE</u>
Sawtimber		
Basswood	31.5 MBF	\$ 35.00 / MBF
Paper Birch	9.5 MBF	\$ 64.00 / MBF
Red Maple	32.0 MBF	\$ 137.00 / MBF
Sugar Maple	29.8 MBF	\$ 173.00 / MBF
Pulpwood		
Balsam Fir	1,057 Cords	\$ 15.90 / Cord
Mixed Aspen	4,427 Cords	\$ 25.25 / Cord
Mixed Hardwood	1,079 Cords	\$ 15.70 / Cord
Mixed Spruce	394 Cords	\$ 23.15 / Cord
Tamarack	74 Cords	\$ 30.75 / Cord

\* The total volume is statistically estimated within plus (+) or minus (-) 9.14 percent. There are an estimated 7,041 cords on this timber sale, plus or minus 644 cords at the 95% confidence level. The estimated units are final and not subject to adjustment. Prospective bidders are urged to examine this timber and to make their own estimates of quantity and quality.

### **BOND AND PAYMENT SCHEDULE:**

1. A bond in the amount of \$8,408.74 to insure faithful performance of the conditions of the contract will be deposited by the successful bidder within 21 days of the sale award.
2. Cutting in any sale or unit without the required advance payment would be considered a trespass.
3. Total payment must be paid in advance or according to the following schedule:
  - (a) Ten percent (10%) of the sale value must be paid within 21 days of the sale award.
  - (b) The 10% down payment will be credited towards the first unit cut.
  - (c) Payment for each of the following units must be made before cutting begins in that unit:

<u>PAYMENT UNIT NUMBER</u>	<u>PERCENT OF TOTAL SALE VALUE</u>
01	15.0%
02	14.5%
03	7.2%
04	18.4%
05	22.5%
06	3.9%
07	8.2%
08	3.4%
09	2.8%
10	4.1%

4. If no cutting takes place, the 10% down payment will not be refunded.
5. Operations on the contract issued will terminate on 08/31/2026.

### **SALE STATISTICS**

Volumes were calculated in cubic feet using the Michigan taper model. Cubic foot volume includes all wood inside bark for the product indicated. For display purposes, cubic feet were converted to cords and MBF using a simple conversion factor, e.g. 79 cubic feet per cord and 185 cubic feet per MBF. The cubic foot volumes are precise; the cords and MBF volumes are not. Cubic foot volume cannot be directly converted to cords or boards with precision.

## SALE VOLUMES

The total estimated sale volume may not equal the sum of the species/products due to the nature of statistical calculations associated with double sampling methodology.

VOLUME			STATISTICAL RANGE IN CORDS	
TOTAL CUBIC FEET	TOTAL CORDS	PERCENT ERROR	MINIMUM	MAXIMUM
556,261	7,041	9.14%	6,398	7,685

## VDU VOLUMES

A VDU is a Volume Determination Unit. Volumes and their associated statistics are calculated at the VDU level and summarized to the sale level. There is often a one to one relationship between a VDU and a Payment Unit, but not always, depending on the cruise design. Refer to the VDU TO PAYMENT UNIT table.

	VOLUME			RANGE IN CORDS	
VDU	TOTAL CUBIC FEET	TOTAL CORDS	PERCENT ERROR	MINIMUM	MAXIMUM
1	11,362	144	39.00%	88	200
18	23,147	293	50.17%	146	440
76	223,160	2,825	11.35%	2,504	3,145
77	78,942	999	32.13%	678	1,320
95	120,220	1,522	18.21%	1,245	1,799
148	24,087	305	60.39%	121	489
153	51,351	650	21.78%	508	792
170	23,992	304	69.06%	94	513
<b>TOTAL:</b>	<b>556,261</b>	<b>7,041</b>		<b>5,384</b>	<b>8,699</b>

## VDU TO PAYMENT UNIT

When a VDU is associated with more than one Payment Unit (PU), the VDU volumes are assigned to the PU based on acres of the VDU within the PU.

VDU	VDU ACRES	PU	PU ACRES
1	9.8	9	9.8
18	7.1	10	7.1
76	85.9	2	31.1
		3	15.4
		4	39.4
77	20.0	1	20.0
95	41.2	5	41.2
148	17.7	8	17.7
153	27.0	7	27.0
170	9.1	6	9.1
<b>TOTAL:</b>	<b>217.8</b>		<b>217.8</b>

**DESCRIPTION OF TIMBER BY PU (PU)**

PU	MARKET GROUP	PRODUCT	QUANTITY	UNIT	ACRES	ADVERTISE PRICE
1	Basswood	Sawtimber	23.0	MBF	20.0	\$25,205.75
	Balsam Fir	Pulpwood	137	Cords		
	Mixed Aspen		824	Cords		
	<i>B. T. Aspen</i>		52	Cords		
	<i>Balsam Poplar</i>		21	Cords		
	<i>Quaking Aspen</i>		751	Cords		
	Mixed Hardwood		74	Cords		
	<i>Basswood</i>		22	Cords		
	<i>Ironwood</i>		7	Cords		
	<i>Sugar Maple</i>		45	Cords		
	Mixed Spruce		11	Cords		
	<i>White Spruce</i>		11	Cords		
2	Basswood	Sawtimber	1.6	MBF	31.1	\$24,459.95
	Paper Birch		1.8	MBF		
	Balsam Fir	Pulpwood	131	Cords		
	Mixed Aspen		791	Cords		
	<i>Balsam Poplar</i>		52	Cords		
	<i>Quaking Aspen</i>		739	Cords		
	Mixed Hardwood		23	Cords		
	<i>Basswood</i>		1	Cords		
	<i>Paper Birch</i>		12	Cords		
	<i>Red Maple</i>		10	Cords		
	Mixed Spruce		45	Cords		
	<i>Black Spruce</i>		27	Cords		
	<i>White Spruce</i>		18	Cords		
	Tamarack		27	Cords		
3	Basswood	Sawtimber	0.8	MBF	15.4	\$12,098.85
	Paper Birch		0.9	MBF		
	Balsam Fir	Pulpwood	65	Cords		
	Mixed Aspen		392	Cords		
	<i>Balsam Poplar</i>		26	Cords		
	<i>Quaking Aspen</i>		366	Cords		
	Mixed Hardwood		11	Cords		
	<i>Paper Birch</i>		6	Cords		
	<i>Red Maple</i>		5	Cords		
	Mixed Spruce		22	Cords		
	<i>Black Spruce</i>		13	Cords		
	<i>White Spruce</i>		9	Cords		
	Tamarack		13	Cords		
4	Basswood	Sawtimber	2.0	MBF	39.4	\$31,018.40
	Paper Birch		2.3	MBF		
	Balsam Fir	Pulpwood	166	Cords		
	Mixed Aspen		1,003	Cords		
	<i>Balsam Poplar</i>		66	Cords		
	<i>Quaking Aspen</i>		937	Cords		
	Mixed Hardwood		30	Cords		
	<i>Basswood</i>		1	Cords		
	<i>Paper Birch</i>		16	Cords		
	<i>Red Maple</i>		13	Cords		
	Mixed Spruce		57	Cords		
	<i>Black Spruce</i>		34	Cords		
	<i>White Spruce</i>		23	Cords		
	Tamarack		34	Cords		
5	Paper Birch	Sawtimber	2.6	MBF	41.2	\$37,857.40
	Red Maple		6.7	MBF		

**DESCRIPTION OF TIMBER BY PU (PU), CON'T**

PU	MARKET GROUP	PRODUCT	QUANTITY	UNIT	ACRES	ADVERTISE PRICE
5 con't	Sugar Maple	Sawtimber	12.6	MBF		
	Balsam Fir	Pulpwood	156	Cords		
	Mixed Aspen		1,001	Cords		
	<i>Balsam Poplar</i>		154	Cords		
	<i>Quaking Aspen</i>		847	Cords		
	Mixed Hardwood		263	Cords		
	<i>Basswood</i>		10	Cords		
	<i>Black Ash</i>		20	Cords		
	<i>Paper Birch</i>		38	Cords		
	<i>Red Maple</i>		58	Cords		
	<i>Sugar Maple</i>		137	Cords		
	Mixed Spruce		117	Cords		
	<i>White Spruce</i>		117	Cords		
6	Basswood	Sawtimber	2.2	MBF	9.1	\$6,528.25
	Red Maple		3.3	MBF		
	Balsam Fir	Pulpwood	51	Cords		
	Mixed Aspen		113	Cords		
	<i>Balsam Poplar</i>		99	Cords		
	<i>Quaking Aspen</i>		14	Cords		
	Mixed Hardwood		75	Cords		
	<i>Basswood</i>		13	Cords		
	<i>Black Cherry</i>		9	Cords		
	<i>Red Maple</i>		15	Cords		
	<i>Sugar Maple</i>		31	Cords		
	<i>Yellow Birch</i>		7	Cords		
	Mixed Spruce		50	Cords		
	<i>White Spruce</i>		50	Cords		
7	Balsam Fir	Pulpwood	197	Cords	27.0	\$13,779.15
	Mixed Aspen		281	Cords		
	<i>Balsam Poplar</i>		183	Cords		
	<i>Quaking Aspen</i>		98	Cords		
	Mixed Hardwood		123	Cords		
	<i>Black Cherry</i>		66	Cords		
	<i>Ironwood</i>		8	Cords		
	<i>Paper Birch</i>		7	Cords		
	<i>Red Maple</i>		4	Cords		
	<i>Sugar Maple</i>		38	Cords		
	Mixed Spruce		70	Cords		
	<i>White Spruce</i>		70	Cords		
8	Paper Birch	Sawtimber	1.9	MBF	17.7	\$5,656.20
	Sugar Maple		2.7	MBF		
	Balsam Fir	Pulpwood	125	Cords		
	Mixed Aspen		22	Cords		
	<i>Quaking Aspen</i>		22	Cords		
	Mixed Hardwood		149	Cords		
	<i>Black Cherry</i>		6	Cords		
	<i>Paper Birch</i>		9	Cords		
	<i>Red Maple</i>		102	Cords		
	<i>Sugar Maple</i>		32	Cords		
	Mixed Spruce		8	Cords		
	<i>White Spruce</i>		8	Cords		
9	Basswood	Sawtimber	1.9	MBF	9.8	\$4,634.20
	Red Maple		3.8	MBF		
	Sugar Maple		14.5	MBF		
	Mixed Hardwood	Pulpwood	98	Cords		

DESCRIPTION OF TIMBER BY PU (PU), CON'T

PU	MARKET GROUP	PRODUCT	QUANTITY	UNIT	ACRES	ADVERTISE PRICE
9 con't	<i>Basswood</i>	<i>Pulpwood</i>	5	<i>Cords</i>		
	<i>Red Maple</i>		24	<i>Cords</i>		
	<i>Sugar Maple</i>		69	<i>Cords</i>		
10	Red Maple	Sawtimber	18.2	MBF	7.1	\$6,936.70
	Balsam Fir	Pulpwood	29	Cords		
	Mixed Hardwood		233	Cords		
	<i>Red Maple</i>		233	<i>Cords</i>		
	Mixed Spruce		14	Cords		
	<i>White Spruce</i>		14	<i>Cords</i>		
TOTAL:			102.8	MBF		
TOTAL:			7,031	Cords		

## **Sale Specific Conditions & Requirements**

**Sale Name: Duke's Doodles GEMS**

**Sale Number: 32-025-22 Seq#: 1**

### **1 - Sale Area**

#### **1.2 - Boundaries**

##### **1.2.1 - Painted boundaries (9/19)**

The sale boundary and Payment Unit boundaries are marked and identified by red, and yellow paint. Exterior sale boundary lines against state are marked with red paint. Interior Payment Unit boundaries are marked with yellow paint. The painted boundary line trees are not Included Timber and are to be protected unless marked with orange paint. Yellow painted trees designating an interior Payment Unit boundary are only to be cut when all surrounding Payment Units have been paid.

### **2 - Timber Specifications**

#### **2.1 - Included Timber**

##### **2.1.1 - Clearcut unit(s) with unmerchantable trees (6/14)**

Within Payment Unit(s) 1-8 and 10, cut all trees that are two (2) inches or more at DBH, with the following exceptions:

- Within Payment Units 2-4, do not cut spruce larger than 26 inches at DBH.
- Within Payment Units 5 and 6, do not cut cedar, hemlock, and white pine.
- Within Payment Unit 8, do not cut cedar, yellow birch, and maple, unless marked with orange paint above and below stump height, regardless of merchantability.
- Within Payment Unit 10, do not cut cedar, hemlock, yellow birch, and cherry.

##### **2.1.3 - Cut tree marked unit(s) (12/08)**

Within Payment Unit(s) 9, all trees are designated for cutting when marked with orange paint above and below stump height, regardless of merchantability. In addition, all merchantable spruce and fir are designated for cutting.

#### **2.2 - Utilization**

##### **2.2.4 - Skidding length (2/14)**

Within Payment Unit 9, skidding of unlimbed tops, or lengths over 17 feet is not permissible, unless approved by unit manager and or his/her representative.

### **3 - Payments**

#### **3.4 - Damaged Timber**

##### **3.4.1 - Damaged timber (7/16)**

General Condition and Requirement 3.4 Damaged Timber, defines liquidated damages for undesignated live merchantable trees which are cut or injured. In addition, extreme care should be taken to avoid damage to tree seedlings and saplings within Payment Unit 9. No damage is acceptable to undesignated live merchantable trees. Within the sale area, if more than 5% of trees (> 4.5" DBH) within a specified area of the sale are damaged, liquidated damages will be assessed for all trees damaged. Rates will be in accordance with General Condition and Requirement 3.4 Damaged Timber.

### **4 - Transportation**

#### **4.1 - Construction**

##### **4.1.3 - Slash and earthen piles (8/04)**

Piles or windrows of earth along roads and landings that have been widened or constructed shall be leveled. Slash from road maintenance or construction, including stumps, shall be dispersed throughout the sale.

##### **4.1.4 - Timber removed for construction (12/09)**

Trees cut or damaged in the process of pre-approved road, landing or skid trail construction will be decked in an area separate from other Designated Timber and not removed until measured by the sale administrator. Payment will be made at the specified Purchase Unit Price.

#### 4.1.6 - Road construction (1/09)

Construction of new roads or improvements of existing roads shall be done in such a way as to minimize the environmental and visual impacts. Merchantable trees shall be cut and utilized unless otherwise directed. Non-merchantable trees shall be severed and laid flat on the ground. Slash shall be scattered, and not left in windrows and kept a minimum of 10 feet back from the road edge. Stumps shall be set upright, not left on edge, and be moved at least 10 feet away from the road edge. Disturbed soil shall be feathered into the woods and not left in berms or windrows.

#### 4.1.7 - Road closure (10/11)

All new roads built into the sale must be blocked to vehicle traffic upon completion of the sale. Overgrown roads that are reopened shall be considered new roads. In general, this will require constructing a four (4') foot high berm of stumps and logs covered with earth. Contact the sale administrator for specific details of design and placement.

### 4.2 - Maintenance

#### 4.2.2 - Fill material (4/07)

To maintain roads, fill material may be needed in areas where "holes" exist or may be expected to develop. This fill material should be placed before trucking begins. Depending on the time of year, multiple areas may require fill material for access across the sale area. Contact the sale administrator regarding the availability of onsite sand or gravel from adjacent State-owned lands.

#### 4.2.4 - Grading (10/16)

For completion of the sale, state forest roads must be graded. In general, this will require a road grader or bull dozer to shape up the roads after forest products have been hauled off site. This includes cleaning of drainage areas, grading, crowning and filling with gravel, if necessary. The grading equipment to be used must be approved by the Unit Manager or his/her representative.

### 4.4 - Access

#### 4.4.3 - Access gate (12/08)

The access gate(s) must be locked at the completion of each day unless otherwise approved by the Unit Manager or his/her representative.

## 5 - Operations

### 5.1 - Notification

#### 5.1.1 - Pre-sale conference (10/16)

A pre-sale conference between the Purchaser and sale administrator is required prior to beginning any operations. The Unit Manager or his/her representative must be contacted at least 3 business days in advance to schedule the conference.

### 5.2 - Conduct of Operations

#### 5.2.1 - Slash

##### 5.2.1.11 - Slash for reforestation (3/21)

To facilitate reforestation, Payment Unit(s) 1-8, and 10, shall be left with slash evenly distributed. Bunched tops within the cutting area shall be broken up and scattered. Stumps shall be cut low to the ground. Processing sites shall not be left with a compacted layer of slash; tops from these sites shall be hauled back into the cut area and scattered.

#### 5.2.2 - Hazard Trees/Snags

##### 5.2.2.1 - Den trees (10/16)

Obvious hollow and/or den trees shall be protected and left standing unless they are a safety hazard.

#### 5.2.3 - Operating Restrictions

##### 5.2.3.1 - Operating restrictions (9/11)

Within Payment Unit(s) 1-10, unless changed by written agreement, cutting, skidding, and hauling are not permitted during the period of April 1 to July 14, and September 15 to October 31. This restriction is to protect grouse and woodcock nesting habitat, and hunting season in the GEMS area.



#### 5.2.3.3 - Bark slippage restriction (3/09)

Within Payment Unit(s) 8-10, unless changed by written agreement, cutting and skidding are not permitted during the period of April 15 to July 15. This restriction is because of bark slippage.

#### 5.2.4 - Dead and Down Creation

##### 5.2.4.4 - Dead and down creation, grouse (6/18)

To encourage grouse and other wildlife, in Payment Unit(s) 1-10, leave one, 12" diameter or larger log-length (8 foot minimum) piece on the ground for every 2 acres. These will be evenly scattered throughout the unit.

#### 5.2.22 - Operating Caution

##### 5.2.22.1 - Operating caution (6/11)

It is recommended, but not required, that within Payment Unit(s) 2-4, cutting, skidding, and hauling occur during dry summer or frozen winter conditions. The reason for the recommendation is because of wet ground.

#### 5.2.32 - Decking/landing restoration (9/13)

All decking and landing areas must have the surface area restored to a condition equal to or better than before. This is to ensure the proper regeneration of the stand. Wood debris, chips and "cookies" from trimmings must be removed or scattered away from landing and loading areas and may not be windrowed on the edge.

#### 5.2.37 - No decking areas (12/08)

No decking is allowed within 50 feet of Perrin Brothers Road without permission of the County and Unit Manager or his/her representative.

#### 5.2.38 - No decking against live trees (2/04)

Cut products may not be decked against unmarked or designated leave trees.

#### 5.2.39 - ORV trail/route protection (4/18)

The Perrin Brothers Trail is an ORV trail or route and is shown on the Timber Sale Map. Do not cut trees or damage posts with yellow ORV markers. All stumps within 5 feet of the trail must be cut flush with the ground. Maintain a 20-foot-wide slash, debris, and rut free zone daily using the ORV trail or route as the centerline.

#### 5.2.40 - Pathway protection (10/10)

The GEMS Trails are recreational trails and are shown on the Timber Sale Map. Do not cut trees or damage posts with blue pathway markers. Maintain a 20-foot-wide slash debris, and rut free zone daily, using the pathway as the centerline.

#### 5.2.41 - Snowmobile trail protection (9/11)

The Perrin Brothers Road is a snowmobile trail and is shown on the Timber Sale Map. Do not cut or damage posts with orange trail markers or traffic control signs. If the trail is used for hauling, it must be graded to the satisfaction of the Unit Manager or his/her representative prior to December 1. If Perrin Brothers Road is to be used for hauling during the snowmobile season, then a snow-covered base must be left on the trail. Maintain a 20-foot-wide slash, debris, and rut free zone daily using the snowmobile trail as the centerline. All stumps within 20 feet of the snowmobile trail must be cut at ground level.

#### 5.4 - Soil Protection

##### 5.4.1 - Rutting restriction, general (7/16)

Operations are to cease immediately if equipment and weather conditions result in rutting of roads and/or skid trails which is 12 inches or greater in depth and 50 feet in length. The Unit Manager or his/her representative may restrict hauling and/or skidding if ruts exceed the specified depth. With the Unit Manager or his/her representative's approval, the Purchaser may return to the area when the risk of rutting has decreased.

##### 5.4.2 - Skid trails (2/04)

Skid trails up and down slopes should be avoided. If however this is unavoidable, these trails will be left in a non-erodible condition using water bars, logs, and slash. Placing of slash on these skid trails while logging is ongoing may alleviate need for any further action. At the direction of the sale administrator, seed, fertilizer, and mulch may also be required.

#### 5.8 - Protection of Endangered Species

##### 5.8.5 - Protection of raptor nests (3/13)

All trees with raptor nests will be protected if found during harvesting operations. Notification will be made to the Unit Manager or his/her representative who will notify the Wildlife Biologist so an on-site evaluation and recommendation can be made, if necessary.

## **6 - Safety and Fire Prevention**

### **6.2 - Signing**

#### **6.2.1 - Road posting (10/20)**

The Purchaser is responsible for posting and maintaining caution signs on Perrin Brothers Trail, north from both directions prior to beginning operations. The road must be posted approximately 350 feet from the sale area to warn of logging activity and truck traffic. Signs must be removed when harvest operations are suspended or completed. The Purchaser will provide these signs.

## **7 - Other Conditions**

### **7.5 - Loss**

#### **7.5.1 - Deteriorating timber (7/09)**

The sale area has received damage from Spruce Budworm. The Purchaser should harvest the wood as soon as possible. The Department of Natural Resources is held free of responsibility of any further damage or deterioration due to delay in harvesting.



## TIMBER SALE MAP

This information provided by authority of Part 525, 1994 PA 451, as amended.

Sale Number	Year
32-025	22

Forest Management Unit Gwinn Management Unit	County Marquette	Mapped By Brolin	Date 09/27/2022	Page 1	of 1
Township 44N	Range 26W	Section(s) and Subdivision(s) Sections 10, 11, 13, 14, 15, 22, 23, and 24	Scale 1:31,680		

## Cover Type

A = Aspen	H = Hemlock	N = Marsh	U = Upland Brush
B = Paper Birch	J = Jack Pine	O = Oak	UM = Upland Mixed
C = Cedar	L = Lowland Brush	P = Lowland Poplar	V = Bog or Marsh
D = Treed Bog	LM = Lowland Mixed	Q = Mixed Swamp Conifer	W = White Pine
E = Swamp Hdwoods	M = Mpl, Bch, Brch	R = Red Pine	X = Non Stocked
F = Spruce Fir	MC = Mixed Conifer	S = Black Spruce	Z = Water
G = Grass	MD = Mixed Deciduous	T = Tamarack	

## Density

0 = Non Stocked	5 = Pole Timber Medium
1 = Seedling Sapling Poor	6 = Pole Timber Well
2 = Seedling Sapling Medium	7 = Saw Timber Poor
3 = Seedling Sapling Well	8 = Saw Timber Medium
4 = Pole Timber Poor	9 = Saw Timber Well

PU Acres	PU Acres
1 20.0	6 9.1
2 31.1	7 27.0
3 15.4	8 17.7
4 39.4	9 9.8
5 41.2	10 7.1

## Duke's Doodles GEMS

### Compartment 51

217.8 Acres

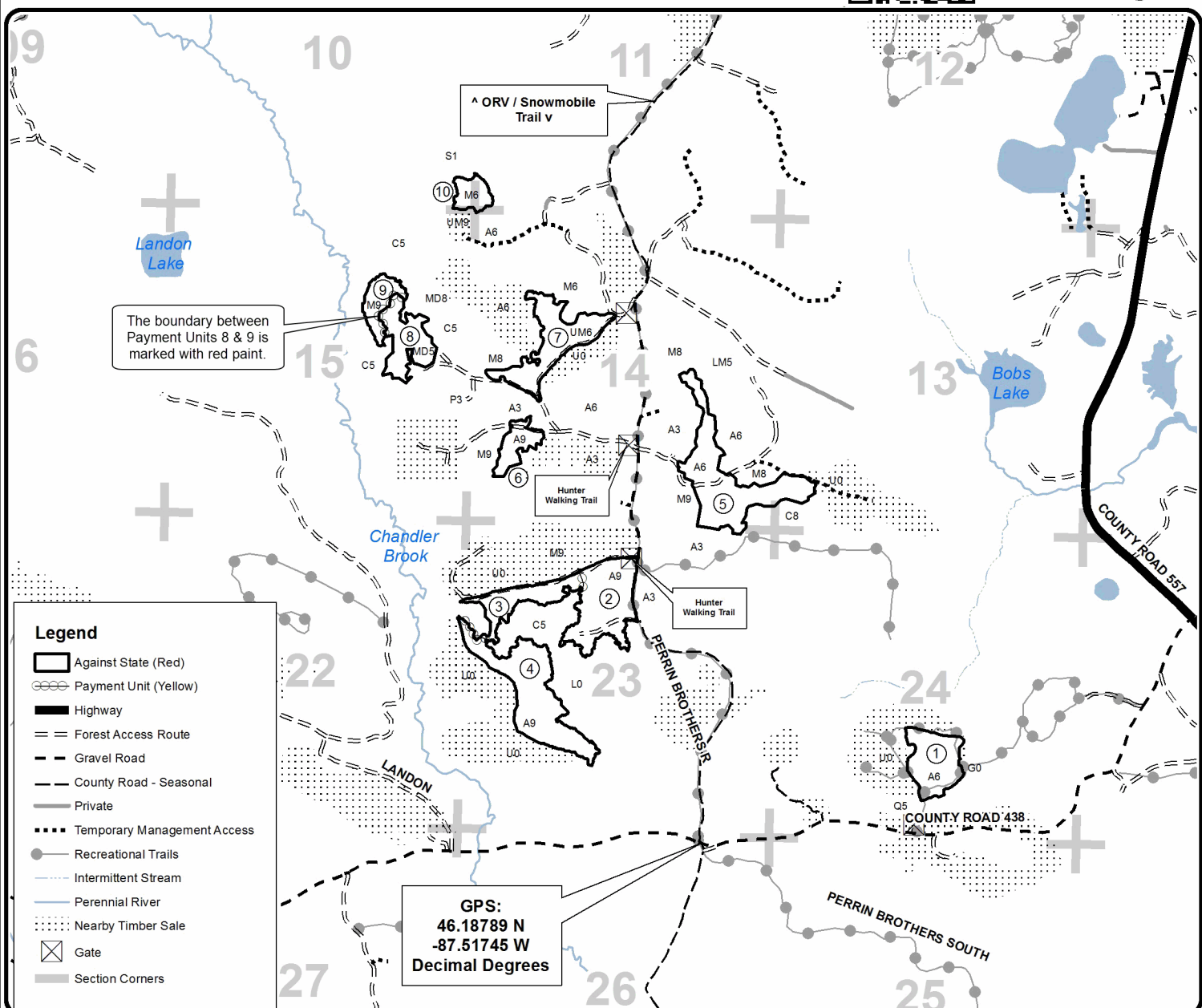
QR code for  
PDF Maps app

0 0.125 0.25 0.5 0.75 1 Miles