



**DEPARTMENT OF NATURAL RESOURCES
STATE OF MICHIGAN
TIMBER SALE PROSPECTUS #7139**

SCHEDULED SALE DATE AND TIME: 4:00 p.m. (local time) on April 4, 2023.

LOCATION: TRAVERSE CITY MGMT UNIT, 2122 M 37 SOUTH, TRAVERSE CITY, MI 49685.

CONTACT NAME: Patrick Cotant

PHONE NUMBER: (231) 649-0544

PROSPECTUS NOTE: Effective immediately: all bid openings for the Traverse City Management Unit (Kalkaska Field Office and Traverse City Field Office) will be held at the Traverse City Field Office regardless of sale location within the unit. All payments will now be handled through the Traverse City Field Office. The Kalkaska Field Office will no longer accept payments or hard paper copies of timber sale bids. Payments for all contracts, use permits, bonds, etc. should be sent to the Traverse City Field Office.

The bidder is advised to inspect the sale area and review the location, estimated volumes, operating costs and contract terms of proposed sales. Please be aware that some landowners may request 60 days or more notice for access across their land.

Notice is hereby given that bids will be received by the Unit Manager, TRAVERSE CITY MANAGEMENT UNIT, for certain timber on the following described lands:

Habblers Road Aspen (61-046-22) / T26N, R13W, SEC. 3, NWSW, S1/2SE.

T26N, R13W, SEC. 4, N1/2NW, NWNE, SENE, NESE.

T26N, R13W, SEC. 5, NENW, NE.

Benzie County, Advertised Price \$94,815.60, 122.0 Acres, Aspen, Hardwood.

SALE NOTE: A recreation site such as a trail, pathway, or campground is within the sale area or the vicinity. Certain restrictions/specifications may be applicable including time restrictions.

TIMBER SALE INFORMATION

Habbler Road Aspen (61-046-22)

T26N, R13W, SEC. 3; T26N, R13W, SEC. 4; T26N, R13W, SEC. 5.

Benzie County (Advertised Price \$94,815.60)

SALE NOTE: A recreation site such as a trail, pathway, or campground is within the sale area or the vicinity. Certain restrictions/specifications may be applicable including time restrictions.

A timber sale contract for this lump sum, sealed bid timber sale will be awarded to the responsible bidder offering the highest sealed bid price. All units of volume listed below were estimated using the Inventory Manager computer program and the new Michigan taper model. Bids must be at or above the following advertised price for each product and species:

<u>PRODUCTS & SPECIES</u>	<u>ESTIMATED UNITS*</u>	<u>ADVERTISED PRICE</u>
Sawtimber		
Basswood	30.2 MBF	\$ 105.00 / MBF
Beech	9.1 MBF	\$ 110.00 / MBF
Black Cherry	5.7 MBF	\$ 154.00 / MBF
Mixed Aspen	94.4 MBF	\$ 101.00 / MBF
Red Maple	106.7 MBF	\$ 143.00 / MBF
Red Pine	7.3 MBF	\$ 115.00 / MBF
Sugar Maple	36.5 MBF	\$ 280.00 / MBF
White Pine	43.3 MBF	\$ 64.00 / MBF
Pulpwood		
Jack Pine	14 Cords	\$ 20.35 / Cord
Mixed Aspen	1,499 Cords	\$ 20.75 / Cord
Mixed Hardwood	737 Cords	\$ 23.55 / Cord
Red Oak	3 Cords	\$ 21.65 / Cord
Red Pine	8 Cords	\$ 49.25 / Cord
White Pine	73 Cords	\$ 26.55 / Cord

* The total volume is statistically estimated within plus (+) or minus (-) 14.15 percent. There are an estimated 2,995 cords on this timber sale, plus or minus 424 cords at the 95% confidence level. The estimated units are final and not subject to adjustment. Prospective bidders are urged to examine this timber and to make their own estimates of quantity and quality.

BOND AND PAYMENT SCHEDULE:

1. A bond in the amount of \$4,740.78 to insure faithful performance of the conditions of the contract will be deposited by the successful bidder within 21 days of the sale award.
2. Cutting in any sale or unit without the required advance payment would be considered a trespass.
3. Total payment must be paid in advance or according to the following schedule :
 - (a) Ten percent (10%) of the sale value must be paid within 21 days of the sale award.
 - (b) The 10% down payment will be credited towards the first unit cut.
 - (c) Payment for each of the following units must be made before cutting begins in that unit:

<u>PAYMENT UNIT NUMBER</u>	<u>PERCENT OF TOTAL SALE VALUE</u>
01	2.6%
02	13.6%
03	11.4%
04	8.5%
05	7.7%
06	22.8%
07	11.1%
08	17.1%
09	1.9%
10	3.3%

4. If no cutting takes place, the 10% down payment will not be refunded.
5. Operations on the contract issued will terminate on 04/15/2025.

SALE STATISTICS

Volumes were calculated in cubic feet using the Michigan taper model. Cubic foot volume includes all wood inside bark for the product indicated. For display purposes, cubic feet were converted to cords and MBF using a simple conversion factor, e.g. 79 cubic feet per cord and 185 cubic feet per MBF. The cubic foot volumes are precise; the cords and MBF volumes are not. Cubic foot volume cannot be directly converted to cords or boards with precision.

SALE VOLUMES

The total estimated sale volume may not equal the sum of the species/products due to the nature of statistical calculations associated with double sampling methodology.

VOLUME			STATISTICAL RANGE IN CORDS	
TOTAL CUBIC FEET	TOTAL CORDS	PERCENT ERROR	MINIMUM	MAXIMUM
236,581	2,995	14.15%	2,571	3,419

VDU VOLUMES

A VDU is a Volume Determination Unit. Volumes and their associated statistics are calculated at the VDU level and summarized to the sale level. There is often a one to one relationship between a VDU and a Payment Unit, but not always, depending on the cruise design. Refer to the VDU TO PAYMENT UNIT table.

	VOLUME			RANGE IN CORDS	
VDU	TOTAL CUBIC FEET	TOTAL CORDS	PERCENT ERROR	MINIMUM	MAXIMUM
45	81,860	1,036	24.02%	787	1,285
71	41,316	523	16.14%	439	607
99	59,117	748	23.14%	575	921
149	4,635	59	141.58%	24	142
152	7,601	96	113.36%	13	205
157	42,052	532	39.10%	324	740
TOTAL:	236,581	2,995		2,088	3,901

VDU TO PAYMENT UNIT

When a VDU is associated with more than one Payment Unit (PU), the VDU volumes are assigned to the PU based on acres of the VDU within the PU.

VDU	VDU ACRES	PU	PU ACRES
45	35.2	3	14.5
		4	10.9
		5	9.8
71	36.7	6	36.7
99	19.8	7	7.8
		8	12.0
149	2.4	9	2.4
152	4.9	10	4.9
157	23.0	1	3.7
		2	19.3
TOTAL:	122.0		122.0

DESCRIPTION OF TIMBER BY PU (PU)

PU	MARKET GROUP	PRODUCT	QUANTITY	UNIT	ACRES	ADVERTISE PRICE
1	Black Cherry	Sawtimber	0.4	MBF	3.7	\$2,421.85
	Mixed Aspen		7.2	MBF		
	<i>B. T. Aspen</i>		4.9	<i>MBF</i>		
	<i>Quaking Aspen</i>		2.3	<i>MBF</i>		
	Sugar Maple		0.5	MBF		
	Mixed Aspen	Pulpwood	65	Cords		
	<i>B. T. Aspen</i>		40	<i>Cords</i>		
	<i>Quaking Aspen</i>		25	<i>Cords</i>		
	Mixed Hardwood		5	Cords		
	<i>Beech</i>		1	<i>Cords</i>		
	<i>Red Maple</i>		2	<i>Cords</i>		
	<i>Sugar Maple</i>		2	<i>Cords</i>		
	White Pine		1	Cords		
2	Black Cherry	Sawtimber	2.0	MBF	19.3	\$12,850.05
	Mixed Aspen		37.6	MBF		
	<i>B. T. Aspen</i>		25.4	<i>MBF</i>		
	<i>Quaking Aspen</i>		12.2	<i>MBF</i>		
	Sugar Maple		2.7	MBF		
	Mixed Aspen	Pulpwood	340	Cords		
	<i>B. T. Aspen</i>		209	<i>Cords</i>		
	<i>Quaking Aspen</i>		131	<i>Cords</i>		
	Mixed Hardwood		34	Cords		
	<i>Beech</i>		6	<i>Cords</i>		
	<i>Black Cherry</i>		3	<i>Cords</i>		
	<i>Red Maple</i>		13	<i>Cords</i>		
	<i>Sugar Maple</i>		12	<i>Cords</i>		
	White Pine		5	Cords		
3	Mixed Aspen	Sawtimber	14.1	MBF	14.5	\$10,763.95
	<i>B. T. Aspen</i>		14.1	<i>MBF</i>		
	Red Maple		6.0	MBF		
	Mixed Aspen	Pulpwood	293	Cords		
	<i>B. T. Aspen</i>		201	<i>Cords</i>		
	<i>Quaking Aspen</i>		92	<i>Cords</i>		
	Mixed Hardwood		102	Cords		
	<i>Beech</i>		4	<i>Cords</i>		
	<i>Black Cherry</i>		17	<i>Cords</i>		
	<i>Red Maple</i>		63	<i>Cords</i>		
	<i>Sugar Maple</i>		18	<i>Cords</i>		
4	Mixed Aspen	Sawtimber	10.6	MBF	10.9	\$8,068.90
	<i>B. T. Aspen</i>		10.6	<i>MBF</i>		
	Red Maple		4.5	MBF		
	Mixed Aspen	Pulpwood	220	Cords		
	<i>B. T. Aspen</i>		151	<i>Cords</i>		
	<i>Quaking Aspen</i>		69	<i>Cords</i>		
	Mixed Hardwood		76	Cords		
	<i>Beech</i>		3	<i>Cords</i>		
	<i>Black Cherry</i>		12	<i>Cords</i>		
	<i>Red Maple</i>		48	<i>Cords</i>		
	<i>Sugar Maple</i>		13	<i>Cords</i>		
5	Mixed Aspen	Sawtimber	9.5	MBF	9.8	\$7,279.25
	<i>B. T. Aspen</i>		9.5	<i>MBF</i>		
	Red Maple		4.1	MBF		
	Mixed Aspen	Pulpwood	198	Cords		
	<i>B. T. Aspen</i>		136	<i>Cords</i>		
	<i>Quaking Aspen</i>		62	<i>Cords</i>		

DESCRIPTION OF TIMBER BY PU (PU), CON'T

PU	MARKET GROUP	PRODUCT	QUANTITY	UNIT	ACRES	ADVERTISE PRICE
5 con't	Mixed Hardwood	Pulpwood	69	Cords		
	<i>Beech</i>		3	<i>Cords</i>		
	<i>Black Cherry</i>		11	<i>Cords</i>		
	<i>Red Maple</i>		43	<i>Cords</i>		
	<i>Sugar Maple</i>		12	<i>Cords</i>		
6	Basswood	Sawtimber	30.2	MBF	36.7	\$21,647.75
	Beech		6.2	MBF		
	Mixed Aspen		5.5	MBF		
	<i>B. T. Aspen</i>		5.5	<i>MBF</i>		
	Red Maple		16.3	MBF		
	Sugar Maple		27.8	MBF		
	Mixed Aspen	Pulpwood	2	Cords		
	<i>B. T. Aspen</i>		2	<i>Cords</i>		
	Mixed Hardwood		298	Cords		
	<i>Basswood</i>		18	<i>Cords</i>		
	<i>Beech</i>		16	<i>Cords</i>		
	<i>Ironwood</i>		8	<i>Cords</i>		
	<i>Red Maple</i>		85	<i>Cords</i>		
	<i>Sugar Maple</i>		171	<i>Cords</i>		
	Red Oak		3	Cords		
7	Beech	Sawtimber	1.1	MBF	7.8	\$10,537.95
	Black Cherry		1.3	MBF		
	Mixed Aspen		3.4	MBF		
	<i>B. T. Aspen</i>		3.4	<i>MBF</i>		
	Red Maple		27.8	MBF		
	Sugar Maple		2.2	MBF		
	White Pine		13.2	MBF		
	Mixed Aspen	Pulpwood	147	Cords		
	<i>B. T. Aspen</i>		147	<i>Cords</i>		
	Mixed Hardwood		51	Cords		
	<i>Beech</i>		3	<i>Cords</i>		
	<i>Black Cherry</i>		4	<i>Cords</i>		
	<i>Ironwood</i>		2	<i>Cords</i>		
	<i>Red Maple</i>		22	<i>Cords</i>		
	<i>Sugar Maple</i>		20	<i>Cords</i>		
	White Pine		7	Cords		
8	Beech	Sawtimber	1.8	MBF	12.0	\$16,259.00
	Black Cherry		2.0	MBF		
	Mixed Aspen		5.2	MBF		
	<i>B. T. Aspen</i>		5.2	<i>MBF</i>		
	Red Maple		42.7	MBF		
	Sugar Maple		3.3	MBF		
	White Pine		20.4	MBF		
	Mixed Aspen	Pulpwood	226	Cords		
	<i>B. T. Aspen</i>		226	<i>Cords</i>		
	Mixed Hardwood		80	Cords		
	<i>Beech</i>		4	<i>Cords</i>		
	<i>Black Cherry</i>		6	<i>Cords</i>		
	<i>Ironwood</i>		4	<i>Cords</i>		
	<i>Red Maple</i>		34	<i>Cords</i>		
	<i>Sugar Maple</i>		32	<i>Cords</i>		
	White Pine		12	Cords		
9	Mixed Aspen	Sawtimber	1.3	MBF	2.4	\$1,815.75
	<i>B. T. Aspen</i>		1.3	<i>MBF</i>		
	Red Maple		3.7	MBF		

DESCRIPTION OF TIMBER BY PU (PU), CON'T

PU	MARKET GROUP	PRODUCT	QUANTITY	UNIT	ACRES	ADVERTISE PRICE
9 con't	White Pine	Sawtimber	2.9	MBF		
	Jack Pine	Pulpwood	2	Cords		
	Jack Pine	Sawtimber	0.6	MBF		
	Jack Pine	Pulpwood	1	Cords		
	Mixed Aspen		8	Cords		
	B. T. Aspen		8	Cords		
	Mixed Hardwood		20	Cords		
	Red Maple		12	Cords		
	Sugar Maple		8	Cords		
	White Pine		11	Cords		
10	Red Maple	Sawtimber	1.6	MBF	4.9	\$3,171.15
	Red Pine		7.3	MBF		
	White Pine		6.8	MBF		
	Jack Pine	Pulpwood	12	Cords		
	Jack Pine		12	Cords		
	Mixed Hardwood		2	Cords		
	Red Maple		2	Cords		
	Red Pine		8	Cords		
	White Pine		37	Cords		
TOTAL:			333.2	MBF		
TOTAL:			2,334	Cords		

Sale Specific Conditions & Requirements

Sale Name: Habbler Road Aspen

Sale Number: 61-046-22 Seq#: 1

1 - Sale Area

1.2 - Boundaries

1.2.1 - Painted boundaries (9/19)

The sale boundary and Payment Unit boundaries are marked and identified by blue, red and yellow paint. Exterior sale boundary lines against private property are marked with blue paint. Exterior sale boundary lines against state land are marked with red paint. Interior Payment Unit boundaries are marked with yellow paint. Retention patches are marked with double red paint marks; no harvesting activities may occur within these areas. The painted boundary line trees are not Included Timber and are to be protected unless marked with orange paint.

2 - Timber Specifications

2.1 - Included Timber

2.1.1 - Clearcut unit(s) with unmerchantable trees (6/14)

Within Payment Unit(s) 1, 2, 3, 4, 5 and 9, cut all trees that are two (2) inches or more at DBH except for the following:

- units 1 and 2: do not cut any white pine greater than 10" dbh, any red pine, or any hemlock;
- units 3, 4 and 5: do not cut any conifers, oak, elm or yellow birch;
- unit 9: do not cut any red pine, oak, hemlock, or any trees marked with green paint.

2.1.3 - Cut tree marked unit(s) (12/08)

Within Payment Unit(s) 6 and 10, all trees are designated for cutting when marked with orange paint above and below stump height, regardless of merchantability. Sapling trees (less than 4.6" dbh) may be cut as necessary to facilitate harvest of designated timber, but must be severed at ground level and laid flat on the ground, and not left bent, broken or damaged.

2.1.4 - Designated timber unit(s) (6/17)

Within Payment Unit(s) 7 and 8, all aspen, maple, ironwood, beech and cherry trees greater than 2" dbh, and all white pine greater than 6" and less than 20" dbh, are designated for cutting regardless of merchantability.

2.2 - Utilization

2.2.4 - Skidding length (2/14)

Within payment units 6 and 10, skidding of unlimbed tops or lengths over 17 feet is not permissible unless approved by the Unit Manager or his/her representative.

4 - Transportation

4.1 - Construction

4.1.3 - Slash and earthen piles (8/04)

Piles or windrows of earth along roads and landings that have been widened or constructed shall be leveled. Slash from road maintenance or construction, including stumps, shall be chipped, utilized or dispersed throughout the sale.

4.1.12 - No new roads (1/12)

No new roads will be permitted in any Payment Unit. All operations are limited to existing roads. Skid trails only will be allowed.

5 - Operations

5.2 - Conduct of Operations

5.2.1 - Slash

5.2.1.8 - Slash height (12/08)

No slash or tree tops may exceed 24 inches in height. Within payment unit 10, slash must be placed on the side of the unit

away from the county road rights of way.

5.2.3 - Operating Restrictions

5.2.3.3 - Bark slippage restriction (3/09)

Within Payment Unit(s) 6, cutting and skidding are not permitted during the period of April 15 to July 15. This restriction is because of bark slippage.

5.2.3.6 - Bark beetle restriction (12/08)

In the event drought creates a high risk of pine bark beetle infestation, pine is not to be cut during the period March 1 through July 1, unless all portions of trees greater than two inches in diameter are removed from the sale area, reduced to chips, or treated to the satisfaction of the Unit Manager or his/her representative, within fifteen days of being severed from the stump. Pine log decks, pulpwood piles and treetops that are piled for chipping in the fall or winter within a 1/4 mile of susceptible sites must be removed before March 15. Residual slash must not be placed in piles or rows and must be spread over the site for quick drying. The Department of Natural Resources will exercise this specification if the risk of damage warrants.

5.2.3.11 - Coppice regeneration protection (4/10)

Timber harvesting in any Payment Unit must be completed before significant aspen sprouting occurs in that Payment Unit so as to minimize damage to the new regeneration. Any post harvest operations, such as chipping, must be completed before sprouting of regeneration occurs. If it is anticipated that chipping will be delayed, then tops shall be carried to one central location or left unchipped. The Unit Manager or his/her representative may cease such operations if sprouting occurs before the operation is complete.

5.2.4 - Dead and Down Creation

5.2.4.1 - Dead and down creation, marked trees (10/13)

All trees marked with an orange "X" must be felled and left on site for wildlife. Either cut these trees at 4 feet above ground level and place the cut trunk alongside the resulting high stump or cut at ground level and place the cut trunk against a small nearby tree retained for this purpose.

In addition to these marked trees, in payment units 7 and 8 the producer must select at least one entire cut tree per acre to leave on site in the same fashion for wildlife. These trees should be well distributed throughout the unit and must be greater than 10" dbh.

5.2.31 - Landing locations (9/13)

A recommended landing for payment units 7 and 8 is marked on the Timber Sale Map with the letter "L". An approximate forwarding route from these payment units to the recommended landing is also shown on the map. Using this location will avoid trucks having to negotiate a narrow culvert or a steep hill on Bronson Lake Road, and will avoid potential conflicts with the Shore to Shore Trail.

5.2.38 - No decking against live trees (2/04)

Cut products may not be decked against unmarked or designated leave trees.

5.2.40 - Pathway protection (10/10)

The Shore to Shore riding/hiking trail is shown on the Timber Sale Map, coincident with Burnt Mill and Bronson Lake roads. Do not cut trees or damage posts with blue pathway markers. Maintain a 20-foot wide slash, debris, and rut free zone daily, using the pathway as the centerline.

5.4 - Soil Protection

5.4.3 - Erosion control (12/08)

Skid trails or haul roads may require erosion control structures or berms per direction of the Unit Manager or his/her representative.

5.4.6 - Wet area protection (5/10)

No harvesting operations, including skidding and felling, are to take place within the area between payment unit 1 and Bowers Road. This unit should be forwarded north to Oakley Road to avoid the wet area. In addition, there are wet areas immediately south of units 3, 5, and 7, and north, west and south of unit 8. Care must be taken by the Purchaser to identify and avoid operating in these areas of the timber sale.

6 - Safety and Fire Prevention

6.2 - Signing

6.2.1 - Road posting (10/20)

The Purchaser is responsible for posting and maintaining caution signs on Oakley, Bowers, Bronson Lake, Reynolds, and Fewins roads prior to beginning operations. The road must be posted at appropriate distances from the sale area to warn of logging activity and truck traffic. Signs must be removed when harvest operations are suspended or completed. The Purchaser will provide these signs.

**TIMBER SALE MAP**

This information provided by authority of Part 525, 1994 PA 451, as amended.

Sale Number	Year
61-046	22

Forest Management Unit	County	Mapped By	Date	Page	of
Traverse City	Benzie	Tim Webb	9/16/2022	1	2
		Cruised By	Webb, Allen, contractors		

Township	Range	Section(s) and Subdivision(s)	Scale
26N	13W	Sec. 3: NWSW, S1/2SE; Sec. 4: N1/2NW, NWNE, SENE, NESE; Sec. 5: NENW, NE	1:15,840

Cover Type				Density	
A = Aspen	H = Hemlock	N = Marsh	U = Upland Brush	0 = Non Stocked	5 = Pole Timber Medium
B = Paper Birch	J = Jack Pine	O = Oak	UM = Upland Mixed	1 = Seedling Sapling Poor	6 = Pole Timber Well
C = Cedar	L = Lowland Brush	P = Lowland Poplar	V = Bog or Marsh	2 = Seedling Sapling Medium	7 = Saw Timber Poor
D = Tread Bog	LM = Lowland Mixed	Q = Mixed Swamp Conifer	W = White Pine	3 = Seedling Sapling Well	8 = Saw Timber Medium
E = Swamp Hdwoods	M = Mpl, Bch, Bach	R = Red Pine	X = Non Stocked	4 = Pole Timber Poor	9 = Saw Timber Well
F = Spruce Fir	MC = Mixed Conifer	S = Black Spruce	Z = Water		
G = Grass	MD = Mixed Deciduous	T = Tamarack			

PU	Acres	PU	Acres	PU	Acres
1	3.7	5	9.8	9	2.4
2	19.3	6	36.7	10	4.9
3	14.5	7	7.8		
4	10.9	8	12.0		

Habbler Road Aspen

Compartment 61013

122.0 acres

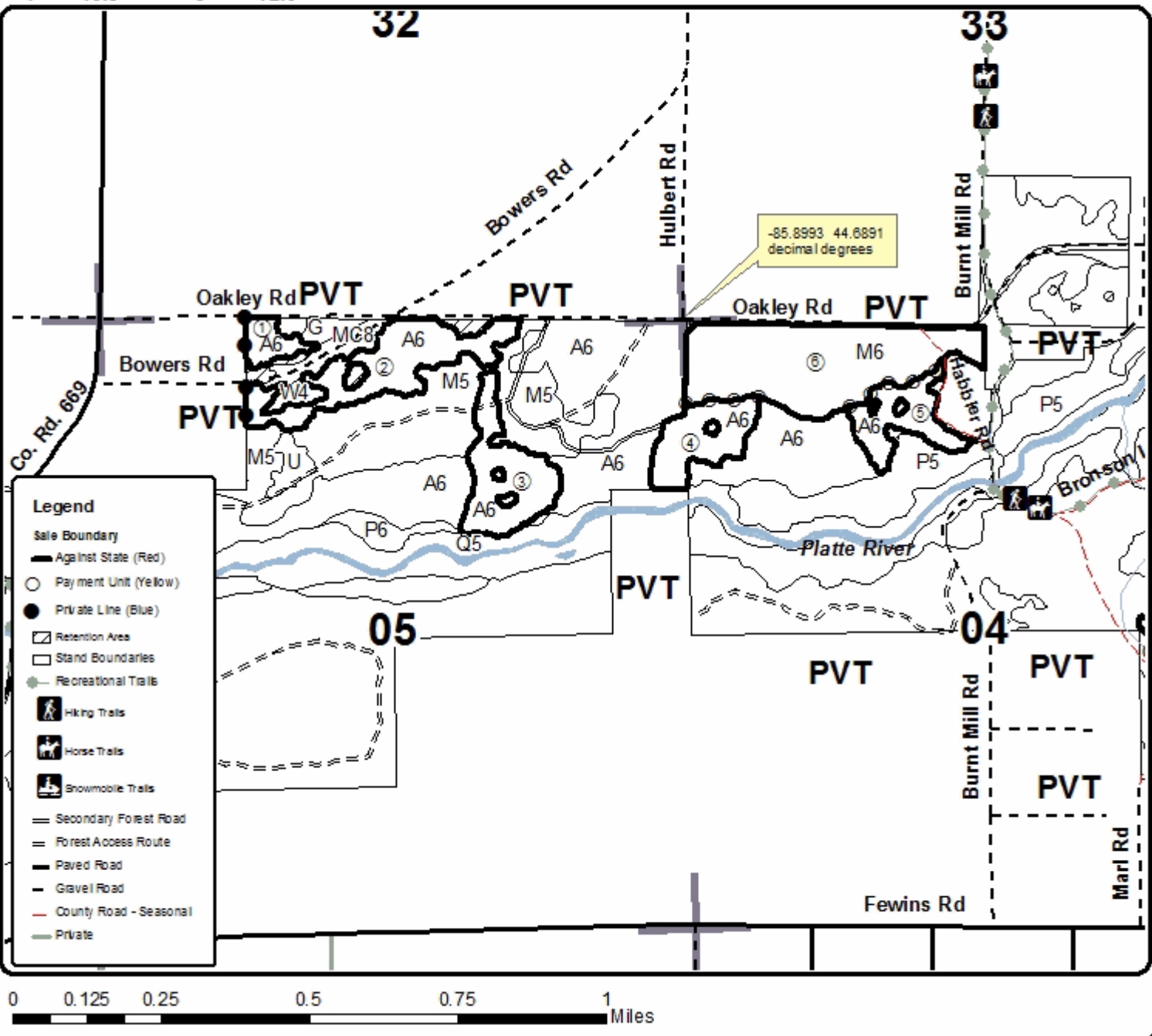

**TIMBER SALE MAP**

This information provided by authority of Part 525, 1994 PA 451, as amended.

Sale Number	Year
61-046	22

Forest Management Unit	County	Mapped By	Date	Page	of
Traverse City	Benzie	Tim Webb	9/16/2022	2	2
Township		Range		Section(s) and Subdivision(s)	
26N		13W		Sec. 3: NWSW, S1/2SE; Sec. 4: N1/2NW, NWNE, SENE, NESE; Sec. 5: NENW, NE	

Cover Type	Density
A = Aspen B = Paper Birch C = Cedar D = Tread Bog E = Swamp Hdwoods F = Spruce Fir G = Grass H = Hemlock J = Jack Pine L = Lowland Brush LM = Lowland Mixed M = Mpl, Bch, Bach MC = Mixed Conifer MD = Mixed Deciduous N = Marsh O = Oak P = Lowland Poplar Q = Mixed Swamp Conifer R = Red Pine S = Black Spruce T = Tamarack U = Upland Brush UM = Upland Mixed V = Bog or Marsh W = White Pine X = Non Stocked Z = Water	0 = Non Stocked 1 = Seedling Sapling Poor 2 = Seedling Sapling Medium 3 = Seedling Sapling Well 4 = Pole Timber Poor 5 = Pole Timber Medium 6 = Pole Timber Well 7 = Saw Timber Poor 8 = Saw Timber Medium 9 = Saw Timber Well

PU	Acres	PU	Acres	PU	Acres
1	3.7	5	9.8	9	2.4
2	19.3	6	36.7	10	4.9
3	14.5	7	7.8		
4	10.9	8	12.0		

Habbler Road Aspen

Compartment 61013

122.0 acres

