



**DEPARTMENT OF NATURAL RESOURCES
STATE OF MICHIGAN**

TIMBER SALE PROSPECTUS #7190

REVISION NOTICE #1 - March 3, 2023

SCHEDULED SALE DATE AND TIME: **9:00 a.m. (local time) on Tuesday, March 21, 2023**

LOCATION: **GAYLORD MGMT UNIT, 1732 West M 32, Gaylord, MI 49735**

This prospectus has been modified with the following changes.

The sale conditions for the Elmer Dudd Red Pine timber sale (52-110-22) have been updated. Please use the attached sale conditions when bidding on this sale and disregard the original sale conditions sent with the prospectus.

We apologize for any inconvenience this may have caused. If you need assistance, please contact Lucas Merrick at 989-732-3541 ext. 5440.

Sale Specific Conditions & Requirements

Sale Name: Elmer Dudd Red Pine

Sale Number: 52-110-22

Seq#: 2

1 - Sale Area

1.2 - Boundaries

1.2.1 - Painted boundaries (9/19)

The sale boundary and Payment Unit boundaries are marked and identified by red paint. Exterior sale boundary lines against state are marked with red paint. The painted boundary line trees are not Included Timber and are to be protected unless marked with orange paint.

2 - Timber Specifications

2.1 - Included Timber

2.1.3 - Cut tree marked unit(s) (12/08)

Within Payment Unit(s) 1, all trees are designated for cutting when marked with orange paint above and below stump height, regardless of merchantability. Any dead trees marked with orange may be harvested or left standing at the discretion of the Purchaser.

3 - Payments

3.4 - Damaged Timber

3.4.1 - Damaged timber (7/16)

General Condition and Requirement 3.4 Damaged Timber, defines liquidated damages for undesigned live merchantable trees which are cut or injured.

No damage is acceptable to undesigned live merchantable trees. Within the sale area, if more than 5 % of trees (> 4.5" DBH) within a specified area of the sale are damaged, liquidated damages will be assessed for all trees damaged. Rates will be in accordance with General Condition and Requirement 3.4 Damaged Timber.

5 - Operations

5.2 - Conduct of Operations

5.2.1 - Slash

5.2.1.13 - Dispose of slash as directed (12/05)

Slash is to be disposed of as directed by the DNR Sale Administrator.

5.2.3 - Operating Restrictions

5.2.3.3 - Bark slippage restriction (3/09)

Within Payment Unit(s) 1, unless changed by written agreement, cutting and skidding are not permitted during the period of April 15 to July 15. This restriction is because of bark slippage.

5.2.38 - No decking against live trees (2/04)

Cut products may not be decked against unmarked or designated leave trees.

5.8 - Protection of Endangered Species

5.8.3 - Red shoulder hawk or goshawk (2/16)

In the event that an active red shoulder hawk or goshawk nest is found, the contract may be amended to protect the nest site until the nest is determined to be inactive. The value of the trees in this excluded area will be refunded or credited to the Purchaser. The nest will be buffered with a five-chain radius (eight acre) protection area, centered on the nest tree, in which there will be no cutting or new roads constructed. Avoid human disturbance, including loading and skidding, in the protection area.

An additional zone of five chains (ten chains centered on the active nest tree) will be established in which there is no management activity from March 15 to July 15 (NLP). Limit biomass harvesting and chipping operations within this ten-chain zone, retain the maximum one-third of residues per the Woody Biomass Harvesting Guidelines (Michigan DNR 2010). Nests determined to be inactive will be protected with a one-chain no-harvest buffer.

5.8.5 - Protection of raptor nests (3/13)

All trees with raptor nests will be protected if found during harvesting operations. Notification will be made to the Unit Manager or his/her representative who will notify the Wildlife Biologist so an on-site evaluation and recommendation can be made, if necessary.

6 - Safety and Fire Prevention

6.2 - Signing

6.2.1 - Road posting (10/20)

The Purchaser is responsible for posting and maintaining caution signs on Dunham Road prior to beginning operations. The road must be posted at appropriate distances from the sale area to warn of logging activity and truck traffic. Signs must be removed when harvest operations are suspended or completed. The Purchaser will provide these signs.



**DEPARTMENT OF NATURAL RESOURCES
STATE OF MICHIGAN
TIMBER SALE PROSPECTUS #7190**

SCHEDULED SALE DATE AND TIME: 9:00 a.m. (local time) on March 21, 2023.

LOCATION: GAYLORD MGMT UNIT, 1732 WEST M 32, GAYLORD, MI 49735.

CONTACT NAME: Lucas Merrick

PHONE NUMBER: (989) 732-3541

PROSPECTUS NOTE: All bid openings for the Gaylord Management Unit (Gaylord Field Office and Indian River Field Office) will be held at the Gaylord Field Office regardless of sale location within the unit. All payments and contract executions will now be handled through the Gaylord Field Office. The Indian River Field Office will no longer accept payments or hard paper copies of timber sale bids. Payments for all contracts, use permits, bonds, etc. should be sent to the Gaylord Field Office.

The bidder is advised to inspect the sale area and review the location, estimated volumes, operating costs and contract terms of proposed sales. Please be aware that some landowners may request 60 days or more notice for access across their land.

Notice is hereby given that bids will be received by the Unit Manager, GAYLORD MANAGEMENT UNIT, for certain timber on the following described lands:

Stimpson Road Aspen Mix (52-124-22) / T38N, R03W, SEC. 5 , NENE.

T39N, R03W, SEC. 19, N1/2SE.

T39N, R03W, SEC. 28, NWSW.

T39N, R03W, SEC. 29, SW,NESE,S1/2SE.

T39N, R03W, SEC. 30, NESE.

T39N, R03W, SEC. 32, NWNE,NESW,SE.

T39N, R03W, SEC. 33, W1/2SW.

Cheboygan County, Advertised Price \$138,880.70, 259.8 Acres, Aspen, Spruce/Fir/Tamarack.

SALE NOTE: This is a large sale consisting of mostly rocky, low ground, but operable terrain. There is good access to most Payment Units. Some Payment Units have larger diameter timber that is past maturity. In addition, there are some individual trees and areas of blowdown.

TIMBER SALE INFORMATION

Stimpson Road Aspen Mix (52-124-22)

T38N, R03W, SEC. 5; T39N, R03W, SEC. 19; T39N, R03W, SEC. 28; T39N, R03W, SEC. 29; T39N, R03W, SEC. 30; T39N, R03W, SEC. 32; T39N, R03W, SEC. 33.

SALE NOTE: This is a large sale consisting of mostly rocky, low ground, but operable terrain. There is good access to most Payment Units. Some Payment Units have larger diameter timber that is past maturity. In addition, there are some individual trees and areas of blowdown.

A timber sale contract for this lump sum, sealed bid timber sale will be awarded to the responsible bidder offering the highest sealed bid price. All units of volume listed below were estimated using the Inventory Manager computer program and the new Michigan taper model. Bids must be at or above the following advertised price for each product and species:

<u>PRODUCTS & SPECIES</u>	<u>ESTIMATED UNITS*</u>	<u>ADVERTISED PRICE</u>
Sawtimber		
Mixed Aspen	440.1 MBF	\$ 58.00 / MBF
N. White Cedar	74.9 MBF	\$ 33.00 / MBF
Red Maple	25.9 MBF	\$ 112.00 / MBF
Red Pine	11.3 MBF	\$ 141.00 / MBF
White Spruce	95.4 MBF	\$ 28.00 / MBF
Pulpwood		
Balsam Fir	886 Cords	\$ 20.80 / Cord
Balsam Poplar	163 Cords	\$ 21.75 / Cord
Mixed Aspen	2,293 Cords	\$ 21.75 / Cord
Mixed Hardwood	770 Cords	\$ 17.35 / Cord
N. White Cedar	557 Cords	\$ 18.90 / Cord
Red Pine	53 Cords	\$ 52.45 / Cord
White Pine	17 Cords	\$ 32.35 / Cord
White Spruce	290 Cords	\$ 16.05 / Cord

* The total volume is statistically estimated within plus (+) or minus (-) 9.08 percent. There are an estimated 6,788 cords on this timber sale, plus or minus 616 cords at the 95% confidence level. The estimated units are final and not subject to adjustment. Prospective bidders are urged to examine this timber and to make their own estimates of quantity and quality.

BOND AND PAYMENT SCHEDULE:

1. A bond in the amount of \$13,888.07 to insure faithful performance of the conditions of the contract will be deposited by the successful bidder within 21 days of the sale award.
2. Cutting in any sale or unit without the required advance payment would be considered a trespass.
3. Total payment must be paid in advance or according to the following schedule :
 - (a) Ten percent (10%) of the sale value must be paid within 21 days of the sale award.
 - (b) The 10% down payment will be credited towards the first unit cut.
 - (c) Payment for each of the following units must be made before cutting begins in that unit:

<u>PAYMENT UNIT NUMBER</u>	<u>PERCENT OF TOTAL SALE VALUE</u>
01	7.3%
02	3.1%
03	16.8%
04	12.0%
05	9.7%
06	11.1%
07	40.0%

4. If no cutting takes place, the 10% down payment will not be refunded.
5. Operations on the contract issued will terminate on 06/30/2027.

SALE STATISTICS

Volumes were calculated in cubic feet using the Michigan taper model. Cubic foot volume includes all wood inside bark for the product indicated. For display purposes, cubic feet were converted to cords and MBF using a simple conversion factor, e.g. 79 cubic feet per cord and 185 cubic feet per MBF. The cubic foot volumes are precise; the cords and MBF volumes are not. Cubic foot volume cannot be directly converted to cords or boards with precision.

SALE VOLUMES

The total estimated sale volume may not equal the sum of the species/products due to the nature of statistical calculations associated with double sampling methodology.

VOLUME			STATISTICAL RANGE IN CORDS	
TOTAL CUBIC FEET	TOTAL CORDS	PERCENT ERROR	MINIMUM	MAXIMUM
536,270	6,788	9.08%	6,172	7,405

VDU VOLUMES

A VDU is a Volume Determination Unit. Volumes and their associated statistics are calculated at the VDU level and summarized to the sale level. There is often a one to one relationship between a VDU and a Payment Unit, but not always, depending on the cruise design. Refer to the VDU TO PAYMENT UNIT table.

	VOLUME			RANGE IN CORDS	
VDU	TOTAL CUBIC FEET	TOTAL CORDS	PERCENT ERROR	MINIMUM	MAXIMUM
2	41,252	522	34.66%	341	703
17	6,339	80	108.56%	7	167
25	64,572	817	23.39%	626	1,009
26	85,009	1,076	26.93%	786	1,366
63	50,735	642	25.19%	480	804
73	225,354	2,853	13.53%	2,467	3,239
93	63,009	798	30.35%	556	1,040
TOTAL:	536,270	6,788		5,249	8,327

VDU TO PAYMENT UNIT

When a VDU is associated with more than one Payment Unit (PU), the VDU volumes are assigned to the PU based on acres of the VDU within the PU.

VDU	VDU ACRES	PU	PU ACRES
2	18.6	1	18.6
17	4.2	2	4.2
25	47.3	4	47.3
26	40.8	3	40.8
63	17.8	5	17.8
73	100.4	7	100.4
93	30.7	6	30.7
TOTAL:	259.8		259.8

DESCRIPTION OF TIMBER BY PU (PU)

PU	MARKET GROUP	PRODUCT	QUANTITY	UNIT	ACRES	ADVERTISE PRICE
1	Mixed Aspen	Sawtimber	3.4	MBF	18.6	\$10,089.15
	<i>B. T. Aspen</i>		2.1	<i>MBF</i>		
	<i>Quaking Aspen</i>		1.3	<i>MBF</i>		
	N. White Cedar		9.4	MBF		
	White Spruce		8.9	MBF		
	Balsam Fir	Pulpwood	65	Cords		
	<i>Balsam Fir</i>		65	<i>Cords</i>		
	Mixed Aspen		251	Cords		
	<i>B. T. Aspen</i>		81	<i>Cords</i>		
	<i>Quaking Aspen</i>		170	<i>Cords</i>		
	Mixed Hardwood		40	Cords		
	<i>Red Maple</i>		33	<i>Cords</i>		
	<i>White Ash</i>		7	<i>Cords</i>		
	N. White Cedar		78	Cords		
	White Spruce		22	Cords		
	<i>Tamarack</i>		7	<i>Cords</i>		
	<i>White Spruce</i>		15	<i>Cords</i>		
2	Red Pine	Sawtimber	11.3	MBF	4.2	\$4,373.15
	Red Pine	Pulpwood	53	Cords		
3	Mixed Aspen	Sawtimber	52.9	MBF	40.8	\$23,275.80
	<i>B. T. Aspen</i>		12.1	<i>MBF</i>		
	<i>Quaking Aspen</i>		40.8	<i>MBF</i>		
	Red Maple		8.5	MBF		
	Balsam Fir	Pulpwood	104	Cords		
	<i>Balsam Fir</i>		4.2	<i>MBF</i>		
	<i>Balsam Fir</i>		96	<i>Cords</i>		
	Balsam Poplar		23	Cords		
	<i>Balsam Poplar</i>		23	<i>Cords</i>		
	Mixed Aspen		644	Cords		
	<i>B. T. Aspen</i>		378	<i>Cords</i>		
	<i>Quaking Aspen</i>		266	<i>Cords</i>		
	Mixed Hardwood		149	Cords		
	<i>Sugar Maple</i>		1.2	<i>MBF</i>		
	<i>White Ash</i>		2.1	<i>MBF</i>		
	<i>Red Maple</i>		135	<i>Cords</i>		
	<i>Sugar Maple</i>		3	<i>Cords</i>		
	<i>White Ash</i>		5	<i>Cords</i>		
4	Mixed Aspen	Sawtimber	47.6	MBF	47.3	\$16,681.80
	<i>B. T. Aspen</i>		6.6	<i>MBF</i>		
	<i>Quaking Aspen</i>		41.0	<i>MBF</i>		
	White Spruce		3.9	MBF		
	Balsam Fir	Pulpwood	195	Cords		
	<i>Balsam Fir</i>		195	<i>Cords</i>		
	Balsam Poplar		50	Cords		
	<i>Balsam Poplar</i>		3.1	<i>MBF</i>		
	<i>Balsam Poplar</i>		44	<i>Cords</i>		
	Mixed Aspen		302	Cords		
	<i>B. T. Aspen</i>		11	<i>Cords</i>		
	<i>Quaking Aspen</i>		291	<i>Cords</i>		
	Mixed Hardwood		109	Cords		
	<i>Sugar Maple</i>		2.1	<i>MBF</i>		
	<i>White Ash</i>		6.3	<i>MBF</i>		
	<i>Paper Birch</i>		22	<i>Cords</i>		
	<i>Red Maple</i>		43	<i>Cords</i>		
	<i>Sugar Maple</i>		3	<i>Cords</i>		

DESCRIPTION OF TIMBER BY PU (PU), CON'T

PU	MARKET GROUP	PRODUCT	QUANTITY	UNIT	ACRES	ADVERTISE PRICE
4 con't	<i>White Ash</i>	<i>Pulpwood</i>	24	<i>Cords</i>		
	White Spruce		13	Cords		
	<i>White Spruce</i>		13	<i>Cords</i>		
5	Mixed Aspen	Sawtimber	82.0	MBF	17.8	\$13,414.70
	<i>B. T. Aspen</i>		71.9	<i>MBF</i>		
	<i>Quaking Aspen</i>		10.1	<i>MBF</i>		
	N. White Cedar		5.7	MBF		
	White Spruce		6.4	MBF		
	Balsam Fir	Pulpwood	22	Cords		
	<i>Balsam Fir</i>	<i>Sawtimber</i>	2.1	<i>MBF</i>		
	<i>Balsam Fir</i>	<i>Pulpwood</i>	18	<i>Cords</i>		
	Balsam Poplar		9	Cords		
	<i>Balsam Poplar</i>		9	<i>Cords</i>		
	Mixed Aspen		195	Cords		
	<i>B. T. Aspen</i>		124	<i>Cords</i>		
	<i>Quaking Aspen</i>		71	<i>Cords</i>		
	Mixed Hardwood		36	Cords		
	<i>Paper Birch</i>		9	<i>Cords</i>		
	<i>Red Maple</i>		22	<i>Cords</i>		
	<i>White Ash</i>		5	<i>Cords</i>		
	N. White Cedar		42	Cords		
	White Pine		17	Cords		
	<i>White Pine</i>	<i>Sawtimber</i>	3.3	<i>MBF</i>		
	<i>White Pine</i>	<i>Pulpwood</i>	10	<i>Cords</i>		
	White Spruce		89	Cords		
	<i>White Spruce</i>		89	<i>Cords</i>		
6	Mixed Aspen	Sawtimber	40.9	MBF	30.7	\$15,470.60
	<i>Quaking Aspen</i>		40.9	<i>MBF</i>		
	N. White Cedar		14.6	MBF		
	Red Maple		11.2	MBF		
	White Spruce		7.0	MBF		
	Balsam Fir	Pulpwood	101	Cords		
	<i>Balsam Fir</i>		101	<i>Cords</i>		
	Mixed Aspen		140	Cords		
	<i>Quaking Aspen</i>		140	<i>Cords</i>		
	Mixed Hardwood		195	Cords		
	<i>Red Maple</i>		195	<i>Cords</i>		
	N. White Cedar		120	Cords		
	White Spruce		23	Cords		
	<i>White Spruce</i>		23	<i>Cords</i>		
7	Mixed Aspen	Sawtimber	213.3	MBF	100.4	\$55,575.50
	<i>B. T. Aspen</i>		29.4	<i>MBF</i>		
	<i>Quaking Aspen</i>		183.9	<i>MBF</i>		
	N. White Cedar		45.2	MBF		
	Red Maple		6.2	MBF		
	White Spruce		69.2	MBF		
	Balsam Fir	Pulpwood	399	Cords		
	<i>Balsam Fir</i>	<i>Sawtimber</i>	5.5	<i>MBF</i>		
	<i>Balsam Fir</i>	<i>Pulpwood</i>	388	<i>Cords</i>		
	Balsam Poplar		81	Cords		
	<i>Balsam Poplar</i>		81	<i>Cords</i>		
	Mixed Aspen		761	Cords		
	<i>B. T. Aspen</i>		12	<i>Cords</i>		
	<i>Quaking Aspen</i>		749	<i>Cords</i>		
	Mixed Hardwood		241	Cords		

DESCRIPTION OF TIMBER BY PU (PU), CON'T

PU	MARKET GROUP	PRODUCT	QUANTITY	UNIT	ACRES	ADVERTISE PRICE
7 con't	<i>Paper Birch</i>	<i>Pulpwood</i>	27	<i>Cords</i>		
	<i>Red Maple</i>		214	<i>Cords</i>		
	N. White Cedar		317	Cords		
	White Spruce		143	Cords		
	<i>White Spruce</i>		143	<i>Cords</i>		
TOTAL:			647.6	MBF		
TOTAL:			5,029	Cords		

Sale Specific Conditions & Requirements

Sale Name: Stimpson Road Aspen Mix

Sale Number: 52-124-22 Seq#: 2

1 - Sale Area

1.2 - Boundaries

1.2.1 - Painted boundaries (9/19)

The sale boundary and Payment Unit boundaries are marked and identified by blue, red and yellow paint. Exterior sale boundary lines against private property are marked with blue paint. Exterior sale boundary lines against state are marked with red paint. Interior Payment Unit boundaries are marked with yellow paint. Retention patches are marked with teal paint; no harvesting activities may occur within these areas. The painted boundary line trees are not Included Timber and are to be protected. Yellow painted trees designating an interior Payment Unit boundary are only to be cut when all surrounding Payment Units have been paid.

2 - Timber Specifications

2.1 - Included Timber

2.1.2 - Clearcut unit(s) w/o unmerchantable trees (8/11)

Within Payment Unit(s) 1 and 3-7, cut all trees which meet minimum piece specifications in 2.2 Utilization, with the following exceptions:

- Within Payment Unit 1, do not cut oak or any pine species.
- Within Payment Unit 3, do not cut oak, white pine, cedar, or any apple species.
- Within Payment Unit 4, do not cut white pine.
- Within Payment Unit 5, do not cut white pine greater than 20 inches at DBH or any apple species
- Within Payment Unit 6, do not cut white pine and hemlock.
- Within Payment Unit 7, do not cut any pine species or hemlock.

2.1.3 - Cut tree marked unit(s) (12/08)

Within Payment Unit(s) 2, all trees are designated for cutting when marked with orange paint above and below stump height, regardless of merchantability.

3 - Payments

3.3 - Pre-measured Sales

3.3.4 - Dividing payment units (7/14)

Payment Unit(s) 7 may be divided at the request of the Purchaser and upon approval of the Unit Manager. Dividing Payment Units is a contract modification which requires a Timber Sale Contract Amendment.

3.6 - Payment Unit Cutting Schedule

3.6.1 - Order of cutting (1/09)

Payment Units shall be cut in numerical order, unless the sale is paid in full or unless approved by the Unit Manager or his/her representative.

4 - Transportation

4.1 - Construction

4.1.3 - Slash and earthen piles (8/04)

Piles or windrows of earth along roads and landings that have been widened or constructed shall be leveled. Slash from road maintenance or construction, including stumps, shall be dispersed throughout the sale.

4.1.6 - Road construction (1/09)

Construction of new roads or improvements of existing roads shall be done in such a way as to minimize the environmental and visual impacts. Merchantable trees shall be cut and utilized unless otherwise directed. Non-merchantable trees shall be

severed and laid flat on the ground. Slash shall be scattered, and not left in windrows and kept a minimum of 10 feet back from the road edge. Stumps shall be set upright, not left on edge, and be moved at least 10 feet away from the road edge. Disturbed soil shall be feathered into the woods and not left in berms or windrows.

4.1.7 - Road closure (10/11)

All new roads built into the sale must be blocked to vehicle traffic upon completion of the sale. Overgrown roads that are reopened shall be considered new roads. In general, this will require constructing a four (4') foot high berm of stumps and logs covered with earth. These roads must be rendered impassable to cars and trucks. Contact the sale administrator for further specific details of design and placement.

4.1.11 - Permits (2/12)

The Purchaser will secure any necessary highway and stream crossing permits that may be required. The Purchaser is also responsible for contacting Miss DIG prior to operating along Stimpson RD.

4.2 - Maintenance

4.2.4 - Grading (10/16)

For completion of the sale, state forest roads must be graded. In general, this will require a road grader or bull dozer to shape up the roads after forest products have been hauled off site. This includes cleaning of drainage areas, grading, crowning and filling with gravel, if necessary. The grading equipment to be used must be approved by the Unit Manager or his/her representative.

5 - Operations

5.1 - Notification

5.1.1 - Pre-sale conference (10/16)

A pre-sale conference on site between the Purchaser and sale administrator is required prior to beginning any operations to determine landing and road locations. The Unit Manager or his/her representative must be contacted at least 3 days in advance to schedule the conference.

5.1.4 - Post-sale conference (10/16)

A post-sale conference on site between the Purchaser and sale administrator is required 3 days prior to the completion of active logging operations to determine clean-up and repair of landings, road edges, and the fulfillment of other contract specifications.

5.2 - Conduct of Operations

5.2.1 - Slash

5.2.1.13 - Dispose of slash as directed (12/05)

Slash is to be disposed of as directed by the Sale Administrator.

5.2.2 - Hazard Trees/Snags

5.2.2.1 - Den trees (10/16)

Obvious hollow and/or den trees shall be protected and left standing unless they are a safety hazard.

5.2.4 - Dead and Down Creation

5.2.4.5 - Dead and down creation, reptiles and amphibians (2/05)

To encourage reptiles and amphibians, within Payment Unit(s) 4, 6, and 7, leave one, 14" DBH or greater full-length tree on the ground, with the top still intact, for every 5 acres. These trees shall be evenly scattered throughout the Payment Unit(s) and identified by blue flagging.

5.2.22 - Operating Caution

5.2.22.1 - Operating caution (6/11)

It is recommended, but not required, that within Payment Unit(s) 1 and 3 - 7, cutting, skidding, and hauling occur during dry summer or frozen winter conditions with tracked equipment. The reason for the recommendation is due to the wetter soil conditions.

5.2.29 - Shrub protection (1/20)

Do not cut or damage hawthorn, witch-hazel, dogwood or juneberry. These woody-shrub plants are highly beneficial to various wildlife species.

5.2.32 - Decking/landing restoration (9/13)

All decking and landing areas must have the surface area restored to a condition equal to or better than before. This is to ensure the proper regeneration of the stand. Wood debris, chips and "cookies" from trimmings must be removed or scattered away from landing and loading areas and may not be windrowed on the edge.

5.2.37 - No decking areas (12/08)

No decking is allowed within the non-forested area located on the south side of access road to Payment Unit 2.

5.4 - Soil Protection

5.4.1 - Rutting restriction, general (7/16)

Operations are to cease immediately if equipment and weather conditions result in rutting of roads and/or skid trails which is 12 inches or greater in depth and 50 feet in length. The Unit Manager or his/her representative may restrict hauling and/or skidding if ruts exceed the specified depth. With the Unit Manager or his/her representative's approval, the Purchaser may return to the area when the risk of rutting has decreased.

5.4.6 - Wet area protection (5/10)

No harvesting operations, including skidding and felling, are to take place within vernal pond areas or drainages within Payment Unit 4. When harvesting occurs, there should be no disturbance to the vernal pond depressions. All equipment, trees and tops should be kept out of this areas. Equipment should only be used when the soil is in a dry or frozen condition. Care must be taken by the Purchaser to identify and avoid operating in these areas of the timber sale.

In addition, there are 2 old water diversion ditches running perpendicular from Stimpson Road located within Payment Units 3 and 4. These ditches must be kept clear of debris during harvesting activities.

5.7 - Protection of Historical Sites

5.7.2 - Potential historical site(s) (9/06)

The State Historic Preservation Office has identified the potential for a historic site within the boundary of this timber sale. Note that if the site is discovered during operations, General Condition and Requirement 5.7 - Protection of Historical Sites will apply.

5.8 - Protection of Endangered Species

5.8.5 - Protection of raptor nests (3/13)

All trees with raptor nests will be protected if found during harvesting operations. Notification will be made to the Unit Manager or his/her representative who will notify the Wildlife Biologist so an on-site evaluation and recommendation can be made, if necessary.

6 - Safety and Fire Prevention

6.2 - Signing

6.2.1 - Road posting (10/20)

The Purchaser is responsible for posting and maintaining caution signs on Stimpson Road prior to beginning operations. The road must be posted at appropriate distances from the sale area to warn of logging activity and truck traffic. Signs must be removed when harvest operations are suspended or completed.

6.2.3 - Recreational trail posting (10/20)

The Purchaser is responsible for posting and maintaining caution signs on the horse trail prior to beginning operations. The trail must be posted at appropriate distances from the sale area to warn of logging activity and truck traffic at both ends of the trail. Signs must be removed when harvest operations are suspended or completed.

7 - Other Conditions

7.5 - Loss

7.5.1 - Deteriorating timber (7/09)

The sale area has received damage from individual tree windthrow and general over maturity. The Purchaser should harvest the wood as soon as possible. The Department of Natural Resources is held free of responsibility of any further damage or deterioration due to delay in harvesting.

**TIMBER SALE MAP**

This information provided by authority of Part 525, 1994 PA 451, as amended.

Sale Number	Year
52 - 124	22

Forest Management Unit Gaylord	County Cheboygan	Mapped By TSP	Date 09/29/2022	Page 2	of 2
Township 38 & 39 N	Range 03W	Section(s) and Subdivision(s) 38N 03W 5: NENE; 39N 03W 19: N1/2SE; 28: NWSW; 29: SW, NESE, S1/2SE; 30: NESE; 32: NWNE, NESW, SE; 33: W1/2SW	Scale 1:15,840		

Cover Type

A = Aspen	H = Hemlock	N = Marsh	U = Upland Brush
B = Paper Birch	J = Jack Pine	O = Oak	UM = Upland Mixed
C = Cedar	L = Lowland Brush	P = Lowland Poplar	V = Bog or Marsh
D = Treed Bog	LM = Lowland Mixed	Q = Mixed Swamp Conifer	W = White Pine
E = Swamp Hdwoods	M = Mpl, Bch, Brch	R = Red Pine	X = Non Stocked
F = Spruce Fir	MC = Mixed Conifer	S = Black Spruce	Z = Water
G = Grass	MD = Mixed Deciduous	T = Tamarack	

Density

0 = Non Stocked	5 = Pole Timber Medium
1 = Seedling Sapling Poor	6 = Pole Timber Well
2 = Seedling Sapling Medium	7 = Saw Timber Poor
3 = Seedling Sapling Well	8 = Saw Timber Medium
4 = Pole Timber Poor	9 = Saw Timber Well

PU	Acres	PU	Acres
1	18.6	5	17.8
2	4.2	6	30.7
3	40.8	7	100.4
4	47.3		

Stimpson Road Aspen Mix

Compartment 136
259.8 Acres

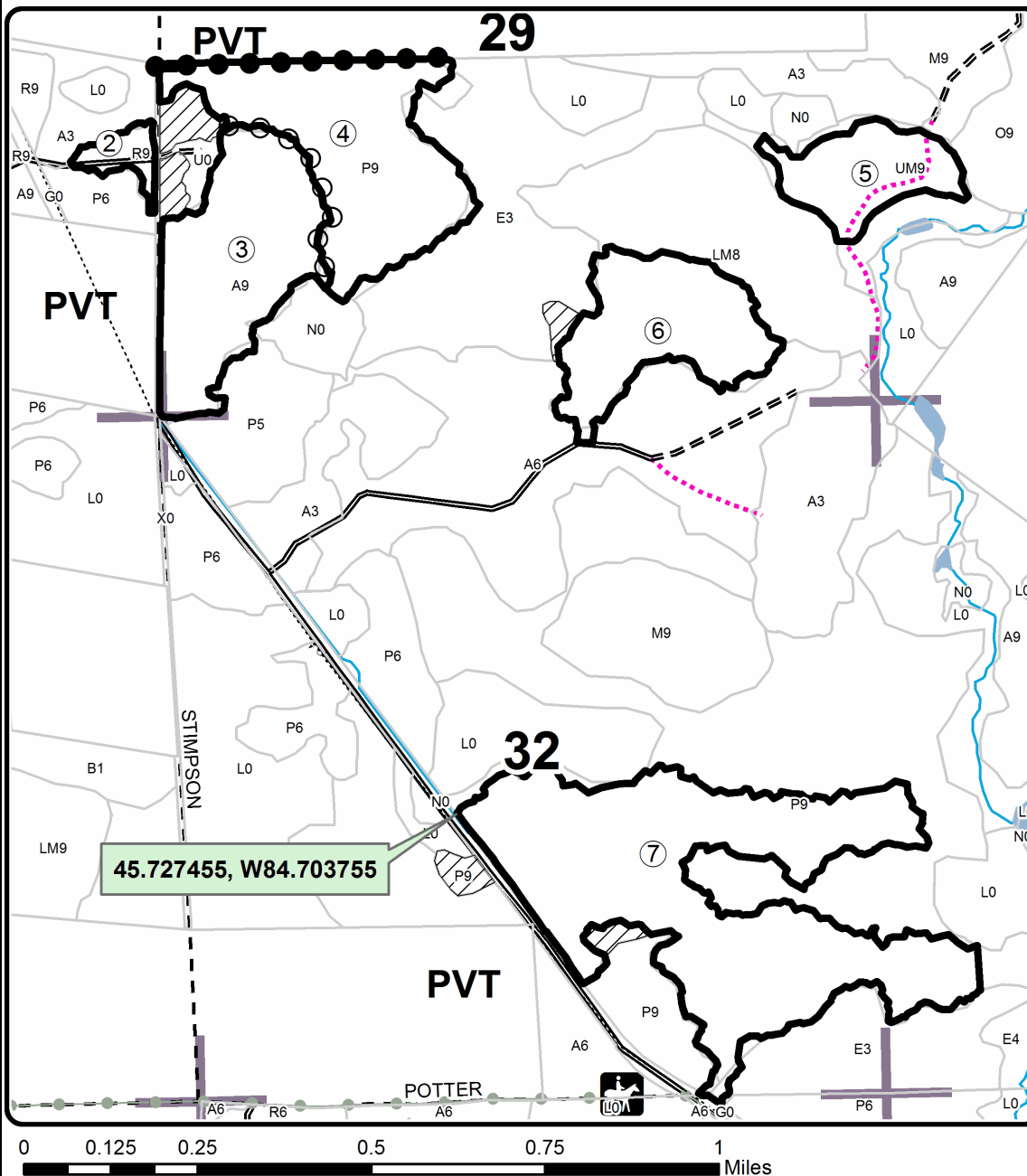
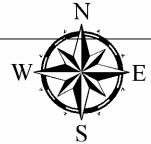
**Legend**

- Against State (Red)
- Payment Unit (Yellow)
- Private Line (Blue)
- ▨ Retention Area
- Stand Boundaries
- - - Utility Line
- Recreational Trail
- Secondary Forest Road
- Forest Access Route
- Gravel Road
- Temporary Management Access
- Perennial River
- Lakes and Rivers
- Section Corners

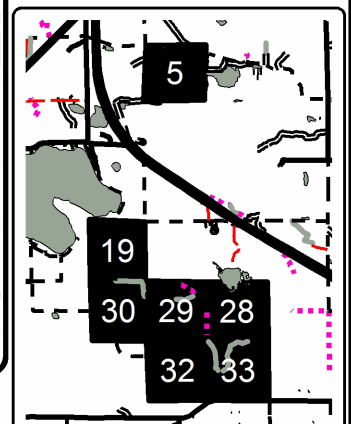
Locator Map
1:200,000



TIMBER SALE MAP

This information provided by authority of Part 525, 1994 PA 451, as amended.

Sale Number	Year
52 - 124	22

Forest Management Unit Gaylord	County Cheboygan	Mapped By TSP	Date 09/29/2022	Page 1	of 2
Township 38 & 39 N	Range 03W	Section(s) and Subdivision(s) 38N 03W 5: NENE; 39N 03W 19: N1/2SE; 28: NWSW; 29: SW, NESE, S1/2SE; 30: NESE; 32: NWNE, NESW, SE; 33: W1/2SW	Cruised By Scheele	Scale 1:15,840	

Cover Type

A = Aspen	H = Hemlock	N = Marsh	U = Upland Brush
B = Paper Birch	J = Jack Pine	O = Oak	UM = Upland Mixed
C = Cedar	L = Lowland Brush	P = Lowland Poplar	V = Bog or Marsh
D = Treed Bog	LM = Lowland Mixed	Q = Mixed Swamp Conifer	W = White Pine
E = Swamp Hdwoods	M = Mpl, Bch, Brch	R = Red Pine	X = Non Stocked
F = Spruce Fir	MC = Mixed Conifer	S = Black Spruce	Z = Water
G = Grass	MD = Mixed Deciduous	T = Tamarack	

Density

0 = Non Stocked	5 = Pole Timber Medium
1 = Seedling Sapling Poor	6 = Pole Timber Well
2 = Seedling Sapling Medium	7 = Saw Timber Poor
3 = Seedling Sapling Well	8 = Saw Timber Medium
4 = Pole Timber Poor	9 = Saw Timber Well

PU	Acres	PU	Acres
1	18.6	5	17.8
2	4.2	6	30.7
3	40.8	7	100.4
4	47.3		

Stimpson Road Aspen Mix

Compartment 136
259.8 Acres

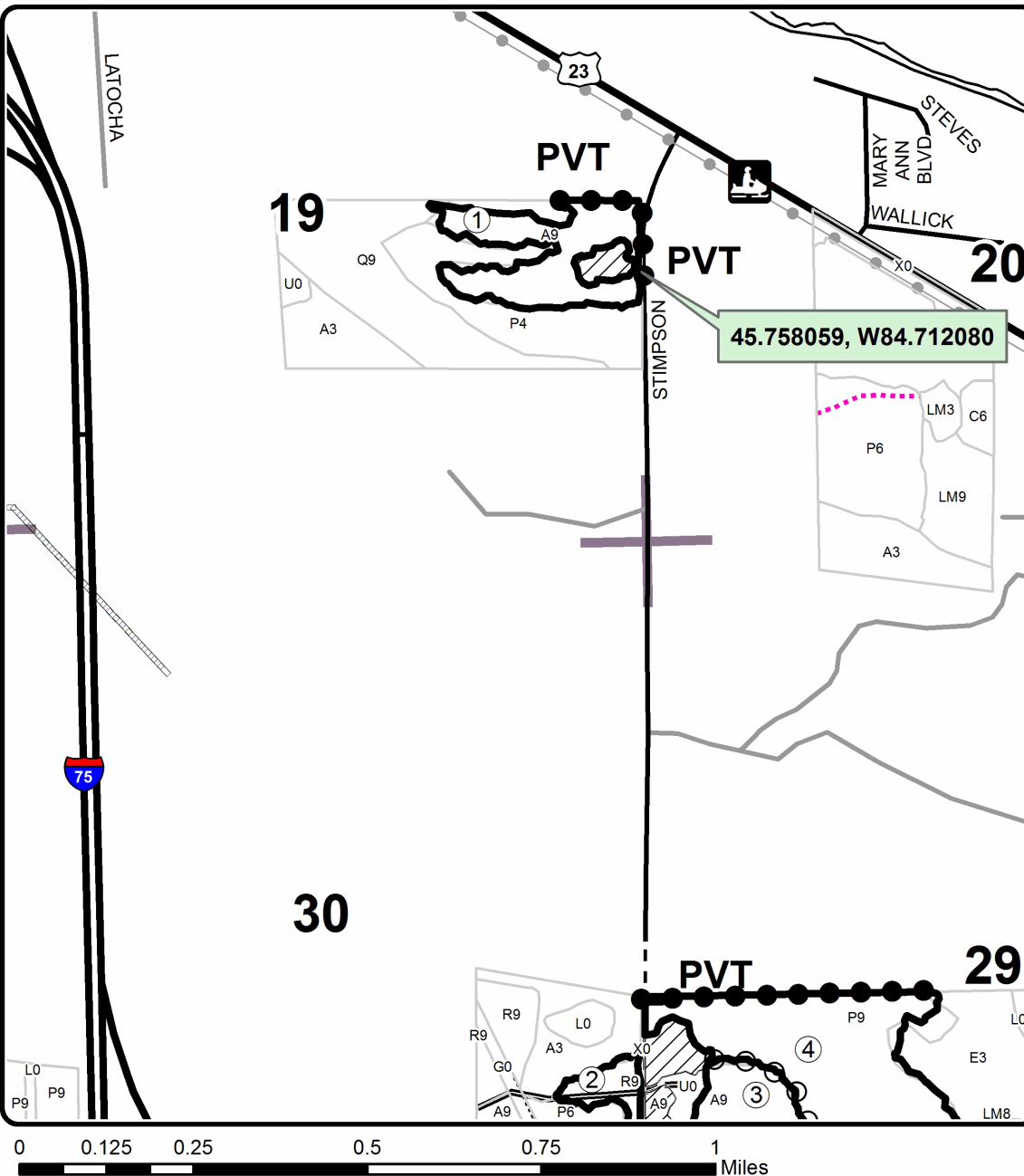
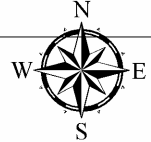

Legend

- Against State (Red)
- Payment Unit (Yellow)
- Private Line (Blue)
- ▨ Retention Area
- Stand Boundaries
- Utility Line
- Recreational Trail
- Highways
- Secondary Forest Road
- Forest Access Route
- Paved Road
- Gravel Road
- Private
- Temporary Management Access
- Section Corners

Locator Map

1:200,000

