



**DEPARTMENT OF NATURAL RESOURCES
STATE OF MICHIGAN
TIMBER SALE PROSPECTUS #7355**

SCHEDULED SALE DATE AND TIME: 9:00 a.m. (local time) on December 5, 2023.

LOCATION: ROSCOMMON MGMT UNIT, PO BOX 218, ROSCOMMON, MI 48653.

CONTACT NAME: Jason Lewicki

PHONE NUMBER: (989) 275-4622

PROSPECTUS NOTE: The bidder is advised to inspect the sale area and review the location, estimated volumes, operating costs and contract terms of proposed sales. Please be aware that some landowners may request 60 days or more notice for access across their land.

Notice is hereby given that bids will be received by the Unit Manager, ROSCOMMON MANAGEMENT UNIT, for certain timber on the following described lands:

Panda Oak Strips (71-005-23) / T21N, R03W, SEC. 13, S1/2SW.

T21N, R03W, SEC. 23, NENE.

T21N, R03W, SEC. 24, NW, N1/2SW, SWSW.

Roscommon County, Advertised Price \$75,698.35, 142.0 Acres, Hardwood, Red Oak.

SALE NOTE: A recreation site such as a trail, pathway, or campground is within the sale area or the vicinity. Certain restrictions/specifications may be applicable including time restrictions.

TIMBER SALE INFORMATION

Panda Oak Strips (71-005-23)

T21N, R03W, SEC. 13; T21N, R03W, SEC. 23; T21N, R03W, SEC. 24.

Roscommon County (Advertised Price \$75,698.35)

SALE NOTE: A recreation site such as a trail, pathway, or campground is within the sale area or the vicinity. Certain restrictions/specifications may be applicable including time restrictions.

A timber sale contract for this lump sum, sealed bid timber sale will be awarded to the responsible bidder offering the highest sealed bid price. All units of volume listed below were estimated using the T-Sale computer program and our traditional volume equations. Bids must be at or above the following advertised price for each product and species:

<u>PRODUCTS & SPECIES</u>	<u>ESTIMATED UNITS*</u>	<u>ADVERTISED PRICE</u>
Sawtimber		
B. T. Aspen	62.2 MBF	\$ 107.00 / MBF
Paper Birch	2.1 MBF	\$ 56.00 / MBF
Red Maple	10.4 MBF	\$ 97.00 / MBF
Red Oak	213.5 MBF	\$ 155.00 / MBF
Red Pine	9.5 MBF	\$ 173.00 / MBF
White Oak	37.0 MBF	\$ 81.00 / MBF
Pulpwood		
B. T. Aspen	54 Cords	\$ 46.90 / Cord
Mixed Oak	230 Cords	\$ 24.90 / Cord
Paper Birch	7 Cords	\$ 21.55 / Cord
Red Maple	109 Cords	\$ 24.50 / Cord
Red Oak	517 Cords	\$ 24.90 / Cord
Red Pine	11 Cords	\$ 61.25 / Cord
White Pine	111 Cords	\$ 50.05 / Cord

* The total volume is statistically estimated within plus (+) or minus (-) 11.41 percent. There are an estimated 1,709 cords on this timber sale, plus or minus 195 cords at the 95% confidence level. The estimated units are final and not subject to adjustment. Prospective bidders are urged to examine this timber and to make their own estimates of quantity and quality.

BOND AND PAYMENT SCHEDULE:

1. A bond in the amount of \$3,784.92 to insure faithful performance of the conditions of the contract will be deposited by the successful bidder within 21 days of the sale award.
2. Cutting in any sale or unit without the required advance payment would be considered a trespass.
3. Total payment must be paid in advance or according to the following schedule :
 - (a) Ten percent (10%) of the sale value must be paid within 21 days of the sale award.
 - (b) The 10% down payment will be credited towards the first unit cut.
 - (c) Payment for each of the following units must be made before cutting begins in that unit:

PAYMENT UNIT NUMBER	PERCENT OF TOTAL SALE VALUE
01	12.7%
02	16.3%
03	26.8%
04	14.1%
05	14.5%
06	15.6%

4. If no cutting takes place, the 10% down payment will not be refunded.
5. Operations on the contract issued will terminate on 12/31/2025.

SALE STATISTICS

SALE VOLUMES

VOLUME		STATISTICAL RANGE IN CORDS		
TOTAL CUBIC FEET	TOTAL CORDS	PERCENT ERROR	MINIMUM	MAXIMUM
134,974	1,709	11.41%	1,514	1,903

VDU VOLUMES

A VDU is a Volume Determination Unit. Volumes and their associated statistics are calculated at the VDU level and summarized to the sale level. There is often a one to one relationship between a VDU and a Payment Unit, but not always, depending on the cruise design. Refer to the VDU TO PAYMENT UNIT table.

	VOLUME			RANGE IN CORDS	
VDU	TOTAL CUBIC FEET	TOTAL CORDS	PERCENT ERROR	MINIMUM	MAXIMUM
117	0	0	14.76%	0	0
118	0	0	16.87%	0	0
TOTAL:	0	0		0	0

VDU TO PAYMENT UNIT

When a VDU is associated with more than one Payment Unit (PU), the VDU volumes are assigned to the PU based on acres of the VDU within the PU.

VDU	VDU ACRES	PU	PU ACRES
117	95.7	1	17.3
		2	22.3
		3	36.8
		4	19.3
118	46.3	5	22.2
		6	24.1
TOTAL:	142.0		142.0

DESCRIPTION OF TIMBER BY PU (PU)

PU	MARKET GROUP	PRODUCT	QUANTITY	UNIT	ACRES	ADVERTISE PRICE
1	B. T. Aspen	Sawtimber	5.5	MBF	17.3	\$9,591.60
	Red Maple		1.2	MBF		
	Red Oak		31.3	MBF		
	White Oak		5.6	MBF		
	B. T. Aspen	Pulpwood	4	Cords		
	Mixed Oak		28	Cords		
	/Red (Hybrid) Oak	Sawtimber	0.6	MBF		
	/Red (Hybrid) Oak	Pulpwood	1	Cords		
	White Oak		26	Cords		
	Paper Birch		1	Cords		
	Red Maple		10	Cords		
	Red Oak		67	Cords		
	Red Pine		1	Cords		
	White Pine		14	Cords		
2	B. T. Aspen	Sawtimber	7.1	MBF	22.3	\$12,331.40
	Red Maple		1.5	MBF		
	Red Oak		40.3	MBF		
	White Oak		7.2	MBF		
	B. T. Aspen	Pulpwood	6	Cords		
	Mixed Oak		35	Cords		
	/Red (Hybrid) Oak	Sawtimber	0.7	MBF		
	/Red (Hybrid) Oak	Pulpwood	1	Cords		
	White Oak		33	Cords		
	Paper Birch		1	Cords		
	Red Maple		13	Cords		
	Red Oak		86	Cords		
	Red Pine		1	Cords		
	White Pine		18	Cords		
3	B. T. Aspen	Sawtimber	11.7	MBF	36.8	\$20,321.45
	Red Maple		2.5	MBF		
	Red Oak		66.5	MBF		
	White Oak		11.7	MBF		
	B. T. Aspen	Pulpwood	9	Cords		
	Mixed Oak		59	Cords		
	/Red (Hybrid) Oak	Sawtimber	1.2	MBF		
	/Red (Hybrid) Oak	Pulpwood	2	Cords		
	White Oak		55	Cords		
	Paper Birch		2	Cords		
	Red Maple		22	Cords		
	Red Oak		142	Cords		
	Red Pine		1	Cords		
	White Pine		30	Cords		
4	B. T. Aspen	Sawtimber	6.1	MBF	19.3	\$10,692.60
	Red Maple		1.3	MBF		
	Red Oak		34.9	MBF		
	White Oak		6.2	MBF		
	B. T. Aspen	Pulpwood	5	Cords		
	Mixed Oak		31	Cords		
	/Red (Hybrid) Oak	Sawtimber	0.6	MBF		
	/Red (Hybrid) Oak	Pulpwood	1	Cords		
	White Oak		29	Cords		
	Paper Birch		1	Cords		
	Red Maple		11	Cords		
	Red Oak		74	Cords		
	Red Pine		1	Cords		

DESCRIPTION OF TIMBER BY PU (PU), CON'T

PU	MARKET GROUP	PRODUCT	QUANTITY	UNIT	ACRES	ADVERTISE PRICE
4 con't	White Pine	Pulpwood	16	Cords		
5	B. T. Aspen	Sawtimber	15.3	MBF	22.2	\$10,948.85
	Paper Birch		1.0	MBF		
	Red Maple		1.9	MBF		
	Red Oak		19.4	MBF		
	Red Pine		4.6	MBF		
	White Oak		3.0	MBF		
	B. T. Aspen	Pulpwood	14	Cords		
	Mixed Oak		37	Cords		
	/Red (Hybrid) Oak	Sawtimber	0.9	MBF		
	/Red (Hybrid) Oak	Pulpwood	1	Cords		
	White Oak		34	Cords		
	Paper Birch		1	Cords		
	Red Maple		25	Cords		
	Red Oak		71	Cords		
	Red Pine		4	Cords		
	White Pine		16	Cords		
6	B. T. Aspen	Sawtimber	16.5	MBF	24.1	\$11,787.55
	Paper Birch		1.1	MBF		
	Red Maple		2.0	MBF		
	Red Oak		21.1	MBF		
	Red Pine		4.9	MBF		
	White Oak		3.3	MBF		
	B. T. Aspen	Pulpwood	16	Cords		
	Mixed Oak		39	Cords		
	/Red (Hybrid) Oak	Sawtimber	0.9	MBF		
	/Red (Hybrid) Oak	Pulpwood	1	Cords		
	White Oak		36	Cords		
	Paper Birch		1	Cords		
	Red Maple		28	Cords		
	Red Oak		77	Cords		
	Red Pine		3	Cords		
	White Pine		17	Cords		
TOTAL:			334.7	MBF		
TOTAL:			1,038	Cords		

Sale Specific Conditions & Requirements

Sale Name: Panda Oak Strips

Sale Number: 71-005-23 Seq#: 1

1 - Sale Area

1.2 - Boundaries

1.2.1 - Painted boundaries (1/14)

The sale boundary and Payment Unit boundaries are marked and identified by red and yellow paint. Exterior sale boundary lines against state are marked with red paint. Interior Payment Unit boundaries are marked with yellow paint. Interior Payment Unit boundaries are marked with yellow paint. The painted boundary line trees are not Included Timber and are to be protected unless marked with orange paint.

2 - Timber Specifications

2.1 - Included Timber

2.1.3 - Cut tree marked unit(s) (12/08)

Within Payment Unit(s) 1-6, all trees are designated for cutting when marked with orange paint above and below stump height, regardless of merchantability.

2.2 - Utilization

2.2.3 - Stump heights (4/07)

Stump heights within the Sale Area shall not exceed 6 inches for all trees.

2.2.6 - Roundwood operation required (5/07)

The skidding of whole trees or tree segments with limbs attached is prohibited. All products must be produced as roundwood and forwarded to existing roads or landing areas in final product length.

2.2.8 - Utilization and removal (5/14)

All products meeting standards set forth in General Condition and Requirement 2.2 - Utilization must be removed from the Sale Area. This is because too much slash buildup may occur from merchantable product being left in woods.

2.2.9 - No chipping permitted (12/08)

Within Payment Unit(s) 1-6, all wood must be removed by roundwood. No chipping is permitted.

3 - Payments

3.3 - Pre-measured Sales

3.3.4 - Dividing payment units (7/14)

Payment Unit(s) 1-6 may be divided at the request of the Purchaser and upon approval of the Unit Manager. Dividing Payment Units is a contract modification which requires a Timber Sale Contract Amendment. There will be only one division per Payment Unit.

3.4 - Damaged Timber

3.4.1 - Damaged timber (6/14)

General Condition and Requirement 3.4 Damaged Timber, defines liquidated damages for undesignated live merchantable trees which are cut or injured. In addition, extreme care should be taken to avoid damage to tree seedlings and saplings. Within the Sale Area, if more than 30% of the tree seedlings or saplings (1/4" to 4.5" DBH) within a specified portion of the Sale Area are damaged, liquidated damages will be assessed at \$300 per acre for all acreage within that specified portion of the sale area that was damaged.

No damage is acceptable to merchantable trees. Within the Sale Area, if more than 5% of trees (> 4.5" DBH) within a specified area of the sale are damaged, liquidated damages will be assessed for all trees damaged. Rates will be in accordance with General Condition and Requirement 3.4 Damaged Timber.

4 - Transportation

4.1 - Construction

4.1.3 - Slash and earthen piles (8/04)

Piles or windrows of earth along roads and landings that have been widened or constructed shall be leveled. Slash from road maintenance or construction, including stumps, shall be dispersed throughout the sale.

4.1.12 - No new roads (1/12)

No new roads will be permitted. All operations are limited to existing roads. Skid trails only will be allowed.

4.2 - Maintenance

4.2.3 - Road maintenance (8/13)

The following road maintenance is required: Within 60 days of completion of hauling, or if no hauling occurs for 60 days, the road must be maintained and graded to the condition it was prior to usage. This may include cleaning of drainage areas, grading, crowning and filling with gravel, if necessary. Damages will be assessed if grading/repair does not occur.

4.2.5 - Two wheel drive condition (2/04)

All existing trail roads on and adjacent to the sale area must be passable by two-wheel drive traffic for the duration of the sale.

5 - Operations

5.1 - Notification

5.1.1 - Pre-sale conference (10/16)

A pre-sale conference on site between the Purchaser and sale administrator is required prior to beginning any operations to determine landing and haul routes.

5.1.4 - Post-sale conference (10/16)

A post-sale conference on site between the Purchaser and sale administrator is required 5 days prior to the completion of active logging operations to determine clean-up and repair of landings, road edges, and the fulfillment of other contract specifications.

5.2 - Conduct of Operations

5.2.1 - Slash

5.2.1.2 - Slash Removal

5.2.1.2.1 - Slash removal, right-of-way (9/16)

All slash must be removed at least 15 feet from the cleared right-of-way of the overhead powerline.

5.2.1.8 - Slash height (12/08)

No slash or tree tops may exceed 24 inches in height.

5.2.2 - Hazard Trees/Snags

5.2.2.1 - Den trees (10/16)

Obvious hollow and/or den trees shall be protected and left standing unless they are a safety hazard.

5.2.3 - Operating Restrictions

5.2.3.1 - Operating restrictions (9/11)

Within Payment Unit(s) 5-6, unless authorized by the Timber Sale Administrator, creation of skids trails are not permitted through the strips of younger regeneration. No trees are marked within the strips for removal. This restriction is to protect the regeneration already established within these strips.

5.2.3.4 - Oak wilt restriction, no exceptions (1/18)

Within Payment Unit(s) 1-6, cutting, skidding, hauling within the sale and brushing of access roads to the sale are not permitted during the period of April 15 to July 15. No exceptions will be granted. This is necessary to reduce the spread

of oak wilt.

5.2.32 - Decking/landing restoration (9/13)

All decking and landing areas must have the surface area restored to a condition equal to or better than before. This is to ensure the proper regeneration of the stand. Wood debris and "cookies" from trimmings must be removed or scattered away from landing and loading areas and may not be windrowed on the edge.

5.4 - Soil Protection

5.4.1 - Rutting restriction, general (7/16)

Operations are to cease immediately if equipment and weather conditions result in rutting of roads and/or skid trails which is 12 inches or greater in depth and 50 feet in length. The Unit Manager or his/her representative may restrict hauling and/or skidding if ruts exceed the specified depth. With the Unit Manager or his/her representative's approval, the Purchaser may return to the area when the risk of rutting has decreased.

5.4.2 - Skid trails (2/04)

Skid trails up and down slopes should be avoided. If however this is unavoidable, these trails will be left in a non-erodible condition using water bars, logs, and slash. Placing of slash on these skid trails while logging is ongoing may alleviate need for any further action. At the direction of the sale administrator, seed, fertilizer, and mulch may also be required.

6 - Safety and Fire Prevention

6.2 - Signing

6.2.1 - Road posting (9/09)

The Purchaser is responsible for posting and maintaining caution signs on roads used for hauling prior to beginning operations. The road must be posted at appropriate distances from the Sale Area to warn of logging activity and truck traffic. Signs must be removed when harvest operations are suspended or completed. The Purchaser will provide these signs.



TIMBER SALE MAP

This information provided by authority of Part 525, 1994 PA 451, as amended.

Sale Number	Year
71 - 005	19

Forest Management Unit	County	Mapped By	Contractor/Martell	Date	Page	of
Roscommon	Roscommon	Cruised By	Contractor	04/19/2019	1	1
Township	Range	Section(s) and Subdivision(s)		Scale		
21N	03W	Sec. 13 - S1/2SW; Sec. 23 - NENE; Sec. 24 - NW, N1/2SW, SWSW		1:15,840		

Cover Type

A = Aspen	H = Hemlock	N = Marsh	U = Upland Brush
B = Paper Birch	J = Jack Pine	O = Oak	UM = Upland Mixed
C = Cedar	L = Lowland Brush	P = Lowland Poplar	V = Bog or Marsh
D = Treed Bog	LM = Lowland Mixed	Q = Mixed Swamp Conifer	W = White Pine
E = Swamp Hdwoods	M = Mpl, Bch, Brch	R = Red Pine	X = Non Stocked
F = Spruce Fir	MC = Mixed Conifer	S = Black Spruce	Z = Water
G = Grass	MD = Mixed Deciduous	T = Tamarack	

Density

0 = Non Stocked	5 = Pole Timber Medium
1 = Seedling Sapling Poor	6 = Pole Timber Well
2 = Seedling Sapling Medium	7 = Saw Timber Poor
3 = Seedling Sapling Well	8 = Saw Timber Medium
4 = Pole Timber Poor	9 = Saw Timber Well

PU	Acres	PU	Acres
1	17.0	4	19.5
2	22.2	5	22.0
3	37.0	6	24.3

Panda Oak Strips

Compartment 027
142 Acres



Legend

- Against State (Red)
- Payment Unit (Yellow)
- Payment Unit Number
- ▨ Retention Area
- ▭ Stand Boundaries
- Pipeline
- ⊕ Powerline
- ⋯ Nearby Timber Sale
- Section Corners
- Highway
- Secondary Forest Road
- == Forest Access Route
- Paved Road
- - Gravel Road

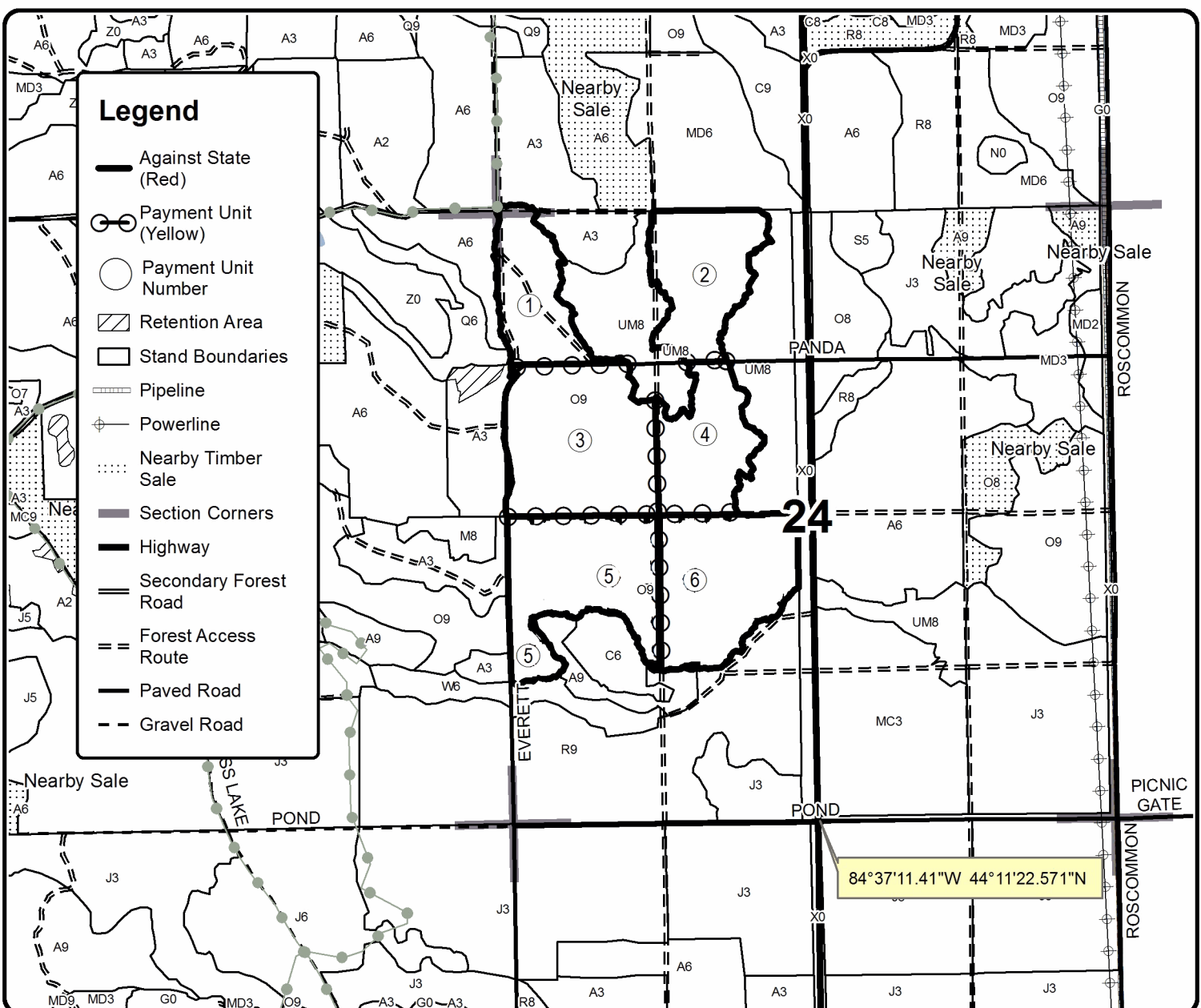

0 0.125 0.25 0.5 0.75 1 Miles